

CENTRAL MAPPING AUTHORITY  
Department of Lands

Trigonometrical Survey of N.S.W.

RECONNAISSANCE and MAINTENANCE REPORT

This Trig. Station has been:-

Note: Cross out word or words which do not apply

1. Completely cleared to permit 360° vision to surrounding trig. stations
2. Cleared by lances bearing 30° 16' 5" N 124° 5' 17" W, 174° 5' 19" N 124° 5' 17" W, 240° 5' 25" W, 280° 5' 30" W from Trig. Mast
3. Trig. Mast & Vanes have been painted white & black respectively.
4. The Trig. was unpiled/not unpiled, dimensions now being:
  - Description of mark copper conical ~~stone~~ should be explicit, e.g. Steel plug, Brass plug, Bolt, G.I. Pipe
  - Height of mark set flush into ~~above~~ ~~below~~ ~~rock~~ ~~concrete~~ ~~at~~ ..... m above below G.L.
  - Height of Top Vanes to Top Mark 3.505 m. Diameter of Vanes (vertical) 0.015 m.
  - Height of Cairn 1.240 m. Diameter of Cairn 1.500 m.
  - Length of Mast 2.505 m. (approximate if not unpiled)

5. A copper nail set in conc/rock has been placed 4.210 m. bearing 100° from Trig. Mast
6. A G.I. Pipe set in conc/soil has been placed 2.665 m. bearing 333° from Trig. Mast
7. A ..... set in conc/soil has been placed ..... m. bearing .....° from Trig. Mast
8. A ..... set in conc/rock has been placed ..... m. bearing .....° from Trig. Mast
9. Connection copper nail to G.I.P. 6.125 m. bearing 267° from Trig. Mast
10. Connection ..... to ..... m. bearing .....° from Trig. Mast
11. Connection ..... to ..... m. bearing .....° from Trig. Mast
12. Connection ..... to ..... m. bearing .....° from Trig. Mast
13. Diff. Ht. copper nail is 0.035 m. below cartr. can fd
14. Diff. Ht. copper nail is 0.000 m. level G.L.P.
15. Diff. Ht. G.I. Pipe is 0.030 m. below cartr. can fd
16. Diff. Ht. ..... is ..... m. above/below

Prepared by: P. HALLS Checked: G. [Signature] Noted on U.T.M. Card

STATION GIRARD TS-6549

Co: DUNCKER Ph: CALLANYN

Map Sheet: DRAKE No: 9340-S  
Inspected by: D.J. KAIN Date: 1-5-75  
Authority: J. SHERWIN Field Book: Q1327  
CMA 7273 Q1442

Beacon Diagram

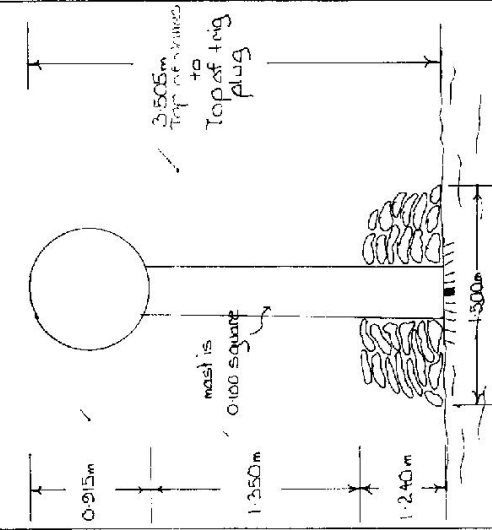

Date: \_\_\_\_\_ Record of Station: \_\_\_\_\_

Checked: \_\_\_\_\_

STATION GIRARD TS. 6549

Current Occupant.....

Address.....

Owners Name.....

Address.....

1-5-1975  
Access 14-5-1975

MILEAGE

0.0  
25.25  
27.15  
27.20  
27.55  
27.65  
27.90  
28.30  
28.85  
29.25  
29.70

FEATURE

TENTERFIELD P.O. via BRUMBER HWY  
TOWARD CASINO  
Cross Road bridge over 'CROOKED CREEK'  
TAKE Gravel road to right  
(opposite white & green cream box)  
TAKE Left fork.  
TAKE right ahead at four way junction  
TAKE right fork.  
Pass Gravel road on R.H.S.  
TAKE left fork at old log ramp  
At water tank take right fork  
TAKE left fork in track down ridge  
TAKE right fork along ridge to Triv  
29.75

NB. A station sedan could be driven to trig in dry weather

*THIS ACCESS IS FOR DRAKE G.S.*

ADVISED BY M. MORRISON on 5-11-79

*M. Morrison*

Not to Scale

Station Diagram  
MAGNETIC  
North

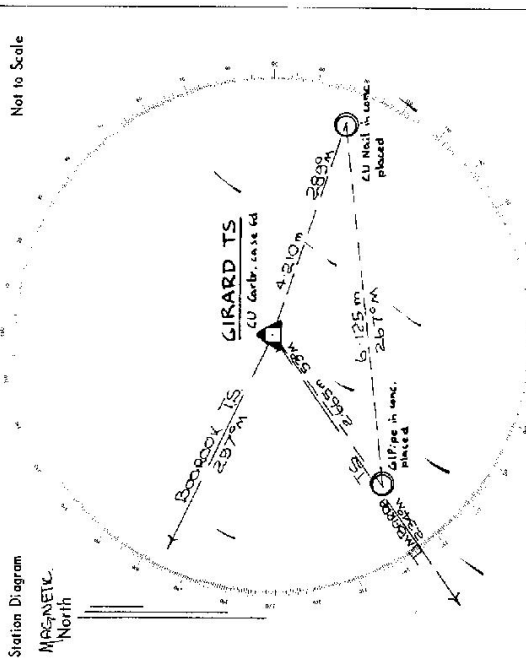

List of Observed Directions:-

Station	Direction	Station	Direction
Beebrook T.S.	287° 52'	Beebrook T.S.	359° 59' 40"
G.S.P.	298° 10' 48"	Triv Plus	353° 48'
Timberara T.S.	113° 48'	G.S.P.	332° 46' 30"
Copper nail	113° 48'	Timberara T.S.	118° 11' 44"
STANDARD: G.S.P.			
Timberara T.S.	218° 09' 56"		
Copper nail	152° 45' 00"		
Triv Plus	118° 13'		
Beebrook T.S.	359° 59' 40"		

CENTRAL MAPPING AUTHORITY

GEODETTIC SURVEY OF N.S.W.

GEODETTIC STATION RECONNAISSANCE and MAINTENANCE REPORT

TS-6549  
No.: 2195

STATION: GIRARD

MAP SHEET SCALE 1:250 000

INSPECTED BY: M.L. MORRISON

DATE: 24/10/19

AUTHORITY: CMAA

FIELD BOOK: 1798

Description: *Note: Cross out word or words which do not apply*

1. Cleared by lanes bearing..... from Trig. Mast
2. Mast & Vanes have been painted white & black respectively.
3. The station/pillar was unpiled/not unpiled/constructed on.....19....., dimensions now being:  
 Description of mark.....should be explicit, e.g., S/Steel Pillar Plate, Steel plug, Brass plug, Bolt, G.I. Pipe  
 Height of mark.....m. <sup>above</sup> <sub>below</sub> rock/concrete; Mark is.....m. <sup>above</sup> <sub>below</sub> G.L.  
 Height of Top Vanes to Top Mark/Pillar plate.....m. Diameter of Vanes (vertical).....m.  
 Height of Cairn.....m. Diameter of Cairn.....m. Name Plate found/not found/placed.  
 Length of Mast.....m. (approximate if not unpiled)
4. A.....set in conc/rock has been placed/found, bearing.....° M from Mast/Plug/Pillar
5. A.....set in conc/rock has been placed/found, bearing.....° M from Mast/Plug/Pillar
6. A.....set in conc/rock has been placed/found, bearing.....° M from Mast/Plug/Pillar
7. A.....set in conc/rock has been placed/found, bearing.....° M from Mast/Plug/Pillar
8. Action required:.....

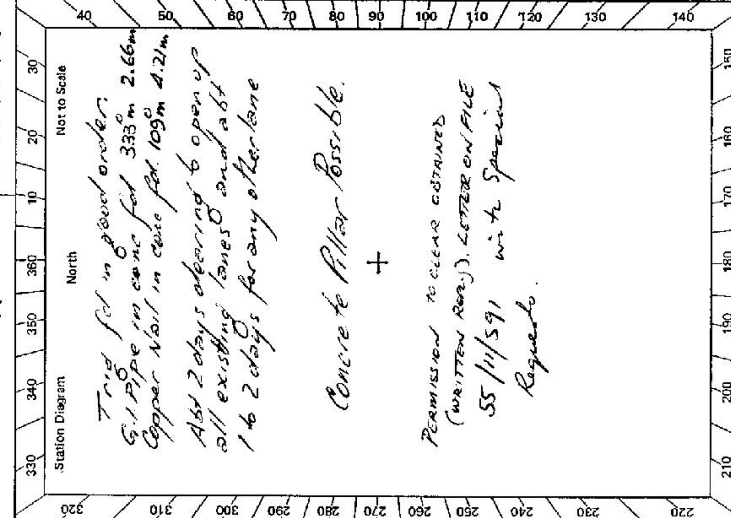

STANDPOINT:			
Mark	Direction	Horiz. Distance	Height Difference
			above standpt.
			below standpt.
			above standpt.
			below standpt.
			above standpt.
			below standpt.
			above standpt.
			below standpt.
			above standpt.
			below standpt.
			above standpt.
			below standpt.

Prepared by: *[Signature]* Checked: *[Signature]* Noted on U.T.M. Card

STATION **GIRARD TS 6549**

Owner's Name: **CARLETON BROS**  
 Address: **SPARKMAN**  
 Phone: **BATHMAN TR**  
 Current Occupant:  
 Address:  
 Phone: **ACCESS 24-10-1979**

Access Report of 14.5.1975 was found ~~unsuitable~~ (unsuitable).

Direction  
 0.00 ENTERFIELD RD. HEADNORTH TOWARDS STANTHORPE  
 0.19 TURN RIGHT ONTO BELMORE HWY HEAD TOWARDS CASANO  
 39.00 BRIDGE OVER CROOKED CREEK.  
 40.33 TURN LEFT OFF HWY INTO RED ROCK ROAD.  
 40.90 STRAIGHT AHEAD  
 41.18 BRID  
 41.55 PASS TRACK ON RIGHT  
 41.97 PASS TRACK ON RIGHT  
 43.44 TAKE RIGHT FORK  
 44.88 PASS PINCH FOREST ROAD ON RIGHT.  
 46.31 GRID  
 47.33 TURN RIGHT OVER GRID  
 47.53 PASS HORSE STALLS ON RIGHT  
 48.49 STRAIGHT ACROSS INTERSECTION  
 48.79 TAKE LEFT FORK  
 48.88 GRID  
 50.22 TURN SHARP LEFT BACK UP HILL (JUST BEFORE BLAZED TREES)  
 50.45 MAKE OWN WAY FOLLOWING FAINT TRACK & BLAZES  
 TRIG

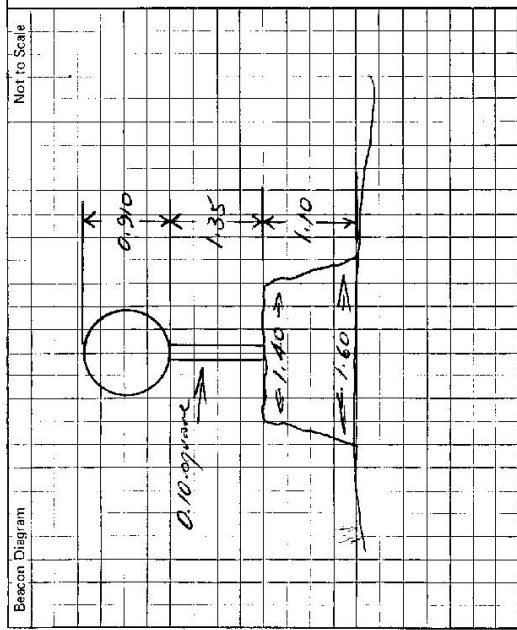

This section to be completed by officer constructing pillar.  
 Original station mark found/not found.  
 Description of mark: .....  
 Original beacon found/not found.  
 Description of beacon: .....  
 Height Top of Vanes to Top Mark .....m.  
 Height of mark .....m. above G.L. below  
 Diameter of Vanes .....m. Height of Cairn .....m.  
 Original Beacon has/has not been destroyed by me.

Date	Record of Station

GEODETIC SURVEY OF M.S.W.

CENTRAL MAPPING AUTHORITY

GEODETIC STATION RECONNAISSANCE and MAINTENANCE REPORT

Description:

1. Cleared by lances bearing  $201 \text{ m } 66^\circ 0'$  ( $12 \text{ m } 172^\circ 1'$ ) to  $195 \text{ m } 70^\circ 2'$  to  $195 \text{ m } 26^\circ 24'$  from Trig. Mast  
Note: Cross out word or words which do not apply
2. Mast & Vanes have been painted white & black respectively.
3. The ~~structure~~/pillar was ~~constructed~~ on ~~str. m. dy.~~  $19.80 \text{ m}$ , dimensions now being: Description of mark ~~should be explicit, e.g., S/Steel Pillar Plate, Steel plug, Brass plug, Bolt, G.I. Pipe~~  
 Height of mark  $1.365 \text{ m}$  above ~~below~~ ~~concrete~~; Mark is  $1.515 \text{ m}$  above G.L.  
 Height of Top Vanes to Top ~~Mast~~/Pillar plate  $1.100 \text{ m}$ . Diameter of Vanes (vertical)  $0.160 \text{ m}$ .  
 Height of Cairn  $0.000 \text{ m}$ . Diameter of Cairn  $0.000 \text{ m}$ . Name Plate ~~not placed~~/placed.  
 Length of Mast  $0.000 \text{ m}$ . (approximate if not unpiled)
4. A ~~concrete~~ ~~base~~ ~~set~~ in conc/~~rock~~ has been ~~placed~~/found, bearing  $230^\circ 0'$  from ~~base~~/plug/Pillar
5. A ~~G.I. Pipe~~ set in conc/~~rock~~ has been ~~placed~~/found, bearing  $281^\circ 0'$  from ~~base~~/plug/Pillar
6. A ~~concrete~~ ~~base~~ set in conc/~~rock~~ has been ~~placed~~/found, bearing  $165^\circ 0'$  from ~~base~~/plug/Pillar
7. A ~~concrete~~ ~~base~~ set in conc/~~rock~~ has been ~~placed~~/found, bearing  $0^\circ 0'$  from Mast/Plug/Pillar
8. Action required: ~~none obs. pillar~~

STANDPOINT: ~~none obs. pillar~~ STATION POINT: ~~lipped concrete base case~~

Mark	Direction	Horiz. Distance	Height Difference	Mark	Direction	Horiz. Distance	Height Difference
			above standpt. below standpt.				above standpt. below standpt.
Pretty Bull's BS (P)	0 00 00			Pretty Bull's BS (P)	0 00 00		
Lipped Nail in Base	21 06 30	3.11A	1.487 below standpt.	Lipped Nail in Base	67 53 45	4.269	0.030 below standpt.
Drake BS	13 27 08		above standpt.	Drake BS	115 31 08	3.078	1.451 above standpt.
G.I. Pipe in Base	249 07 00	3.583	1.107 below standpt.	G.I. Pipe in Base	134 28 10		above standpt.
Concrete Cairn Base	248 22 08	3.078	1.460 below standpt.	G.I. Pipe in Base	192 21 20	2.664	0.023 below standpt.
			above standpt. below standpt.				above standpt. below standpt.

Prepared by: P. Torres 3rd JULY 1985. Checked: P. Torres 31st JULY 1985. Noted on U.T.M. Card

SI 2733-1

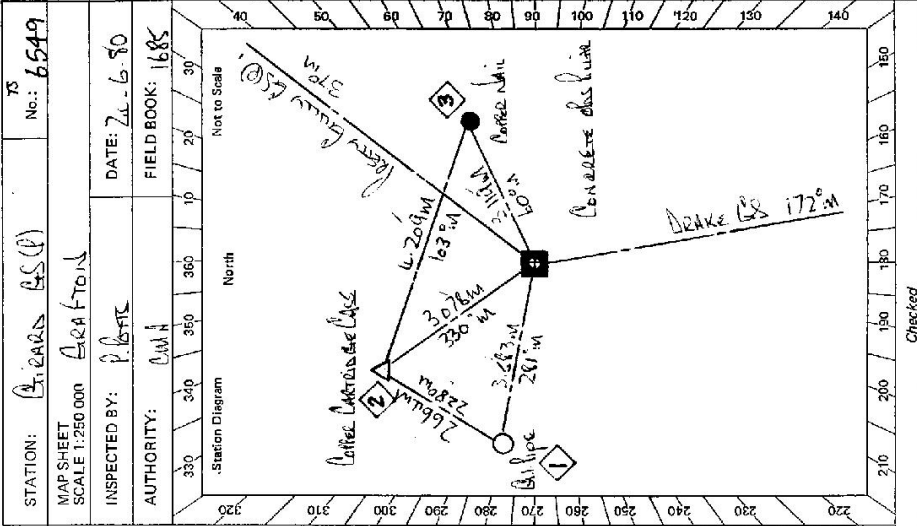

Checked

STATION **PEARL BR (P) TS-6549**

Owner's Name: **GONNET TENTERFIELD FORESTRY COMMISSION**  
 Address: **CHARLESTER BRIDGE STANSHAWTON BOKSHAW**  
 Phone: **BOKSHAW TR**  
 Current Occupant: .....  
 Address: .....  
 Phone: .....

**ACCESS**

Access Report of 28/6/1982 was found suitable/unsuitable.  
 KM FEATURE  
 0.00 TENTERFIELD TO HEAD NORTH TOWARDS STANTHORPE  
 0.19 TURN RIGHT ONTO BRUNNED H'WAY HEAD TOWARDS LANSING  
 39.00 BRIDGE OVER COOKED CREEK  
 40.22 TURN LEFT OFF H'WAY INTO RED ROCK ROAD  
 40.40 STRAIGHT AHEADS  
 41.18 GRID  
 41.56 PASS TRAILER ON RIGHT  
 41.97 PASS TRAILER ON RIGHT  
 43.40 TAKE RIGHT FORK  
 44.88 PASS PINCH FOREST ROAD ON RIGHT  
 46.31 GRID  
 47.32 TURN RIGHT AND CROSS GRID  
 47.53 PASS HALL STALLS ON RIGHT  
 48.05 STRAIGHT AHEADS INTERSECTION  
 48.79 TAKE LEFT FORK  
 49.68 GRID  
 50.22 TURN SHARP LEFT BACK UP (JUST BEFORE BLAZED TREE)  
 50.46 MAKE ONH WAY FOLLOWING PAINT TRAIL + BLAZES  
 50.46 TRAIL

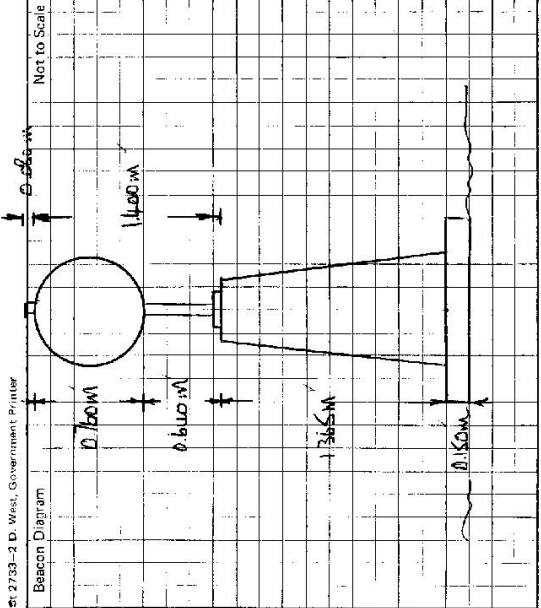

This section to be completed by officer constructing pillar.

Original station mark found/.....  
 Description of mark: **COPPER CARTRIDGE CASE**  
 Original beacon found/.....  
 Description of beacon: **WOOD POLE AND DISC**  
 Height Top of Vanes to Top Mark: **3.42m**  
 Height of mark: **1.16m** above G.L., **1.16m** below G.L.  
 Diameter of Vanes: **0.170m**  
 Height of Cairn: **1.16m**  
 Original Beacon has/..... been destroyed by me.

Date: ..... Record of Station: .....