

7498

CENTRAL MAPPING AUTHORITY
Department of Lands

Trigonometrical Survey of N.S.W.

RECONNAISSANCE and MAINTENANCE REPORT

This Trig. Station has been:-

Note: Cross out word or words which do not apply

1. Completely cleared to permit 360° vision to surrounding Trigs.
2. Cleared by lanes bearing... 60° 50' to 195° 00' from Trig. Mast
3. Trig. Mast & Vanes have been painted white & black respectively.
4. The Trig. was unpiled/net-worked, dimensions now being:



- Description of mark: BRASS PIPE SUPPORTING MAST, should be explicit, e.g. Steel plug, Brass plug, Bolt, G.I. Pipe
- Height of mark: 2.300 m above below G.I.
- Height of Top Vanes to Top Mark: 4.110 m ✓ Diameter of Vanes (vertical): 0.900 m.
- Height of Centre: m. Diameter of Centre: m.
- Length of Mast: m. (approximate if not unpiled)

5. A. S.S.M. set in conc/rock has been placed 3.130 m, bearing 174° from Trig. Mast
6. A. brick set in conc/soil has been placed 3.145 m, bearing 65° from Trig. Mast
7. A. set in conc/soil has been placed m, bearing° from Trig. Mast
8. A. set in conc/rock has been placed m, bearing° from Trig. Mast

9. Connection to m, bearing°
10. Connection to m, bearing°
11. Connection S.S.M. to brick 5.135 m, bearing 25°
12. Connection to m, bearing°
13. Diff. Ht. BRASS PLATE is 0.250 m above below S.S.M. in conc.
14. Diff. Ht. BRASS PLATE is 0.240 m above below G.I.P. in conc.
15. Diff. Ht. S.S.M. in conc. is 0.010 m above below G.I.P. in conc.
16. Diff. Ht. is m, above below

Prepared by: D.W. FREDRIKSEN Checked: F.K. Broman 5/8/25 Mtd on U.T.M. Card

STATION ALICE TS (QUINDRIPS) 6537

Co: DRONE / Phi: M.M.I.T.S.N. /

Map Sheet: LORDAIRE / No: 9435/N

Inspected by: P. PATTS & J. SHARVIN / Date: 19/05/25

Authority C.M.A. 72/73 / Field Book: CS 289

Scale: 1:2500

Beacon Diagram

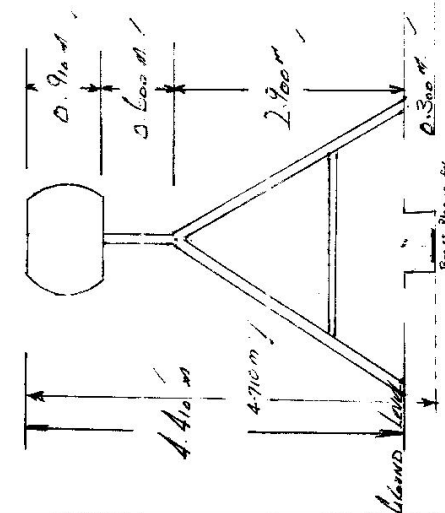

Record of Station

Date	Remarks

Checked: F.K. Broman

STATION ALICE TS (QUAD R.D.) 6537

Owners Name: Mr. L. M. HART Current Occupant:

Address: RAILWAY STATION Address:

TARBURTON
1-3-75
Access MILES.

FEATURE
 0.00 WOODEN BRIDGE OVER CARRON CREEK AT MINE (YATES CROSSING)
 0.80 PASS ROAD ON RIGHT HAND SIDE
 1.10 PASS ROAD ON LEFT SIDE SAYS "EQUIVOCAL"
 1.15 END OF SEALED ROAD
 1.50 STEEL CRIB
 2.15 STEEL CRIB
 2.55 WOODEN BRIDGE
 2.60 STEEL CRIB
 3.20 WOODEN BRIDGE OVER MOUNTAIN WASHLET CREEK
 3.25 STEEL CRIB
 4.40 TURN RIGHT BEFORE CRIB (OLD TINK CRIB)
 4.50 WOODEN CRIB
 4.55 TURN RIGHT ALONG STEEL CRIB AND IMMEDIATELY TAKE LEFT AND FOLLOW FENCE
 4.70 FOLLOW FENCE AND BEHIND TROIL
 5.10 TRAIL

To Get to Mt. Harts from wooden crib at 4.50 follow road down to horse
0.80 down rd.

Stations Useable from mine are

BRID TS. 336° MISERY TS. 40° BELMORE EAST TS. 96°
CHURCH HILL ONLY 341° PEARSON HILL ONLY ? 72°
BY PEARSON HILL ONLY 13° PEARSON FIRE TOWER. 85°

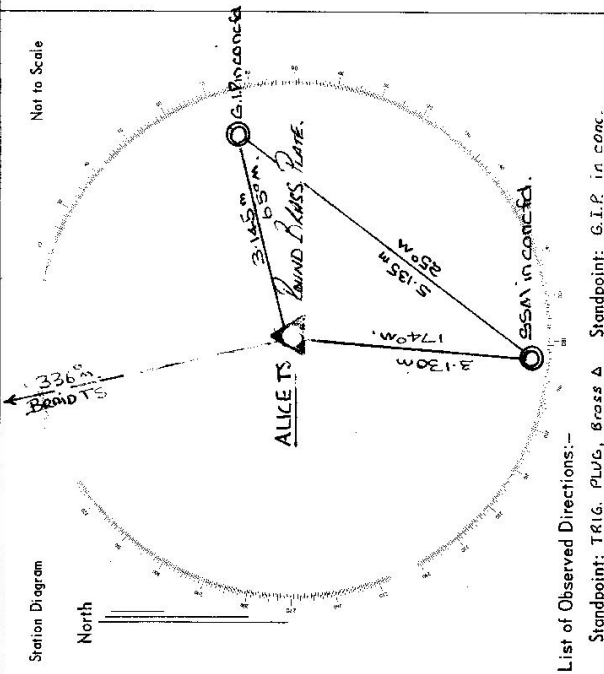

List of Observed Directions:-

Standpoint: TRIG. PLUG, BRASS A Standpoint: G.I.P. in conc.

Station	Direction	Station	Direction
BRID	T.S. 0°00'00"	BRID	T.S. 0°00'00"
G.I.P. in conc. fd	88°43'	S.M. in conc. fd	233°44'30"
S.M. in conc. fd	198°36'	TRIG. PLUG, BRASS A	268°44'
Station	Direction	Station	Direction

CENTRAL MAPPING AUTHORITY

GEODETIC SURVEY OF N.S.W.

GEODETIC STATION RECONNAISSANCE and MAINTENANCE REPORT

Description: *Note: Cross out word or words which do not apply*

1. Cleared by lanes bearing..... from Trig. Mast
2. Mast & Vanes have been painted white & black respectively.
3. The station ~~letter~~ was unpiled/~~not unpiled~~/~~reinstated~~ on 10 - 10 - 1979, dimensions now being: BRASS ARMY SURVEY PLaque should be explicit, e.g., S/Steel Pillar Plate, Steel plug, Brass plug, Bolt, G.I. Pipe
 Description of mark: FLUSH ^{above} rock/concrete; Mark is 0.30 m. ^{below} G.L.
 Height of mark.....m. Diameter of Cairn.....m. Name Plate ~~found~~/not found/~~placed~~.
 Height of Top Vanes to Top Mark/Pillar plate 1.720 m. Diameter of Vanes (vertical).....m. 0.910 m.
 Height of Cairn.....m. Diameter of Cairn.....m. Name Plate ~~found~~/not found/~~placed~~.
 Length of Mast.....m. (approximate if not unpiled)
4. A.....set in conc/rock has been placed/found, bearing.....°M from Mast/Plug/Pillar
5. A.....set in conc/rock has been placed/found, bearing.....°M from Mast/Plug/Pillar
6. A.....set in conc/rock has been placed/found, bearing.....°M from Mast/Plug/Pillar
7. A.....set in conc/rock has been placed/found, bearing.....°M from Mast/Plug/Pillar
8. Action required:.....

STANDPOINT:

Mark	Direction	Horiz. Distance	Height Difference	Mark	Direction	Horiz. Distance	Height Difference
			above standpt				above standpt
			below				below
			above standpt				above standpt
			below				below
			above standpt				above standpt
			below				below
			above standpt				above standpt
			below				below
			above standpt				above standpt
			below				below
			above standpt				above standpt
			below				below

Prepared by: *[Signature]*

Checked: *[Signature]*

2 | 11 | 79

Noted on U.T.M. Card

Checked

STATION: ALICE * No.: 6537
 MAP SHEET SCALE 1:250 000 GRAFTON
 INSPECTED BY: M.L. Morrison DATE: 10/10/79
 AUTHORITY: C.M.A. FIELD BOOK: 1798

Station Diagram

North

Not to Scale

320 330 340 350 360 370 380 390 400

220 230 240 250 260 270 280 290 300 310

40 50 60 70 80 90 100 110 120 130 140

150 160 170 180 190 200 210

TRIG. FOUND GOOD ORANGE
ARMY SURVEY PLaque FD (TRIG)
G.I. PIPE in conc for 65m 3.14m
S.S. M. in conc for 172m 3.13m
Beacon is a Steel Quadrant.
Concrete Pillar Possible.
Abt 1 hour clearing required.
+
Permission to Pillar and to
Clear obtained from owner.
Please notify when work starting.

6-2735-2 D. West, Government Printer

<p>STATION ALICE * 6537</p> <p>Owner's Name: <u>MR L.W. HART</u> Address: <u>PLAIN STATION</u> <u>TABULAM</u> Phone:</p> <p>Current Occupant: <u>DUNN</u> Address:</p> <p>Phone: <u>10-10-79</u> <u>18-1-80</u></p> <p>ACCESS Access Report of <u>L.L.B. / 19/8</u> was found suitable/..... <u>DIRECTION</u></p> <p><u>0.00</u> ON BOUNDARY ONLY 3.5 Km WEST OF TABULAM AT SIGN ZENTBERHELD 71 2520061 <u>EWINGAR 26</u> TAKE RD SOUTH TO EWINGAR <u>2.85</u> PASS CHAUVEL RD ON LEFT. <u>14.65</u> JUST AFTER OLD TICK GATE FOLLOW TRACK/PAST HOUSE ON LEFT. <u>14.85</u> JUST AFTER GRID TAKE 2ND GATE ON RIGHT + FOLLOW FAINT TRACK + FENCE <u>15.00</u> UP RIDGE. (STRAIGHT AHEAD AFTER GRID TOOKNER'S PLACE) <u>TRIG.</u></p>	<table border="1" style="width:100%; border-collapse: collapse;"> <thead> <tr> <th style="width: 50%;">Date</th> <th style="width: 50%;">Record of Station</th> </tr> </thead> <tbody> <tr><td> </td><td> </td></tr> <tr><td> </td><td> </td></tr> <tr><td> </td><td> </td></tr> <tr><td> </td><td> </td></tr> <tr><td> </td><td> </td></tr> <tr><td> </td><td> </td></tr> <tr><td> </td><td> </td></tr> <tr><td> </td><td> </td></tr> <tr><td> </td><td> </td></tr> <tr><td> </td><td> </td></tr> </tbody> </table>	Date	Record of Station																				
Date	Record of Station																						

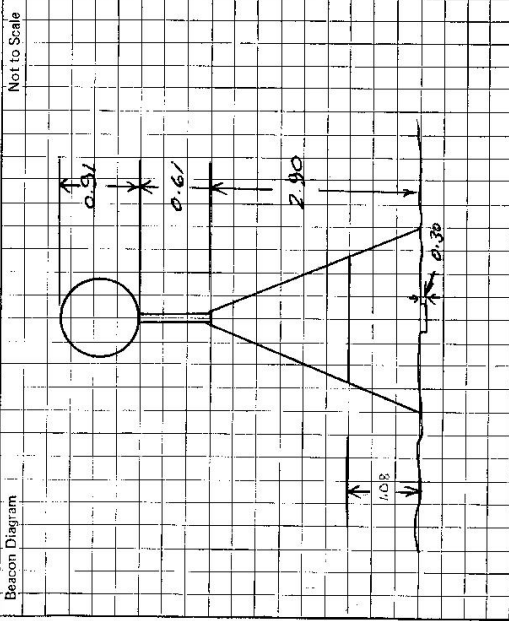

This section to be completed by officer constructing pillar.

Original station mark found/~~not found~~:

Description of mark: BEARS ARMY SURVEY PILLAR

Original beacon found/not found:

Description of beacon:

Height Top of Vanes to Top Mark: m.

Height of mark: m. above / below G.L.

Diameter of Vanes: m. Height of Cairn: m.

Original Beacon hat/has not been destroyed by me.

GEODETIC SURVEY OF A.S.I.W.

CENTRAL MAPPING AUTHORITY

GEODETIC STATION RECONNAISSANCE and MAINTENANCE REPORT

Description:

1. Cleared by James bearing 216° 127° M. Note: Cross out word or words which do not apply

2. Mast & Vanes have been painted white & black respectively.

3. The ~~station~~ pillar was ~~replaced~~ constructed on 13^{th} May 1982. dimensions now being:

Description of marks: ~~S.I. Pipe~~ ~~Block~~ should be explicit, e.g., S/Steel Pillar Plate, Steel plug, Brass plug, Bolt, G.I. Pipe

Height of mark: 1.358 m. above ~~base~~ ~~below~~ concrete; Mark is 1.358 m. above G.L.

Height of Top Vanes to Top Mast/Pillar plate 1.445 m. Diameter of Vanes (vertical) 159 mm.

Height of Cairn 1.358 m. Diameter of Cairn 159 mm. Name Plate ~~not~~ placed.

Length of Mast 1.545 m. (approximate if not stated)

* Shows only Australian Navy Survey Station

4. ~~A.S.I.W. Pillar~~ set in conc/rock has been placed/observed, bearing 147° M from Mast/Plug/Pillar

5. A. S.S.M. set in conc/rock has been placed/observed, bearing 163° M from Mast/Plug/Pillar

6. A. G.I. Pipe set in conc/rock has been placed/observed, bearing 182° M from Mast/Plug/Pillar

7. A. set in conc/rock has been placed/observed, bearing 182° M from Mast/Plug/Pillar

8. Action required: Name plate to be placed.

Mark	Concrete Observation			STANDPOINT: Trig. Plug			
	Direction	Horiz. Distance	Height Difference	Mark	Direction	Horiz. Distance	Height Difference
BREAD G.S.	0 00 00		above standpt.	BREAD G.S.	0 00 00		above standpt.
PICKERNE FIRE TOWER	109 15 10		above standpt.	G.I. Pipe	88 46 52	3.158	below standpt.
G.I. pipe	121 17 54.5	4.287	below standpt.	PICKERNE FIRE TOWER	109 14 28.5		above standpt.
Trig. Plug	170 48 36.5	2.518	below standpt.	S.S.M.	198 36 59	3.128	above standpt.
S.S.M.	186 14 16	5.486	below standpt.	BLOXSBOME G.S.	289 21 26.5		above standpt.
BLOXSBOME G.S.	266 20 57		above standpt.	Cont. Obs. Pillar	350 48 33	2.521	below standpt.

Prepared by: Noted on U.T.M. Card

Checked:

Checked

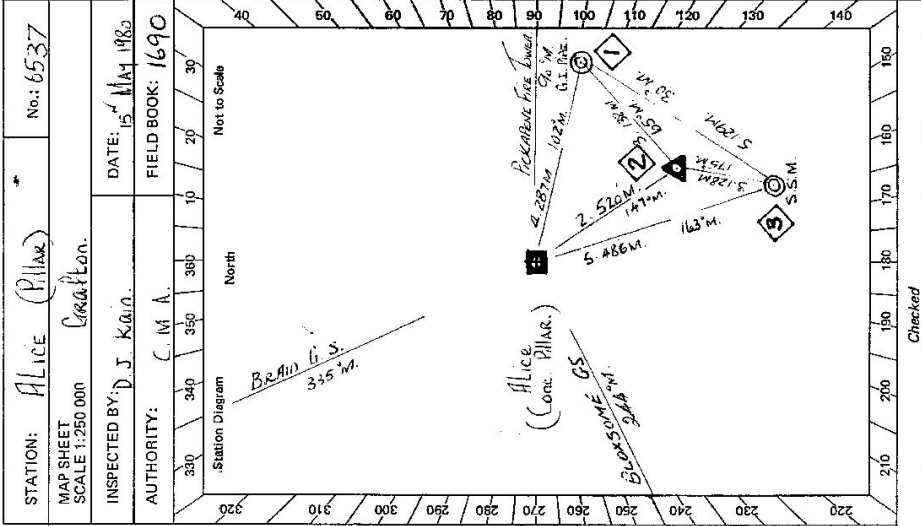

W.

sr-2733-2 D. West, Government Printer

STATION	Alice (Pillar) * 6537
Owner's Name: MR. L. W. HAST	Current Occupant: G. MILLER
Address: PLAIN STATION TABULAM	Address:
Phone:	Phone:
Access Report of 18.1.1980 was found suitable/unsuitable.	ACCESS 15-5-80
Access to Alice (Pillar) FEATURE	
Kms	
0.0 On Brixner Highway 3.50 Kms West of Tabulam at sign, Tenterfield T, CRINO G1, EWINGAR 26, TAKE ROAD TO EWINGAR.	
2.85. Pass Channel Road on Left.	
14.65 Just After old Tick Gate, follow Track Rise house on Your Left.	
14.85 Just After Grid Take Second (2nd) Double Iron gates on Your Right & follow faint track up ridge & along fence.	
15.40 Note:- Travel straight ahead after Grid to owners house. Concrete observation pillar.	

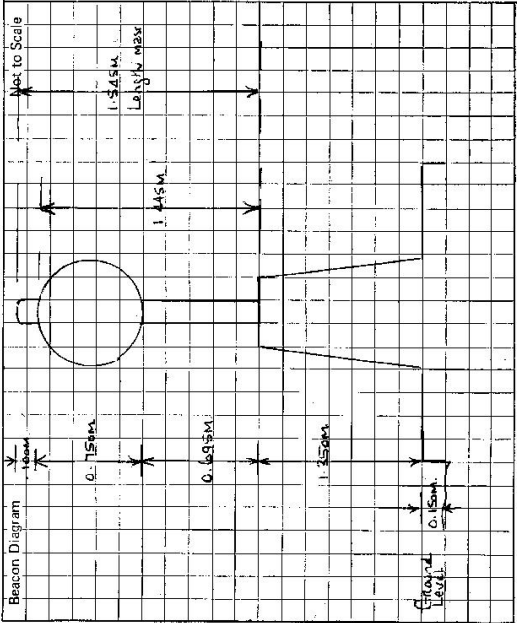

This section to be completed by officer constructing pillar.

Original station mark found/recovered.
Beacon PLAGE

Description of mark: this station is a ... Station

Original beacon found/recovered.

Description of beacon: Iron ... Vane

Height Top of Vane to Top Mark: 4.700 m

Height of mark: 1.981 m above/below G.L.

Diameter of Vane: 0.110 m

Height of Cairn: ... m

Original Beacon has/has not been destroyed by me.

Date	Record of Station