

GEODETTIC SURVEY OF N.S.W.

CENTRAL MAPPING AUTHORITY

GEODETTIC STATION RECONNAISSANCE and MAINTENANCE REPORT

Description:

1. Cleared by lanes bearing.....  
 Note: Cross out word or words which do not apply

2. Mast & Vanes have been painted white & black respectively.

3. The station/~~plate~~ was applied/hot unpiled/~~constructed~~ on..... 19....., dimensions now being:

Description of mark..... should be explicit, e.g., S/Steel Pillar Plate, Steel plug, Brass plug, Bolt, G.I. Pipe

Height of mark..... m. <sup>above</sup>/<sub>below</sub> rock/concrete; Mark is..... m. <sup>above</sup>/<sub>below</sub> G.L.

Height of Top Vanes to Top Mark/~~Plate~~..... m. <sup>above</sup>/<sub>below</sub> Diameter of Vanes (vertical)..... 0.920 m.

Height of Cairn..... m. Diameter of Cairn..... 2.1 m. Name Plate ~~found~~/not found/~~placed~~.

Length of Mast..... 5.4 m. (approximate if not unpiled)

4. A..... 5.5 M..... set in conc/~~reek~~/~~has been placed~~/found, bearing..... 56.....° M from Mast/Plug/Pillar

5. A..... ~~Steel Plug~~..... set in conc/~~reek~~/~~has been placed~~/found, bearing..... 312.....° M from Mast/Plug/Pillar

6. A..... set in conc/rock has been placed/found, bearing.....° M from Mast/Plug/Pillar

7. A..... set in conc/rock has been placed/found, bearing.....° M from Mast/Plug/Pillar

8. Action required: ~~1/2 day clearing~~ / ~~to clear~~.....

STANDPOINT:

Mark	Direction	Horiz. Distance	Height Difference	Mark	Direct on	Horiz. Distance	Height Difference
			above standpt.				above standpt.
			below standpt.				below standpt.
			above standpt.				above standpt.
			below standpt.				below standpt.
			above standpt.				above standpt.
			below standpt.				below standpt.
			above standpt.				above standpt.
			below standpt.				below standpt.

Prepared by: J Fanning.

Checked: W. Jeffrey

Noted on U.T.M. Card

S:2733-1

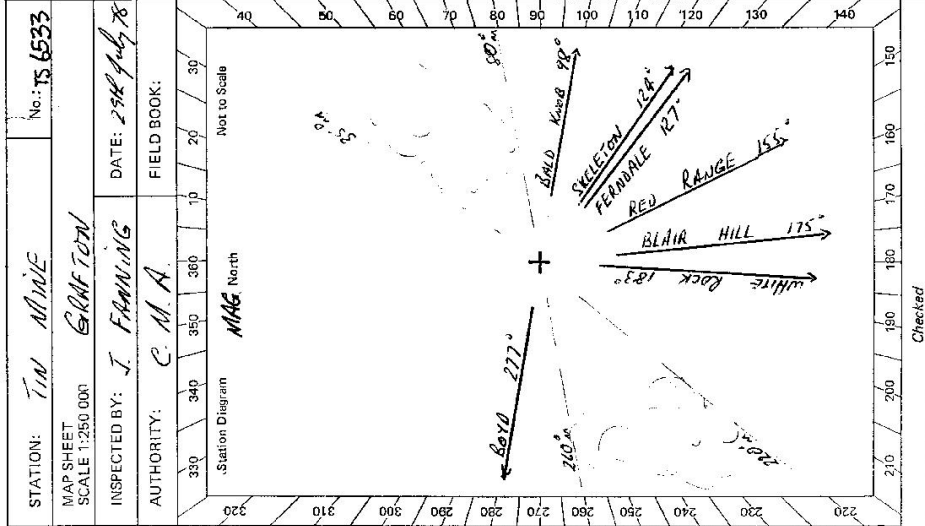

Checked

STATION: TIN MINE

MAP SHEET SCALE 1:250 000

INSPECTED BY: J FANNING

DATE: 29th July 78

AUTHORITY: C.M.A.

FIELD BOOK:

Station Diagram

North

MAG

Not to Scale

320

330

340

350

360

370

380

390

400

410

420

430

440

450

460

470

480

490

500

510

520

530

540

550

560

570

580

590

600

610

620

630

640

650

660

670

680

690

700

710

720

730

740

750

760

770

780

790

800

810

820

830

840

850

860

870

880

890

900

910

920

930

940

950

960

970

980

990

1000

1010

1020

1030

1040

1050

1060

1070

1080

1090

1100

1110

1120

1130

1140

1150

1160

1170

1180

1190

1200

1210

1220

1230

1240

1250

1260

1270

1280

1290

1300

1310

1320

1330

1340

1350

1360

1370

1380

1390

1400

1410

1420

1430

1440

1450

1460

1470

1480

1490

1500

1510

1520

1530

1540

1550

1560

1570

1580

1590

1600

1610

1620

1630

1640

1650

1660

1670

1680

1690

1700

1710

1720

1730

1740

1750

1760

1770

1780

1790

1800

1810

1820

1830

1840

1850

1860

1870

1880

1890

1900

1910

1920

1930

1940

1950

1960

1970

1980

1990

2000

2010

2020

2030

2040

2050

2060

2070

2080

2090

2100

2110

2120

2130

2140

2150

2160

2170

2180

2190

2200

2210

2220

2230

2240

2250

2260

2270

2280

2290

2300

2310

2320

2330

2340

2350

2360

2370

2380

2390

2400

2410

2420

2430

2440

2450

2460

2470

2480

2490

2500

2510

2520

2530

2540

2550

2560

2570

2580

2590

2600

2610

2620

2630

2640

2650

2660

2670



TS 6533

STATION: *TID MINE G.S.* No: *4384*

MAP SHEET SCALE 1:250 000

INSPECTED BY: *J. FANNING* DATE: *11 May 79*

AUTHORITY: *C.M.A.* FIELD BOOK: *1753*

CENTRAL MAPPING AUTHORITY GEODETIC SURVEY OF N.S.W. GEODETIC STATION RECONNAISSANCE and MAINTENANCE REPORT

Description: *Note: Cross out word or words which do not apply*

1. Cleared by lanes bearing *260° + 3s. m* *80° - 220. m* from Trig. Mast

2. Mast & Vanes have been painted white & black respectively.

3. The station ~~height~~ ~~was supplied~~ ~~not unpiled~~ ~~constructed~~ on *11.12 May* 19.79, dimensions now being:

Description of mark.....should be explicit, e.g., S/Steel Pillar Plate, Steel plug, Brass plug, Bolt, G.I. Pipe

Height of mark.....m. above rock/concrete; Mark is.....m. above G.L.

Height of Top Vanes to Top Mark/Pillar plate.....m. Diameter of Vanes (vertical).....*0.822*..m.

Height of Cairn.....*1.35*..m. Diameter of Cairn.....*2.1*..m. Name Plate found/not found/placed.

Length of Mast.....*3.47*..m. (approximate if not unpiled) ✓

4. A.....*Steel! Plug*.....set in concrete ~~has been placed~~ found, bearing.....*132*° M from Mast/~~Plug/Pillar~~ } *id sta 60*

5. A.....*S.S.A.*.....set in conc/~~rock has been placed~~ found, bearing.....*236*° M from Mast/~~Plug/Pillar~~

6. A.....set in conc/rock has been placed/ found, bearing.....° M from Mast/Plug/Pillar

7. A.....set in conc/rock has been placed/ found, bearing.....° M from Mast/Plug/Pillar

8. Action required: *Erect Conc. Pillar*

Trigs sighted

Mark	GRID	Horiz. App. Distance	Height Difference	Mark	GRID	Horiz. App. Distance	Height Difference
<i>East Ridge</i>	<i>42°</i>	<i>9</i>	above standpt.	<i>Wood</i>	<i>287</i>	<i>6</i>	above standpt.
<i>Bald slab</i>	<i>100</i>	<i>9</i>	above standpt.	<i>Redoo</i>	<i>337</i>	<i>9</i>	above standpt.
<i>Skeleton</i>	<i>133</i>	<i>3</i>	above standpt.	<i>Hinkler</i>	<i>269</i>	<i>8</i>	if mast & vanes erected
<i>Red Range</i>	<i>164</i>	<i>14</i>	above standpt.				above standpt.
<i>Nightcap</i>	<i>171</i>	<i>39</i>	above standpt.				above standpt.
<i>Mitchell</i>	<i>182</i>	<i>42</i>	above standpt.				above standpt.
<i>White Rock</i>	<i>193</i>	<i>13</i>	above standpt.				above standpt.

Prepared by: *J. FANNING*

Checked:

Noted on U.T.M. Card

Checked

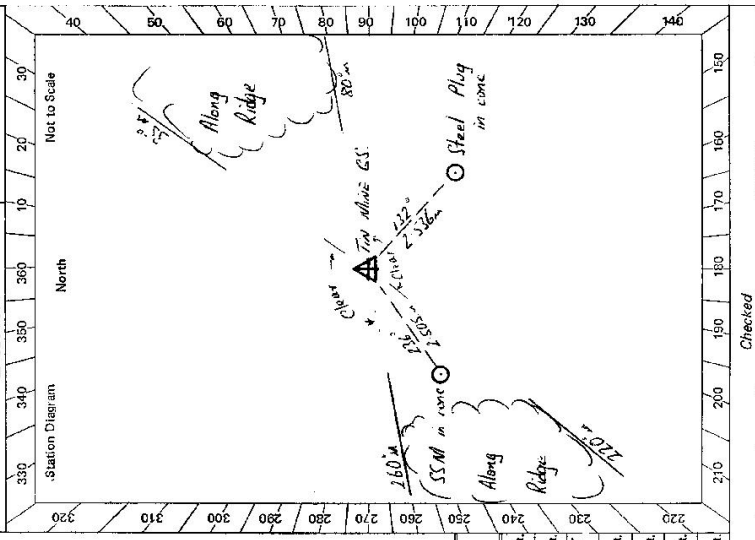

CENTRAL MAPPING AUTHORITY

GEODETIC SURVEY OF N.S.W.

GEODETIC STATION RECONNAISSANCE and MAINTENANCE REPORT

Description:

1. Cleared by Janes bearing  $260^{\circ}30'$ ,  $65^{\circ}70'$ ,  $73^{\circ}212'$  from Trig. Mast  
 Note: Cross out word or words which do not apply
2. Mast & Vanes have been painted white & black respectively.
3. The station/pillar was unpiled/not unpiled/constructed on  $12^{\circ}$ ,  $2^{\circ}$ ,  $19^{\circ}30'$ , dimensions now being:  
 Description of mark SS PLATE should be explicit, e.g., S/Steel Pillar Plate, Steel plug, Brass plug, Bolt, G.I. Pipe  
 Height of mark  $1.375$  m. above reek/concrete; Mark is  $1.525$  m. above G.L.  
 Height of Top Vanes to Top Mark/Pillar plate  $1.420$  m. Diameter of Vanes (vertical)  $0.770$  m.  
 Height of Cairn  $1.500$  m. Diameter of Cairn  $1.500$  m. Name Plate found/not found/placed.  
 Length of Mast  $1.500$  m. (approximate if not unpiled)
4. A S/S PIN set in conc/reek has been placed/found, bearing  $175^{\circ}$  M from Mast/Plug/Pillar
5. A S.S.M set in conc/reek has been placed/found, bearing  $229^{\circ}$  M from Mast/Plug/Pillar
6. A CARRIAGE CASE set in conc/reek has been placed/found, bearing  $237^{\circ}$  M from Mast/Plug/Pillar
7. A CARRIAGE CASE set in conc/reek has been placed/found, bearing  $237^{\circ}$  M from Mast/Plug/Pillar
8. Action required:

STANDPOINT: CONCRETE PILLAR

STANDPOINT: CARRIAGE CASE

Mark	Direction	Horiz. Distance	Height Difference	Mark	Direction	Horiz. Distance	Height Difference
EAST RIDGE GS	359 59 60		above standpt.	EAST RIDGE GS	359 59 60		above standpt.
SKELTON PILLAR	89 59 46		above standpt.	TIN MINIE PILLAR	26 49 35		above standpt.
S/S PIN	143 56 35	2.532	1.576 below standpt.	SKELTON PILLAR	89 56 65		above standpt.
S.S.M	199 45 36	47.95	1.529 below standpt.	S/S PIN	89 26 26	2.539	above standpt.
CARRIAGE CASE	206 47 49	2.323	1.755 below standpt.	S.S.M	193 11 15	2.505	above standpt.
			above standpt.				below standpt.
			above standpt.				below standpt.
			above standpt.				below standpt.

Prepared by:

Checked: *D. J. ...* 2/15/80 Noted on U.T.M. Card

S: 2793-1

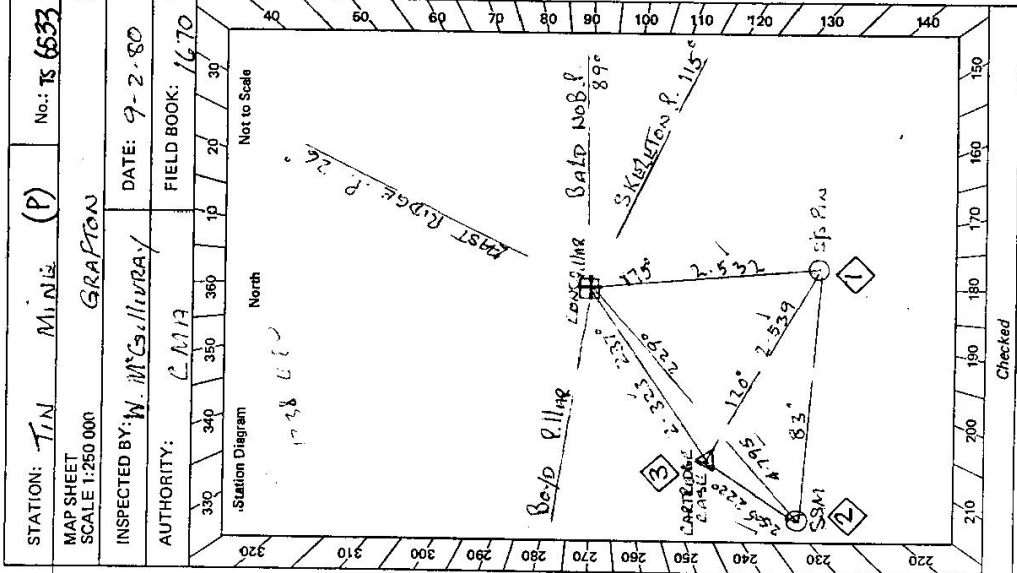

Checked

SI-2733-2 D. West, Government Printer

STATION <b>TIN MINIE (P)</b> TS <b>6533</b>	Owner's Name: <b>DR. VICTOR EMBLAZ</b> Address: <b>KIENST PARK</b> Phone: <b>6468 1111</b> ACCESS Access Report of <b>11.5/1987</b> was found suitable/unsuitable.
Beacon Diagram Not to Scale	
This section to be completed by officer constructing pillar.	
Original station mark found/not found.	
Description of mark: <b>CONCRETE CASE IN CONC</b>	
Original beacon found/not found.	
Description of beacon: <b>CONCRETE CASE IN CONC</b>	
Height Top of Vanes to Top Mark: <b>3.570</b> above/below G.L.	
Height of mark: <b>0.30</b> above/below G.L.	
Diameter of Vanes: <b>2.940</b>	
Original Beacon has/had not been destroyed by me.	
Date	Record of Station

St. 2733-2 D. West. Government Printer Beacon Diagram Owners Property On Glen Innes rd → Red Range rd. 3 km on R.H.S. from New England Highway	Not to Scale 	STATION <b>TIN MINE G.S. TS 6533</b> Owner's Name: <b>Dr. Victor Eady</b> Address: <b>"Kent Park" (Property)</b> Phone: <b>Glen Innes 2</b> ACCESS Access Report of 22.7.1988 was found <del>attached</del> (unstable). 0 20 Glen Innes Post Office. Travel east on Gwydir H-way 22 1 Turn left through double iron gate off road (Part of El Dorado Property) Follow track. Pass steering sled LHS 22 86 Iron gate. Cross chain wall 23 16 Take track to right 23 23 Iron gate. Turn left around rocks head in direction 312 m to Large Blazed Tree 23 66 Large blazed tree. Turn left follow front track 24 00 Top of spur turn right follow blazed trail 24 35 Iron gate turn left 24 42 Wood gate follow blazed trail to trig 25 21 Tin Mine G.S.	Owner has no objection to necessary clearing & erecting a pillar ✓ Phone: <b>4WD 11-5-1979</b>	Date 2/5/79 Written permissions received 2/5/79 (see 55/11 file)	Record of Station
This section to be completed by officer constructing pillar.		Original station mark found/not found.			
Description of mark:		Original beacon found/not found.			
Description of beacon:		Height Top of Vanes to Top Mark .....m. Height of mark.....m. above G.L. below Diameter of Vanes .....m. Height of Cairn .....m. Original Beacon has/has not been destroyed by me.			