

TS-6504

STATION: GLEN ELGIN C.S. No.: 2214

MAP SHEET SCALE 1:250 000 GRAFTON SH 56-6

INSPECTED BY: K. THOMPSON DATE: 15-5-79

AUTHORITY: C.M.A. FIELD BOOK: 75211

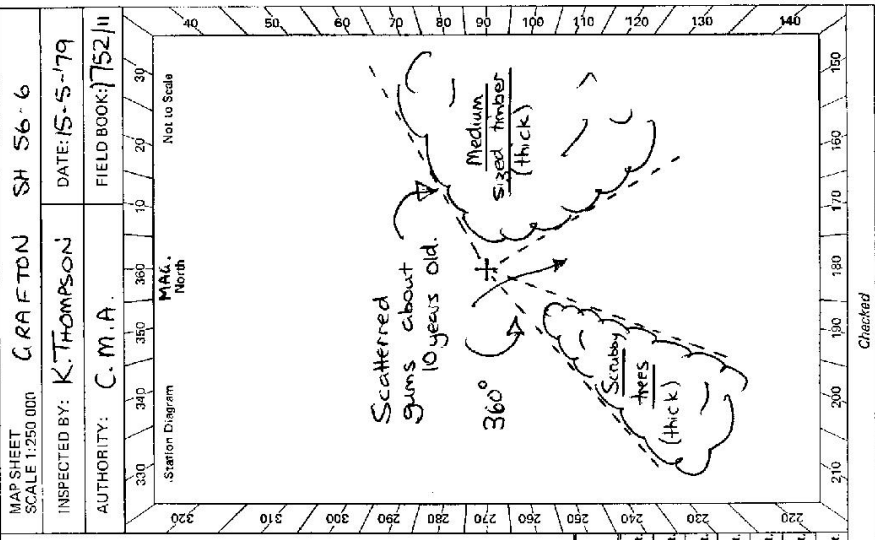

Mark	Direction	Horiz. Distance	Height Difference	Mark	Direction	Horiz. Distance	Height Difference
			above standpt.				above standpt.
			below				below
			above standpt.				above standpt.
			below				below
			above standpt.				above standpt.
			below				below
			above standpt.				above standpt.
			below				below
			above standpt.				above standpt.
			below				below
			above standpt.				above standpt.
			below				below

Description: Note: Cross out word or words which do not apply

1. Cleared by ~~hoses-bearing~~ from ~~Flag-Mast~~

2. Mast & Vane have been painted white & black respectively.

3. The station/pillar was unspiled/not unspiled/constructed on 15th MAY 1979, dimensions now being:

Description of mark: should be explicit; e.g. S/Steel Pillar Plate, Steel plug, Brass plug, Bolt, G.I. Pipe

Height of mark: m. above rock/concrete; Mark is m. m. below

Height of Top Vanes to ~~Top Mast/Pillar-plate~~ 3.7 m. Diameter of Vanes (vertical) 0.9 m.

Height of Cairn: 1.4 m. Diameter of Cairn: 2.1 m. Name Plate found/not found/placed.

Length of Mast: 3.7 m. (approximate if not unspiled)

4. A. C.I. Pipe set in conc/rock has been placed/found, bearing 21° M from Mast/Plug/Pillar

5. A. Copper Nail set in conc/rock has been placed/found, bearing 127° M from Mast/Plug/Pillar

6. A. set in conc/rock has been placed/found, bearing ° M from Mast/Plug/Pillar

7. A. set in conc/rock has been placed/found, bearing ° M from Mast/Plug/Pillar

8. Action required: Clearing of scattered gums about 2 days. Pillar

STANDPOINT:

Prepared by: K. Thompson

Checked: 24/9/79

Noted on U.T.M. Card

Checked

Station Diagram

MAP North

Not to Scale

Prepared by: K. Thompson

Checked: 24/9/79

Noted on U.T.M. Card

Checked

St 2733-1

66-2713-2 D. West, Government Printer

STATION **GLEN ELGIN G.S. IS-6504**

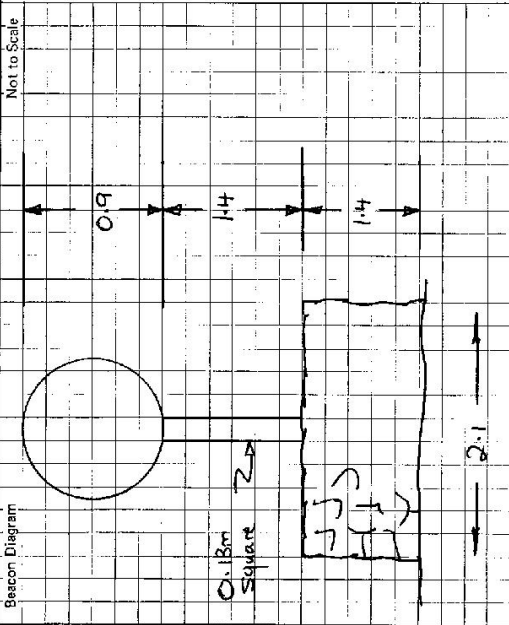

Owner's Name: J.A. Slane
 Address: Karanga (R. Property)
 Phone: 344136
 Current Occupant: Parents consent to
 Address: Pho & any clearing
 Phone: accessary
 ACCESS 15-5-1979

Access Report of 15-5-1979 was found suitable/unavailable.

Feature

Glen Innes P.O. Head towards Crofton for 35km

Left turn of Gwydir Highway S.P. "Glen Elgin 13km"

Bridge "Old Man Swamp"

Creek

School on right

wooden bridge

grid

wooden bridge

right turn onto track through timber

take right fork

ford

wooden gate, follow fence straight ahead

rough wooden bridge

take left fork

Iron gate, follow faint track (NE) through clear paddock towards timber

Slip rails

right turn away from creek, follow rough blazed track up ridge

Dingo fence. Walk 5min along easy trail.

Access Owners Property
 0.0 Under Auto Eick travel South
 1.0 Turn left sign "Ball 268"
 2.5 Pass road to left
 3.1 Take road to left
 9.1 Gate house R.H.S.

- 0 km
- 0.05
- 11.6
- 14.3
- 15.95
- 16.15
- 16.3
- 16.65
- 17.1
- 17.15
- 17.25
- 17.35
- 19.15
- 19.3
- 19.9
- 20.9
- 21.3
- 22.1

This section to be completed by officer constructing pillar.

Original station mark found/not found.

Description of mark:

Original beacon found/not found.

Description of beacon:

Height Top of Vanes to Top Mark:m.

Height of mark:m. above G.L. /m. below G.L.

Diameter of Vanes:m. Height of Cairn:m.

Original Beacon has/tas not been destroyed by me.

Date	Record of Station

STATION TS 2245 GLENFELDS 6504
 CO: CUMBERLAND Ph: ST LUKE
 Map Sheet: LEPPINGTON 1:10,000 No: 4237
 Inspected by: C. STARKY Date: 30-7-19
 Authority: LANDS DEPT Field Book: 1AOS
 Beacon Diagram Not to Scale
NO BEACON

Department of Lands
 Integral survey of N.S.W.
 RECONNAISSANCE and MAINTENANCE REPORT

This Trig. Station has been: - Note: Cross out word or words which do not apply

- 1. Completely cleared to permit 360° vision to surrounding Trigs.
- 2. ~~Cleared~~ by lances bearing from Trig. Mast
- 3. Trig. Mast & Vanes have been painted white & black respectively.

4. The Trig. was unpiled/~~not completed~~, dimensions now being: PLUG IN PM BOX, should be explicit, e.g. Steel plug, Brass plug, Bolt, Concrete Pillar

Description of mark, PLUG IN PM BOX, should be explicit, e.g. Steel plug, Brass plug, Bolt, Concrete Pillar

Height of mark, m above below m above below G.L.

Height of Top Vanes to Top Mark/Top pillar plate m Diameter of Vanes (vertical) m.

Height of Cairn m. Diameter of Cairn m.

Length of Mast m. (approximate if not unpiled)

- 5. A SSM set in conc/~~rock~~ has been placed/fd 1.618 m, bearing 305 ^{PLUG} ~~0~~ M from Trig. Mast/~~pillar~~
- 6. A GA PIPE set in conc./soil has been placed 1.354 m, bearing 250 ^{PLUG} ~~0~~ M from Trig. Mast/~~pillar~~
- 7. A set in conc./soil has been placed/fd m, bearing °M from Trig. Mast/pillar
- 8. A set in conc./rock has been placed/fd m, bearing °M from Trig. Mast/pillar
- 9. Connection SSM to GA PIPE : 1.143 m, bearing 186 °M
- 10. Connection to m, bearing °M
- 11. Connection to m, bearing °M
- 12. Connection to m, bearing °M
- 13. Diff. Ht. SSM is 0.028 m. ^{TRIG PLUG} ~~TRIG PLUG~~
- 14. Diff. Ht. GA PIPE is 0.136 m. ^{TRIG PLUG} ~~TRIG PLUG~~
- 15. Diff. Ht. is m. above below
- 16. Diff. Ht. is m. above below

Prepared by: C. STARKY Checked: [Signature]

Date	Record of Station

STATION **6504**
TS 2215 GLENFIELD

Current Occupant.....

Address.....

Owners Name.....

Address.....

Access **30-7-1979**

Station Diagram Not to Scale

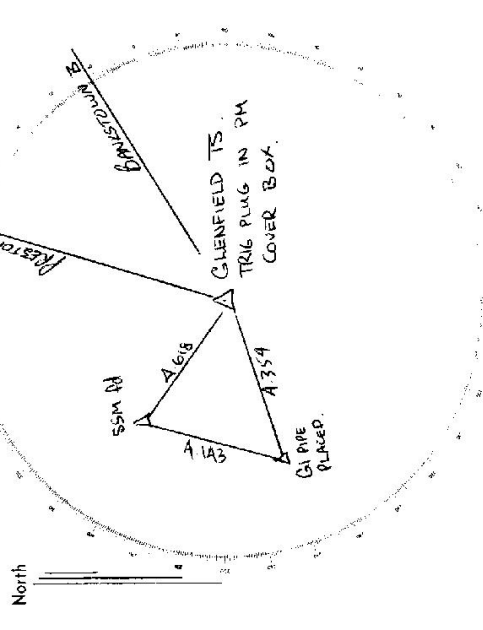

List of Observed Directions:-

Standpoint: TRIG PLUG		Standpoint: SSM	
Station	Direction	Station	Direction
Parkstone TS	07 42 00.0	TRIG PLUG	59 20 36
BANKSTOWN TS	18 04 31.7	GAP	
GAP PLACED	53 A2 06.0		
SSM FOUND	250 11 37.9		
	305 05 15.4		
Station	Direction	Station	Direction

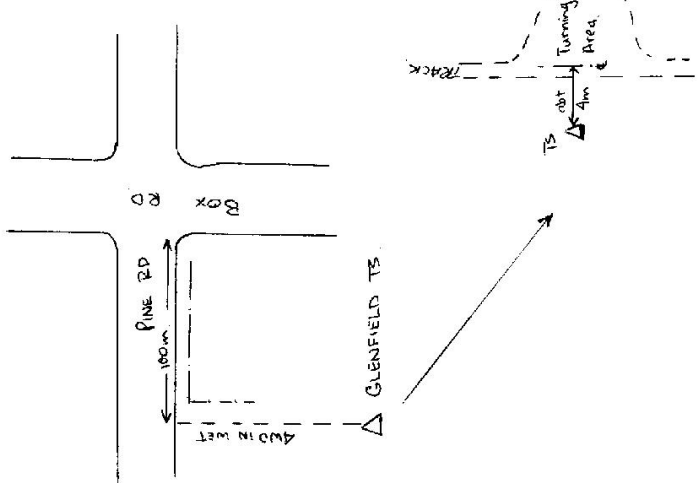

GEODETTIC SURVEY OF N.S.W.

CENTRAL MAPPING AUTHORITY

GEODETTIC STATION RECONNAISSANCE and MAINTENANCE REPORT

- Description:
- Cleared by lanes bearing..... 360°..... from Trig. Mast
 - Mast & Vanes have been painted white & black respectively, ✓
 - The station/pillar was ~~unplaced/reconstructed~~/constructed on..... 19.82°..... dimensions now being: Description of mark..... S/Steel Pillar Plate, Steel plug, Brass plug, Bolt, G.I. Pipe
- Height of mark..... 1.376.....m. ^{above} ~~below~~ rock/concrete; Mark is..... 724.....m. ^{above} G.L.
- Height of Top Vanes to Top Mark/Pillar plate..... 46.....m. Diameter of Vanes (vertical)..... 737.....m.
- Height of Cairn..... m. Diameter of Cairn..... m. Name Plate ~~found/not found~~/placed.
- Length of Mast..... m. (approximate if not unplied)
- A..... ~~Block~~..... set in conc/rock has been placed/found, bearing..... 315.....°M from Mast/Plug/Pillar
 - A..... ~~Coiled Nail~~..... set in conc/rock has been placed/found, bearing..... 42.....°M from Mast/Plug/Pillar
 - A..... set in conc/rock has been placed/found, bearing..... °M from Mast/Plug/Pillar
 - A..... set in conc/rock has been placed/found, bearing..... °M from Mast/Plug/Pillar
8. Action required:.....

STANDPOINT: <u>Pillar Base</u>			STANDPOINT: <u>Block Top Plate</u>				
Mark	Direction	Horiz. Distance	Height Difference	Mark	Direction	Horiz. Distance	Height Difference
<u>Block Masthead P</u>	0 00 00		above standpt	<u>Block Masthead P</u>	0 00 00		above standpt
<u>Coilert P</u>	78 03 00		above standpt	<u>Coilert P</u>	78 03 00		above standpt
<u>Trig. Mast</u>	221 07 00	12.422	below standpt	<u>Masthead P</u>	144 25 30		below standpt
<u>Masthead P</u>	144 25 00		above standpt	<u>Coiled Nail</u>	254 04 00	11.919	above standpt
<u>Coiled Nail</u>	251 11 00	12.287	above standpt	<u>Block Base (Site)</u>	351 00 00	13.540	above standpt
			below standpt				below standpt
			below standpt				below standpt

Prepared by: [Signature] Checked: [Signature] Noted on U.T.M. Card 11/1/20

St 2733-1

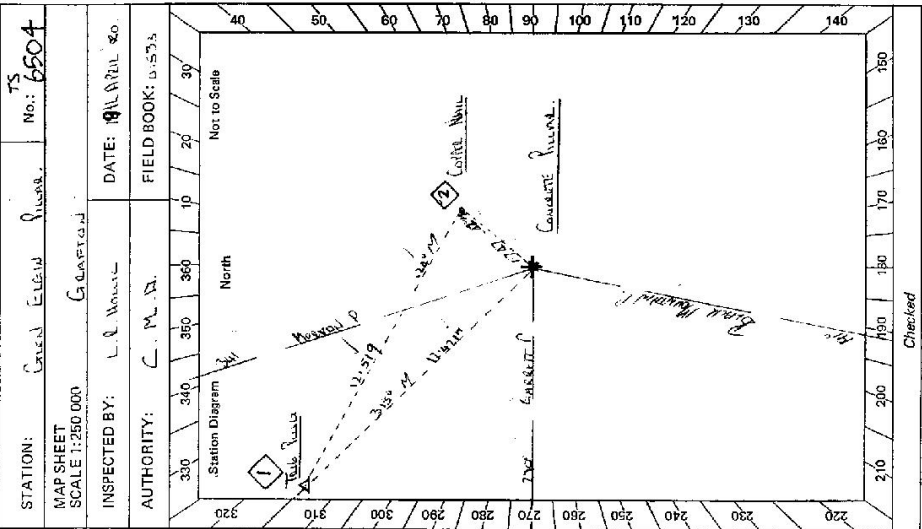

STATION: Central Mapping Authority No: 6504
 MAP SHEET SCALE 1:250 000
 INSPECTED BY: L. J. M. M. M. DATE: 18/11/2020
 AUTHORITY: C. M. A. FIELD BOOK: U.S. 73

