

TS. 6485  
No.: 3027

CENTRAL MAPPING AUTHORITY  
GEODETTIC SURVEY OF N.S.W.

GEODETTIC STATION RECONNAISSANCE and MAINTENANCE REPORT

STATION: FALLS G.S.

MAP SHEET SCALE 1:250 000  
INSPECTED BY: J. FANNING  
AUTHORITY: C.M.A.

DATE: 5th Sept 79  
FIELD BOOK: 1753

- Description:  
 1. Cleared by lanes bearing...  
 2. Mast & Vanes have been painted white & black respectively.  
 3. The station...  
 Description of mark...  
 Height of mark...  
 Height of Top Vanes to Top Mark/Pillar plate...  
 Height of Cairn...  
 Length of Mast...  
 4. A...  
 5. A...  
 6. A...  
 7. A...  
 8. Action required...

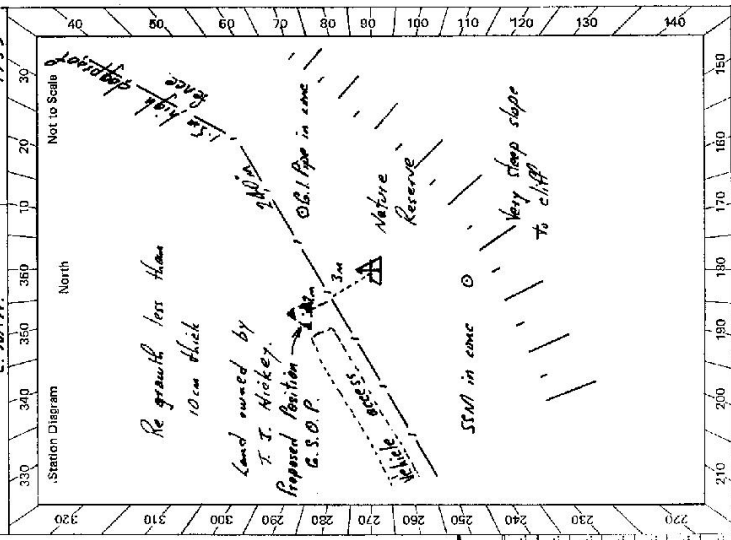

STANDPOINT:

Mark	Direction	Horiz. Distance	Height Difference	Mark	Direction	Horiz. Distance	Height Difference
			above standpt.				above standpt.
			below				below
			above standpt.				above standpt.
			below				below
			above standpt.				above standpt.
			below				below
			above standpt.				above standpt.
			below				below
			above standpt.				above standpt.
			below				below
			above standpt.				above standpt.
			below				below

Prepared by: J. Fanning  
 Checked: [Signature]  
 Noted on U.T.M. Card





STATION **FALLS PILLAR TS 6485**

Owner's Name: **T. J. HICKEY**  
 Address: **WEST WOOD (SEE ACCESS 7-77 AM)**  
 Phone: **WOLLONGONG 7 58 506**

Current Occupant:  
 Address:  
 Phone:

**ACCESS**

Access Report of 28/1/1971 was found suitable/unsuitable.  
**FROM GUYRA TRAVEL TOWARDS EBOR - GRAPTON**  
**0-0 SIGN WOLLONGONG GUYRA 32 EBOR 17 (MILES)**  
**0-2 CROSS KANGAROO CR**  
**6-0 TAKE TRACK TO LEFT THROUGH IRON GATE OPPOSIT MAIL BOX WITH**  
**NAME J. HICKEY**  
**6-92 IRON GATE PASS HOMES HEAD L.H.S (OWNERS HOUSE) HEAD NORTH**  
**7-77 IRON GATE FOLLOW DOWN AROUND FENCE**  
**7-88 TO WOOD GATE GO TO RIGHT UP FENCE AND OVER RIDGE**  
**8-19 WOOD GATE PASS FAINT TRACKS L.H.S**  
**8-72 IRON GATE FOLLOW FAINT TRACK TO LEFT DOWN GULLY (GULLY LINE IS L.H.S SOUTH)**  
**8-94 PASS DAM L.H.S**  
**8-96 IRON GATE FOLLOW FAINT TRACK TO LEFT DOWN GULLY (GULLY LINE IS L.H.S SOUTH)**  
**9-48 CROSS GULLY BLAZED TREES & TRACK**  
**9-62 SLITRAIL GATE**  
**10-47 AT BLAZED TREES FOLLOW TRACK TO RIGHT UP GULLY**  
**10-26 TURN LEFT OVER GULLY FOLLOW BLAZED TRACK TO TRAIL**  
**10-75 FALLS TRIC**

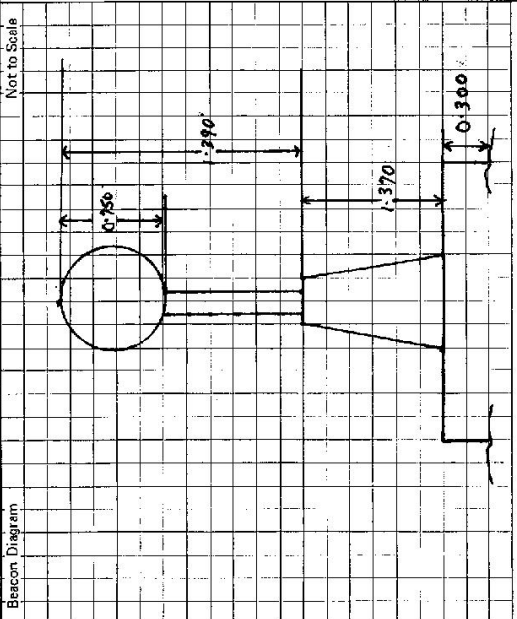

This section to be completed by officer constructing pillar.

Original station mark found/missing  
 Description of mark: **BRASS PLUG IN ROCK**  
 Original beacon found/missing  
 Description of beacon: **CAIRN MAST & VANES**  
 Height Top of Vanes to Top Mark: **4.000** m.  
 Height of mark: **0.35** m. above rock/above G.L. below G.L.  
 Diameter of Vanes: **0.915** m. Height of Cairn: **1.000** m.  
 Original Beacon has/has not been destroyed by me.

Date	Record of Station
	<b>PILLAR CONSTRUCTED ON T. J. HICKEY LAND</b>
	<b>ORIGINAL STATION IN RESERVE</b>