

CENTRAL MAPPING AUTHORITY

GEODETIC STATION RECONNAISSANCE and MAINTENANCE REPORT

Description:

Note: Cross out word or words which do not apply

1. Cleared by trees/bearing..... Completely..... Right down by wattle for 360°..... From Trig-Mast
2. Mast & Vanes have been painted white & black respectively.
3. The station/pillar was erected/not erected/constructed on..... 6.6m..... 19.79m....., dimensions now being:
Description of mark..... should be explicit e.g., S/Steel Pillar Plate, Steel plug, Brass plug, Bolt, G.I. Pipe
Height of mark..... above rock/concrete..... Mark is..... above G.L.
Height of Top Vanes to Top Mast/Pillar plate..... Diameter of Vanes (vertical) 0.910..... m.
Height of Cairn..... 2.5..... m. Diameter of Cairn..... 2.5..... m. Name Plate found/not found/.....
Length of Mast..... 3.37..... m. (approximate if not unpiled)
4. A..... G.I. Pipe in Conc...... set in conc/rock has been placed/found, bearing..... 5.2..... °M from Mast/Plug/Pillar
5. A..... SSM in Conc...... set in conc/rock has been placed/found, bearing..... 140..... °M from Mast/Plug/Pillar
6. A..... set in conc/rock has been placed/found, bearing..... °M from Mast/Plug/Pillar
7. A..... set in conc/rock has been placed/found, bearing..... °M from Mast/Plug/Pillar
8. Action required: Pillar to be constructed. Clearing to be undertaken about 1 day clearing wattle, 2 days remove to STANDPOINT. 50m - difficult to estimate time for clearing from 50-90m - possibly up to 4 days

Mark	Direction	Horiz. Distance	Height Difference	Mark	Direction	Horiz. Distance	Height Difference
			above	standpt.			above
			below	standpt.			below
			above	standpt.			above
			below	standpt.			below
			above	standpt.			above
			below	standpt.			below
			above	standpt.			above
			below	standpt.			below
			above	standpt.			above
			below	standpt.			below

Prepared by: N. Krahe

Checked: 7/9/75 Noted on U.T.M. Card

S: 2733-1

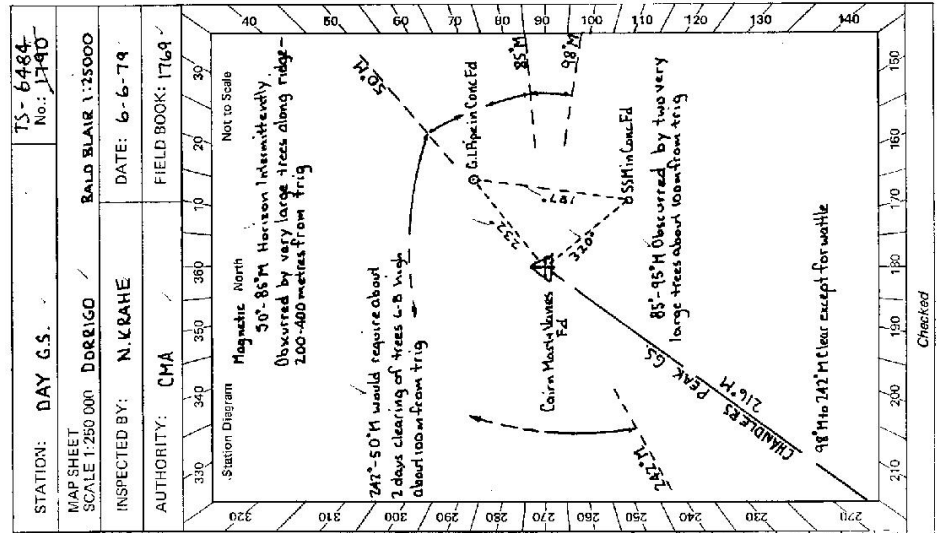

Checked

STATION: DAY G.S.
MAP SHEET: BALD BLAIR 1:25000
SCALE 1:250 000
INSPECTED BY: N. KRAHE
AUTHORITY: CMA
DATE: 6-6-74
FIELD BOOK: 1769

TS-6484
No.: 1490

GEODETTIC SURVEY OF N.S.W.

CENTRAL MAPPING AUTHORITY

GEODETTIC STATION RECONNAISSANCE and MAINTENANCE REPORT

STATION: DAY G.S (PILLAR) ✓ TS 6484 No.:
 MAP SHEET: DORRIGO ✓
 SCALE 1:250 000
 INSPECTED BY: G. L. FORD ✓ DATE: 12-12-79
 AUTHORITY: C. M. A. ✓ FIELD BOOK: 1679J

Station Diagram
 North
 Not to Scale

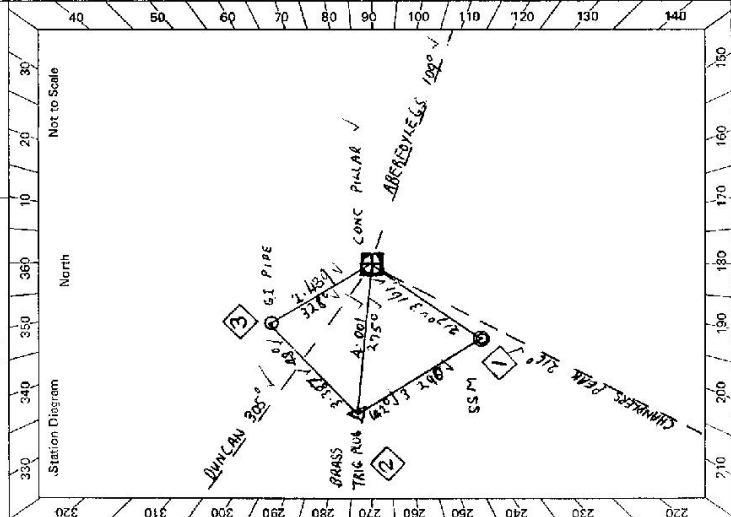

Description:	STANDPOINT: CONC. PILLAR			STANDPOINT: BRASS TRIG PLUG		
	Mark	Direction	Horiz. Distance	Height Difference	Direction	Horiz. Distance
1. Cleared by lances bearing $97^{\circ} - 50'$ / <u>CLOSE</u> <u>RIDGE</u> <u>310</u> - <u>345</u> from <u>TRIG. Mast</u>						
2. Mast & Vanes have been painted white & black respectively.						
3. The <u>station/pillar</u> was <u>replaced/removed</u> / constructed on <u>12.12.79</u> / <u>19.7.79</u> , dimensions now being: <u>Steel plate: Brass plug: Bolt: G.I. Pipe</u>						
Description of marks: <u>PILLAR PLATE</u> should be explicit, e.g., S/Steel Pillar Plate, <u>Steel plate: Brass plug: Bolt: G.I. Pipe</u>						
Height of mark: <u>3.95</u> m. above <u>rock/concrete</u> ; Mark is <u>1.535</u> m. above <u>G.L.</u>						
Height of Top Vanes to Top <u>Mark/Pillar plate</u> <u>1.445</u> m. Diameter of Vanes (vertical): <u>0.750</u> m.						
Height of Cairn:m. Diameter of Cairn:m. Name Plate <u>found/not found</u> / placed: ✓						
Length of Mast:m. (approximate if not unplied)						
4. <u>BRASS TRIG PLUG</u> set in <u>conc/rock</u> has been <u>placed</u> / found, bearing <u>2.75</u> M from <u>Mast/Dung/Pillar</u>	<u>CHARLES PEAR PLUG</u>	0 00	0 00 ✓	above standpt.	0 00	0 00 ✓
5. <u>A. S.S.M.</u> set in <u>conc/rock</u> has been <u>placed</u> / found, bearing <u>2.17</u> M from <u>Mast/Dung/Pillar</u>	<u>S.S.M.</u>	0 28 40	3 61 ✓	above standpt.	87 52	20 ✓
6. <u>A. G.I. PIPE</u> set in <u>conc/rock</u> has been <u>placed</u> / found, bearing <u>3.28</u> M from <u>Mast/Dung/Pillar</u>	<u>BRASS TRIG PLUG</u>	53 39	30 4.001 ✓	below standpt.	196 11	10 3.87 ✓
7. <u>A.</u> set in <u>conc/rock</u> has been placed / found, bearing M from Mast/Plug/Pillar	<u>DUN CAN</u>	09 30	4.001 ✓	below standpt.	233 40	20 4.001 ✓
8. Action required:	<u>G.I. PIPE</u>	111 09	50 2.439 ✓	above standpt.	253 36	40
	<u>ABERFOYLE GS</u>	253 35	0 ✓	below standpt.	283 55	30 0.184 ✓
				above standpt.		
				below		

Prepared by: G.L. Ford 14 December 1979 Checked:
 Noted on U.T.M. Card

Checked

DAY 6 S (PILLAR) IS 6484

STATION

Owner's Name: CHRIS AND SHERIDAN NEWBERK
 Address: BALVAY
 Phone: 797587
 Current Occupant: CHRIS AND SHERIDAN NEWBERK
 Address: BALVAY
 Phone: 797587

ACCESS

Access Report of 4/11/1919 was found suitable/

31.5 GUYRA RD NORTH ALONG BRADLEY ST 0-4 TURN RIGHT INTO OLLERA ST AND CROSS RAILWAY LINE CONTINUE
 START AT HEAD CROSSING NEW ENGLAND TOWARDS EBOR 4.2 TURN LEFT ONTO
 WARD'S MISTAKE RD / 25.8 TURN RIGHT INTO ROAD SIGN POSTED (KORRALUE) (GOWAN BRIDGE)
 CROSS FIVE GRIDS THEN CEMENT BRIDGE AT 21-00 THEN GRID AT 31-10 TURN RIGHT
 OFF ROAD, 31-3 THROUGH IRON GATE FOLLOW TRACK TOWARDS SHEDS
 32.0 TURN LEFT HEAR SOUTH TO WOODEN GATE AT 22-3 THROUGH GATE STILL HEADING SOUTH THROUGH
 SOLLY SECTION. FENCE LINE ON R.H.S. THROUGH IRON GATE AT 22-10 (IM FENCE ON R.H.S.)
 ROUND DAM UP HILL ON TRAIL THROUGH TIMBER (STARTS OFF WEST).
 35.1 DAM ON RIGHT HEAD EAST UP SLOPE FOLLOWING BLAZED TREES TO DAY 6 S. 36.0
 DO NOT ATTEMPT IN WET OR AFTER NOET

DAY 6 S MET SEASON ACCESS

DO KIMS. GUYRA RD HEAD NORTH ALONG BRADLEY ST 0-4 TURN RIGHT CROSS RAILWAY LINE (CROSS NEW ENGLAND) 4.2
 HEADING TOWARDS EBOR PASS WARD'S MISTAKE RD ON L.H.S. AT 4.2 PASS CHANDLERS PEAK RD ON
 R.H.S. AT 12-20 PASS BROCKLEY RD ON R.H.S. AT 16-80
 20-07 TURN LEFT ABERFOYLE RD. 21-80 CROSS ABERFOYLE RIVER
 22-83 LEFT ONTO TRACK PASSING THROUGH IRON GATE AT 22-98
 FOLLOW TRACK PASSING THROUGH WOODEN GATES AT 24-80 AND 25-36 AN IRON GATE AT 26-25
 27-29 TURN LEFT OFF TRACK PASS THROUGH WOODEN GATE IN THE CORNER AT 27-22
 LEFT FOLLOW FENCE LINE WEST LEAVE FENCE AT 27.40 TO SKIRT AROUND WATLEDON
 ROCKY KNOB 27.80 REJOIN FENCE AT CORNER CONTINUE WEST 27.90 BLAZED WILD
 APPLE TREE AT HEAD OF MARSHY GULLY FOLLOW BLAZES NORTH THEN THROUGH CLEARING
 AND THEN A NEW DIRECTION UP SLOPE ONCE ON THE RIDGE HEAD WEST TO BOUNDARY
 FENCE ABOUT 60m FROM TAIG DAY 6 S

Date

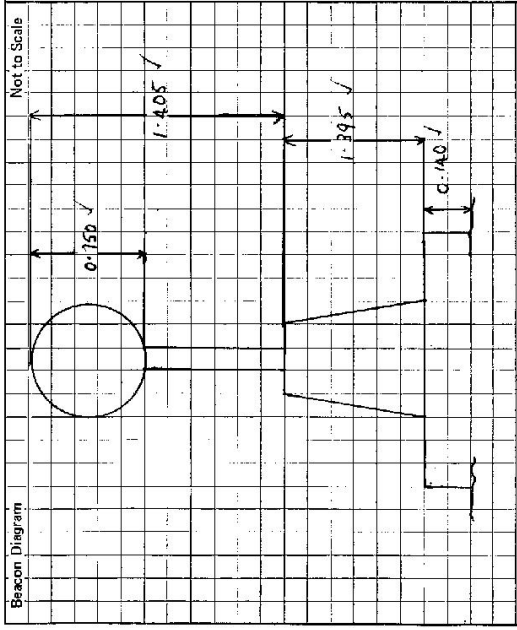

Beacon Diagram

Not to Scale

This section to be completed by officer constructing pillar.

Original station mark found/destroyed:
 Description of mark: BASS TRIG PLUG ✓
 Original beacon found/destroyed:
 Description of beacon: CAIN MAST AND VANES ✓
 Height Top of Vanes to Top Mark: 3.650 m.
 Height of mark: 0.15 m. above rock/beam 0.150 m. below G.L.
 Diameter of Vanes: 0.115 m. Height of Cairn: 3.000 m.
 Original Beacon has/has not been destroyed by me. ✓