

CENTRAL MAPPING AUTHORITY

GEODETIC SURVEY OF M.S.W.
 GEODETTIC STATION RECONNAISSANCE and MAINTENANCE REPORT

STATION: **NM C 73** No.: **6478**

MAP SHEET: **WALGETT**

SCALE: 1:250 000

INSPECTED BY: **K. ZAHRA** DATE: **26-8-78**

AUTHORITY: **CMA** FIELD BOOK: **-**

Description: *Note: Cross out word or words which do not apply*

1. Cleared by lances bearing..... from Trig. Mast
2. Mast & Vanes have been painted white & black respectively.
3. The station/pillar was unpiled/not unpiled/constructed on..... 19....., dimensions now being:
 Description of mark.....should be explicit, e.g., S/Steel Pillar Plate, Steel plug, Brass plug, Bolt, G.I. Pipe
 Height of mark.....m. ^{above} rock/concrete; Mark is.....m. ^{above} G.L.
 Height of Top Vanes to Top Mark/Pillar plate.....m. Diameter of Vanes (vertical).....m.
 Height of Cairn.....m. Diameter of Cairn.....m. Name Plate found/not found/placed.
 Length of Mast.....m. (approximate if not unpiled)
4. A.....set in conc/rock has been placed/found, bearing.....° M from Mast/Plug/Pillar
5. A.....set in conc/rock has been placed/found, bearing.....° M from Mast/Plug/Pillar
6. A.....set in conc/rock has been placed/found, bearing.....° M from Mast/Plug/Pillar
7. A.....set in conc/rock has been placed/found, bearing.....° M from Mast/Plug/Pillar
8. Action required:.....

STANDPOINT:			
Mark	Direction	Horiz. Distance	Height Difference
			above standpt.
			below standpt.
			above standpt.
			below standpt.
			above standpt.
			below standpt.
			above standpt.
			below standpt.
			above standpt.
			below standpt.
			above standpt.
			below standpt.

Prepared by: **K. Zahra** Checked: **[Signature]**
 Noted on U.T.M. Card



Station Diagram
 Not to Scale
 Not. Map. Access amended.

Checked

St. 2733-1

8-2783-2 D. West, Government Printer

<p>Beacon Diagram</p> <p>Not to Scale</p>	<p>STATION NM C 73 IS 6478</p>	<p>Owner's Name: Public Land</p> <p>Address:</p> <p>Phone:</p> <p>Current Occupant:</p> <p>Address:</p> <p>Phone:</p> <p>ACCESS</p> <p>Access Report of 24/11/1978 was found suitable/unsuitable.</p>	
<p>This section to be completed by officer constructing pillar.</p> <p>Original station mark found/not found.</p> <p>Description of mark:</p> <p>Original beacon found/not found.</p> <p>Description of beacon:</p> <p>Height Top of Vanes to Top Markm.</p> <p>Height of markm. above below G.L.</p> <p>Diameter of Vanesm. Height of Cairnm.</p> <p>Original Beacon has/not been destroyed by me.</p>		<p>Date</p> <p>Record of Station</p>	

70/326, 075 201 20

CENTRAL MAPPING AUTHORITY

GEODETIC SURVEY OF N.S.W.

GEODETIC STATION RECONNAISSANCE and MAINTENANCE REPORT

STATION: NM/C173 TS6478

MAP SHEET
SCALE 1:250 000 WALGETT

INSPECTED BY: D. FREDRIKSEN DATE: 9/7/79

AUTHORITY: C.M.A. FIELD BOOK: 1562

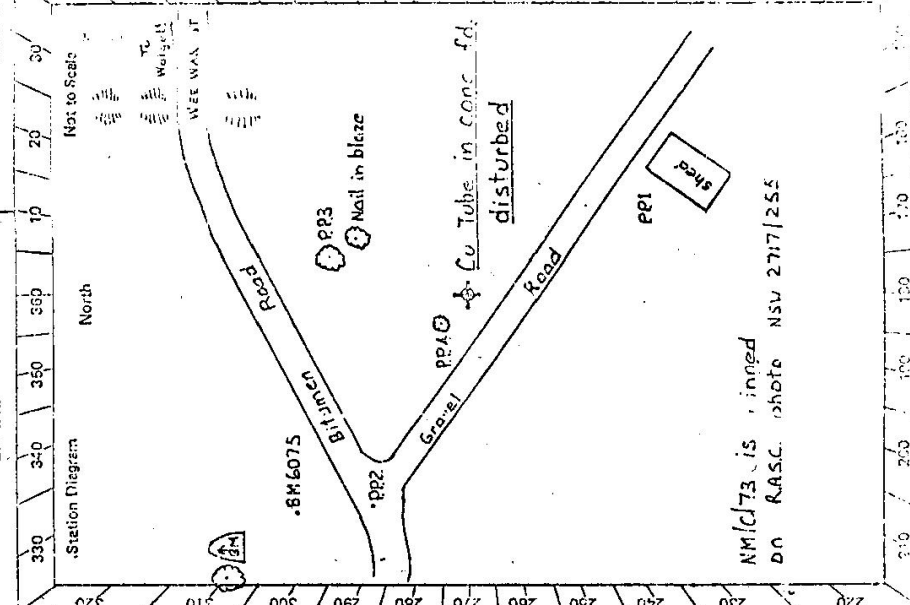

NM/C173 is pinned
on R.A.S.C. photo NSU 2717/255

Description:

Note: Cross out word or words which do not apply

1. Cleared by lanes bearing..... from Trig. Mast
2. Mast & Vanes have been painted white & black respectively.
3. The station/pillar was unpiled/no unpiled/constructed on..... 19....., dimensions now being:
Description of mark..... should be explicit, e.g., S/Steel Pillar Plate, Steel plug, Brass plug, Bolt, G.I. Pipe
Height of mark..... m. ^{above} rock/concrete; Mark is..... m. ^{above} G.L. _{below}
Height of Top Vanes to Top Mark/Pillar plate m. Diameter of Vanes (vertical)..... m.
Height of Cairn..... m. Diameter of Cairn..... m. Name Plate found/not found/placed.
Length of Mast m. (approximate if not unpiled)
4. A. Cu. Tube..... R.M.1..... set in conc/reek has been placed/found, bearing... 32.9... °M from Mast/Plug/Pillar
5. A. Cu. Tube..... R.M.2..... set in conc/reek has been placed/found, bearing... 1.2... °M from Mast/Plug/Pillar
6. A. Nail in blaze..... set in conc/rock has been placed/found, bearing... 1.8... °M from Mast/Plug/Pillar
7. A..... set in conc/rock has been placed/found, bearing..... °M from Mast/Plug/Pillar
8. Action required:.....

STANDPOINT: Cu Tube in conc. fd

Mark	Direction True	Horiz. Distance	Height Difference	Mark	Direction True	Horiz. Distance	Height Difference
Nail in blaze (R.C.)	26° 40'	42.065	1.313	Cent. BM 6075	307°	96.0	0.165
Tree	310° 31'	128.5	above standpt.	8m High			below standpt.
Cu Tube in conc. RM1	337° 57'	17.973	above standpt.	Tree 4m cover PP3	13°	49.5	below standpt.
Cu Tube in conc. RM2	20° 43'	19.236	above standpt.	Tree 5m High	312°	12.8	below standpt.
			below	3m cover PP4			below standpt.
PP1	147°	74.2	above standpt.				above standpt.
PP2	28.5°	79.5	below				below standpt.

NM/C/73 (orig.)
as per Nat. Map report

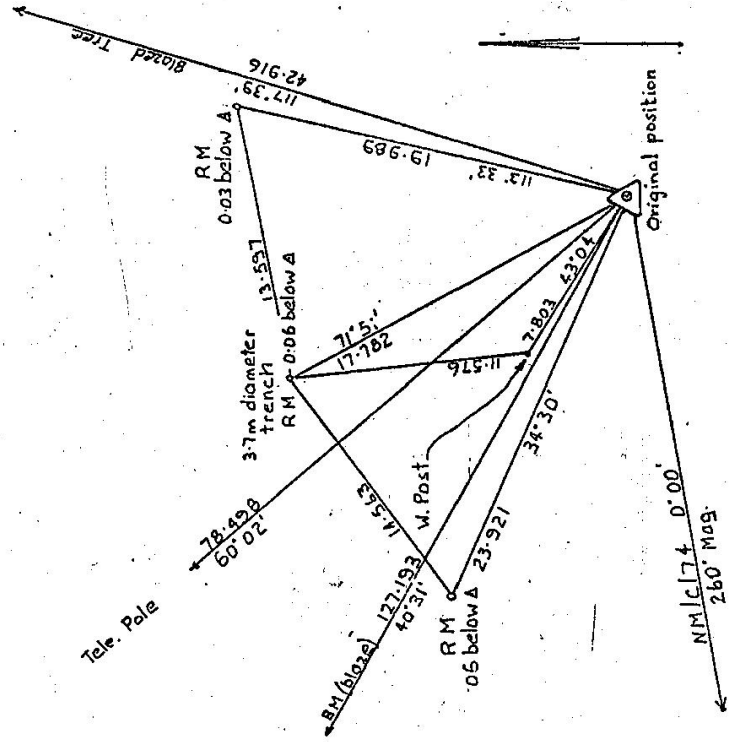

NM/C/73 (New)
as per C.M.A. 2618/78 & 9/7/79
It would appear that this mark has been moved by the amount shown below before the 26/8/78. This is verified by a measurement taken to the witness post on this day by K. Zahra of the C.M.A. which agrees with the measurement taken on 9/7/79.

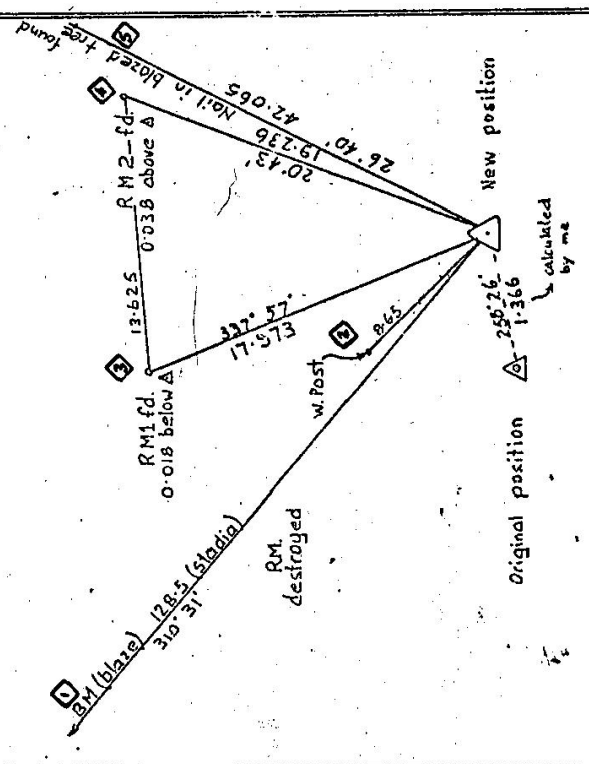

TS 6478

KMS	ACCESS	FEATURE
0.0	Walgett	P.O. heading west along Wee Wee
0.7	levee	bank
1.6	At intersection see	sketch.

CENTRAL MAPPING AUTHORITY

GEODETIC SURVEY OF N.S.W.

GEODETIC STATION RECONNAISSANCE and MAINTENANCE REPORT

Description:

1. Cleared by lanes-bearing..... Note: Cross out word or words which do not apply
..... from Trig-Meet

2. Meet & Vanes have been painted white & black respectively.

3. The station/pillar was unplaced/not unplaced/constructed on..... dimensions not being.....
Copper tube

Description of mark..... should be explicit, e.g., S/Steel Pillar Plate, Steel plug, Brass plug, Bolt, G.I. Pipe
Height of mark..... m. above/below Mark is..... m. above/below G.L.

Height of Top Vanes to Top Mark/Filler plate..... m. Diameter of Vanes (vertical)..... m.

Height of Cairn..... m. Diameter of Cairn..... m. Name Plate found/not found/placed.

Length of Mast..... m. (approximate if not supplied)

4. A..... set in conc/rock has been placed/found, bearing..... M from Mast/Plug/Pillar

5. A galv iron witness post set in conc was found bearing..... M from Mast/Plug/Pillar

6. A..... set in conc/rock has been placed/found, bearing..... M from Mast/Plug/Pillar

7. A..... set in conc/rock has been placed/found, bearing..... M from Mast/Plug/Pillar

8. Action required:.....

STANDPOINT:

STANDPOINT:

Mark	Direction	Horiz. Distance	Height Difference	Mark	Direction	Horiz. Distance	Height Difference
			above standpt				above standpt
			below				below
			above standpt				above standpt
			below				below
			above standpt				above standpt
			below				below
			above standpt				above standpt
			below				below
			above standpt				above standpt
			below				below
			above standpt				above standpt
			below				below

Prepared by: *[Signature]* 4.3.81 Checked:

Noted on U.T.M. Card

ST 2753-1

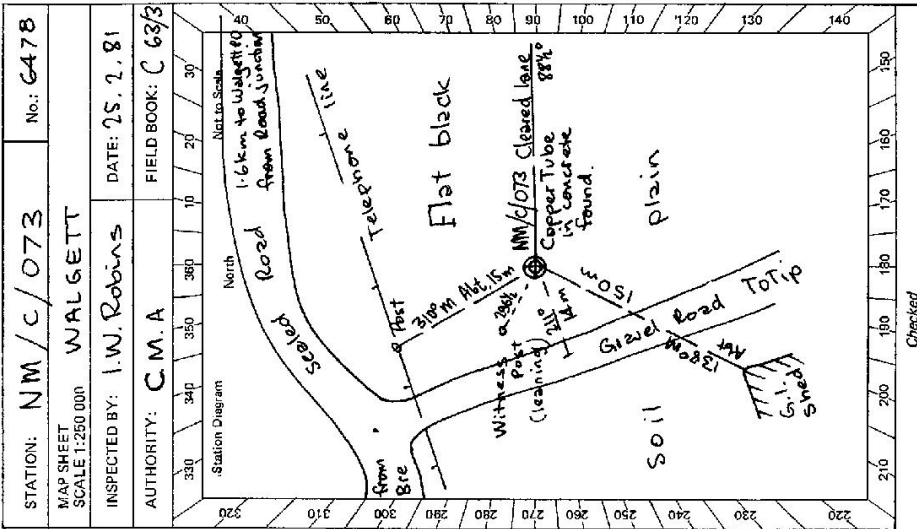

6: 2733-2 D. West, Government Printer

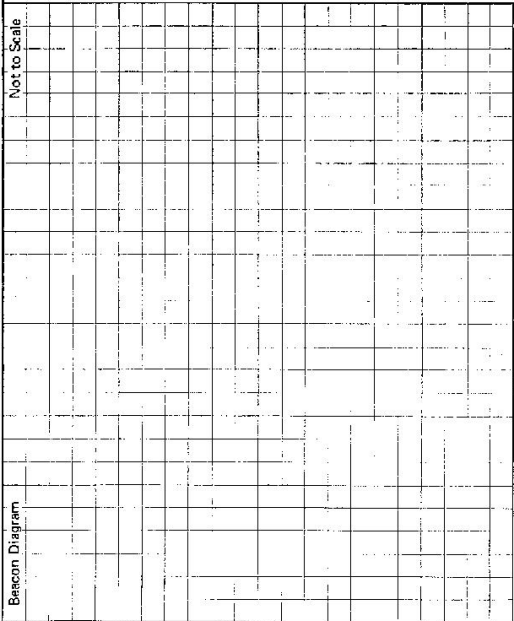
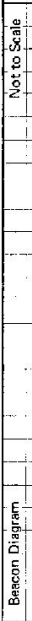
Beacon Diagram 	Not to Scale 	STATION NM/c/073 TS 6478	Owner's Name: Road reserve Address: Phone: Current Occupant: Address: Phone: ACCESS Access Report of 25.2.1981 was found suitable/unsuitable. 0.0 Walgett Post Office head west along Wee Wee Street towards Brewarrina 1.6 Turn left into gravel road ^{to left} 1.7 NM/c/073 is 14 m from centreline gravel road.
This section to be completed by officer constructing pillar. Original station mark found/not found. Description of mark: Original beacon found/not found. Description of beacon: Height Top of Vanes to Top Markm. Height of markm. above rock/concm. below G.L. Diameter of Vanesm. Height of Cairnm. Original Beacon has/has not been destroyed by me.		Date Record of Station	

LAND INFORMATION CENTRE

GEODETIC SURVEY OF A.S.K.

GEODETIC STATION RECONNAISSANCE and MAINTENANCE REPORT

Description:

1. Cleared by lanes bearing.....
 Note: *Cross out word or words which do not apply*

2. Mast & Vanes have been painted white & black respectively.
 from Trig. Mast

3. The station/pillar was unpiled/not unpiled/constructed on..... 19....., dimensions now being:

Description of mark..... should be explicit, e.g., S/Steel Pillar Plate, Steel plug, Brass plug, Bolt, G.I. Pipe

Height of mark.....m. ^{above} rock/concrete; Mark is.....m. ^{above} _{below} G.L.

Height of Top Vanes to Top Mark/Pillar platem. Diameter of Vanes (vertical).....m.

Height of Cairn.....m. Diameter of Cairn.....m. Name Plate found/not found/placed.

Length of Mastm. (approximate if not unpiled)

4. A.....set in conc/rock has been placed/found, bearing.....°M from Mast/Plug/Pillar

5. A.....set in conc/rock has been placed/found, bearing.....°M from Mast/Plug/Pillar

6. A.....set in conc/rock has been placed/found, bearing.....°M from Mast/Plug/Pillar

7. A.....set in conc/rock has been placed/found, bearing.....°M from Mast/Plug/Pillar

8. Action required:.....

STANDPOINT:				STANDPOINT:			
Mark	Direction	Horiz. Distance	Height Difference	Mark	Direction	Horiz. Distance	Height Difference
			above standpt. below				above standpt. below
			above standpt. below				above standpt. below
			above standpt. below				above standpt. below
			above standpt. below				above standpt. below
			above standpt. below				above standpt. below
			above standpt. below				above standpt. below

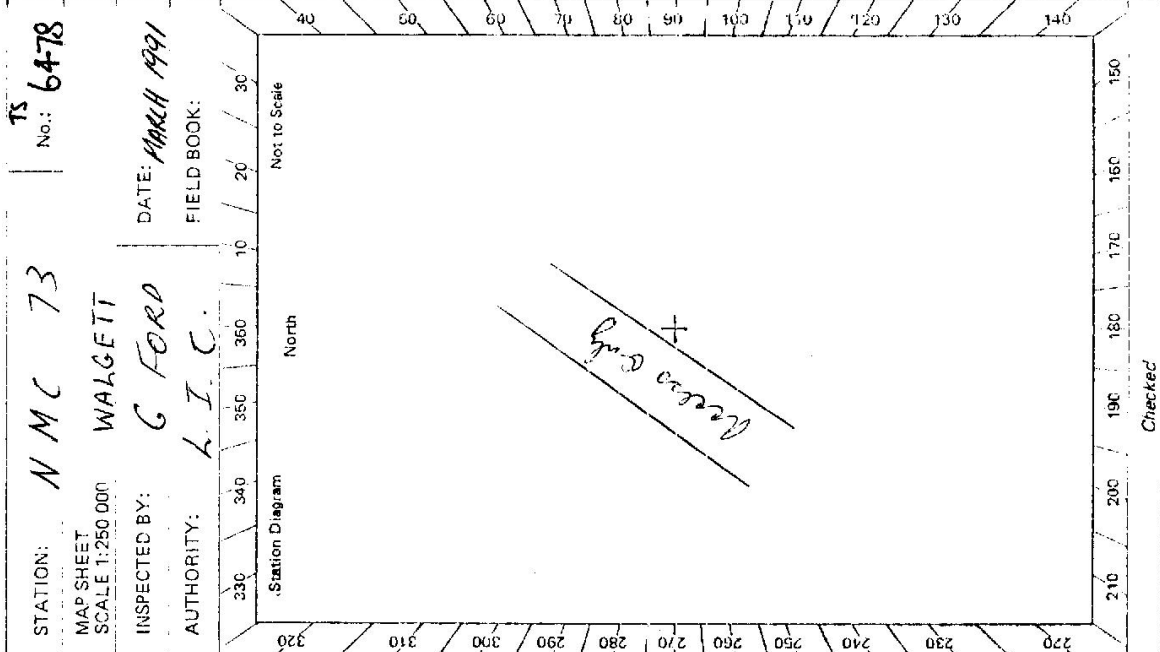

STATION: **NMC 73** TS No.: **6478**

MAP SHEET SCALE 1:250,000 **WALGETT**

INSPECTED BY: **G FORD** DATE: **MAR 1991**

AUTHORITY: **L.I.C.** FIELD BOOK:

Checked

Noted on U.T.M. Card

Checked: **L. Call** 2/5/91

Prepared by: **S. J. ...** 10/14/91

STATION **N M C 73 TS 6478**

Name:
 Current Occupant:
 Address:
 Phone:

ACCESS

Report of/...../19..... was found suitable/unsuitable.

N M C 73
WALGETT

WEE WAST
 WALGETT
 TOWNSHIP

LEVEE BANK 0.00

TO BREWSTER

CONC. BLOCK WITH
 PH 6075 MARKED INT.
 MARK IS PIPE IN GROUND WITH SIGN
 IN PLACE

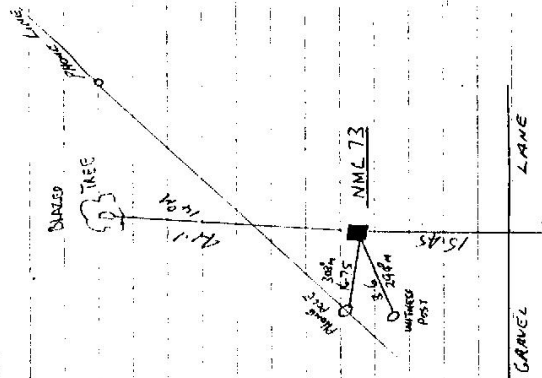
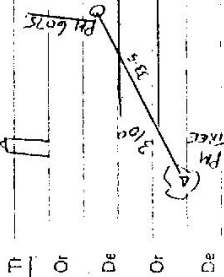

Record of Station

N M C 73 MARK IS LOOSE IN
 BLACK FLOOD PLAIN SOIL.

Original beacon has/not been destroyed by me.