

TS 6457

GEODETTIC SURVEY OF N.S.W.

CENTRAL MAPPING AUTHORITY

GEODETTIC STATION RECONNAISSANCE and MAINTENANCE REPORT

STATION: **WARDS MISTAKE GS.**

No.: **4638**

MAP SHEET
SCALE 1:250 000 **DORRICO**

INSPECTED BY: **N. KRAHE**

DATE: **7-6-79**

AUTHORITY: **C.M.A.**

FIELD BOOK: **1769**

Note: Cross out word or words which do not apply

1. Cleared by fence bearing **111° 00' 00" N 350 M** ~~from Flag Mast~~
2. Mast & Vanes have been painted white & black respectively.
3. The station/pillar was supplied/not supplied/constructed on **3.1.15** ~~1979~~, dimensions now being:
 Description of mark: ~~should be explicit, e.g., S/Steel Pillar Plate, Steel plug, Brass plug, Bolt, G.I. Pipe~~
 Height of mark: ~~above rock/concrete~~ **3.15** m. ~~Mark is~~ ^{above} ~~below~~ **G.I.**
 Height of Top Vanes to Top Mark/Pillar plate ~~.....m.~~ Diameter of Vanes (vertical) **0.915** m.
 Height of Cairn **1.15** m. Diameter of Cairn **1.1** m. Name Plate ~~found/not found/~~ **found**.
 Length of Mast **3.17** m. (approximate if not unplied)
4. A **SSM** set in ~~conc/rock~~ **conc** has been ~~placed/~~ **found**, bearing **351**° M from Mast/~~Flag/Pillar~~
5. A **G.I. Pipe** set in ~~conc/rock~~ **conc** has been ~~placed/~~ **found**, bearing **340**° M from Mast/~~Flag/Pillar~~
6. A **G.I. Pipe** set in ~~conc/rock~~ **conc** has been ~~placed/~~ **found**, bearing **.....**° M from Mast/~~Flag/Pillar~~
7. A **G.I. Pipe** set in ~~conc/rock~~ **conc** has been ~~placed/~~ **found**, bearing **.....**° M from Mast/~~Flag/Pillar~~
8. Action required: **3-4 days cleaning timber 5.2.8 m high. owner requests stumps be poisoned. P. 112.1...**

STANDPOINT:

Mark	Direction	Horiz. Distance	Height Difference	Mark	Direction	Horiz. Distance	Height Difference
			above standpt.				above standpt.
			below standpt.				below standpt.
			above standpt.				above standpt.
			below standpt.				below standpt.
			above standpt.				above standpt.
			below standpt.				below standpt.
			above standpt.				above standpt.
			below standpt.				below standpt.

Prepared by: **N. Krahe** Checked: **N. Krahe** 7/9 Noted on U.T.M. Card

S. 2733-1

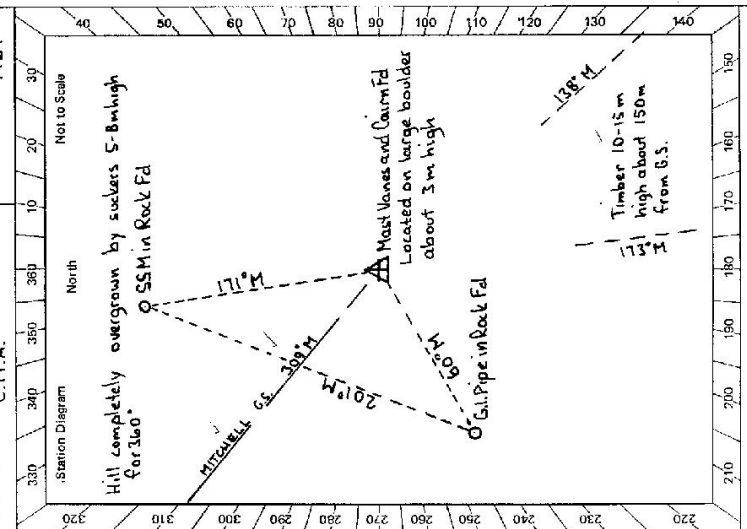

GEODETIC SURVEY OF M.S.W.

CENTRAL MAPPING AUTHORITY

GEODETIC STATION RECONNAISSANCE and MAINTENANCE REPORT

Description:

1. Cleared by lanes bearing 198m to 125m 170m to 177m. *Note: Cross out word or words which do not apply*
2. Mast & Vanes have been painted white & black respectively. ✓
3. The ~~structure~~ pillar was ~~constructed on~~ constructed on SS in rock, dimensions now being: Description of mark Steel Pillar Plate, Steel plug, Brass plug, Bolt, G.I. Pipe
Height of mark 1.27m above ~~rock~~ concrete; Mark is 1.57m above ~~rock~~ below rock.
Height of Top Vanes to Top Mast/Plate 1.17m above ~~rock~~ concrete; Diameter of Vanes (vertical) 0.760 m.
Height of Cairn 0.00 m. Diameter of Cairn 0.00 m. Name Plate ~~placed~~ placed.
Length of Mast 0.00 m. (approximate if not unplied)
4. A SS in rock set in ~~conc~~ conc/rock has been ~~placed~~ found, bearing 362.0°M from ~~standing~~ Pillar
5. A G.I. Pipe set in ~~conc~~ conc/rock has been ~~placed~~ found, bearing 245.0°M from ~~standing~~ Pillar
6. A SS in rock set in ~~conc~~ conc/rock has been ~~placed~~ found, bearing 0.00°M from Mast/Plug/Pillar
7. A SS in rock set in ~~conc~~ conc/rock has been ~~placed~~ found, bearing 0.00°M from Mast/Plug/Pillar
8. Action required: Conc obs. Place STANDPOINT: In SS in rock

Mark	Direction	Horiz. Distance	Height Difference	Direction	Horiz. Distance	Height Difference
Mitchell BR	0 00 00		above standpt	Mitchell BR	0 00 00	above standpt
Mitchell BR	32 44 50		above standpt	Mitchell BR	32 05 40	above standpt
SS in rock	16 49 40	2.967	below standpt	Conc obs. Place	22 0 19 40	1.380 above standpt
G.I. Pipe in rock	297 06 40	2.239	below standpt	G.I. Pipe in rock	254 29 30	0.653 below standpt
			above standpt			above standpt
			below standpt			below standpt
			above standpt			above standpt
			below standpt			below standpt

Prepared by: Plates 2745 Station No. 1979 Checked: Plates

SI 2738-1

Noted on U.T.M. Card

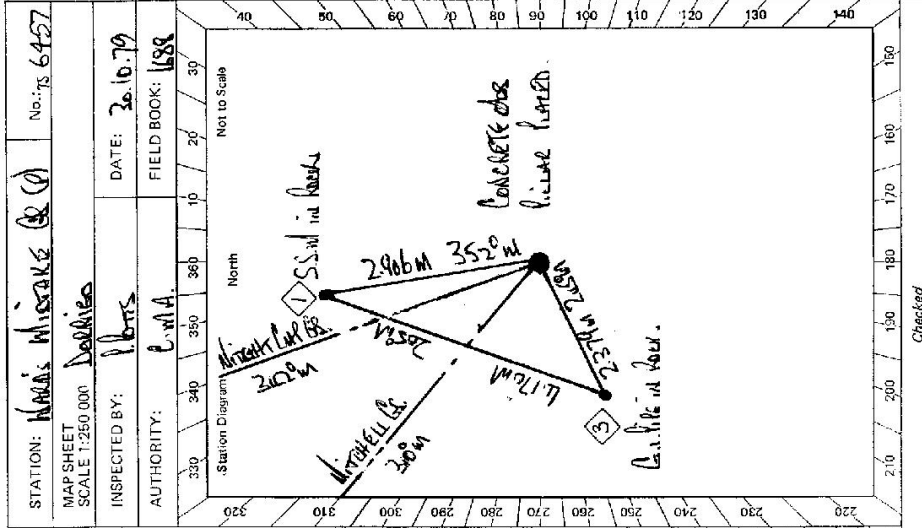

Checked

STATION: NAMAS MISSAKE (C) No.: TS 6457

MAP SHEET SCALE 1:250,000 Boharies

INSPECTED BY: Plates DATE: 30.10.79

AUTHORITY: C.M.A. FIELD BOOK: 1688

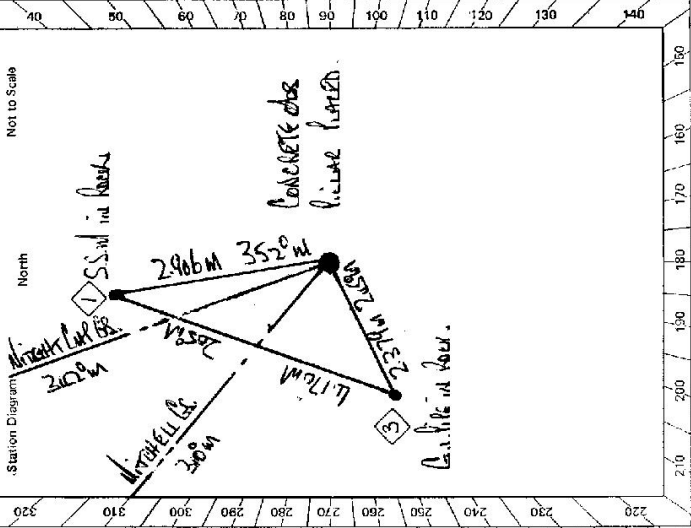

STATION MARKS W. STAKE CR (P) IS 6457	Owner's Name: <u>MR TAN HUIS</u> Address: <u>LEARNERAN CAVARA</u> Phone: <u>7975544</u> Current Occupant: Address: Phone:	Access Report of <u>7.6.19</u> was found suitable/ ACCESS NOTE: <u>BRICK TIAO WAS FOUND OUT OF ROCK</u> <u>THE CENTRE OF BELL HOLE WAS USED AS MARK.</u> <u>DIMETER OF BELL HOLE 0.020M.</u>
Beacon Diagram Not to Scale		
This section to be completed by officer constructing pillar. Original station mark found/ Description of mark: <u>BRICK TIAO WAS (BELL HOLE)</u> Original beacon found/ Description of beacon: <u>CAIRN MADE OF BRICK</u> Height Top of Vane to Top Mark <u>3.495</u> m. Height of mark <u> </u> m. above <u> </u> below <u> </u> Diameter of Vane <u>0.920</u> m. Height of Cairn <u>1.150</u> m. Original Beacon has/ been destroyed by me.		
		Date Record of Station

6

<p>STATION WINDS WINDMILL BR TS 6457</p>	<p>Owner's Name: MR. SAM HILLS Address: LEA WOODS Phone: 01753 511111</p> <p>Current Occupant: Address: Phone:</p> <p>Access Report of 26/79, was found suitable/unsuitable.</p> <p style="text-align: center;">ACCESS</p>
<p>Not to Scale</p> <p>Beacon Diagram</p>	<p>This section to be completed by officer constructing pillar.</p> <p>Original station mark found/not found.</p> <p>Description of mark:</p> <p>Original beacon found/not found.</p> <p>Description of beacon:</p> <p>Height Top of Vanes to Top Mark:m.</p> <p>Height of mark:m. above / below G.L.</p> <p>Diameter of Vanes:m. Height of Cairn:m.</p> <p>Original Beacon has/has not been destroyed by me.</p>
	<p>Date</p> <p>Record of Station</p>

CENTRAL MAPPING AUTHORITY

GEODETIC SURVEY OF N.S.W.

GEODETIC STATION RECONNAISSANCE and MAINTENANCE REPORT

Description: *Note: Cross out word or words which do not apply*

1. Cleared by lanes bearing..... from Trig. Mast

2. Mast & Vanes have been painted white & black respectively.
 MAST & VANES REPLACED

3. ~~The station pillar was applied/not applied/constructed on~~.....*1.0*.....*1.0*.....*1950*..... dimensions now being:

Description of mark *S/S P.L.L.M.* should be explicit, e.g., S/Steel Pillar Plate, Steel plug, Brass plug, Bolt, G.I. Pipe

Height of mark.....*1.375*.....^{above} rock/concrete; Mark is.....*1.87*.....^{above} G.L.

Height of Top Vanes to Top Mark/Pillar plate.....*1.422*.....m. Diameter of Vanes (vertical).....*0.750*.....m.

Height of Cairn.....m. Diameter of Cairn.....m. Name Plate found/~~not found~~/*placed*.

Length of Mast.....m. (approximate if not unplied)

4. A.....*set in conc/rock* has been placed/*found*, bearing.....°M from Mast/Plug/Pillar

5. A.....*set in conc/rock* has been placed/*found*, bearing.....°M from Mast/Plug/Pillar

6. A.....*set in conc/rock* has been placed/*found*, bearing.....°M from Mast/Plug/Pillar

7. A.....*set in conc/rock* has been placed/*found*, bearing.....°M from Mast/Plug/Pillar

8. Action required.....

STANDPOINT:			
Mark	Direction	Horiz. Distance	Height Difference
			above standpt.
			below standpt.
			above standpt.
			below standpt.
			above standpt.
			below standpt.
			above standpt.
			below standpt.
			above standpt.
			below standpt.
			above standpt.
			below standpt.

Prepared by: *[Signature]* Checked: *[Signature]* 21.9.03 Noted on U.T.M. Card

SI 2733-1

STATION: **WARDS MISTAKE CS (P)** No.: **6457**

MAP SHEET SCALE 1:250 000 **DORRILEE**

INSPECTED BY: **L. HITCHINS** DATE: **10 10 80**

AUTHORITY: **C.M.A.** FIELD BOOK: **1681**

Station Diagram

Not to Scale

Checked

<p>STATION</p> <p style="text-align: center; font-weight: bold;">LADROS MISTAKE TS 6457</p>	<p>Owner's Name: <u>IAN HUIS</u></p> <p>Address: <u>LEAMARUA</u></p> <p>Phone: <u>797554</u></p> <p>Current Occupant:</p> <p>Address:</p> <p>Phone:</p> <p style="text-align: center;">ACCESS</p> <p>Access Report of <u>...../19.....</u> was found suitable/unavailable.</p>	
<p>Beacon Diagram</p> <p style="text-align: right; font-size: small;">Not to Scale</p>	<p>This section to be completed by officer constructing pillar.</p> <p>Original station mark found/not found.</p> <p>Description of mark:</p> <p>Original beacon found/not found.</p> <p>Description of beacon:</p> <p>Height Top of Vanes to Top Mark.....m.</p> <p>Height of mark.....m. above G.L.m. below rock/conc</p> <p>Diameter of Vanes.....m. Height of Cairn.....m.</p> <p>Original Beacon has/has not been destroyed by me.</p>	<p>Date</p> <p style="text-align: center;">Record of Station</p>

6:2735-2 D. West, Government Printer

Beacon Diagram	Not to Scale	STATION	WARDS MISTAKE G.S. 15 6457
		Owner's Name: <u>Jan Hills</u> Address: <u>LEAWARUA</u> (at 38.6 km milestone) <u>GUVERA</u> Phone: <u>7971554</u>	Current Occupant: <u>Stewart Street, for abt 2 km</u> Phone: _____ ACCESS Access Report of 1.1.21/19 shows found suitable/unavailable. Guyra P.O. Head north along Braderly St ✓ 0-38 Turn left into Diercks St crossing Railway Line ✓ 0-51 Cross New England Hwy and continue towards Ebor ✓ 0-95 Near left towards Ebor ✓ 4-67 Turn left towards Wards Mistake 37 Backwater 26 ✓ 7-53 Turn right at intersection - continue to follow Bitumen passing Stevensons Rd at 11.40 on the left. 22-71 End of bitumen - continue straight ahead passing Mitchell Backwater Rd at 23.17, Kellys Rd at 25.42 and Waverly Rd at 33.45 ✓ 35-41 Turn left into Folly Lane - Pass through gate at 37.54 ✓ 38-08 Turn right through gate into Leawarua and follow track in a S.E. direction ✓ 38-48 Pass through iron gate and immediately turn left through another iron gate and follow faint track through timbered paddock ✓ 39-36 Turn right off track at blazed stringybark on RHS of track near salt licks. Follow faint wheel tracks at base of timber line passing fence corner about 40m to your right at 39.62 and continue along tracks heading into light timber ✓ 39-67 Turn left before blazed forked gum and follow blazed track up slope ✓ 40-02 WARBS MISTAKE G.S. ✓
This section to be completed by officer constructing pillar. Original station mark found/not found.		Date	Record of Station
Description of mark: _____ Original beacon found/not found. _____ Description of beacon: _____ Height: Top of Vane to Top Markm. Height of markm. above G.L. below G.L. Diameter of Vanem. Height of Cairnm. Original Beacon has/has not been destroyed by me.		7-6-79 Permission to clear and build pillar obtained from owner. Owner requests that after clearing, stumps be poisoned (see owner).	