

GEODETTIC SURVEY OF M.S.W.

CENTRAL MAPPING AUTHORITY

GEODETTIC STATION RECONNAISSANCE and MAINTENANCE REPORT

Description:

1. Cleared by lanes bearing T.O. S.V.B.R.O. SPRING ~~TRIGS?~~ TRIGS? from Trig. Mast
Note: Cross out word or words which do not apply
2. Mast & Vanes have been painted white & black respectively.
3. The station/~~pillar~~ was ~~was~~ not ~~not~~ emptied/~~constructed~~ on 2.3.6 ~~6~~ 19.7.9, dimensions now being:
Description of marks S/S PILLAR PLATE should be explicit, e.g., S/Steel Pillar Plate, Steel plug, Brass plug, Bolt, G.I. Pipe
Height of mark 1.80 ~~1.80~~ 1.80 m. ^{above} ~~below~~ rock/concrete; Mark is 1.80 ~~1.80~~ 1.80 m. ^{above} ~~below~~ G.L.
Height of Top Vanes to Top Mark/Pillar plate 1.380 ~~1.380~~ 1.380 m. Diameter of Vanes (vertical) 0.760 ~~0.760~~ 0.760 m.
Height of Cairn 0.760 ~~0.760~~ 0.760 m. Diameter of Cairn 0.760 ~~0.760~~ 0.760 m. Name Plate found/~~not found~~/placed.
Length of Mast 1.760 ~~1.760~~ 1.760 m. (approximate if not unplied)
4. A BRASS PLUG ~~set~~ set in conc/rock has been placed/~~found~~/found, bearing 265.5 ~~265.5~~ 265.5 °M from Mast/Bug/Pillar
5. A COPPER NAIL ~~set~~ set in conc/rock has been placed/~~found~~/found, bearing 137.0 ~~137.0~~ 137.0 °M from Mast/Bug/Pillar
6. A G.I. PIPE ~~set~~ set in conc/rock has been placed/~~found~~/found, bearing 249.0 ~~249.0~~ 249.0 °M from Mast/Bug/Pillar
7. A BRASS PLUG ~~set~~ set in conc/rock has been placed/~~found~~/found, bearing 319.0 ~~319.0~~ 319.0 °M from Mast/Bug/Pillar
8. Action required: CONC OBS PILLAR ~~BRASS PLUG~~

Mark	Direction	Horiz. Distance	Height Difference	Mark	Direction	Horiz. Distance	Height Difference
MAJORS POINT P.	359 59 60	1.967	above standpt.	MAJORS POINT P.	359 59 60	1.967	above standpt.
COPPER NAIL	103 07 40	2.794	below standpt.	POINT LOOKOUT PILLAR	83 19 20	26.907	above standpt.
G.I. PIPE	249 02 55	3.542	below standpt.	G.I. PIPE	85 29 20	23.492	below standpt.
BRASS PLUG	265 31 20	26.910	above standpt.	COPPER NAIL	87 21 49	28.893	above standpt.
EBOR G.S.	319 35 10		below standpt.	EBOR G.S.	319 28 20		below standpt.

Prepared by: R. M. K. ~~31/7/22~~ 31/7/22 Noted on U.T.M. Card
Checked: R. M. K.

Sr 2735-1

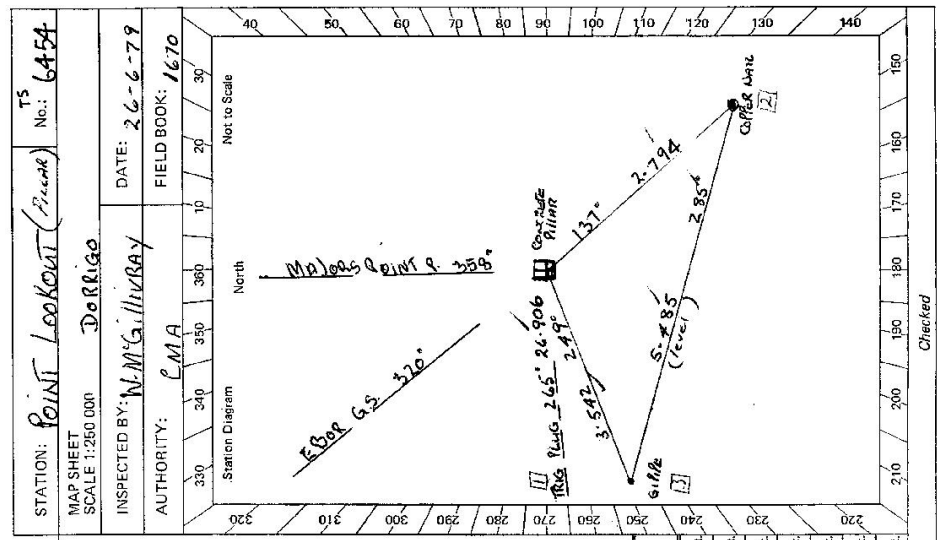

STATION: POINT LOOKOUT (Pillar) No.: 6454
 MAP SHEET SCALE 1:280 000
 INSPECTED BY: M.M. GILLIKRAY DATE: 26-6-79
 AUTHORITY: CMA FIELD BOOK: 1670

G

STATION **POINT LOOKOUT** **Pillar IS 6454**

Owner's Name: **NATIONAL PARKS & WILDLIFE**
 Address: **ARMIDALE**
 Phone:
 Current Occupant:
 Address:
 Phone:
ACCESS

Access Report of **6/19/79** was found suitable/unsuitable.

0.0 Wollombi. Post Office, Travel Towards Dorrigo
27.8 TURN RIGHT, SIGN NEW ENGLAND NATIONAL PARK.
 FOLLOW SIGNS TO POINT LOOKOUT.
43.0 G.S. /

NOTE: MAY & VANES ARE STORED WITH THE RAUCER AT NEW ENGLAND NATIONAL PARK. THEY ARE OBTAINABLE ON REQUEST.

Sr 2733-2 D. West, Government Printer

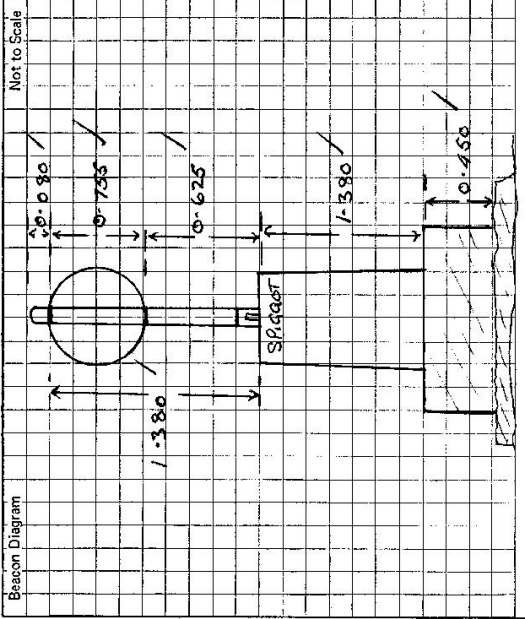

This section to be completed by officer constructing pillar.

Original station mark found/~~not found~~
 Description of mark: **BRASS PLUG**
 Original beacon found/not found.
 Description of beacon: **CRACKER BOX OVER TRIG PLUG**
 Height Top of Vanes to Top Mark: **NA** m.
 Height of mark: **NA** m. above G.L. / **NA** m. below G.L.
 Diameter of Vanes: **NA** m. Height of Cairn: **NA** m.
 Original Beacon has/has not been destroyed by me.

Date	Record of Station