

IS-6448

CENTRAL MAPPING AUTHORITY

GEODETIC STATION RECONNAISSANCE and MAINTENANCE REPORT

Description: Note: Cross out word or words which do not apply

1. Cleared by lanes bearing... *about 1/2 days clearing for 360° from Trig. Mast*
  2. Mast & Vanes have been painted white & black respectively. *by forestry*
  3. The station/pillar was ~~applied~~ *NOT APPLIED* / ~~not applied~~ / ~~constructed~~ on... *19*... dimensions now being: *rock/concrete*
- Height of mark... *above* rock/concrete; Mark is... *above* G.L.
- Height of Top Vanes to Top Mark/Pillar plate .....m. Diameter of Vanes (vertical).....m.
- Height of Cairn.....m. Diameter of Cairn.....m. Name Plate found/not found/placed.
- Length of Mast .....m. (approximate if not unplied)
4. A... *G.I.P.*.....set in conc/teeck has been ~~placed~~/found, bearing.....°M from Mast/Plug/Pillar
5. A... *S.S.M.*.....set in conc/teeck has been ~~placed~~/found, bearing.....°M from Mast/Plug/Pillar
6. A.....set in conc/rock has been placed/found, bearing.....°M from Mast/Plug/Pillar
7. A.....set in conc/rock has been placed/found, bearing.....°M from Mast/Plug/Pillar
8. Action required: *A strike in conc/teeck... found... and... a pillar... sensitive find.*

STANDPOINT:			
Mark	Direction	Horiz. Distance	Height Difference
			above standpt.
			below standpt.
			above standpt.
			below standpt.
			above standpt.
			below standpt.
			above standpt.
			below standpt.
			above standpt.
			below standpt.
			above standpt.
			below standpt.

Prepared by: *D. Fredriksen* 3/18/79 Checked: *W. J. J. J.* 27/9/79 Noted on U.T.M. Card

SR 2739-1

STATION: *HYLAND G.S.* No.: *8544*

MAP SHEET SCALE 1:250 000 *DORRIGO*

INSPECTED BY: *D. FREDRIKSEN* DATE: *2/18/79*

AUTHORITY: *C.M.P.* FIELD BOOK: *1764*

Station Diagram  
 North  
 If we can wait until the Forestry Com. have a dozer in the area they'll put in a track for 1/2 cost. Total cost approx. \$400. Time for dozer uncertain. It would take a P/O about 2 days work to cut this track out to Trig

*Scip in conc. fd*

*Cairn Mast & Vanes fd*

*S.S.M. in conc. fd*

Checked

<p style="font-size: small;">SI 2733-2 D. West Government Printer</p>	<p style="font-size: small;">Beacon Diagram</p>	<p style="font-size: small;">Not to Scale</p>	<p style="text-align: center; font-weight: bold;">STATION HYLAND G.S TS 6448</p> <p>Owner's Name: <i>Mt. Hyland Preserve</i>            Address: <i>Forestry Commission</i>            Phone: <i>Dunbarton</i></p> <p style="text-align: right;">Current Occupant:            Address:            Phone:</p> <p style="text-align: center;"><b>ACCESS</b></p> <p>Access Report of <i>2.18.1921</i> was found <del>unsuitable</del> suitable. <b>Feature</b></p> <table style="width: 100%; border-collapse: collapse;"> <tr> <td style="width: 10%; font-size: small;">Kms</td> <td style="font-size: small;">At Dundurabin "86 GRAFTON / 114 ARMDALE" head west.</td> </tr> <tr> <td>0.0</td> <td>Turn LEFT at tele-phone box keep on main road.</td> </tr> <tr> <td>0.1</td> <td>Turn LEFT into "CHAELUNDI RD"</td> </tr> <tr> <td>6.5</td> <td>Pass "Hyland Forest Rd" on L.H.S</td> </tr> <tr> <td>7.3</td> <td>PASS "obelisk Rd" on L.H.S.</td> </tr> <tr> <td>10.0</td> <td>KEEP LEFT at "BIG BULL RD" S.P.</td> </tr> <tr> <td>12.6</td> <td>Straight ahead at "VISTA POINT" S.P.</td> </tr> <tr> <td>16.8</td> <td><del>Pass</del> Turn LEFT along "HARDENS RD"</td> </tr> <tr> <td>17.7</td> <td>Grid</td> </tr> <tr> <td>19.55</td> <td>Pass old access on L.H.S just past cutting.</td> </tr> <tr> <td>20.8</td> <td>Turn LEFT towards "Dundurabin IS" along "Moss Forest Rd"</td> </tr> <tr> <td>23.45</td> <td>Pass track on R.H.S</td> </tr> <tr> <td>24.0</td> <td>Turn LEFT along fire trail just before grid.</td> </tr> <tr> <td>24.45</td> <td>Turn HARD RIGHT off trail onto old snigging track.</td> </tr> <tr> <td>24.8</td> <td>At edge of rain forest follow blazes then red tape</td> </tr> <tr> <td>25.1</td> <td>up ridge in N.E. direction onto a hardwood knoll then</td> </tr> <tr> <td></td> <td>in N. direction onto trig. Easy grade all the way</td> </tr> <tr> <td></td> <td>and should be able to be made into a drive to.</td> </tr> </table>	Kms	At Dundurabin "86 GRAFTON / 114 ARMDALE" head west.	0.0	Turn LEFT at tele-phone box keep on main road.	0.1	Turn LEFT into "CHAELUNDI RD"	6.5	Pass "Hyland Forest Rd" on L.H.S	7.3	PASS "obelisk Rd" on L.H.S.	10.0	KEEP LEFT at "BIG BULL RD" S.P.	12.6	Straight ahead at "VISTA POINT" S.P.	16.8	<del>Pass</del> Turn LEFT along "HARDENS RD"	17.7	Grid	19.55	Pass old access on L.H.S just past cutting.	20.8	Turn LEFT towards "Dundurabin IS" along "Moss Forest Rd"	23.45	Pass track on R.H.S	24.0	Turn LEFT along fire trail just before grid.	24.45	Turn HARD RIGHT off trail onto old snigging track.	24.8	At edge of rain forest follow blazes then red tape	25.1	up ridge in N.E. direction onto a hardwood knoll then		in N. direction onto trig. Easy grade all the way		and should be able to be made into a drive to.
Kms	At Dundurabin "86 GRAFTON / 114 ARMDALE" head west.																																						
0.0	Turn LEFT at tele-phone box keep on main road.																																						
0.1	Turn LEFT into "CHAELUNDI RD"																																						
6.5	Pass "Hyland Forest Rd" on L.H.S																																						
7.3	PASS "obelisk Rd" on L.H.S.																																						
10.0	KEEP LEFT at "BIG BULL RD" S.P.																																						
12.6	Straight ahead at "VISTA POINT" S.P.																																						
16.8	<del>Pass</del> Turn LEFT along "HARDENS RD"																																						
17.7	Grid																																						
19.55	Pass old access on L.H.S just past cutting.																																						
20.8	Turn LEFT towards "Dundurabin IS" along "Moss Forest Rd"																																						
23.45	Pass track on R.H.S																																						
24.0	Turn LEFT along fire trail just before grid.																																						
24.45	Turn HARD RIGHT off trail onto old snigging track.																																						
24.8	At edge of rain forest follow blazes then red tape																																						
25.1	up ridge in N.E. direction onto a hardwood knoll then																																						
	in N. direction onto trig. Easy grade all the way																																						
	and should be able to be made into a drive to.																																						
<p>This section to be completed by officer constructing pillar.</p> <p>Original station mark found/not found.</p> <p>Description of mark: .....</p> <p>Original beacon found/not found.</p> <p>Description of beacon: .....</p> <p>Height Top of Vanes to Top Mark .....m.</p> <p>Height of mark .....m.    <small>above G.L.</small>  <small>below</small></p> <p>Diameter of Vanes .....m.    <small>Height of Cairn .....m.</small></p> <p>Original Beacon has/has not been destroyed by me.</p>		<p>Date</p> <p style="text-align: right;">Record of Station</p>																																					

GEODETTIC SURVEY OF M.S.W.

CENTRAL MAPPING AUTHORITY

GEODETTIC STATION RECONNAISSANCE and MAINTENANCE REPORT

STATION: HYLOND PILLAR No.: 6448

MAP SHEET SCALE 1:250,000

INSPECTED BY: L. R. HALLIS DATE: 21/05/2022

AUTHORITY: C.M.A. FIELD BOOK: 1676

- Description: 360° ✓ *Note: Cross out word or words which do not apply*
1. Cleared by lanes bearing 360° from Trig. Mast
2. Mast & Vanes have been painted white & black respectively. ✓
3. The ~~station~~ pillar was ~~replaced/re-constructed~~ constructed on 1st. Salt 19.75m, dimensions now being: 19.75m, 19.75m, dimensions now being: 19.75m, 19.75m
- Description of mark Steel Plate, Steel plug, Brass plug, Bolt, G.I. Pipe
- Height of mark 1.815m above concrete Mark is 1.815m above G.L.
- Height of Top Vanes to Top Mark/Pillar plate 1.815m Diameter of Vanes (vertical) 750mm
- Height of Cairn 0m Diameter of Cairn 0m Name Plate found/not found/placed
- Length of Mast 0m (approximate if not upright)
4. 1.815m set in conc/rock has been placed/found, bearing 330° from Mast/Pillar
5. 1.815m set in conc/rock has been placed/found, bearing 330° from Mast/Pillar
6. 1.815m set in conc/rock has been placed/found, bearing 330° from Mast/Pillar
7. 1.815m set in conc/rock has been placed/found, bearing 330° from Mast/Pillar
8. Action required: None

STANDPOINT: <u>None</u>		STANDPOINT: <u>None</u>		STANDPOINT: <u>None</u>	
Mark	Direction	Horiz. Distance	Height Difference	Direction	Horiz. Distance
<u>CHRISTMAS I</u>	<u>0 00 00</u>	<u>0</u>	<u>above standpt</u>	<u>0 00 00</u>	<u>0</u>
<u>MARSHALL S</u>	<u>4 12 20</u>	<u>0</u>	<u>below standpt</u>	<u>4 12 20</u>	<u>0</u>
<u>G. Pipe</u>	<u>36 13 30</u>	<u>2.133</u>	<u>below standpt</u>	<u>36 13 30</u>	<u>2.133</u>
<u>Top Plate</u>	<u>116 07 00</u>	<u>3.410</u>	<u>below standpt</u>	<u>116 07 00</u>	<u>3.410</u>
<u>TRINITY P</u>	<u>140 35 00</u>	<u>0</u>	<u>above standpt</u>	<u>140 35 00</u>	<u>0</u>
<u>S.S.P</u>	<u>180 03 30</u>	<u>4.287</u>	<u>below standpt</u>	<u>180 03 30</u>	<u>4.287</u>

Prepared by: L. R. HALLIS Checked: L. R. HALLIS Noted on U.T.M. Card

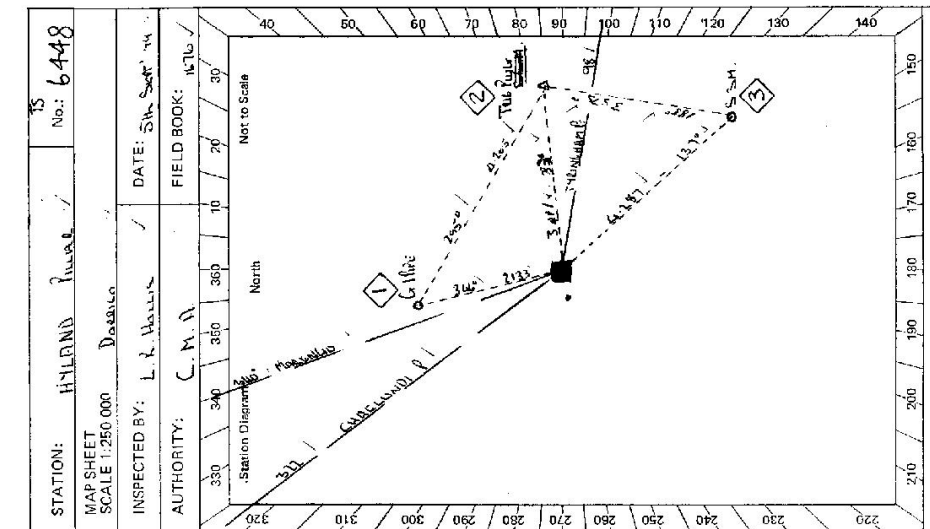

Checked: L. R. HALLIS

SR 2733-2 D. West, Government Printer

**STATION** HYLAND ROAD / TS 6448

Owner's Name: .....  
 Address: .....  
 Phone: .....

Current Occupant: Telecom Australia  
 Address: .....  
 Phone: .....

**ACCESS**

Access Report of 2.X.19: Access found suitable/unsuitable.

AT DUNDURRILL SUBSTATION THE REMOVAL OF TRAFFIC VANS  
 TURN LEFT AT TELEPHONE BOX  
 TURN LEFT SLOW (CONCRETE) IN  
 PASS HYLAND RD ON LEFT  
 PASS OBSTACLE ON LEFT  
 PASS "SIL BULL" ON RIGHT  
 TURN LEFT "HARBOUR RD"  
 GO ON  
 PASS OLD HOUSE ON LEFT  
 TURN LEFT TOWARDS DUNDURRILL IN "MABLE" TRAFFIC VANS  
 PASS TRUCK ON RIGHT  
 TURN LEFT FIRST TRUCK, SIGN BEFORE LANE  
 TURN RIGHT OFF ROAD ONTO OLD SOUTHWALK ROAD.  
 LOCATIONS SHOWN.

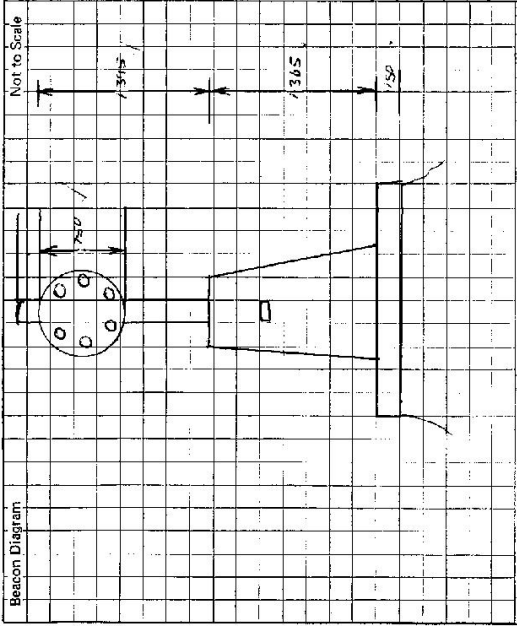

This section to be completed by officer constructing pillar.

Original station mark found/~~not found~~. ✓

Description of mark: Beacon with four vanes

Original beacon found/~~not found~~. ✓

Description of beacon: Concrete pillar with four vanes

Height Top of Vanes to Top Mark: 3.58 m.

Height of mark: 0.55 m. above peak/conc. 0.15 below G.L.

Diameter of Vanes: 180 m. Height of Cairn: ..... m.

Original Beacon has/~~has not~~ been destroyed by me. /

Date: .....

Record of Station