

GEODETTIC SURVEY OF N.S.W.

CENTRAL MAPPING AUTHORITY

GEODETTIC STATION RECONNAISSANCE and MAINTENANCE REPORT

Description:

1. Cleared by laser bearing: ~~from~~ *Visibility* from Trig, Mast
 Note: Cross out word or words which do not apply

2. Mast & Vanes have been painted white & black respectively

3. The station/pillar was supplied/not supplied/constructed on ~~30.10~~ *1978*, dimensions now being:

Description of mark ~~Mast & Vanes~~ should be explicit, e.g., S/Steel Pillar Plate, Steel plug, Brass plug, Bolt, G.I. Pipe

Height of mark: m. ^{above} rock/concrete; Mark is m. ^{above} G.I.

Height of Top Vanes to Top Mark/Pillar plate: m. Diameter of Vanes (vertical): *0.765* m.

Height of Cairn: *1.7* m. Diameter of Cairn: *2.25* m. Name Plate found/not found/placed:

Length of Mast: *3.5* m. (approximate if not unplied)

4. ~~Set in cone/rock has been placed/~~ found, bearing: M - from Mast/Plug/Pillar

5. ~~Set in cone/rock has been placed/~~ found, bearing: M - from Mast/Plug/Pillar

6. ~~Set in cone/rock has been placed/~~ found, bearing: M - from Mast/Plug/Pillar

7. ~~Set in cone/rock has been placed/~~ found, bearing: M - from Mast/Plug/Pillar

8. Action required: *Mast & Vanes to be replaced. 360° clearing i.s.r. required.*

STANDPOINT:

Mark	Direction	Horiz. Distance	Height Difference	Mark	Direction	Horiz. Distance	Height Difference
			above standpt.				above standpt.
			below				below
			above standpt.				above standpt.
			below				below
			above standpt.				above standpt.
			below				below
			above standpt.				above standpt.
			below				below
			above standpt.				above standpt.
			below				below
			above standpt.				above standpt.
			below				below

Prepared by: *SP* 30.10.78 Checked:

Noted on U.T.M. Card

St 2733-1

STATION: **CAMPION** No.: **TS 6445**

MAP SHEET SCALE 1:250 000 **DORRIGO**

INSPECTED BY: **J. SUTTON** DATE: **30.10.78**

AUTHORITY: **C.M.A.** FIELD BOOK: **NIL**

Station Diagram

North

Not to Scale

STATION **CAMPION. TS-6445**

Owner's Name: *Forestry Commission*
 Address: *Forestry Office*
Cudgery St. Dargary
 Phone: *(01665711) 83*

Current Occupant: *For. Comm. of NSW*
 Address:
 Phone: *30-10-78*

ACCESS **30-10-78**

Access Report of *22/1/19* was found ~~unsuitable~~ *unsuitable*.
 From Dargary P.O. follow Hickory St. towards Dargary Falls. Proceed past Dargary Falls

- 10.10km Turn left up Lower Balsdown road.
- 15.85km Turn left up gravel road.
- 16.55km Turn left up dirt track.
- 16.85km Pass through wire gate.
- 17.10km Pass by old house 100m off to left.
- 17.25km Pass through steel gate.
- 17.65km Drive through ford to right of ruined bridge.
- 18.40km Pass through wire gate.
- 19.15km Track Junction - proceed right.
- 19.20km Track Junction - proceed left.
- 19.40km Track Junction - proceed right along overgrown track. Follow old smig track on ridge to saddle.
- 21.45km Stop truck. Head SE along ridge - Walk to Campion 25 minutes easy walk following old smig track for most of way. (Take moquette or bush hook)

WALK TO - 25 MINUTES

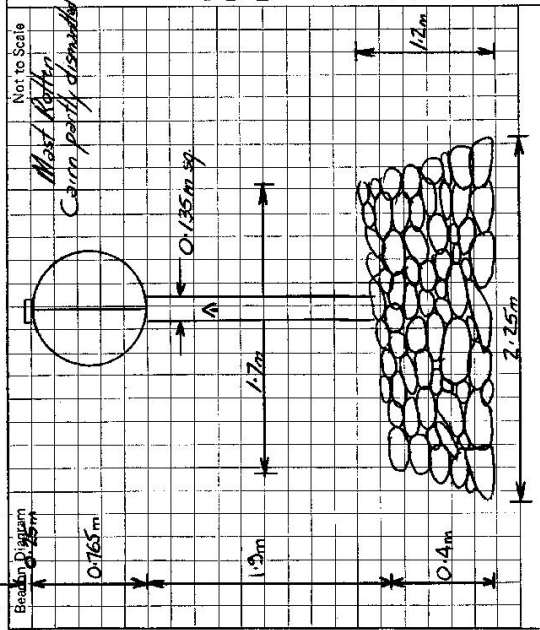

This section to be completed by officer constructing pillar.

Original station mark found/not found.

Description of mark:

Original beacon found/not found.

Description of beacon:

Height Top of Vanes to Top Markm.

Height of markm. above/below

Diameter of Vanesm.

Original Beacon has/has not been destroyed by me.

Date

Record of Station

GEODETTIC SURVEY OF NSW

CENTRAL MAPPING AUTHORITY

GEODETTIC STATION RECONNAISSANCE and MAINTENANCE REPORT

STATION: Campanal Pinnacle No.: TS 6445

MAP SHEET SCALE 1:250 000 Dubbois - Cores Ridge

INSPECTED BY: L. L. Housley DATE: 24th Sept '21

AUTHORITY: C.M.A. FIELD BOOK: 1876

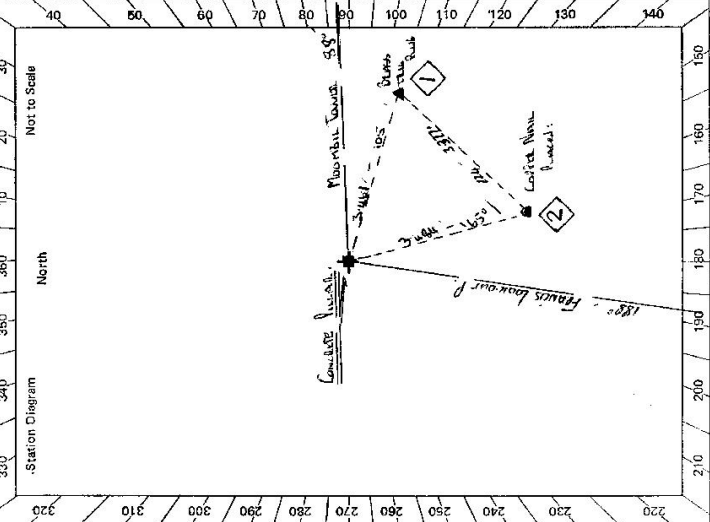

- Description: Note: Cross out word or words which do not apply
- Cleared by lanes bearing 135° 00' 00" from Trig, Mast
 - Mast & Vanes have been painted white & black respectively. ✓
 - The ~~station~~/pillar was ~~unplaced/not placed~~/constructed on 19.34m dimensions now being: 19.34m
 - Description of mark: Francis Lighthouse should be explicit, e.g., S/Steel Pillar Plate, Steel Plug, Brass plug, Bolt, G.I. Pipe
 - Height of mark: 1.400 m. ^{above} 1.100 m. ^{below} G.L.
 - Height of Top Vanes to Top Mark/Pillar plate 4.400 m. Diameter of Vanes (vertical): 0.750 m.
 - Height of Cairn: 0.000 m. Diameter of Cairn: 0.000 m. Name Plate found/not found/placed.
 - Length of Mast: 0.000 m. (approximate if not unplied)
 - A. Francis Lighthouse set in conc/rock has been ~~placed~~/found, bearing 180° 00' 00" M from ~~Mast/Hang~~/Pillar
 - A. Dubs Pinnacle set in conc/rock has been ~~placed~~/found, bearing 135° 00' 00" M from ~~Mast/Hang~~/Pillar
 - A. Coffee Mine Pinnacle set in conc/rock has been ~~placed~~/found, bearing 105° 00' 00" M from ~~Mast/Hang~~/Pillar
 - A. Campanal Pinnacle set in conc/rock has been ~~placed~~/found, bearing 180° 00' 00" M from ~~Mast/Hang~~/Pillar
 - Action required: None

STANDPOINT: <u>Francis Lighthouse</u>			
Mark	Direction	Horiz. Distance	Height Difference
<u>Francis Lighthouse P</u>	<u>180 00 00</u>	<u>0.00</u>	<u>above standpt.</u>
<u>Dubs Pinnacle</u>	<u>135 00 00</u>	<u>3.377</u>	<u>above standpt.</u>
<u>Coffee Mine</u>	<u>105 00 00</u>	<u>3.463</u>	<u>above standpt.</u>
<u>Campanal Pinnacle</u>	<u>180 00 00</u>	<u>0.00</u>	<u>above standpt.</u>
<u>Campanal Pinnacle</u>	<u>135 00 00</u>	<u>3.463</u>	<u>above standpt.</u>
<u>Campanal Pinnacle</u>	<u>105 00 00</u>	<u>3.463</u>	<u>above standpt.</u>
<u>Campanal Pinnacle</u>	<u>180 00 00</u>	<u>0.00</u>	<u>above standpt.</u>
<u>Campanal Pinnacle</u>	<u>135 00 00</u>	<u>3.463</u>	<u>above standpt.</u>
<u>Campanal Pinnacle</u>	<u>105 00 00</u>	<u>3.463</u>	<u>above standpt.</u>
<u>Campanal Pinnacle</u>	<u>180 00 00</u>	<u>0.00</u>	<u>above standpt.</u>
<u>Campanal Pinnacle</u>	<u>135 00 00</u>	<u>3.463</u>	<u>above standpt.</u>
<u>Campanal Pinnacle</u>	<u>105 00 00</u>	<u>3.463</u>	<u>above standpt.</u>

Prepared by: L. L. Housley Checked: L. L. Housley Noted on U.T.M. Card



ST 2723-1

St 2733-2 D. West, Government Printer

STATION

Cairns Road TS 6445

Owner's Name:
 Address:
 Phone:
 Current Occupant:
 Address:
 Phone:

ACCESS

Access Report of 27.9.19. It was found suitable/unsuitable.

1/2.00 From Doolittle P.O. Cross Intersection and Travel Nth
 1/7.50 Pass Old Caravan Rd and Light.
 1/9.30 Grand Quarry on Left
 1/9.45 Turn Left Sign Lower Intersection 20
 1/15.70 Turn Left on to Dist Rd
 1/16.25 Turn Left
 1/16.70 Wire Gate
 1/17.10 Iron Gate
 1/17.30 Green Grasshills.
 1/18.30 Wire Gate
 1/19.15 Take R.H. Foli.
 1/19.10 Turn Right and Follow Turn Inland Dist.
 1/19.30 Green Grasshills.
 1/21.50

NOTE: Chains required during wet season from 20.0 to 6.5.

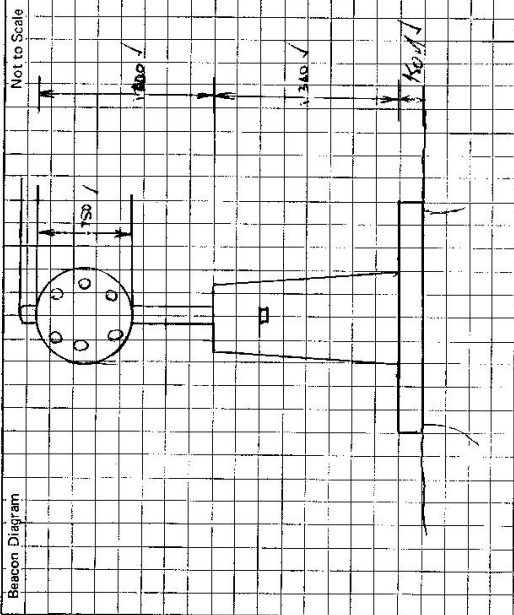

This section to be completed by officer constructing pillar.

Original station mark found/~~not found~~.

Description of mark: ~~Beacon~~ ~~with~~ ~~1/4 Dist~~

Original beacon found/~~not found~~. ~~located off~~

Description of beacon: ~~1/4 Dist~~ ~~1/4 Dist~~

Height Top of Vanes to Top Mark:m.

Height of mark: ~~2.05~~ /m. above ~~1.50~~ /cond. ~~3.60~~ /m. below G.L.

Diameter of Vanes: ~~1.15~~ /m.

Height of Cairn:m.

Original Beacon has/~~was~~ been destroyed by me.

Date	Record of Station