

TS 6401

No.: 4047

STATION: WOODGOLGA G.S. HARBOUR

MAP SHEET
SCALE 1:250 000

INSPECTED BY: D FREDRIKSEN DATE: 11/5/79

AUTHORITY: C.M.A. FIELD BOOK: 1764

GEODETIC SURVEY OF N.S.W.
CENTRAL MAPPING AUTHORITY
GEODETIC STATION RECONNAISSANCE and MAINTENANCE REPORT

Description: Note: Cross out word or words which do not apply
1. Cleared by James bearing... 1 day... for 2 lanes... 2 days... for Trig. Mast
360

2. Mast & Vanes have been painted white & black respectively.

3. The station/pillar was ~~unplaced~~/not unplaced/omitted on... 1.1.1. 19... 19... dimensions now being:

Description of mark... should be explicit, e.g. S/Steel Pillar Plate, Steel plug, Brass plug, Bolt, G.I. Pipe

Height of mark... m. above/below rock/concrete; Mark is... m. above/below G.L.

Height of Top Vanes to Top Mark/Pillar plate... m. Diameter of Vanes (vertical)... m.

Height of Cairn... m. Diameter of Cairn... m. Name Plate found/not found/placed.

Length of Mast... m. (approximate if not unplied)

4. A... set in conc/rock has been placed/found, bearing... M from Mast/Plug/Pillar

5. A... set in conc/rock has been placed/found, bearing... M from Mast/Plug/Pillar

6. A... set in conc/rock has been placed/found, bearing... M from Mast/Plug/Pillar

7. A... set in conc/rock has been placed/found, bearing... M from Mast/Plug/Pillar

8. Action required: Clearing... marks... found

STANDPOINT:

Mark	Direction	Horiz. Distance	Height Difference	Mark	Direction	Horiz. Distance	Height Difference
			above standpt				below
			below				above
			above standpt				below
			below				above
			above standpt				below
			below				above
			above standpt				below
			below				above
			above standpt				below
			below				above
			above standpt				below
			below				above

Prepared by: D FREDRIKSEN 31/8/79 Checked: 6/9/79
Noted on U.T.M. Card

SI 2733-1

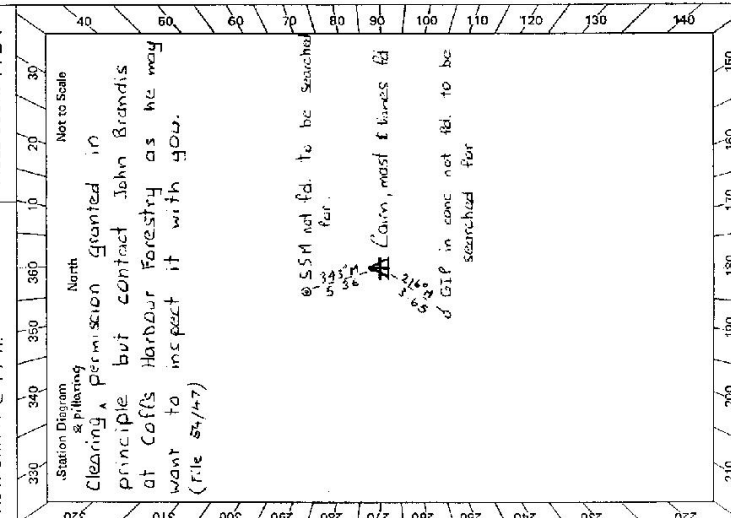

CENTRAL MAPPING AUTHORITY

GEODETIC SURVEY OF N.S.W.
 GEODETIC STATION RECONNAISSANCE and MAINTENANCE REPORT

Description:

1. Cleared by lanes bearing 210° to 140° m to 100 m to 282° m from Trig. Mast
 Note: Cross out word or words which do not apply
2. Mast & Vanes have been painted white & black respectively. ✓
3. The station/pillar was unpiled/~~not unpiled~~/~~constructed on~~ $11 - 9$ dimensions now being: 19.79
 Description of mark ~~Steel~~ ~~Pillar~~ ~~Plate~~ should be explicit, e.g., S/Steel Pillar Plate, Steel plug, Brass plug, Bolt, G.I. Pipe
 Height of mark 1.650 m. above ~~rock~~/~~concrete~~; Mark is 1.650 m. above G.L.
 Height of Top Vanes to Top Mark/Pillar plate 1.375 m. Diameter of Vanes (vertical) 0.150 m. ✓
 Height of Cairn 0 m. Diameter of Cairn 0 m. Name Plate found/~~not found~~/~~placed~~.
 Length of Mast 0 m. (approximate if not unpiled)
4. A $S.I.P.C.$ set in conc/rock has been ~~placed~~/~~found~~, bearing 210° M from Mast/Plug/Pillar
5. A $TRIG. PIN$ set in conc/rock has been ~~placed~~/~~found~~, bearing 195° M from Mast/Plug/Pillar
6. A $CONCRETE OBS PILLAR$ set in conc/rock has been placed/~~found~~, bearing 210° M from Mast/Plug/Pillar
7. A $C.I. PIPE$ set in conc/rock has been placed/~~found~~, bearing 210° M from Mast/Plug/Pillar
8. Action required: 0

STANDPOINT:

Mark	Direction	Horiz. Distance	Height Difference	Mark	Direction	Horiz. Distance	Height Difference
			above standpt.				above standpt.
			below standpt.				below standpt.
			above standpt.				above standpt.
			below standpt.				below standpt.
			above standpt.				above standpt.
			below standpt.				below standpt.
			above standpt.				above standpt.
			below standpt.				below standpt.
			above standpt.				above standpt.
			below standpt.				below standpt.

Prepared by:

Checked: *[Signature]*

Noted on U.T.M. Card

Checked

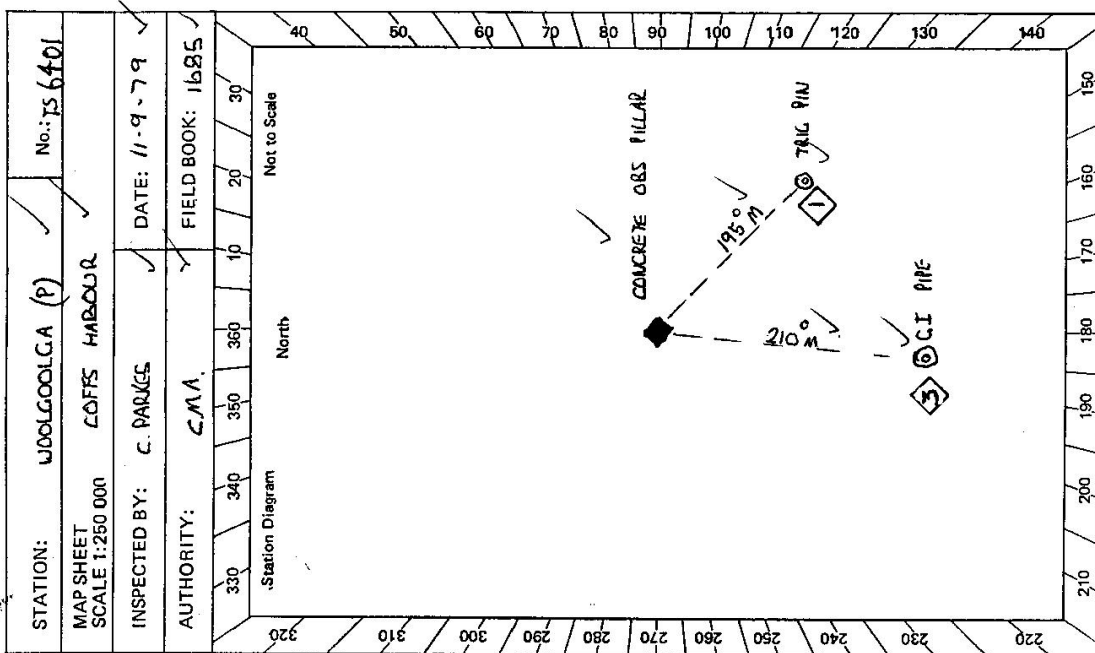

STATION: J00LGOOLCA (P) No.: JS 6401

MAPSHEET SCALE 1:250 000 COFFS HARBOUR

INSPECTED BY: C. PARLGS DATE: 11-9-79

AUTHORITY: C.M.A. FIELD BOOK: 1685

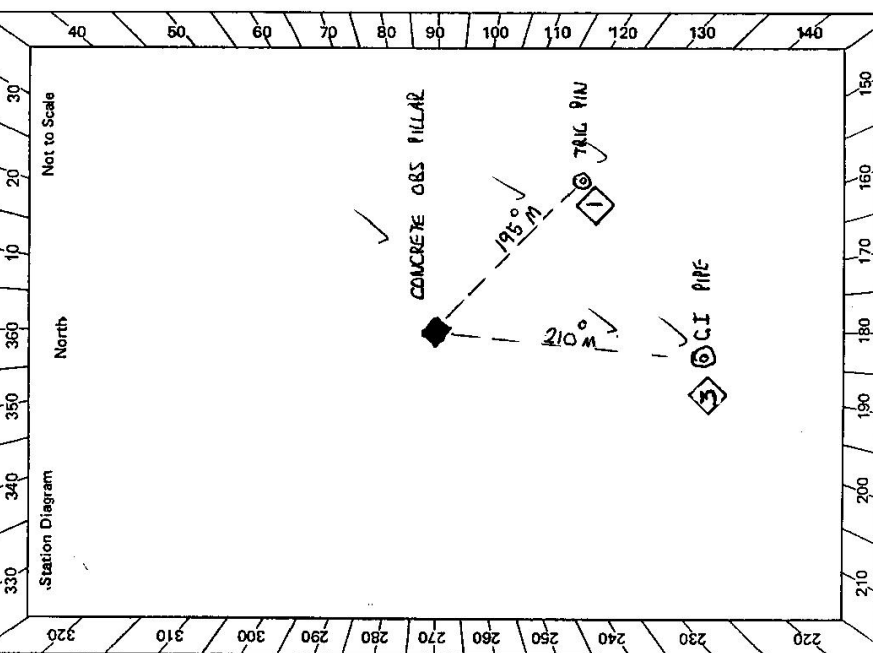

Checked

CENTRAL MAPPING AUTHORITY

GEODETIC SURVEY OF N.S.W.

GEODETIC STATION RECONNAISSANCE and MAINTENANCE REPORT

- Description:
- Cleared by James bearing $5^{\circ} - 35'$. Note: Cross out word or words which do not apply
 1. Cleared by James bearing $5^{\circ} - 35'$ $10.5 - 1.35$ from Trig. Mast
 - Mast & Vanes have been painted white & black respectively.
 - The ~~station~~ pillar was ~~unplaced/not applied~~/constructed on $1 - 9 - 1979$, dimensions now being: Description of mark ~~Sp. Pillar~~ ~~Plate~~ could be explicit, e.g. S/Steel Pillar Plate, Steel plug, Brass plug, Bolt, G.I. Pipe
 Height of mark 1.375 m. ^{above} ~~below~~ rock/concrete; Mark is 1.675 m. ^{above} ~~below~~ G.L.V.
 Height of Top Vanes to Top Mark/Pillar plate 3.77 m. Diameter of Vanes (vertical) 0.755 m.
 Height of Cairn m. Diameter of Cairn m. Name Plate ~~found/not found~~/placed.
 Length of Mast 1.57 m. (approximate if not unplied)
 - A ~~BRASS PLUG~~ set in conc/rock has been ~~placed~~/found, bearing $197^{\circ} M$ from ~~Mast/Plug~~/Pillar
 - A ~~S.S.M~~ set in conc/rock has been ~~placed~~/found, bearing $312^{\circ} M$ from ~~Mast/Plug~~/Pillar
 - A ~~G.I. PIPE~~ set in conc/rock has been ~~placed~~/found, bearing $205^{\circ} M$ from ~~Mast/Plug~~/Pillar
 - A set in conc/rock has been placed/found, bearing $^{\circ} M$ from Mast/Plug/Pillar
 - Action required:

Mark	Direction	Horiz. Distance	Height Difference	STANDPOINT: CONCRETE OBS Pillar		STANDPOINT: BRASS PLUGS	
				Mark	Direction	Horiz. Distance	Height Difference
RED ROCK PILLAR	359 59 60		above standpt	RED ROCK PILLAR	359 59 60		above standpt
SOUTH SPLITRAY 1/4	106 55 00		above standpt	SOUTH SPLITRAY 1/4	106 59 10		above standpt
BRASS PLUG	177 22 00	3.069	above standpt	G.I. PIPE	196 21 10	3.649	above standpt
G.I. PIPE	187 41 40	6.625	above standpt	S.S.M	324 57 40	5.389	above standpt
S.S.M	294 32 35	3.245	below standpt	Woolgoogah Pillar	357 21 20	3.070	below standpt
			below				below

Prepared by: *[Signature]* Checked: *[Signature]* 31/05/22 Notes on U.T.M. Card

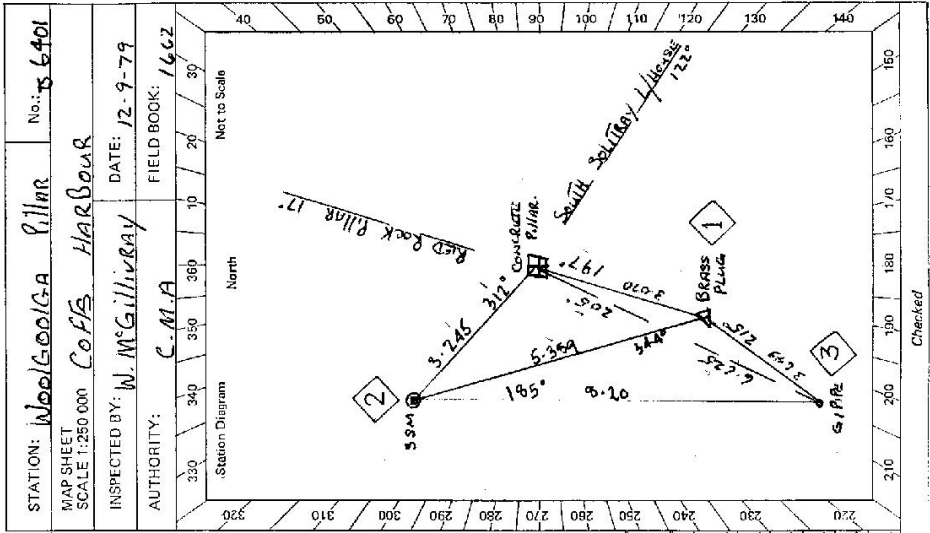

STATION: Woolgoogah Pillar No. 6401
 MAP SHEET SCALE 1:250 000
 INSPECTED BY: W. McGILLIVRAY DATE: 12-9-79
 AUTHORITY: C.M.A. FIELD BOOK: 1662

Station Diagram
 North
 Net to Scale

Checked

SI 2753-1

St 2733 - 2 D. West, Government Printer

Beacon Diagram

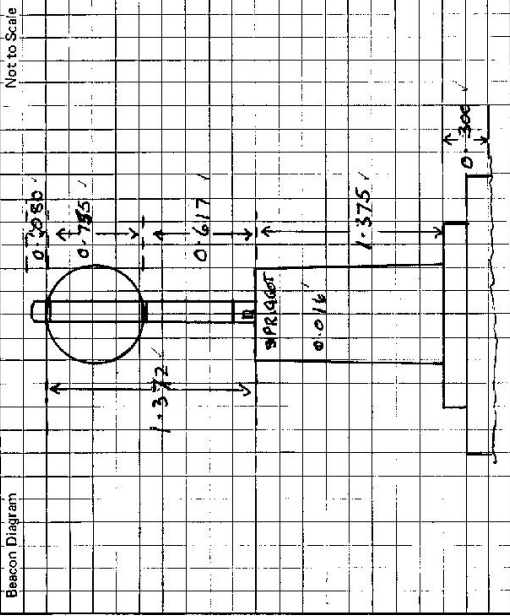

This section to be completed by officer constructing pillar.

Original station mark found/~~not found~~.

Description of mark: BRASS PLAG

Original beacon found/~~not found~~.

Description of beacon: ROCK CAIRN, MAST & VANES

Height Top of Vanes to Top Mark: 3.790 m.

Height of mark 0.016 m. ^{above} rock/conc. 0.580 ^{above} G.L. _{below}

Diameter of Vanes 0.920 m. Height of Cairn 1.00 m.

Original Beacon has/~~has not~~ been destroyed by me.

STATION Woolpool SA Q.L.H.R. 75 6401

Owner's Name: MEDDING BULLS STATE FOREST

Address: BRIAN LANE

FORESTRY COMMISSION

Phone: COFFS HARBOUR 521822

Current Occupant:
Address:
Phone:

ACCESS

Access Report of 11.2.1978 was found suitable/~~was suitable~~.

Date

Record of Station

GEODETTIC SURVEY OF N.S.W.

CENTRAL MAPPING AUTHORITY

GEODETTIC STATION RECONNAISSANCE and MAINTENANCE REPORT

Description:

1. Cleared by lanes bearing..... Note: Cross out word or words which do not apply
..... from Trig. Mast.

2. Mast & Vanes have been painted white & black respectively.

3. The station/pillar was unplied/~~not unplied~~/~~constructed~~ on November 23, 1979, dimensions now being:
S/Steel PILLAR

Description of mark..... Plates..... should be explicitly eg, S/Steel Pillar Plate, Steel plug, Brass plug, Bolt, G.I. Pipe

Height of mark..... 1.368 m..... Mark is..... m..... above
below G.L.

Height of Top Vanes to Top Mast/Pillar plate..... 1.368 m..... Diameter of Vanes (vertical)..... 0.750 m.

Height of Cairn..... m..... Diameter of Cairn..... m. Name Plate found/~~not found~~/~~placed~~.

Length of Mast..... m. (approximate if not unplied)

4. A. Brass PLUG..... set in conc/rock has been ~~placed~~/~~found~~, bearing..... 196°M from Mast/Plug/Pillar
G.I. Pipe

5. A.G.I.Nail/An.G.I.P... set in conc/~~rock~~ has been ~~placed~~/~~found~~, bearing..... 206°M from Mast/Plug/Pillar

6. A..... set in conc/rock has been placed/~~found~~, bearing..... °M from Mast/Plug/Pillar

7. A..... set in conc/rock has been placed/~~found~~, bearing..... °M from Mast/Plug/Pillar

8. Action required:.....

STANDPOINT: Brass PLUG Found in Rock well				STANDPOINT: S/Steel PILLAR Spigot & Plate			
Mark	Direction	Horiz. Distance	Height Difference	Mark	Direction	Horiz. Distance	Height Difference
SOUTH SOLITARY LH	137 17 42		above standpt	SOUTH SOLITARY LH	137 18 19		above standpt
G.I.Nail/G.I. Pipe	226 47 08	3.643	0.70 below standpt	Brass PLUG found	207 42 43	3.071	2.19 below standpt
BROWNS KNOB (P)	353 00 27		below standpt	G.I.NAIL/G.I.Pipe	218 04 36	6.623	1.49 below standpt
PILLAR Spigot	27 43 00	3.070	2.19 above standpt	RED ROCK (P)	30 23 21		below standpt
RED ROCK (P)	30 23 18		below standpt	OCEAN VIEW (P)	54 19 38		above standpt
OCEAN VIEW (P)	54 18 52		below standpt	WOOLGOOLGA Res. (P)	103 07 14		above standpt
WOOLGOOLGA Res. (P)	103 05 21		below standpt				below standpt

Prepared by: *H. Jackson* 13/12/79 Checked: *H. Jackson*

Sr 2738-1

Checked

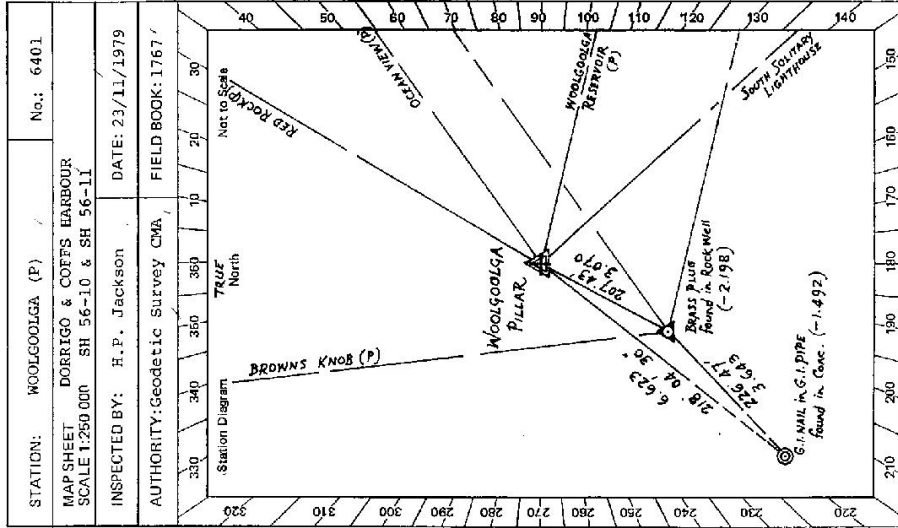

STATION: WOOLGOOLGA (P) No.: 6401
MAP SHEET DOBRIGO & COFFS HARBOUR
SCALE 1:250 000 SH 56-10 & SH 56-11
INSPECTED BY: H.P. Jackson DATE: 23/11/1979
AUTHORITY: Geodetic Survey CMA FIELD BOOK: 1767

SI 2733-2 D. West, Government Printer

STATION WOOLGOOLGA (P) No.: 6401

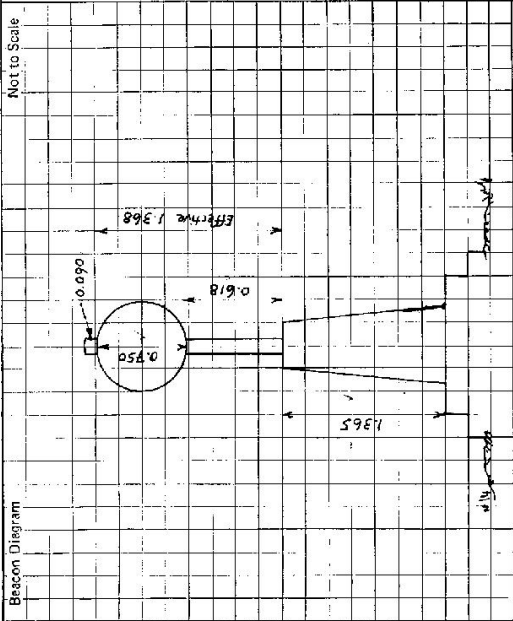

Owner's Name:
 Address:
 Phone:
 Current Occupant:
 Address:
 Phone:

ACCESS
 Access Report of...../19.....was found suitable/unavailable.

This section to be completed by officer constructing pillar.

Original station mark found/not found.

Description of mark:

Original beacon found/not found.

Description of beacon:

Height Top of Vanes to Top Mark.....m.

Height of mark.....m. above G.L.
 rock/conc.....m. below

Diameter of Vanes.....m. Height of Cairn.....m.

Original Beacon has/has not been destroyed by me.

Date	Record of Station