

Department of Lands

RECONNAISSANCE and MAINTENANCE REPORT

Integrated Survey of N.S.W.

This Trig. Station has been:

Note: Cross out word or words which do not apply

1. Completely cleared to permit 360° vision to surrounding Trigs.

2. ~~Cleared to allow access to base~~

~~Access to Mast~~

3. Trig. Mast & Vanes have been painted white & black respectively.

4. The Trig. was unpiled/not unpiled, dimensions now being:

Description of mark: Steel Plate on Concrete. Pillar would be explicit, e.g. Steel plug, Brass plug, Bell Concrete Pillar

Height of mark: 1.44 m above rock concrete 1.44 m above G.L.

Height of Top Vanes to ~~Horizontal~~ Top pillar plate: 1.44 m Diameter of Vanes (vertical) 0.60 m.

Height of Cairn:          m. Diameter of Cairn:          m.

Length of Mast: 1.53 m. (approximate if not unpiled)

5. A. SSM 23338 set in conc./~~rock~~ has been placed 1.27 m. bearing         °M from ~~Trig~~ pillar

6. A copper spike in conc./~~rock~~ has been placed 1.43 m. bearing         °M from ~~Trig~~ pillar

7. A. HR 33002 set in conc./~~rock~~ has been placed 1.38 m. bearing         °M from Trig. Mast/pillar

8. A.          set in conc./rock has been placed          m. bearing         °M from Trig. Mast/pillar

9. Connection SSM to C. Spike:          m. bearing 353°M

10. Connection:          to         :          m. bearing         °M

11. Connection:          to         :          m. bearing         °M

12. Connection:          to         :          m. bearing         °M

13. Diff. Ht. SSM 23338 is 1.491 m.          PILLAR.

14. Diff. Ht. Copper Spike is 1.817 m.          PILLAR.

15. Diff. Ht. SSM 23338 is 0.326 m.          COPPER SPIKE.

16. Diff. Ht.          is          m.         

STATION 25 (BYRON VIEW) 6393

Co: ROUIS Ph: BYRON

Map Sheet: BYRON BAY No: 9610-IV-9

Inspected by: G.P. WALDE Date: 25-1-77

Authority: Field Book:

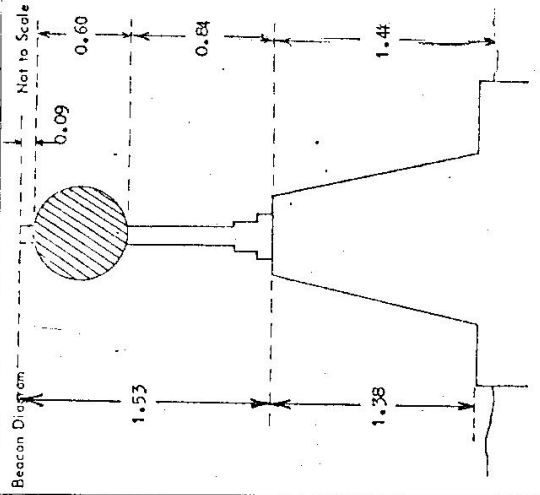

Beacon Diagram

Date: 3/12/76

Record of Station: Pillar erected

BYRON VIEW (1)

STATION TS ( BYRON VIEW ) 6393

Owners Name: Reserve for PMG

Address: TELECOM AUSTRALIA

LISHORE

Access 25-1-77

Current Occupant

Address

0.0 From Bangalow Post Office follow Pacific highway north,  
 5.8 turn right onto bitumen road to Saint Helena,  
 7.7 turn right through gate and follow bitumen track,  
 7.9 Pillar on left.

NOTE: All weather access

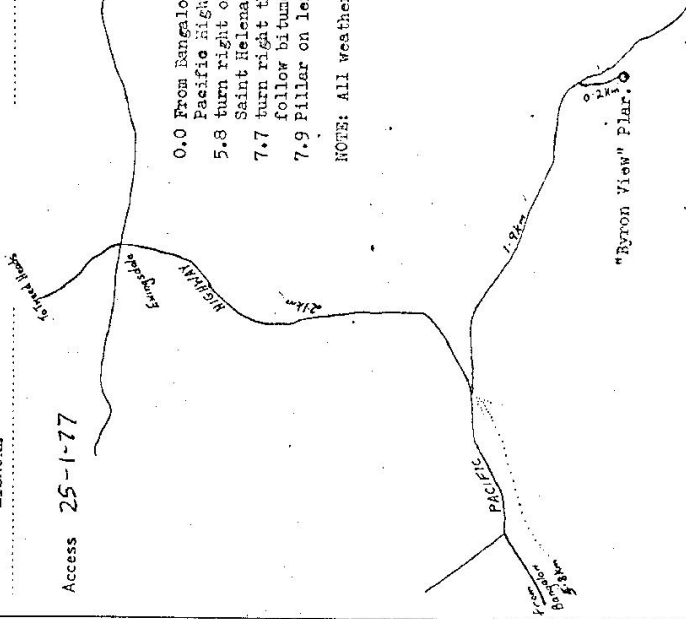

D. West, Government Printer, New South Wales - 1976

Not to Scale

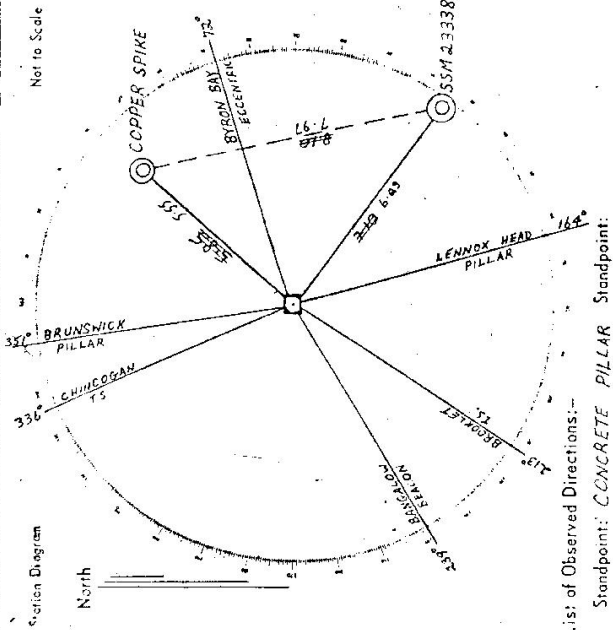

List of Observed Directions:-

Standpoint: CONCRETE PILLAR

Station	Direction	Station	Direction

BYRON VIEW TS

GEODETIC SURVEY OF N.S.W.

CENTRAL MAPPING AUTHORITY

GEODETIC STATION RECONNAISSANCE and MAINTENANCE REPORT

STATION: **BYRON VIEW GSOP** No.: **6393**

Description:

*Note: Cross out word or words which do not apply*

- Cleared by lanes bearing **No. clearing needed** for **connections** from Trig, Mast
- Mast & Vanes have been painted white & black respectively.
- The station/pillar was ~~emptied~~ ~~emptied~~ /constructed on ..... 19....., dimensions now being:  
Description of mark **S.I.S. Pillar. Plates** should be explicit, e.g. S/Steel Pillar Plate, Steel plug, Brass plug, Bolt, G.I. Pipe  
Height of mark.....m. above rock/concrete; Mark is.....m. above below G.L.  
Height of Top Vanes to Top Mark/Pillar plate **1.440**.....m. Diameter of Vanes (vertical) **0.600**.....m.  
Height of Cairn.....m. Diameter of Cairn.....m. Name Plate found/~~not found~~/~~placed~~.  
Length of Mast.....m. (approximate if not unplied)
- A.C.N. Nail**.....set in conc/tee has been ~~placed~~/found, bearing...**S.L.**.....°M from Mast/~~Plug~~/~~Pillar~~ **5.55** m
- A.S.S.M. 2.3.3.3.3**.....set in conc/tee has been ~~placed~~/found, bearing...**L.R.D.**.....°M from Mast/~~Plug~~/~~Pillar~~ **6.9** m
- A**.....set in conc/rock has been placed/found, bearing.....°M from Mast/~~Plug~~/~~Pillar~~
- A**.....set in conc/rock has been placed/found, bearing.....°M from Mast/~~Plug~~/~~Pillar~~
- Action required: **Painting, Rilen, bolts replaced, connections**.....

STANDPOINT: **GSOP**

Mark	Direction	Height Difference	Mark	Direction	Height Difference
<b>CAPE BYRON GSOP</b>	<b>72° 17' Grid</b>	above standpt	<b>DUNGOON GSOP</b>	<b>266° 26' Grid</b>	above standpt
<b>BROOKLET GSOP</b>	<b>OTHERS</b>	above standpt	<b>PEARCES CRK</b>	<b>217° 14' "</b>	above standpt
<b>CHINGOGHAN GSOP</b>	<b>214° 07' Grid</b>	above standpt			above standpt
<b>BRUNSWICK GSOP</b>	<b>334° 43' "</b>	above standpt			above standpt
<b>JULIAN GSOP</b>	<b>351° 41' "</b>	above standpt			above standpt
<b>GOONENGERRY (hill)</b>	<b>61° 05' "</b>	above standpt			above standpt
	<b>297° 50' proved</b>	below standpt			below standpt

Prepared by: **D. Fredriksen** 25/3/80 Checked: **P. Hollick** Noted on U.T.M. Card

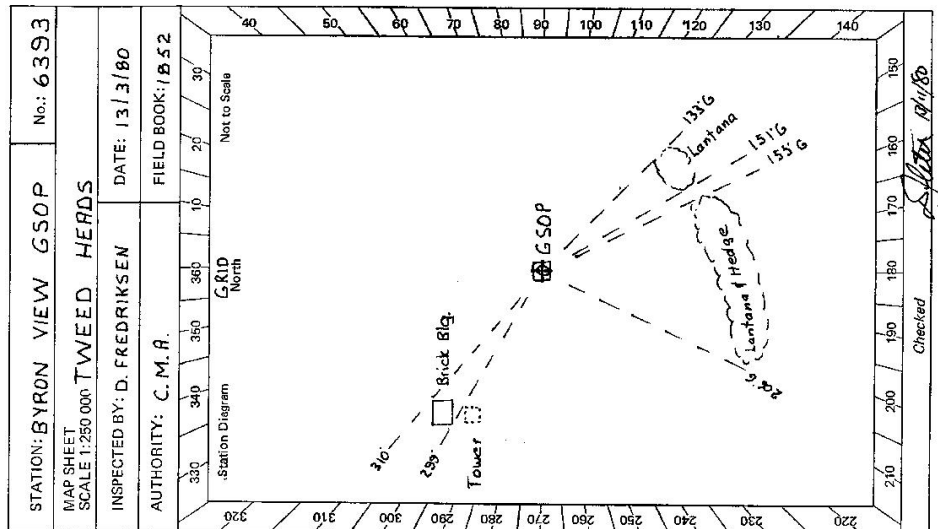

Checked

25/3/80

2735-2 D. West, Government Printer

Beacon Diagram

Not to Scale

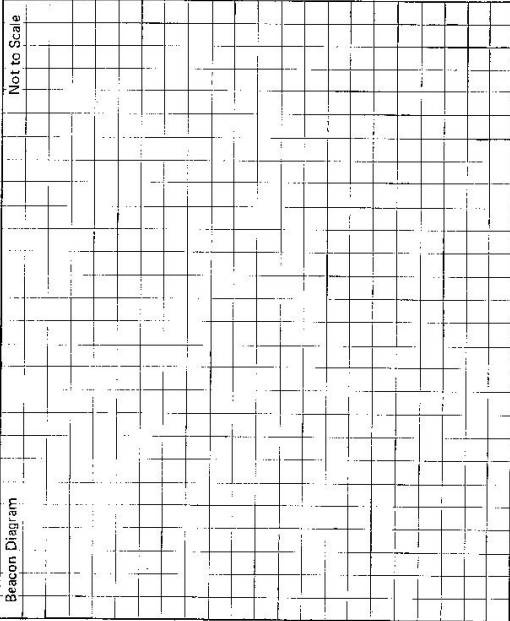

This section to be completed by officer constructing pillar.

Original station mark found/not found.

Description of mark: .....

Original beacon found/not found.

Description of beacon: .....

Height Top of Vanes to Top Mark: .....m.

Height of mark: .....m. above rock/conc .....m. above G.L.  
below below

Diameter of Vanes .....m. Height of Calm .....m.

Original Beacon has/hes not been destroyed by me.

STATION **BYRON VIEW G.S.O.P 6393**

Owner's Name: **RESERVE for P.M.G.** Current Occupant: .....  
 Address: **TELECOM** Address: .....  
 Phone: **LISMORE** Phone: .....

**ACCESS**

Access Report of 25/11/1971 was found suitable/suitable.

**feature**

**BANGALOW RD. head north along Pacific Hwy**  
**Turn RIGHT onto bitumen road to Saint Helena**  
**This turn off is 2.1 km south of EWINGSDALE ie the**  
**Byron Bay turn off.**  
**Turn RIGHT through gate along bitumen track**  
**Pillar on LEFT.**

**7.0**

**5.8**

**7.7**

**7.9**

Date

Record of Station

No clearing or construction required, public access, so no permissions have been sought.

GEODETTIC SURVEY OF N.S.W.

CENTRAL MAPPING AUTHORITY

GEODETTIC STATION RECONNAISSANCE and MAINTENANCE REPORT

Description:

1. Cleared by lances bearing  $298^{\circ} 46'$   $131^{\circ}$   $137^{\circ} 46'$   $165^{\circ} 19'$  to  $273^{\circ}$  from Trig. Mast  
Note: Cross out word or words which do not apply
2. Mast & Vanes have been painted white & black respectively. ✓
3. The ~~station~~/pillar was ~~constructed~~/constructed on  $2.7$  m  $19.8$  m, dimensions now being:  
 Description of mark  $2.7$  m  $19.8$  m should be explicit, e.g., S/Steel Pillar Plate, Steel plug, Brass plug, Bolt, G.I. Pipe
- Height of mark  $1.45$  m above ~~concrete~~/concrete; Mark is  $1.45$  m above G.L.
- Height of Top Vanes to Top ~~mark~~/Pillar plate  $1.45$  m. Diameter of Vanes (vertical)  $0.25$  m.
- Height of Cairn  $0$  m. Diameter of Cairn  $0$  m. Name Plate ~~not placed~~/placed.
- Length of Mast  $0$  m. (approximate if not unplied)
4. A. ~~Copper Nail~~ set in conc/~~mark~~ has been ~~placed~~/found, bearing  $45^{\circ}$  M from ~~mark~~/Pillar
5. A. ~~S.S.M. 23338~~ set in conc/~~mark~~ has been ~~placed~~/found, bearing  $40^{\circ}$  M from ~~mark~~/Pillar
6. A. ~~set in conc/rock~~ has been placed/found, bearing  $0^{\circ}$  M from Mast/Plug/Pillar
7. A. ~~set in conc/rock~~ has been placed/found, bearing  $0^{\circ}$  M from Mast/Plug/Pillar
8. Action required: ~~set in conc/rock~~

STANDPOINT: ~~S.S.M. 23338~~

Mark	Direction	Horiz. Distance	Height Difference	Mark	Direction	Horiz. Distance	Height Difference
Cape Byron (A)	0 00 00		above standpt.	Cape Byron (A)	0 00 00		above standpt.
S.S.M. 23338	68 25 00	6.894	above standpt.	Beaconslet (A)	141 55 26		above standpt.
Beaconslet (A)	141 50 16		above standpt.	Beaconslet (B)	165 00 50		above standpt.
Beaconslet (B)	165 52 16		above standpt.	Cape obs. Pillar	248 28 10	6.894	above standpt.
Copper Nail	349 42 38	5.546	above standpt.	Copper Nail	271 36 00	7.657	above standpt.
			below standpt.				below standpt.
			below standpt.				below standpt.

Prepared by: *F. Morris* 10-12-80. Checked: *F. Morris* Noted on U.T.M. Card

SY 2735-1

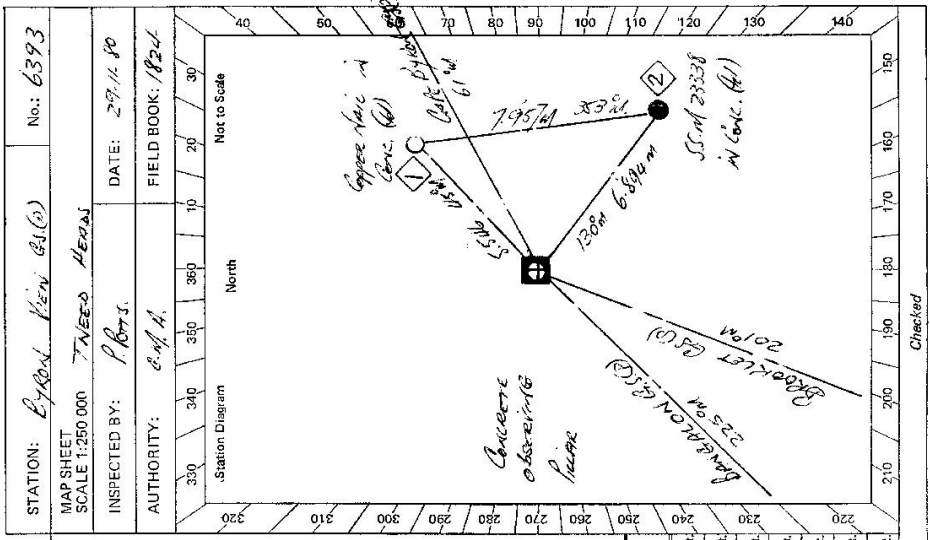

Checked

61-2723-2 D. West, Government Printer

STATION *Byron View (S.O.) 6393*

Owner's Name: *RESERVE FOR P.A.S.*  
 Address: *TELECOM*  
 Phone: *DISPATCH*  
 Current Occupant:  
 Address:  
 Phone:

ACCESS

Access Report of 27.11.1980 was found suitable/unsuitable.

*61  
000  
580  
770  
796*  
 FEATURE: *BENEFICON HEAD NORTH HONG HONG ROAD*  
*TURN RIGHT SIGN SIGN HONG HONG ROAD*  
*TURN RIGHT THROUGH IRON GATE*  
*BYRON VIEW (S.O) ALONG SIDE TELECOM TOWER*

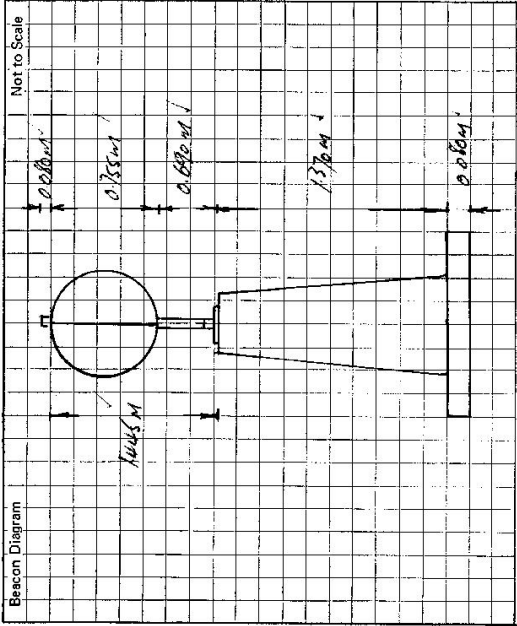

This section to be completed by officer constructing pillar.

Original station mark found/not found.

Description of mark: .....

Original beacon found/not found.

Description of beacon: .....

Height Top of Vanes to Top Mark.....m.

Height of mark.....m. above rock/contc.....m. below G.L.

Diameter of Vanes.....m.

Original Beacon has/has not been destroyed by me. Height of Cairn.....m.

Date	Record of Station