

GEODETTIC SURVEY OF ALSW

CENTRAL MAPPING AUTHORITY

GEODETTIC STATION RECONNAISSANCE and MAINTENANCE REPORT

STATION: ENMORRE (P) ^{TS} No: 6326
 MAP SHEET SCALE 1:250 000
 INSPECTED BY: J.M. Gillivray DATE: 30-3-79
 AUTHORITY: CMA FIELD BOOK: 1657

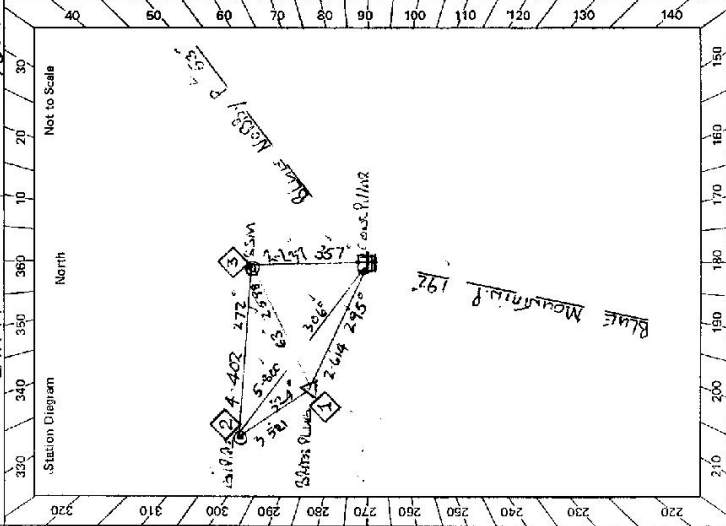

- Description: *Note: Cross out word or words which do not apply*
- Cleared by lanes bearing 360 from Trig, Mast
 - Mast & Vanes have been painted white & black respectively. ✓
 - The station/pillar was ~~unplaced~~/constructed on 2.6 ³ 197.9, dimensions now being: Description of mark 3/4" Brass Pillar should be explicit, e.g., S/Steel Pillar Plate, Steel plug, Brass plug, Bolt, G.I. Pipe
 Height of mark 3.36 ^{above} 3.36 _{below} m. Mark is concrete ^{above} concrete _{below}.
 Height of Top Vanes to Top Mark/Pillar plate 1.48 ^{above} 1.48 _{below} m. Diameter of Vanes (vertical) 0.755 m.
 Height of Cairn 0.528 m. Diameter of Cairn 0.528 m. Name Plate found/not found/placed.
 Length of Mast 1.528 m. (approximate if not unplied)
 - A Brass Trig Plate set in conc/rock has been placed/found, bearing 295 M from Mast/Plug/Pillar
 - A S.S.M. set in conc/rock has been placed/found, bearing 357 M from Mast/Plug/Pillar
 - A G.I. Pipe set in conc/rock has been placed/found, bearing 306 M from Mast/Plug/Pillar
 - A S.S.M. set in conc/rock has been placed/found, bearing 271 M from Mast/Plug/Pillar

STANDPOINT: CONC CIB P/LAR			STANDPOINT: BRASS TRIG PLUG				
Mark	Direction	Horiz. Distance	Height Difference	Mark	Direction	Horiz. Distance	Height Difference
BLUe MOUNTAIN	359 59 60		above standpt.	BLUe MOUNTAIN	359 59 60		above standpt.
TRIG PLUG	91 11 40	2.614	above standpt.	G.I. PIPE	129 58 40	3.521	above standpt.
G.I. PIPE	113 22 55	5.800	above standpt.	BLUe MOUNTAIN	219 10 35		above standpt.
S.S.M.	150 28 10	2.237	above standpt.	S.S.M.	220 23 10	2.599	above standpt.
BLUe Nobby	219 04 25		above standpt.	ENMORRE PILLAR	271 14 10	2.615	above standpt.
			below				below

Prepared by: *[Signature]* Checked: *[Signature]* ^{8 57 28} Noted on U.T.M. Card

STATION **ENMORE (E) IS 6326**

Owner's Name:
 Address:
 Phone:

Current Occupant:
 Address:
 Phone:

ACCESS

Access Report of 30/3/1971 was found suitable/unstable.

- 0-0 P.O. ORIGINALLY PROCEEDED UP FAULKNER ST
- 1-3 TURN LEFT INTO KENTUCKY STREET
- 2-2 TURN RIGHT INTO KENNEDY STREET
- 4-2 TURN LEFT SIGN DANGAR FALLS
- 10-2 PASS DANGAR FALLS ZWAN AW LEFT
- 11-3 DANGARLEIGH SCHOOL OF ART ON RIGHT
- 12-2 GO LEFT SIGN ENMORE MELROSE
- 21-1 PASS MILLS, WRALLA ROAD ON RIGHT
- 27-4 GO LEFT SIGN BLUE NOBBY, SHERWOOD, MELROSE,
- 30-3 MELROSE SCHOOL ON LEFT
- 33-4 TURN RIGHT WOODEN GATE (MOOREN" on Enmore 1950s)
- 34-4 GATE OWNERS HOUSE ON RIGHT, FOLLOW TRACK DRUMS ON LEFT
- 34-6 TO GATE BETWEEN SHEDS
- 34-8 THROUGH GATE & TURN RIGHT AROUND HAY SHED.
- 35-2 WOODEN GATE INTO LAINE
- 35-2 WOODEN GATE ON RIGHT FOLLOW FAINI TRACK THROUGH TIMBER
- 36-1 DRIVE UP ONTO SADDLE THEN TO G.S.

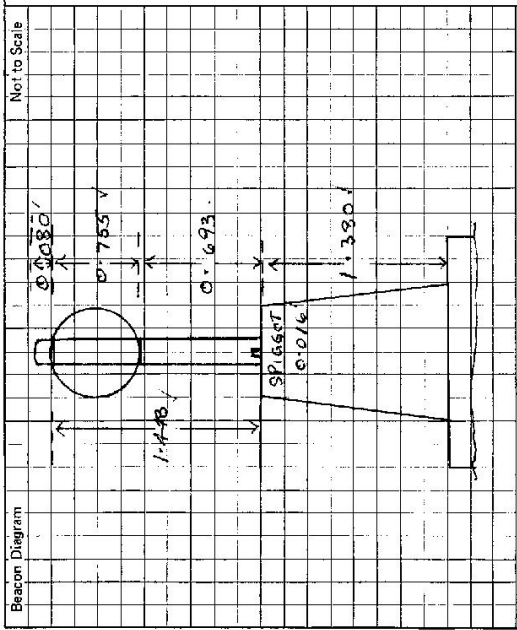

This section to be completed by officer constructing pillar.

Original station mark found/lost/used.

Description of mark: **BRASS TRIG PUG**

Original beacon found/lost/used.

Description of beacon: **CALIBR. MOUNT * MARKS**

Height Top of Vanes to Top Mark: **3.028** m.

Height of mark: **0.74m** above **active G.L.** / **0.74m** below **rest/cont.**

Diameter of Vanes: **0.765** m. Height of Calm: **1.56** m.

Original Beacon has/has not been destroyed by me.

Date: Record of Station: