

CENTRAL MAPPING AUTHORITY

GEODETIC SURVEY OF N.S.W.

GEODETIC STATION RECONNAISSANCE and MAINTENANCE REPORT

STATION: BOSIA (Pillar) No.: 6314

MAP SHEET SCALE 1:250 000 DORRIGO

INSPECTED BY: W M Gillivray DATE: 9-7-79

AUTHORITY: CMA FIELD BOOK: 662

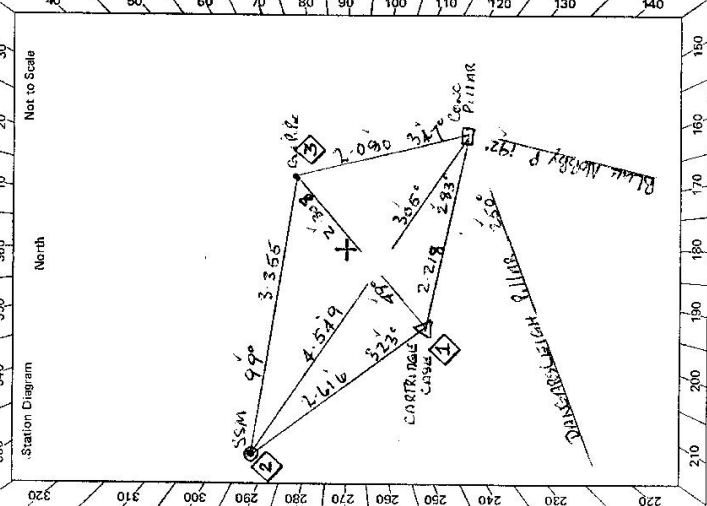

- Description:
- Cleared by lanes bearing 36.0°. Note: Cross out word or words which do not apply
 - Mast & Vanes have been painted white & black respectively.
 - The station/pillar was unplied/not unplied/constructed on 7.7.1979, dimensions now being: Description of mark S.S.M. Pillar should be explicit, e.g., S/Steel Pillar Plate, Steel plug, Brass plug, Bolt, G.I. Pipe
Height of mark 1.375 m. above rock/concrete; Mark is 3.95 m. above G.L. ✓
Height of Top Vanes to Top Mark/Pillar plate 1.437 m. ✓ Diameter of Vanes (vertical) 0.755 m.
Height of Cairn 0.571 m. Diameter of Cairn 0.571 m. Name Plate found/not found/placed.
Length of Mast 1.571 m. (approximate if not unplied)
 - CARRIDGE CASE set in conc/rock has been placed/found, bearing 283.6° M from Mast/Plug/Pillar
 - S.S.M. set in conc/rock has been placed/found, bearing 305.6° M from Mast/Plug/Pillar
 - G.I. Pipe set in conc/rock has been placed/found, bearing 347.0° M from Mast/Plug/Pillar
 - A. set in conc/rock has been placed/found, bearing 219.0° M from Mast/Plug/Pillar
 - Action required:

Mark	Direction	Horiz. Distance	Height Difference	Mark	Direction	Horiz. Distance	Height Difference
<u>Black Mercury P.</u>	<u>359 69 60</u>	<u>359 69 60</u>	above standpt.	<u>Black Mercury P.</u>	<u>359 69 60</u>	<u>359 69 60</u>	above standpt.
<u>DARRIGAN P.</u>	<u>58 25 50</u>	<u>58 25 50</u>	above standpt.	<u>DARRIGAN P.</u>	<u>58 25 50</u>	<u>58 25 50</u>	above standpt.
<u>CARRIDGE CASE</u>	<u>91 23 25</u>	<u>2.217</u>	above standpt.	<u>S.S.M.</u>	<u>131 13 05</u>	<u>2.616</u>	above standpt.
<u>S.S.M.</u>	<u>113 02 05</u>	<u>4.549</u>	above standpt.	<u>G.I. Pipe</u>	<u>216 43 50</u>	<u>2.308</u>	above standpt.
<u>G.I. Pipe</u>	<u>156 21 00</u>	<u>2.030</u>	above standpt.	<u>BOSIA Pillar</u>	<u>271 25 00</u>	<u>2.219</u>	above standpt.
			below standpt.				below standpt.
			below standpt.				below standpt.

STANDPOINT: CONCRETE PILLAR STANDPOINT: CARRIDGE CASE
 Prepared by: W M Gillivray 20/4/79 Noted on U.T.M. Card
 Checked: W M Gillivray

STATION **BORA (VILLAGE) 6314**

Owner's Name: **M.A. I.M.A.R.**
 Address:
 Phone:
 Current Occupant:
 Address:
 Phone:

ACCESS
 Access Report of:/19..... was found suitable/unsuitable.

- 0.0 FROM ARMADALE TAKE DORRIGO ROAD FOR 23 KM TURN RIGHT ONTO GRAVEL ROAD SIGN HILLEROVE, BAKERS CREEK FALLS
- 4.5 TURN RIGHT SIGN HILLEROVE, KEMBRAY GRANITON
- 6.8 TURN LEFT SIGN LONGE POINT ROAD
- 9.0 TURN LEFT SIGN EDGARS ROAD, GATE.
- 10.6 GATE.
- 10.8 GATE. FOLLOW TRACK PAST HOUSE.
- 11.1 OWNERS HOUSE
- 11.2 GATE.
- 11.5 GATE
- 11.7 GATE GO THROUGH + TURN SHARP LEFT FOLLOW POINT TRACK.
- 13.0 G.S.

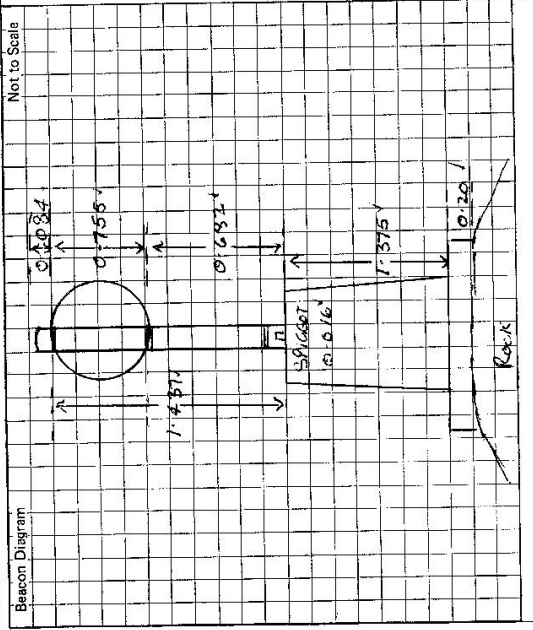

Beacon Diagram Not to Scale

This section to be completed by officer constructing pillar.
 Original station mark found/~~not found~~.
 Description of mark: **CARRIAGE CASE**
 Original beacon found/~~not found~~.
 Description of beacon: **CAIRN MARK V. V. MARKS**
 Height Top of Vanes to Top Mark: **3.398** m.
 Height of mark: **0.022** m. above rock/~~cont~~ **0.150** m. above G.L. below
 Diameter of Vanes: **0.975** m. Height of Cairn: **1.50** m.
 Original Beacon has/~~has not been~~ destroyed by me.

Date	Record of Station

CENTRAL MAPPING AUTHORITY

GEODETIC SURVEY OF N.S.W.

GEODETIC STATION RECONNAISSANCE and MAINTENANCE REPORT

Description:

1. Cleared by lanes bearing.....
Note: Cross out word or words which do not apply
2. Mast & Vanes have been painted white & black respectively.
from Trig. Mast
3. The station/pillar was unpiled/not unpiled/constructed on.....
19....., dimensions now being:
- Description of mark.....
should be explicit, e.g., Steel Pillar Plate, Steel plug, Brass plug, Bolt, G.I. Pipe
- Height of mark.....
above rock/concrete; Mark is.....m. below G.L.
- Height of Top Vanes to Top Mark/Pillar plate.....
Diameter of Vanes (vertical).....m.
- Height of Cairn.....
Diameter of Cairn.....m. Name Plate found/not found/placed.
- Length of Mast.....
(approximate if not-empiled)
4. A.....
set in conc/rock has been placed/found, bearing.....° M from Mast/Plug/Pillar
5. A.....
set in conc/rock has been placed/found, bearing.....° M from Mast/Plug/Pillar
6. A.....
set in conc/rock has been placed/found, bearing.....° M from Mast/Plug/Pillar
7. A.....
set in conc/rock has been placed/found, bearing.....° M from Mast/Plug/Pillar
8. Action required.....

STANDPOINT:

Mark	Direction	Horiz. Distance	Height Difference	Mark	Direction	Horiz. Distance	Height Difference
			above standpt				above standpt
			below standpt				below standpt
			above standpt				above standpt
			below standpt				below standpt
			above standpt				above standpt
			below standpt				below standpt
			above standpt				above standpt
			below standpt				below standpt
			above standpt				above standpt
			below standpt				below standpt

Prepared by: *m. v. red.*

Checked: *W. J. 13/14*

Noted on U.T.M. Card

SR 2733-1

STATION: BORA USDP No.: 6314-1064

MAPSHEET SCALE 1:250 000 DORRIGO

INSPECTED BY: C. ZAHRA DATE: 23-10-19

AUTHORITY: CMA FIELD BOOK: *xxxx*

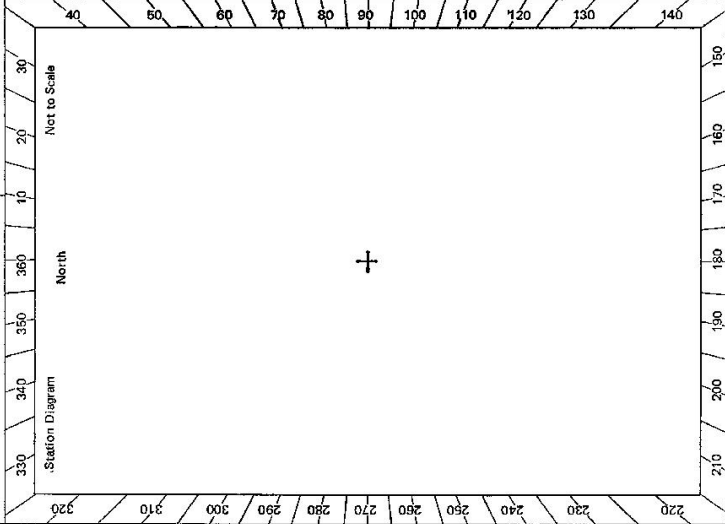

Checked

