

7408

CENTRAL MAPPING AUTHORITY
 Department of Lands
 Trigonometrical Survey of N.S.W.
 RECONNAISSANCE and MAINTENANCE REPORT

STATION **BANDA BANDA** **6305**

Co: **DUDLEY** Ph: **DUDLEY**
 Map Sheet: **COWARRAL** No: **9335**
 Inspected by: **M.L. MacKison** Date: **9-8-77**
 Authority: **Field Book: 1587**

This Trig. Station has been:- *Timber and backing*
 completely ~~elevated to permit~~ 360° vision to surrounding Trigs.

1. Cleared by limes bearing from Trig. Mast
2. Trig. Mast & Vanes have been painted white & black respectively. —
3. The Trig. was unpiled/not unpiled, dimensions now being: —

Note: Cross out word or words which do not apply

Description of mark..... should be explicit, e.g. Steel plug, Brass plug, Bolt, G.I. Pipe
 Height of mark..... m ^{above} _{below} rock/concrete m ^{above} _{below} G.L.
 Height of Top Vanes to Top Mark..... m. Diameter of Vanes (vertical)..... m.
 Height of Cairn..... m. Diameter of Cairn..... m. ^{1.60 top} _{2.40 base}
 Length of Mast..... m. (approximate if not unpiled)

5. A..... set in conc/rock has been placed..... m. bearing..... °M from Trig. Mast
6. A..... set in conc/soil has been placed..... m. bearing..... °M from Trig. Mast
7. A..... set in conc/soil has been placed..... m. bearing..... °M from Trig. Mast
8. A..... set in conc/rock has been placed..... m. bearing..... °M from Trig. Mast
9. Connection..... to..... m. bearing..... °M
10. Connection..... to..... m. bearing..... °M
11. Connection..... to..... m. bearing..... °M
12. Connection..... to..... m. bearing..... °M
13. Diff. Ht. is..... m. ^{above} _{below}
14. Diff. Ht. is..... m. ^{above} _{below}
15. Diff. Ht. is..... m. ^{above} _{below}
16. Diff. Ht. is..... m. ^{above} _{below}

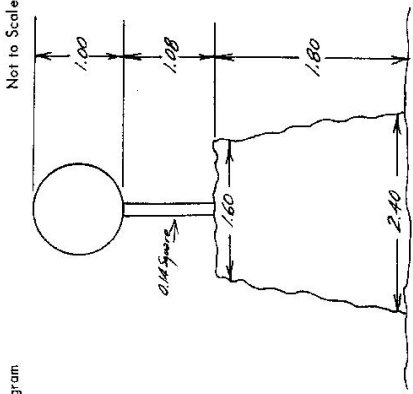

Date	Record of Station
	TRIG. TO AL BIRD ORDER... NEEDS RECONIZING AND A NEW MAST (CONCRETE CHAIN). HILL IS A VERY HIGH HILL WITH FULL 360° VIEW TO ALL SURROUNDING TRIGS IF CLEARED. ALL 2 INGRESS CEMENTS TO CLEAR TOP OF HILL. VERY VERY TO LAKE (A VERY LARGE TREE ON TOP OF HILL)

Prepared by: Checked: **Checked**
 Noted on U.T.M. Card

CENTRAL MAPPING AUTHORITY

GEODETIC SURVEY OF A.S.W. GEODETIC STATION RECONNAISSANCE and MAINTENANCE REPORT

STATION: BAUDA BAUDA (Pillar) No.: 6305

MAP SHEET SCALE 1:250 000

INSPECTED BY: H. L. HOLLIS DATE: 23rd Feb 74

AUTHORITY: C.M.A. FIELD BOOK: 167

Description: *Note: Cross out word or words which do not apply*

1. Cleared by lances bearing..... *145°M L 292°M* *40°M L 70°M*..... from Trig. Mast

2. Mast & Vanes have been painted white & black respectively. ✓

3. The ~~section~~/pillar was ~~unplaced/not completed~~/constructed on ~~the~~ *Feb*..... 197*3*....., dimensions now being:

Description of mark: *St. Pillar*..... should be explicit, e.g., S/Steel Pillar Plate, Steel plug, Brass plug, Bolt, G.I. Pipe

Height of mark..... *1.380*.....m. ^{above} ~~below~~ *rock/concrete*; Mark is..... *1.550*.....m. ^{above} ~~below~~ *G.I.*

Height of Top Vanes to Top ~~Mark~~/Pillar plate..... *1.430*.....m. Diameter of Vanes (vertical)..... *75.9*.....m.

Height of Cairn.....m. Diameter of Cairn.....m. Name Plate ~~found/not found~~/placed.

Length of Mast.....m. (approximate if not unplied)

4. A..... *Brass*..... *Van*..... set in conc/~~rock~~ has been ~~placed~~/found, bearing..... *85*.....°M from ~~Mast~~/~~Plate~~/Pillar

5. A..... *Copper*..... *Mark*..... set in conc/~~rock~~ has been placed/~~found~~, bearing..... *162*.....°M from ~~Mast~~/~~Plate~~/Pillar

6. A..... set in conc/~~rock~~ has been placed/~~found~~, bearing.....°M from Mast/~~Plate~~/Pillar

7. A..... set in conc/~~rock~~ has been placed/~~found~~, bearing.....°M from Mast/~~Plate~~/Pillar

8. Action required:.....

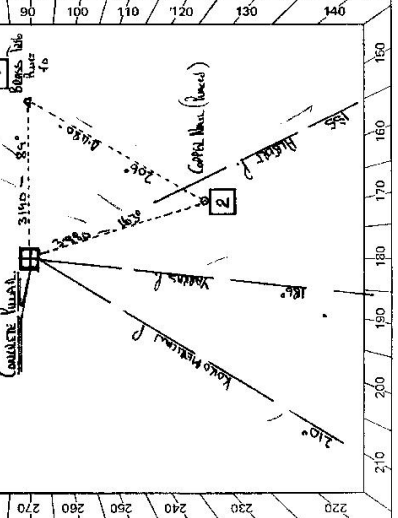

STANDPOINT: <i>Brass Van</i>		STANDPOINT: <i>Brass Van</i>		STANDPOINT: <i>Brass Van</i>	
Mark	Direction	Horiz. Distance	Height Difference	Mark	Direction
<i>Vanes (P)</i>	<i>0 00 00</i>		<i>above</i> standpt. / <i>below</i> standpt.	<i>Vanes (P)</i>	<i>0 00 00</i>
<i>Koro Pillar (P)</i>	<i>23 36 00</i>		<i>above</i> standpt. / <i>below</i> standpt.	<i>Copper Mark</i>	<i>22 51 10</i>
<i>Top Plate</i>	<i>260 04 00</i>	<i>3.140</i>	<i>1.925</i> <i>above</i> standpt. / <i>below</i> standpt.	<i>Koro Pillar (P)</i>	<i>23 36 00</i>
<i>Brass (P)</i>	<i>324 14 00</i>		<i>above</i> standpt. / <i>below</i> standpt.	<i>Brass Van</i>	<i>80 05 00</i>
<i>Copper Mark</i>	<i>338 44 10</i>	<i>3.350</i>	<i>1.400</i> <i>above</i> standpt. / <i>below</i> standpt.	<i>Brass (P)</i>	<i>324 18 00</i>
			<i>above</i> standpt. / <i>below</i> standpt.		
			<i>above</i> standpt. / <i>below</i> standpt.		

Prepared by: *H.L.H.* Checked: *H.L.H.* Noted on U.T.M. Card

S4 2733-2 D. West, Government Printer Beacon Diagram	Not to Scale 	This section to be completed by officer constructing pillar. Original station mark found/ not found . Description of mark: Beacon <u>Tim. Posts at 1.1m</u> Original beacon found/ not found . Description of beacon: <u>Conc. Mast, 1.1m high</u> Height Top of Vanes to Top Mark: <u>2.550</u> m. Height of mark: <u>2.450</u> m. ^{above} below G.L. Diameter of Vanes: <u>170</u> m. Height of Cairn: <u>1.30</u> m. Original Beacon has/ has not been destroyed by me. ✓
STATION <u>BAUDA BAUDA (UWA)</u> <u>6305</u> Owner's Name: <u>FRANZMAN COMMUNAL</u> Address: <u>WAIKAPUKE WITHIN PROPOSED WAIKAPUKE WINDFARM SITES</u> Phone: <u>08/646153</u> Current Occupant: <u>FORESTS COMMISSION</u> Address: <u>.....</u> Phone: <u>.....</u> ACCESS YN Access Report of 24/12/1978 was found suitable/ unsuitable . 0-00 KM. <u>CAMPIONOUS CAMP (FRANZMAN GOLF) TRAVEL WEST ALONG RIMUWA'S FOREST HIGHWAY</u> 0-35 <u>STRAIGHT NORTH ROAD BANGUOUS FOREST HIGHWAY AT SIGN POST BAUDA RESERVE 6,</u> <u>WAIKAPUKE EG. SIGN TO LEFT HIGHWAY 87 MARKS 36</u> 3-70 <u>PAST PILLAR 10 on RIGHT</u> 4-10 <u>TURN RIGHT SIGN BAUDA RESERVE</u> 8-80 <u>END WAIKAPUKE RD</u> 9-50 <u>STEEP TRAVEL NORTH at WAIKAPUKE</u> 10-05 <u>LEAVE VEHICLE - 5 MINUTE WAIT</u>		Date Record of Station