

CENTRAL MAPPING AUTHORITY

GEODETIC SURVEY OF N.S.W.

GEODETIC STATION RECONNAISSANCE and MAINTENANCE REPORT

STATION: WALCHA ROAD BS 1114K No.: TS 6300

MAP SHEET SCALE 1:250 000 MA1114K

INSPECTED BY: P. BOTS DATE: 23.3.19

AUTHORITY: B.M.A. FIELD BOOK: 1669

Description: Cleared by lanes bearing 139° to 175° 235 to 210 from Trig. Mast

2. Mast & Vanes have been painted white & black respectively.

3. The ~~stone~~ pillar was ~~constructed~~ on ~~stone~~ 9.78 m, dimensions now being:

Description of mark: ~~S/S~~ ~~Steel~~ ~~Pillar~~ ~~Plate~~, Steel plug, Brass plug, Bolt, G.I. Pipe

Height of mark: 1.24 m. ~~above~~ ~~below~~ G.L. Mark is 1.05 m. ~~above~~ ~~below~~ G.L.

Height of Top Vanes to Top ~~Mark~~ ~~Pillar~~ ~~plate~~ 1.15 m. Diameter of Vanes (vertical) 175 m.

Height of Cairn: ~~.....~~ m. Diameter of Cairn: ~~.....~~ m. Name Plate: ~~.....~~ /placed.

Length of Mast: ~~.....~~ m. (approximate if not unplied)

4. ~~Stone~~ ~~plug~~ ~~found~~, bearing 296° 206 M from ~~.....~~ /Pillar

5. A ~~SS in hole~~ set in conc/rock has been ~~found~~ bearing 350° 350 M from ~~.....~~ /Pillar

6. A ~~G.I. Pipe~~ set in conc/rock has been ~~found~~ bearing 279° 279 M from ~~.....~~ /Pillar

7. A ~~.....~~ set in conc/rock has been ~~found~~ bearing ~~.....~~ M from Mast/Plug/Pillar

8. Action required: ~~.....~~

STANDPOINT: BRASS TRIG PLUG			STANDPOINT: CONCRETE OBS PILLAR				
Mark	Direction	Horiz. Distance	Height Difference	Mark	Direction	Horiz. Distance	Height Difference
White Lead BS	0 08 00	5.01	above standpt	White Lead BS	A 00 00	A 00 00	above standpt
SS in hole	26 26 20	5.10	below standpt	INJALISS BS (P)	112 52 30	112 52 30	above standpt
Concrete obs pillar	66 11 30	5.76	above standpt	MONA VALE BS (P)	117 27 20	117 27 20	above standpt
INJALISS BS (P)	112 50 20	5.77	below standpt	G.I. Pipe in hole	161 18 20	11.66	below standpt
G.I. Pipe in hole	114 22 00	5.77	above standpt	BRASS TRIG PLUG	246 15 50	5.760	below standpt
MONA VALE BS (P)	117 28 30	5.76	below standpt	SS in hole	300 02 10	11.254	below standpt

Prepared by: P. BOTS 23.3.19 Checked: P. BOTS 23.3.19 Noted on U.T.M. Card

SI 2753-1

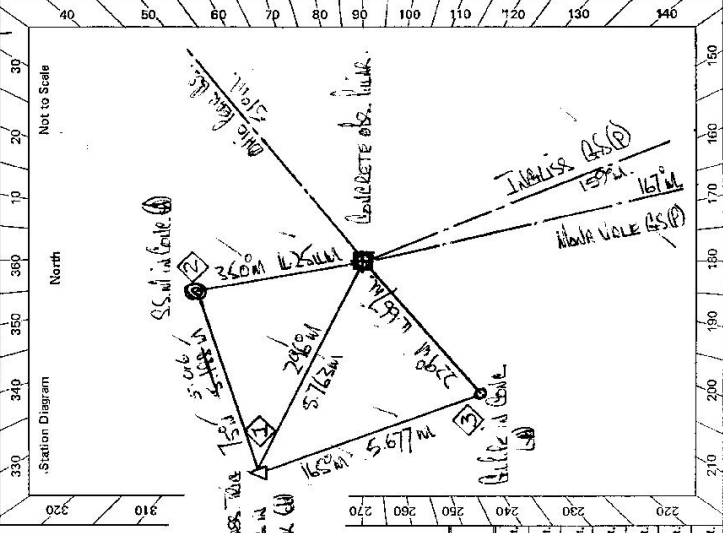

S: 2735-2 D. West, Government Printer	STATION WALUNA ROAD CR. ROAD. TS 6300	Owner's Name: M.R. D. WAREHAM Address: 107 LA HILL STREET WALUNA Phone: 772619	Current Occupant: Address: Phone:	ACCESS Access Report of 23.12.1979 was found suitable/unsuitable. Feat 000 TO WALUNA HEAD SOUTH TONGAREVA DUNES HIGHWAY 020 TURN RIGHT AND FOLLOW DUNES HIGHWAY 070 TURN RIGHT SLOW WALUNA ROAD 1450 TAKE RIGHT FORK 2030 TURN LEFT 2090 RAILWAY LINE CROSSING - GAMES BOTH SIDES 2130 TURN LEFT 2210 TURN LEFT AND FURTHER 2230 TURN RIGHT 2240 TURN RIGHT FURTHER 2260 TAKE FURTHER AS LEFT 2300 TURN RIGHT - TAKE LEFT TURN DOWN AND LEFT 2320 TAKE LEFT FORK THROUGH OLD FENCE 2340 TURN LEFT FOLLOW TRACK TO THE 2400 ELECTRIC STATION WALUNA ROAD
Beacon Diagram 		This section to be completed by officer constructing pillar. Original station mark found/ not found Description of mark: Base of Pillar Original beacon found/ not found Description of beacon: Orange base v Disc Height Top of Vanes to Top Mark 3.686 m. Height of mark 0.68 m. above rock/ceac. below G.L. Diameter of Vanes 1.81 m. Height of Cairn 1.340 m. Original Beacon has been been destroyed by me.		

Date	Record of Station