

GEODETTIC SURVEY OF N.S.W.

CENTRAL MAPPING AUTHORITY

GEODETTIC STATION RECONNAISSANCE and MAINTENANCE REPORT

Description:

1. Cleared by lanes bearing To Permit *Note: Cross out word or words which do not apply*
2. Mast & Vanes have been painted white & black respectively. 360 *from Trig. Mast pillar*
3. The ~~station~~ pillar was ~~replaced~~ replaced / constructed on 9<sup>th</sup> March 1979, dimensions now being:  
Description of mark: S/S Pillar Plate should be explicit, e.g., S/Steel Pillar Plate, Steel plug, Brass plug, Bolt, G.I. Pipe  
Height of mark: 3.40 m. <sup>above</sup> ~~below~~ level concrete Mark is 4.40 m. <sup>above</sup> ~~below~~ level
- Height of Top Vanes to Top ~~mark~~ / Pillar plate 4.25 m. Diameter of Vanes (vertical) 0.126 m.
- Height of Cairn 0.15 m. Diameter of Cairn 0.15 m. Name Plate ~~found~~ found / placed.
- Length of Mast 1.515 m. (approximate if not unipiled)
4. A Range Pole pin set in conc/~~rock~~ has been ~~placed~~ / found, bearing 65.0 M from ~~mark~~ / Trig. Mast / Pillar
5. A S.S. V set in conc/~~rock~~ has been ~~placed~~ / found, bearing 21.0 M from ~~mark~~ / Trig. Mast / Pillar
6. A G.I. pipe set in conc/~~rock~~ has been ~~placed~~ / found, bearing 7.1 M from Mast/Plug / Pillar
7. A concrete set in conc/~~rock~~ has been ~~placed~~ / found, bearing 0.0 M from Mast/Plug / Pillar

Action required:

STANDPOINT: Conc. obs. Pillar

STANDPOINT: Trig. Plug

Mark	Direction	Horiz. Distance	Height Difference	Mark	Direction	Horiz. Distance	Height Difference
<u>Parabola G.S.</u>	<u>0 00 00</u>		<u>above</u> <u>standpt.</u>	<u>Parabola G.S.</u>	<u>0 00 00</u>		<u>above</u> <u>standpt.</u>
<u>S.S.M.</u>	<u>244 46 50</u>	<u>3.102</u>	<u>below</u> <u>standpt.</u>	<u>Conc. obs. pillar</u>	<u>108 56 18.5</u>	<u>2.284</u>	<u>above</u> <u>standpt.</u>
<u>Trig. plug</u>	<u>288 55 13</u>	<u>2.283</u>	<u>below</u> <u>standpt.</u>	<u>S.S.M.</u>	<u>108 01 31.5</u>	<u>2.224</u>	<u>above</u> <u>standpt.</u>
<u>G.I. pipe</u>	<u>295 01 08.5</u>	<u>4.838</u>	<u>below</u> <u>standpt.</u>	<u>G.I. pipe</u>	<u>200 20 44</u>	<u>2.517</u>	<u>above</u> <u>standpt.</u>
<u>Brass pins G.S.</u>	<u>249 23 33.5</u>		<u>below</u> <u>standpt.</u>	<u>Brass pins G.S.</u>	<u>299 23 10.5</u>		<u>below</u> <u>standpt.</u>

Prepared by:

Checked:

ST 2735-1

Noted on U.T.M. Card

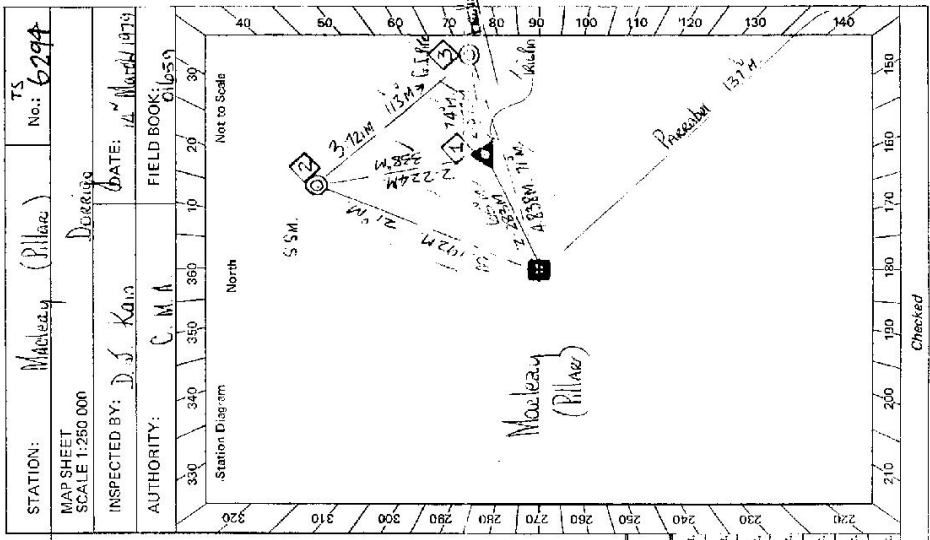

STATION: Macleay (Pillar) No: 6294  
 MAP SHEET SCALE 1:250 000  
 INSPECTED BY: D.S. Kallis DATE: 14 March 1979  
 AUTHORITY: C.M.A. FIELD BOOK: 01659

STATION **Macleay (Pillar) IS 6294**

Owner's Name: **Mr Dudley Scott**  
 Address: **GREEN STREET**  
**BELLBROOK**  
 Phone: **67 2013**

Current Occupant: .....  
 Address: .....  
 Phone: .....

ACCESS

Access Report of **14.3.19** was found suitable/unsuitable.  
**Access to Macleay (Pillar) G.S. 0.0 Kilometres travel towards Kempsey**

**AT POST OFFICE AT BELLBROOK AT 0.0 KILOMETRES**

**Kilometres**

**0.10 TAKE GRAVEL ROAD TO YOUR RIGHT.**  
**0.45 CROSS BRIDGE OVER MACLEAY RIDGE.**  
**0.50 TAKE RIGHT FORK.**  
**1.25 PASS THROUGH STEEL GATE.**  
**3.10 PASS OVER WOODEN BRIDGE.**  
**3.70 THROUGH IRON GATE AT "T" JUNCTION, TAKE ROAD TO RIGHT, SIGNPOST "TOOSE ROAD".**  
**8.60 PASS ABANDONED SLAB BRIDGE ON YOUR R.H.S.**  
**9.00 JUST BEFORE LEFT HAND BEND IN ROAD AND ON R.H.S GULLY TAKE TRAIL UP SPUR TO YOUR LEFT, FOLLOW RIDGE IN AN SOUTHWEST DIRECTION TO CONE AND PILLAR AT 11.30 KILOMETRES. ~~DO NOT~~ WEATHER EXPOSE ONLY AND 4 WD.**

RECORD OF STATION

Date: .....

