

CENTRAL MAPPING AUTHORITY
Department of Lands

Trigonometrical Survey of N.S.W.

RECONNAISSANCE and MAINTENANCE REPORT

STATION GALAH MT TS-6279

Co: _____
 Map Sheet: WALLERAWANG No: 8931
 Inspected by: _____ Date: _____
 Authority: _____ Field Book: _____
 Beacon Diagram: _____ Nor to Scale

This Trig. Station has been:-

Note: Cross out word or words which do not apply

1. Completely cleared to permit 360° vision to surrounding Trigs.
2. Cleared by lanes bearing..... from Trig. Mast
3. Trig. Mast & Vanes have been painted white & black respectively.
4. The Trig. was ~~upheld~~/not upheld, dimensions now being: Original Station Mark found; not found

Description of mark..... should be explicit, e.g. Steel plug, Brass plug, Bolt, G.I. Pipe
 Height of mark..... m ^{above} rock/concrete m ^{below} G.L.
 Height of Top Vanes to Top Mark..... m. Diameter of Vanes (vertical)..... m.
 Height of Cairn..... m. Diameter of Cairn..... m.

Length of Mast..... m. (approximate if not upheld)

5. A..... set in conc/rock has been placed..... m. bearing.....°M from Trig. Mast
6. A..... set in conc/soil has been placed..... m. bearing.....°M from Trig. Mast
7. A..... set in conc/soil has been placed..... m. bearing.....°M from Trig. Mast
8. A..... set in conc/rock has been placed..... m. bearing.....°M from Trig. Mast

9. Connection..... to..... m. bearing.....°M

10. Connection..... to..... m. bearing.....°M

11. Connection..... to..... m. bearing.....°M

12. Connection..... to..... m. bearing.....°M

13. Diff. Ht. is..... m. ^{above} ^{below}

14. Diff. Ht. is..... m. ^{above} ^{below}

15. Diff. Ht. is..... m. ^{above} ^{below}

16. Diff. Ht. is..... m. ^{above} ^{below}

Prepared by: _____ Checked: _____

Noted on U.T.M. Card

Date	Record of Station
1930	Station Established

Checked

Department of Lands

Integration Su of M.S.W

RECONNAISSANCE and MAINTENANCE REPORT 2125 STATION GALAH(PITS)

6279

This Trig. Station has been:-

Note: Cross out word or words which do not apply

1. Completely cleared to permit 360° vision to surrounding Trigs.
2. Cleared by limes bearing 150M to 250M from Trig. Mast
3. Trig. Mast & Vanes have been painted white & black respectively.
4. The Trig. was unspiled/net unspiled, dimensions now being:

Description of mark: **ROYAL AUSTRALIAN ARMY CORP (ARGE GALAH)** should be explicit, e.g. Steel plug, Brass plug, Bolt, Concrete Pillar

Height of mark: m above hole rock concrete m above G.L.
 Height of Top Vanes to Top Mark/Top pillar plate m Diameter of Vanes (vertical) m.
 Height of Cairn m. Diameter of Cairn m.
 Length of Mast m. (approximate if not unspiled)

5. A. set in conc/rock has been placed/fd m. bearing °M from Trig. Mast/pillar
6. A. set in conc/soil has been placed/fd m. bearing °M from Trig. Mast/pillar
7. A. set in conc/soil has been placed/fd m. bearing °M from Trig. Mast/pillar
8. A. set in conc/rock has been placed/fd m. bearing °M from Trig. Mast/pillar

9. Connection to m. bearing °M
10. Connection to m. bearing °M
11. Connection to m. bearing °M
12. Connection to m. bearing °M
13. Diff. Ht. is m. above below
14. Diff. Ht. is m. above below
15. Diff. Ht. is m. above below
16. Diff. Ht. is m. above below

Prepared by: L.M.HAVES

Checked: *[Signature]*

Co:

Map Sheet:

Inspected by: L.M.HAVES
 Authority: DEP OF LANDS

Beacon Diagram

No:

Date: 15/7/75
 Field Book: 68C 37

Not to Scale

No Beacon

Date

Record of Station

6279
GALAH TS. (P)

STATION

Current Occupant

Owners Name

Address

Address

Not to Scale

Station Diagram

North

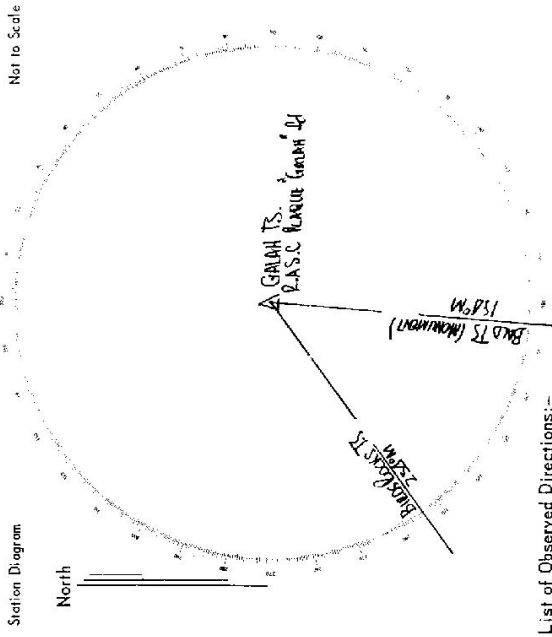

List of Observed Directions:-

Standpoint:		Standpoint:	
Station	Direction	Station	Direction
BIRD TS (MONUMENT)	355 553 60		
BIRDS ROCKS TS.	465 37 034		

Access 15-7-1975
CONVENTIONAL DEME VEHICLE
CAN BE DRIVEN TO BINT WARRÉ
VEHICLE IS LEFT.

AT 19.7 MILES
LEAVE VEHICLE
10 MINS WALK UP
HILL TO TRIG

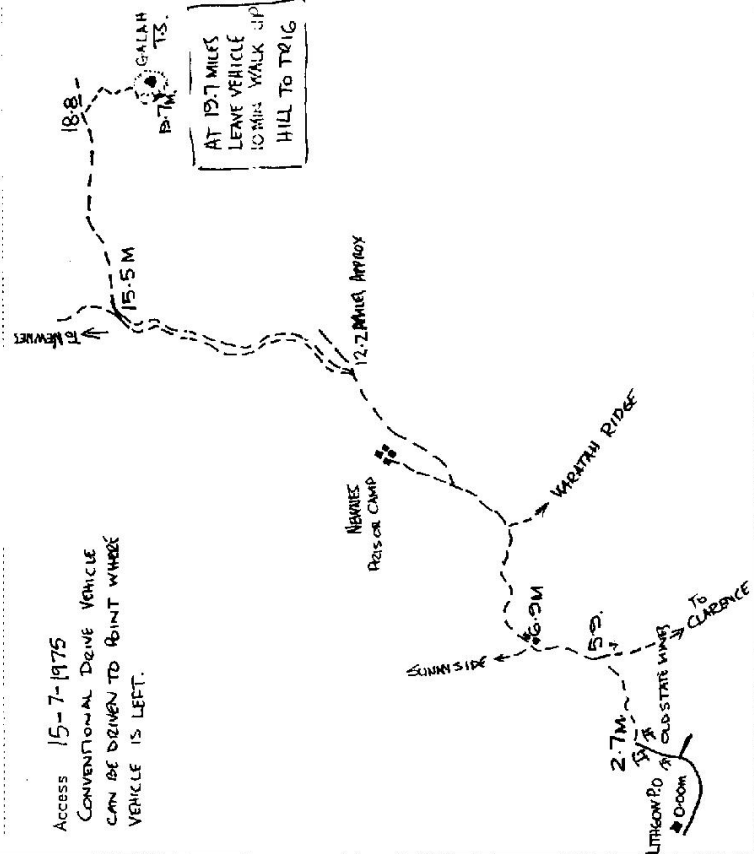

CENTRAL MAPPING AUTHORITY

GEODETIC SURVEY OF N.S.W.

GEODETIC STATION RECONNAISSANCE and MAINTENANCE REPORT

STATION: GALAH PILLAR No.: 6279

MAP SHEET SCALE 1:250 000

INSPECTED BY: S/DNEY DATE: 27-11-75

AUTHORITY: C.M.A. FIELD BOOK: 1662

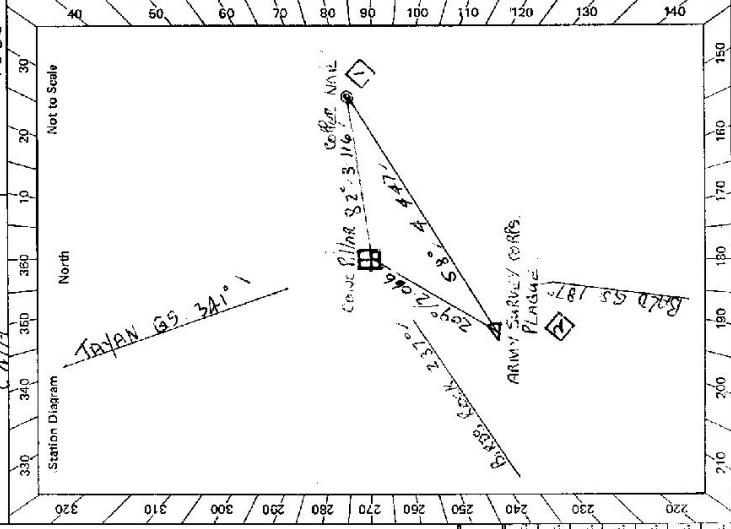

- Description:
- Note: Cross out word or words which do not apply
- Cleared by lances bearing 159° - 169° 180° - 191° 230° - 250° 269° - 287° 330° - 351° from Trig. Mast
 - Mast & Vanes have been painted white & black respectively. ✓
 - The station/pillar was unpiled/not unpiled/constructed on 2.11.18, dimensions now being: Description of mark. S.S. Pillar. Should be explicit, e.g., S/Steel Pillar Plate, Steel plug, Brass plug, Bolt, G.I. Pipe Height of mark 1.380 m. above below Mark is m. above below G.L.
 - Height of Top Vanes to Top Mark/Pillar plate 1.438 m. Diameter of Vanes (vertical) 0.752 m.
 - Height of Cairn m. Diameter of Cairn m. Name Plate found/not found/placed.
 - Length of Mast 1.518 m. (approximate if not applied)
 - A.S.C. set in conc/rock has been placed/round, bearing 209° M from Mast/Plug/Pillar
 - A.C.P.P. Nail set in conc/rock has been placed/round, bearing 82° M from Mast/Plug/Pillar
 - A. set in conc/rock has been placed/round, bearing° M from Mast/Plug/Pillar
 - A. set in conc/rock has been placed/round, bearing° M from Mast/Plug/Pillar

STANDPOINT: PLOW OBS PILLAR		STANDPOINT: A.S.C. PLAGUE	
Mark	Direction	Horiz. Distance	Height Difference
BALD PILLAR	0° 02' 00"		above standpt
A.S.C. PLAGUE	171° 26' 00"	2.085	below standpt
BASS ROCK PILLAR	46° 36' 00"		above standpt
GALAH PILLAR	197° 24' 30"	2.068	below standpt
CENTER NAIL	260° 34' 35"	3.116	below standpt
			above standpt
			below standpt
			above standpt
			below standpt
			above standpt
			below standpt

Prepared by: Checked: Noted on U.I.M. Card

STATION **GALEAH & Inlet TS 6279**

Owner's Name:
 Address:
 Phone:
 Current Occupant:
 Address:
 Phone:

ACCESS

Access Report of **77/11/1878** was found suitable/unsuitable.

- L. T. Inlet**
- 0 0 LITHGOW P.O. TRAVEL WEST ALONG RAILWAY FOR
 - 1 5 TURN LEFT INTO HATKINSON STREET
 - 2 2 RAIL CROSSING
 - 4 3 SIGN, STATE HILL WINE ROAD
 - 8 4 PASS ROAD TO CHALLENGE V SYDNEY
 - 10 6 PASS ROAD ON LEFT TO SUNNYSIDE
 - 12 3 PASS ROAD ON LEFT TO NEWNES CAMP
 - 13 7 PASS WARRATAH RIDGE ROAD ON RIGHT
 - 15 0 TAKE CENTRE ROAD, START OF DUEL TRACK
 - 19 0 FORK, TURN LEFT.
 - 24 2 TURN RIGHT, END OF DUEL TRACK
 - 24 8 FORK TURN LEFT SIGN "GALEAH MI ROAD"
 - 29 4 TURN RIGHT.
 - 30 4 TURN LEFT AUTO BUSA TRACK
 - 30 5 G.S.

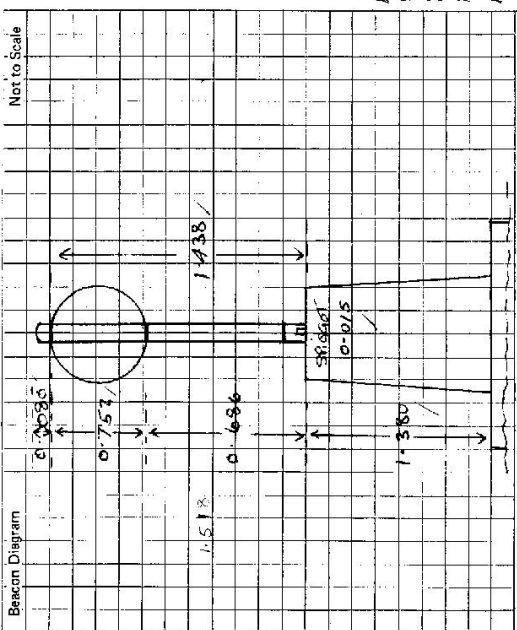

This section to be completed by officer constructing pillar.

Original station mark found/~~not found~~:
 Description of mark: **BRICK SURVEY CORNER PLASTER (SARLID)**
 Original beacon found/~~not found~~:
 Description of beacon: **NO BEACON FOUND**
 Height Top of Vanes to Top Mark m.
 Height of mark: **above** / **below** m.
 Diameter of Vanes m. Height of Cairn m.
 Original Beacon has/~~not been~~ destroyed by me.

Date	Record of Station