

B 6268
No.: 2700

GEODETIC SURVEY OF N.S.K.

CENTRAL MAPPING AUTHORITY

GEODETIC STATION RECONNAISSANCE and MAINTENANCE REPORT

STATION: KEW
MAP SHEET SCALE 1:250 000
INSPECTED BY: A. Svendsen
AUTHORITY: CMA

DATE: 7-3-78
FIELD BOOK: 1565

Description:
1. Cleared by lanes bearing..... ~~medium~~ timber..... ~~360°~~..... from Trig. Mast
2. Mast & Vanes have been painted white & black respectively X
3. The station ~~has been~~ ~~was~~ ~~erected~~ ~~at~~..... ~~10~~....., dimensions now being:
Description of mark..... should be explicit, e.g., S/Steel Pillar Plate, Steel plug, Brass plug, Bolt, G.I. Pipe
Height of mark.....m. ^{above} rock/concrete; Mark is.....m. ^{above} G.L.
Height of Top Vanes to Top Mark/Pillar plate.....m. Diameter of Vanes (vertical)..... ~~0.76~~ m.
Height of Cairn..... ~~1.5~~ m. Diameter of Cairn..... ~~2.0~~ m. Name Plate ~~found~~/not found/~~placed~~.
Length of Mast..... ~~3.8~~ m. (approximate if not uplited)

4. A..... ~~set in conc/rock~~ ~~has been placed~~/found, bearing.....° M from Mast/Plug/Pillar
5. A..... ~~set in conc/rock~~ ~~has been placed~~/found, bearing.....° M from Mast/Plug/Pillar
6. A..... ~~set in conc/rock~~ ~~has been placed~~/found, bearing.....° M from Mast/Plug/Pillar
7. A..... ~~set in conc/rock~~ ~~has been placed~~/found, bearing.....° M from Mast/Plug/Pillar
8. Action required: ~~2.3 days clearing~~; ~~Conc. pillar and marks~~ ~~to be~~ ~~erected~~ ~~before~~ ~~clearing~~

STANDPOINT:

Mark	Direction	Horiz. Distance	Height Difference	Mark	Direction	Horiz. Distance	Height Difference
			above standpt.				above standpt.
			below				below
			above standpt.				above standpt.
			below				below
			above standpt.				above standpt.
			below				below
			above standpt.				above standpt.
			below				below
			above standpt.				above standpt.
			below				below

Prepared by: 14-3-78 Checked: 14-3-78 Noted on U.T.M. Card

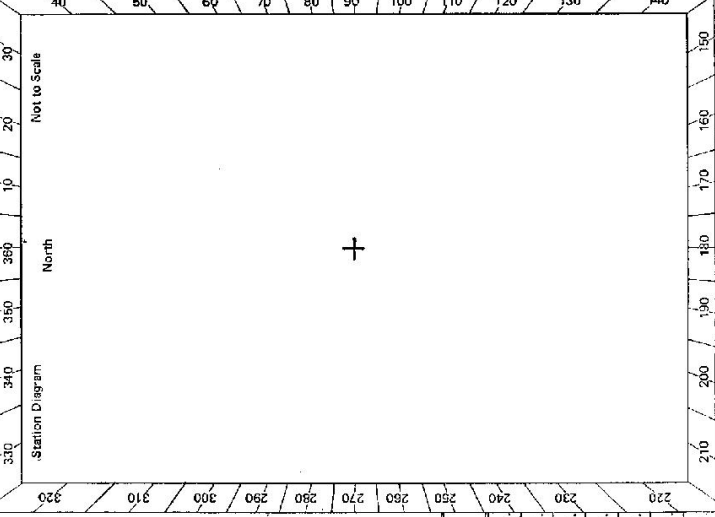

Checked

GEODETTIC SURVEY OF M.S.W.

CENTRAL MAPPING AUTHORITY

GEODETTIC STATION RECONNAISSANCE and MAINTENANCE REPORT

Description:

Note: Cross out word or words which do not apply

1. Cleared by lanes bearing $325^{\circ} 42' 30''$ / $325^{\circ} 42' 30''$ from Trig. Mast
2. Mast & Vanes have been painted white & black respectively. ✓
3. The ~~station~~/pillar was ~~reconstructed~~/constructed on $19.11.19$, dimensions now being: Description of mark $54 \times 57 \times 36$ should be explicit, e.g., S/Steel Pillar Plate, Steel plug, Brass plug, Bolt, G.I. Pipe
Height of mark 1.346 above ~~rock~~/concrete; Mark is 1.450 above G.L.
Height of Top Vanes to Top ~~Mast~~/Pillar plate 4.433 m. Diameter of Vanes (vertical) 75.6 m.
Height of Cairn 1.346 m. Diameter of Cairn 1.346 m. Name Plate ~~found/not found~~/placed.
Length of Mast 1.346 m. (approximate if not unplied)
4. A. ~~Station~~ $19.11.19$ set in conc/~~rock~~ has been ~~placed~~/~~found~~/bearing $327^{\circ} 00'$ M from ~~Mast/Plug~~/Pillar ✓
5. A. ~~Station~~ $19.11.19$ set in conc/~~rock~~ has been placed/~~found~~, bearing $143^{\circ} 00'$ M from ~~Mast/Plug~~/Pillar ✓
6. A. ~~Station~~ $19.11.19$ set in conc/rock has been placed/found, bearing $154^{\circ} 00'$ M from Mast/Plug/Pillar
7. A. ~~Station~~ $19.11.19$ set in conc/rock has been placed/found, bearing $154^{\circ} 00'$ M from Mast/Plug/Pillar
8. Action required:

Mark	Direction	Horiz. Distance	Height Difference	Mark	Direction	Horiz. Distance	Height Difference
Iron G.S. Pillar	$0^{\circ} 00'$		above standpt	Iron G.S. Pillar	$0^{\circ} 00'$		above standpt
Concrete G.S. of	$54^{\circ} 57' 36''$		above standpt	Conc. Plug	$49^{\circ} 27' 36''$	2.672	above standpt
Brass Plug	$325^{\circ} 42' 30''$		above standpt	Concrete G.S. (19.11.19)	$143^{\circ} 00'$		above standpt
Conc. Plug	$325^{\circ} 42' 30''$		below standpt	Steel Plate	$154^{\circ} 00'$	3.275	above standpt
			below standpt				below standpt
			above standpt				above standpt
			below standpt				below standpt
			above standpt				above standpt
			below standpt				below standpt

STANDPOINT: ~~Station~~ $19.11.19$ Date: ~~19.11.19~~ 2022. STANDPOINT: Brass Plug Date: Noted on U.T.M. Card

Prepared by: ~~John C.S. (P)~~ 17/11/19

Checked

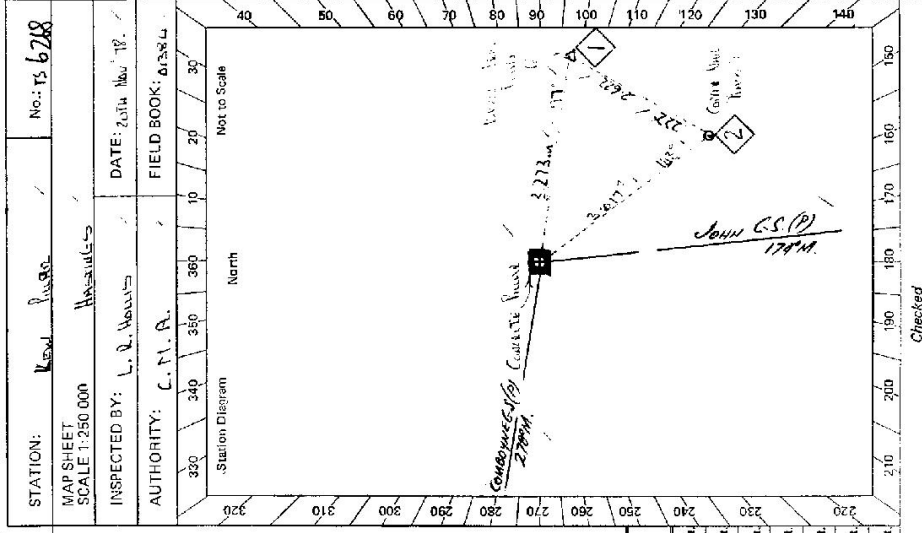

STATION: ~~Iron G.S. Pillar~~ / No: TS 6268

MAP SHEET SCALE 1:250 000

INSPECTED BY: L. R. M... DATE: 20/11/19

AUTHORITY: C. N. A. FIELD BOOK: 01384

STATION West Pines, IS 6268

Owner's Name: John J. Sisk
 Address:
 Phone:

Current Occupant: General Land
 Address:
 Phone:

ACCESS

Access Report of 28/11/19 was found suitable/unsuitable.

MN
 Highway Creek Post Office Tower South Post Saw Mill
 Tully Right
 Stuntz Area Possible Concrete Co as Left
 Tully Left
 Tully P. Head Fork Log Dump and Utility Lane
 Tully Left Fork Tully Lane
 Tully Left
 Geonary Corridor.

12-00
 16-15
 1-10
 21-60
 5-40
 7-60
 8-10
 9-20
 9-50

Not to Scale

Beacon Diagram

This section to be completed by officer constructing pillar.

Original station mark found/~~not found~~.

Description of mark: Station on a concrete pillar

Original beacon found/~~not found~~.

Description of beacon: Station on a concrete pillar

Height: Top of Vanes to Top Mark 3.728 m.

Height of mark 3.50 m. above / below G.L.

Diameter of Vanes 1.520 m. Height of Cairn 1.520 m.

Original Beacon has/~~has not~~ been destroyed by me. ✓

Date

Record of Station

GEODETTIC SURVEY OF N.S.W.

CENTRAL MAPPING AUTHORITY

GEODETTIC STATION RECONNAISSANCE and MAINTENANCE REPORT

Description: *Note: Cross out word or words which do not apply*

1. Cleared by vanes bearing $17^{\circ} - 22' M$, $53^{\circ} - 28' M$, $165^{\circ} - 172' M$, $190^{\circ} - 200' M$, from Trig. Mast $221' - 230' M$ $263' - 274' M$
2. Mast & Vanes have been painted white & black respectively. *PILLAR CONSTRUCTED APPROXIMATELY LATE 1978*
3. ~~The station pillar was applied/ret-applied/constructed on~~ 19 dimensions now being:

Description of mark: ~~S/STEEL P.P.~~ should be explicit, e.g. S/Steel Pillar Plate, Steel plug, Brass plug, Bolt, G.I. Pipe

Height of mark 1.37 m. ^{above} ~~below~~ ~~rock~~/concrete; Mark is 1.4 m. ^{above} G.L. ~~below~~

Height of Top Vanes to ~~Top of Pillar~~ Pillar plate 1.43 m. Diameter of Vanes (vertical) 0.75 m.

Height of Cairn $N.A.$ m. Diameter of Cairn $N.A.$ m. Name Plate found/~~not found/placed~~

Length of Mast 0.68 m. (approximate if not unplied)

4. A ~~BRASS SPIKE~~ set in conc/~~rock~~ has been ~~placed~~/found, bearing $150^{\circ} M$ from ~~Mast/Plug/Pillar~~
5. A set in conc/rock has been placed/found, bearing M from Mast/Plug/Pillar
6. A set in conc/rock has been placed/found, bearing M from Mast/Plug/Pillar
7. A set in conc/rock has been placed/found, bearing M from Mast/Plug/Pillar

8. Action required:

STANDPOINT:				STANDPOINT:			
Mark	Direction	Horiz. Distance	Height Difference	Mark	Direction	Horiz. Distance	Height Difference
			above standpt				above standpt
			below				below
			above standpt				above standpt
			below				below
			above standpt				above standpt
			below				below
			above standpt				above standpt
			below				below
			above standpt				above standpt
			below				below

Prepared by: *R. Pierce* Checked: *R. Pierce* Noted on U.T.M. Card

St 2753-1

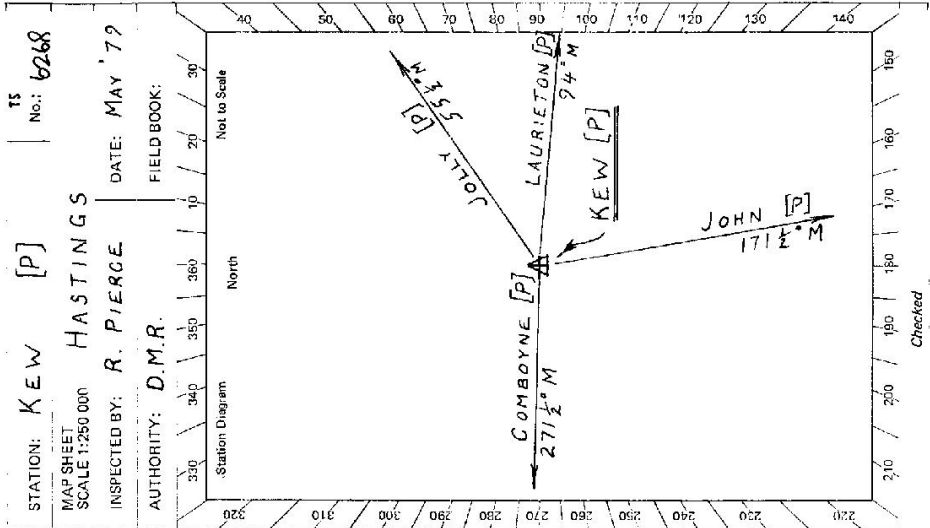

Checked

<p>STATION KEW [P] TS 6268</p>	<p>Owner's Name:</p> <p>Address:</p> <p>Phone:</p>	<p>Current Occupant:</p> <p>Address:</p> <p>Phone:</p>	<p>ACCESS</p> <p>Access Report of 7.1.1978 was found inaccessible accessible.</p> <p>ALTERNATIVE ROUTE:-</p>
<p>Beacon Diagram</p>			<p>Record of Station</p>
<p>Scale: 1:43 (Not to Scale)</p>			<p>Date</p>
<p>This section to be completed by officer constructing pillar.</p> <p>Original station mark found/not found.</p> <p>Description of mark:</p> <p>Original beacon found/not found.</p> <p>Description of beacon:</p> <p>Height Top of Vanes to Top Mark:m.</p> <p>Height of mark:m. above rock/cenc.m. below G.L.</p> <p>Diameter of Vanesm. Height of Calmm.</p> <p>Original Beacon has/has not been destroyed by me.</p>			