

GEODETTIC SURVEY OF N.S.W.

CENTRAL MAPPING AUTHORITY

GEODETTIC STATION RECONNAISSANCE and MAINTENANCE REPORT

STATION: Butterfly No.: 6264

MAP SHEET SCALE 1:250 000 4857465

INSPECTED BY: L.R.Hous DATE: 27th August 2015

AUTHORITY: C.M.A FIELD BOOK: 01651

- Description:
- Cleared by lanes bearing 360°  Note: Cross out word or words which do not apply from Trig. Mast
  - Mast & Vanes have been painted white & black respectively.
  - The station/pillar was reconstructed/constructed on Site. Trip.....19.78... dimensions now being:
  - Description of mark Steel Plate should be explicit, e.g., S/Steel Pillar Plate, Steel plug, Brass plug, Bolt, G.I. Pipe
  - Height of mark 1.44 m. <sup>above</sup> rock/concrete; Mark is 1.44 m. <sup>above</sup> G.L.
  - Height of Top Vanes to Top Mark/Pillar plate 1.430 m. Diameter of Vanes (vertical) 0.750 m.
  - Height of Cairn.....m. Diameter of Cairn.....m. Name Plate found/not found/placed.....
  - Length of Mast.....m. (approximate if not unplied)
  - A Brass Trip.....set in conc/rock has been placed/found, bearing 216° M from Mast/Plug/Pillar
  - A S.S.M.....set in conc/rock has been placed/found, bearing 197° M from Mast/Plug/Pillar
  - A C.M.A.....set in conc/rock has been placed/found, bearing 160° M from Mast/Plug/Pillar
  - A.....set in conc/rock has been placed/found, bearing.....° M from Mast/Plug/Pillar
8. Action required:.....

Mark	Direction	Horiz. Distance	Height Difference	Mark	Direction	Horiz. Distance	Height Difference
<u>Dial 65</u>	<u>0 00 00</u>			<u>Dial 60</u>	<u>0 00 00</u>		
<u>Dial 65.0.P</u>	<u>169 50 50</u>			<u>Rock Plate</u>	<u>167 51 00</u>	<u>4.721</u>	<u>-1.886</u>
<u>G.I. Plate</u>	<u>291 39 40</u>	<u>2.956</u>	<u>1347</u>	<u>Dial 65.0.P</u>	<u>169 50 20</u>		
<u>S.S.M</u>	<u>330 25 40</u>	<u>4.228</u>	<u>1398</u>	<u>G.I. Plate</u>	<u>200 33 10</u>	<u>3.934</u>	<u>+5.60</u>
<u>Brass Trip Pl</u>	<u>337 52 00</u>	<u>4.970</u>	<u>1490</u>	<u>S.S.M</u>	<u>281 21 20</u>	<u>2.153</u>	<u>+1.579</u>

STANDPOINT: Steel Trip Pl

STANDPOINT: Rock Trip Pl

Checked: L.R.Hous

Prepared by: L.R.Hous

Noted on U.T.M. Card

Sr 2733-1

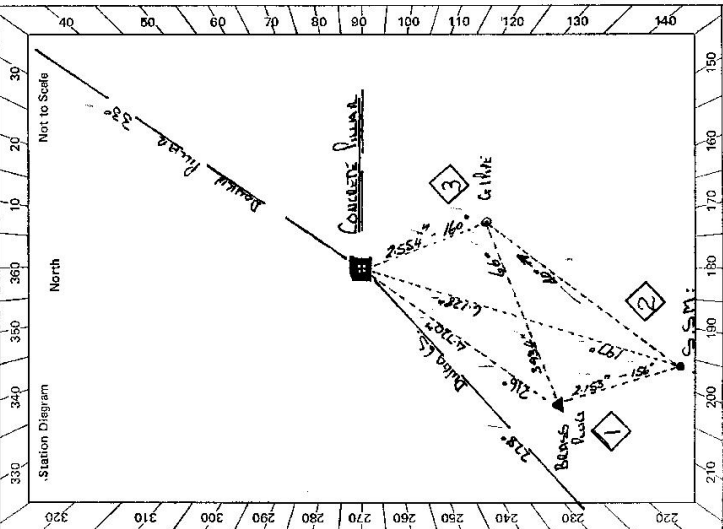

STATION BUTTERFLY - 6264

Owner's Name: Mr. Mark Anthony  
 Address: Butterfly, Co. Wick  
 Phone: 087 2345678

Current Occupant: Mark Anthony  
 Address: Butterfly, Co. Wick  
 Phone: 087 2345678

ACCESS  
 MY Access Report of 21/8/1978 was found suitable/unsuitable.

- / 0000 WALKWAY TO TOWER WTH
- / 0100 TOWER LEFT
- / 1000 TOWER RIGHT
- / 1100 TOWER LEFT SWAN ISLANDS
- / 7500 TOWER LEFT SWAN ISLANDS FISH II
- / 1500 TOWER LEFT NEW FOR PARKER'S OWNERS THE TOWER LIGHT
- / 1400 WALKWAY FLAT WTH
- / 2000 TOWER LIGHT AT VANDOS, THREMGH, JAW END, TOWER LIGHT
- / 2040 TOWER LEFT (GARDEN) BY FORCE INVESTIGATION
- / 2100 WIDE GARDEN, FENCED TOWER OF HILL AND RAIL LINE
- / 2300 LONDON RAIL LINE
- / 2400 GEORGE SPITHEAD.

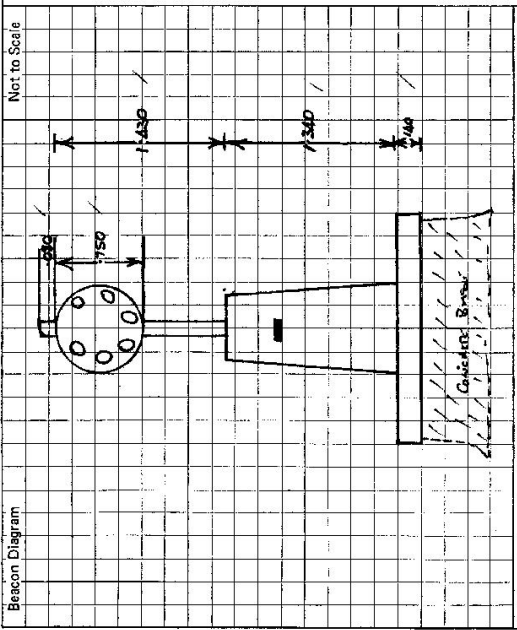

This section to be completed by officer constructing pillar.

Original station mark found/~~not found~~.

Description of mark: Butterfly, Co. Wick, Ireland

Original beacon found/~~not found~~.

Description of beacon: Concrete, Masonry, Dismantled

Height Top of Vanes to Top Mark: 2.332 m.

Height of mark: 0.750 m. above ~~below~~ G.L.

Diameter of Vanes: 1.000 m. Height of Cairn: 0.000 m.

Original Beacon has ~~been~~ been destroyed by me. ✓

Date	Record of Station

CENTRAL MAPPING AUTHORITY

GEODETTIC SURVEY OF N.S.W.

GEODETTIC STATION RECONNAISSANCE and MAINTENANCE REPORT

Description:

1. Cleared by lanes bearing All Round *Notes: Cross out word or words which do not apply* from Trig. Mast

2. Mast & Vanes have been painted white & black respectively, yes 30/27/15/86 dimensions now being: Replaced

3. The station either was omitted/not impeded/constructed on 1/5/1986

Description of mark Steel Plug/Pillar Plate should be explicit, e.g., S/Steel Pillar Plate, Steel plug, Brass plug, Bolt, G.I. Pipe

Height of mark 3.30 m, above rock/concrete; Mark is at m, above G.L.

Height of Top Vanes to Top Mark/Pillar plate 1.470 m. Diameter of Vanes (vertical) 0.750 m.

Height of Cairn 0 m. Diameter of Cairn 0 m. Name Plate found/not found/placed.

Length of Mast 0 m. (approximate if not unplied)

4. A. 0 set in conc/rock has been placed/found, bearing 0°M from Mast/Plug/Pillar

5. A. 0 set in conc/rock has been placed/found, bearing 0°M from Mast/Plug/Pillar

6. A. 0 set in conc/rock has been placed/found, bearing 0°M from Mast/Plug/Pillar

7. A. 0 set in conc/rock has been placed/found, bearing 0°M from Mast/Plug/Pillar

8. Action required: Vanes stolen, new vanes required

STANDPOINT:

STANDPOINT:

Mark	Direction	Horiz. Distance	Height Difference	Mark	Direction	Horiz. Distance	Height Difference
			above standpt				above standpt
			below				below
			above standpt				above standpt
			below				below
			above standpt				above standpt
			below				below
			above standpt				above standpt
			below				below
			above standpt				above standpt
			below				below
			above standpt				above standpt
			below				below

Prepared by: gllan

Checked: 13/6/86

Noted on U.T.M. Card

Checked

STATION: BUTTERFLY No. 6264  
 MAP SHEETS WINGHAM SCALE 1:100 000  
 SCALE 1:250 000 3334-2-2  
 INSPECTED BY: J. Sherwin DATE: 19/6/86  
 AUTHORITY: CMA FIELD BOOK: -

Station Diagram

Not to Scale

GS 24

<p>STATION <b>BUTTERFLY (P)</b> 6264</p> <p>Owner's Name: <b>SHANE (Jimmy) Fox</b></p> <p>Address: .....</p> <p>Phone: .....</p> <p>Manager: <b>Eric Fox</b></p> <p>Current Occupant: .....</p> <p>Address: .....</p> <p>Phone: .....</p> <p>ACCESS <b>19-5-86</b></p>	<p>Access Report of <del>XXXXXX</del> was found <del>unsuitable</del>/unsuitable.</p> <p>0:00 Wingham Po Travel North</p> <p>0:10 Turn <del>Left</del> <b>Right</b></p> <p>1:10 Turn <del>Left</del> <b>Right</b> Sign <b>ELANDS</b></p> <p>1:23 Turn <del>Left</del> <b>Right</b> Sign <b>WERRAL FLAT.</b></p> <p>7:80 Turn <del>Left</del> <b>Right</b></p> <p>20:20 Werral Flat Hall.</p> <p>21:36 Just past old School site turn right through wire gate</p> <p>21:44 Through Sliprails along fence East towards steep ridge.</p> <p>21:52 Through old fence line proceed straight up steep ridge.</p> <p>22:71 Ridge levels Bears left through scattered trees. FOLLOW RIDGE</p> <p>23:40 TRIG <b>VISIBLE AHEAD SLIGHTLY LEFT.</b></p> <p>24:45 GO THROUGH <b>SLIPRAILS. STRAIGHT UP STEEP RIDGE.</b></p> <p>25:26 BUTTERFLY G.S. (P)</p>
<p>Beacon Diagram</p> <p>TM 1570</p> <p>J.U. 1370</p> <p>SV. 1300</p> <p>0:00</p> <p>1300</p>	<p>This section to be completed by officer constructing pillar.</p> <p>Original station mark found/<del>not found</del>: <b>5/Steel Pillar Plate</b></p> <p>Description of mark: .....</p> <p>Original beacon <del>found</del>/not found.</p> <p>Description of beacon: <b>To be replaced</b> .....</p> <p>Height Top of Vanes to Top Mark .....m.</p> <p>Height of mark: .....m. above G.L. below G.L.</p> <p>Diameter of Vanes .....m. Height of Cairn .....m.</p> <p>Original Beacon has/has not been destroyed by me.</p>
<p>Date</p> <p>Records of Station</p>	