

LAND INFORMATION CENTRE

GEODETTIC SURVEY OF A.S.W.

GEODETTIC STATION RECONNAISSANCE and MAINTENANCE REPORT

Description:

1. Cleared by lanes bearing OK FOR C.P.S. *Note: Cross out word or words which do not apply* from Trig. Mast

2. Mast & Vanes have been painted white & black respectively.

3. The station/pillar was ~~unpulled~~ ^{visited} ~~not unpulled~~ constructed on 14.3 19.1 dimensions now being: (UNDER STEEL CAP PAINTED RED)

Description of mark: Copper tube ^{above} ~~below~~ in Conc Roof. ^{above} ~~below~~ Steel Pillar Plate; Steel plug, Brass plug, Bolt, G.I. Pipe

Height of mark: 0.00 ^{above} ~~below~~ rock/concrete. ^{above} ~~below~~ G.L. AT ROOF LEVEL.

Height of Top Vanes to Top Mark/Pillar plate 0.00 m. Diameter of Vanes (vertical) 0.00 m.

Height of Cairn 0.00 m. Diameter of Cairn 0.00 m. Name Plate found/not found/placed: 0.00 m.

Length of Mast 0.00 m. (approximate if not unpiled)

4. A. 0.00 set in conc/rock has been placed/found, bearing 0.00 °M from Mast/Plug/Pillar

5. A. 0.00 set in conc/rock has been placed/found, bearing 0.00 °M from Mast/Plug/Pillar

6. A. 0.00 set in conc/rock has been placed/found, bearing 0.00 °M from Mast/Plug/Pillar

7. A. 0.00 set in conc/rock has been placed/found, bearing 0.00 °M from Mast/Plug/Pillar

8. Action required: * CONNECTIONS IN ANGLE BESS C588 FOLIOS 13+14 * 7/5/91

STANDPOINT: * CU TUBE IN CONC ROOF (NML59) STANDPOINT: PILLAR PLATE

Mark	Direction	Horiz. Distance	Height Difference	Mark	Direction	Horiz. Distance	Height Difference
CULGOORA TRANST NML 60	0° 00' 00"	0.00	above standpt	CULGOORA TRANST NML 60	0° 00' 00"	0.00	above standpt
CULGOORA (P)	211 11 00	8.094 4.434	above standpt	NML 59 CU TUBE	30 41 56	8.094 4.434	above standpt
			below standpt				below standpt
			above standpt				above standpt
			below standpt				below standpt
			above standpt				above standpt
			below standpt				below standpt

Prepared by: L.I.C.

Checked: [Signature]

Noted on: U.T.M. Card

STATION: CULGOORA SOLAR No.: 6258

MAP SHEET SCALE 1:250 000 NARRABRI

INSPECTED BY: L. HITCHINS DATE: 14.3.91

AUTHORITY: L.I.C. FIELD BOOK: ---

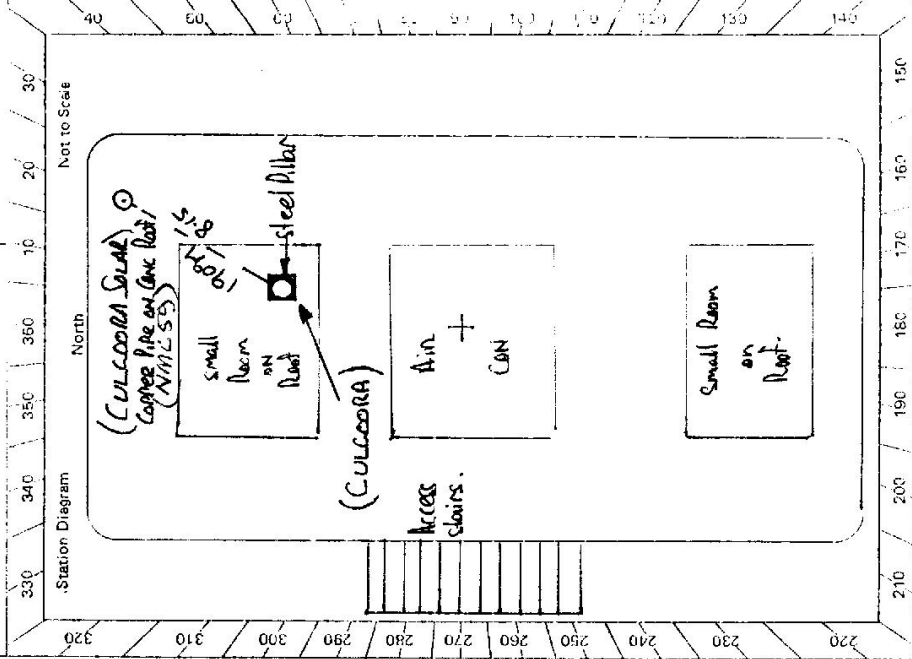

Checked

STATION **CULGOORA SOLAR 6258**

Owner's Name: **Australia Telescope**
 Address: **National Facility, Contract**
Ms Lorna Kent (Administrative Officer)
 Phone: **067-959205 Business Hrs.**

Current Occupant:
 Address:
 Phone:

ACCESS

Access Report of 14.3.19 was found suitable/unsuitable.
*** Please Call During Business Hrs. Weekdays ***

0-0 NARRABRI RD. HEAD SOUTH ALONG DOYLE ST
0-08 TURN LEFT ONTO NEWELL HWY. FOLLOW HIGHWAY TO RIGHT + CROSS BRIDGE.
2-95 TURN RIGHT OFF HIGHWAY AT WILLOWA ST
3-60 TURN RIGHT AT WILLOWA ST
21-71 TURN RIGHT SIGN "CULGOORA 7"
23-88 TURN LEFT + CROSS GRID.
2574 CROSS GRID
25-87 TURN RIGHT
25-92 MAIN CONTROL BUILDING ON LEFT.

MARK IS ON TOP OF BUILDING NEAR N/E CORNER
UNDER RED STEEL CAP.
STAIRS AT REAR OF BUILDING.

Beacon Diagram

Not to Scale



ATNF



NATIONAL FACILITY



CSIRO

Ms Lorna Kent
Administrative Officer

ATNF NARRABRI
Paul Wild Observatory
Culgoora NSW

Postal Address:
PO Box 94
Narrabri NSW 2390
Australia

Telephone: (067) 95 9205
FAX: (61 67) 95 9205
E-mail: lkent@pepping.osza

ATNF NARRABRI
Paul Wild Observatory
Culgoora NSW

Telephone: (067) 95 9205
FAX: (61 67) 95 9205
E-mail: lkent@pepping.osza

This section to be completed by officer constructing pillar.

Original station mark found/not found.

Description of mark:

Original beacon found/not found.

Description of beacon:

Height: Top of Vanes to Top Mark.ft.

Height of mark.m. above G.L.
 below rock/conc.m. below

Diameter of Vanesm. Height of Cairnm.

Original Beacon has/has not been destroyed by me.

Date	Record of Station

LAND INFORMATION CENTRE

GEODETTIC SURVEY OF A.S.W.

GEODETTIC STATION RECONNAISSANCE and MAINTENANCE REPORT

STATION: **CULGOERA SOLAR** No.: **6258**

MAP SHEET SCALE 1:250 000

INSPECTED BY: **M MARRISON** DATE: **14/9/92**

AUTHORITY: **LIC** FIELD BOOK: **—**

Description:

1. Cleared by lanes bearing..... *Note: Cross out word or words which do not apply*

2. Mast & Vanes have been painted white & black respectively. from Trig, Mast

3. The station/pillar was unspiled/not unspiled/constructed on..... [9]....., dimensions now being:

Description of mark..... should be explicit, e.g., S/Steel Pillar Plate, Steel plug, Brass plug, Bolt, G.I. Pipe

Height of mark.....m. ^{above} rock/concrete; Mark is.....m. ^{above} G.L. _{below}

Height of Top Vanes to Top Mark/Pillar plate.....m. Diameter of Vanes (vertical).....m.

Height of Cairn.....m. Diameter of Cairn.....m. Name Plate found/not found/placed.

Length of Mast.....m. (approximate if not unspiled)

4. A.....set in conc/rock has been placed/found, bearing.....° M from Mast/Plug/Pillar

5. A.....set in conc/rock has been placed/found, bearing.....° M from Mast/Plug/Pillar

6. A.....set in conc/rock has been placed/found, bearing.....° M from Mast/Plug/Pillar

7. A.....set in conc/rock has been placed/found, bearing.....° M from Mast/Plug/Pillar

8. Action ~~required~~: **STATION HAS OBTAINED BY GPS**

STANDPOINT:

Mark	Direction	Horiz. Distance	Height Difference	Mark	Direction	Horiz. Distance	Height Difference
			above standpt.				above standpt.
			below				below
			above standpt.				above standpt.
			below				below
			above standpt.				above standpt.
			below				below
			above standpt.				above standpt.
			below				below
			above standpt.				above standpt.
			below				below

Prepared by:  Checked: *Checked*

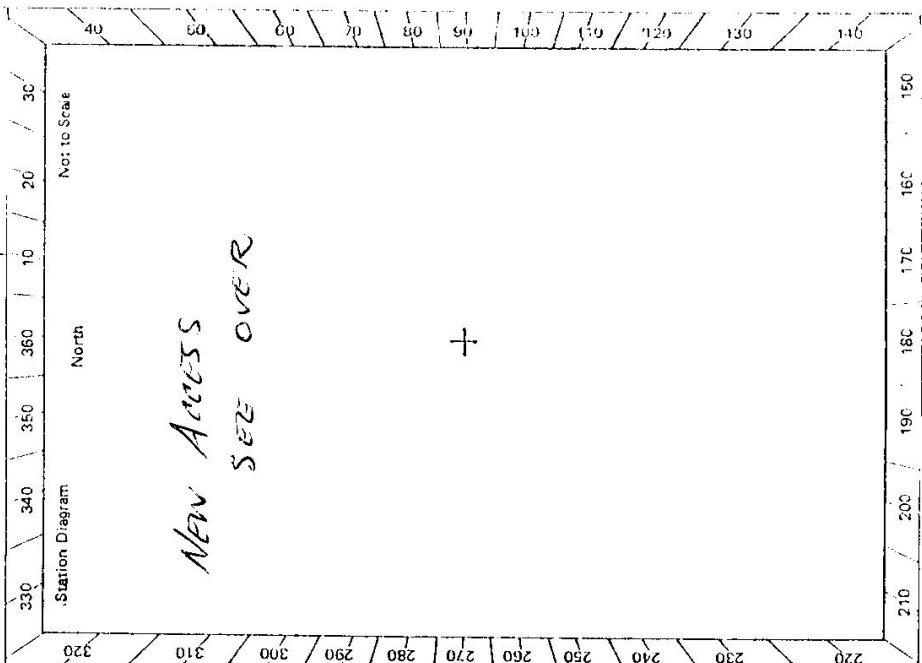

STATION **CULGOORA SOLAR TS 6258**

Owner's Name: **AUSTRALIA TELESCOPE**

Address: **NATIONAL FACILITY**

CONTACT **MS LORNA KENT (ADMINISTRATIVE OFFICER)**

Phone: **06.7.95.9205 (BUS HOURS)**

(FAX 1067 959233)

Current Occupant: **P. Box 91**

Address: **NARRABRI 2330**

Phone: **15/9/92**

ACCESS

Access Report of **M31951** was found **unsuitable**

DIRECTION

NOTE: **PAVING BEFORE VISITING STATION**

NARRABRI RD HEAD WEST ALONG DOYLE ST. TOWARDS RIVER

TURN LEFT ONTO MURVELL HWY

TURN RIGHT EVER BRIDGE SIGN: GUNNEDAH, COONABARRAN

TURN RIGHT INTO UGRA ST. SIGN: AUSTRALIA TELESCOPE 23

TURN LEFT INTO WALLONIA ST. SIGN: AUSTRALIA TELESCOPE

TURN RIGHT INTO GERRARD ST

PASS ROAD ON RIGHT TO NEE WAH, CULGOORA GO STRAIGHT AHEAD OVER

RAILWAY LINE TOWARDS CSIRO, YARRIE LAKE

PASS ROAD ON RIGHT TO AUSTRALIA TELESCOPE

TURN LEFT AT CROSS-ROADS FOLLOW ROAD OVER GRID AND ROUND TO THE RIGHT

PASS CONTROL BUILDING ON LEFT. CULGOORA (P) + CULGOORA SOLAR ON RIGHT

(ACCESS TO THESE STATIONS BY FIRE ESCAPE / STAIRS AT REAR OF BUILDING)

CROSS RAIL TRACKS + THROUGH GATE (USUALLY LOCKED) AND CROSS GRID

NINE GO ON LEFT. ABOUT 10M TO LEFT OF ROAD AND ABOUT 50M BEHIND BUILDING

- km
- 0.0
- 0.1
- 0.2
- 1.7
- 2.5
- 3.6
- 6.1
- 21.9
- 22.0
- 24.6
- 24.85
- 25.0
- 25.4

Date

Record of Station