

GEODETTIC SURVEY OF M.S.W.

CENTRAL MAPPING AUTHORITY

GEODETTIC STATION RECONNAISSANCE and MAINTENANCE REPORT

Description:

1. Cleared by lanes bearing..... CLEARED 3000 ✓ Note: Cross out word or words which do not apply

2. Mast & Vanes have been painted white & black respectively. /

3. The station/pillar was ~~erected~~ not erected / constructed on 2E 11 19 7E 11 dimensions now being:

Description of mark..... Steel Pillar Steel Plate Steel plug Brass plug Bolt G.I. Pipe

Height of mark..... 3.7 m above mark / concrete / concrete / concrete / concrete / G.L. / above G.L.

Height of Top Vanes to Top ~~mark~~ / Pillar plate 1.430 m / Diameter of Vanes (vertical) 0.75 m.

Height of Cairn..... m / Diameter of Cairn..... m / Name Plate found / not found / placed.

Length of Mast..... m / (approximate if not unplied)

4. A Brass Top Plate set in conc/~~mark~~ has been ~~placed~~ / found, bearing 273 0 M from ~~mark~~ / mark / mark / Pillar /

5. A SSM set in conc/~~mark~~ has been ~~placed~~ / found, bearing 258 0 M from ~~mark~~ / mark / mark / Pillar /

6. A C.I. Pipe set in conc/~~mark~~ has been ~~placed~~ / found, bearing 310 0 M from ~~mark~~ / mark / mark / Pillar /

7. A set in conc/~~mark~~ has been placed / found, bearing 0 M from Mast/mark / mark / Pillar

8. Action required:.....

STANDPOINT: PILLAR PLATE

Mark	Direction	Horiz. Distance	Height Difference	Mark	Direction	Horiz. Distance	Height Difference
BOMRA G.S (P)	0 00 00		above standpt.	BOMRA G.S (P)	0 00 00		above standpt.
YAKRAHAPINNI G.S (P)	165 17 30		above standpt.	C.I. PIPE	39 18 13	2.440	above standpt.
C.I. PIPE	8 17 46	3.782	below	Conc Obs Pillar	51 39 54	2.108	above standpt.
ANUSONS SENSARANI G.S (P)	295 47 26		above standpt.	YAKRAHAPINNI G.S (P)	165 16 56		above standpt.
SSM	316 09 30	4.365	below	ANUSONS SENSARANI G.S (P)	295 46 38		above standpt.
BRASS TRIG PLUG	331 33 39	2.106	below	SSM	302 35 27	2.402	above standpt.

STANDPOINT: BRASS TRIG PLUG

Mark	Direction	Horiz. Distance	Height Difference
BOMRA G.S (P)	0 00 00		above standpt.
C.I. PIPE	39 18 13	2.440	above standpt.
Conc Obs Pillar	51 39 54	2.108	above standpt.
YAKRAHAPINNI G.S (P)	165 16 56		above standpt.
ANUSONS SENSARANI G.S (P)	295 46 38		above standpt.
SSM	302 35 27	2.402	above standpt.

Prepared by: P.L. King

Checked: 10.12.78

Noted on U.T.M. Card

S. 2735-1

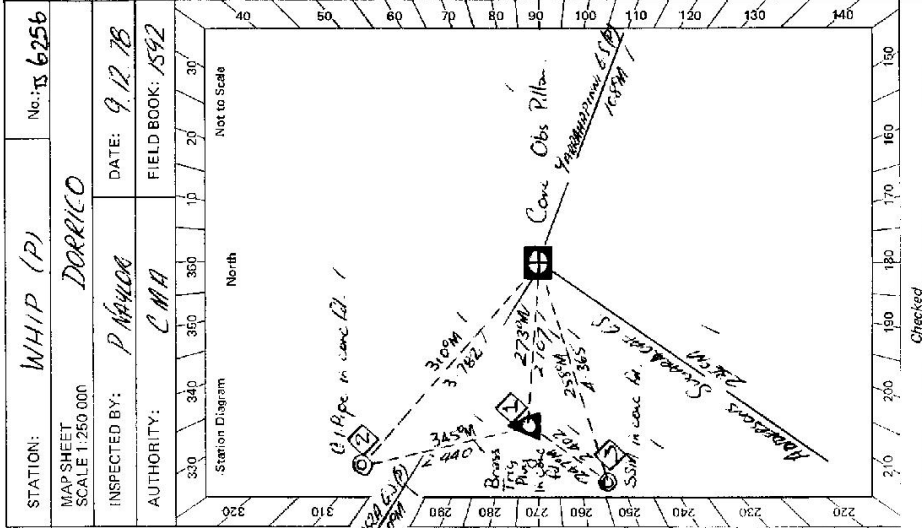

Checked

