

GEODETTIC SURVEY OF NSLW

CENTRAL MAPPING AUTHORITY

GEODETTIC STATION RECONNAISSANCE and MAINTENANCE REPORT

Description:

Note: Cross out word or words which do not apply

1. Cleared by lanes bearing.....*3.45°*.....*2.45°*..... from Trig. Mast
2. Mast & Vanes have been painted white & black respectively.
3. The station/pillar was unpiled/not unpiled/constructed on.....*19*..... dimensions now being:
Description of mark.....*STEEL P/PLUG*.....should be explicit, e.g., S/Steel Pillar Plate, Steel plug, Brass plug, Bolt, G.I. Pipe
Height of mark.....*0.6*.....m. above rock/concrete; Mark is.....*0.6*.....m. above G.I.
Height of Top Vanes to Top Mark/Pillar plate.....*1.46*.....m. Diameter of Vanes (vertical).....*0.6*.....m.
Height of Cairn.....m. Diameter of Cairn.....m. Name Plate found/not found/placed.
Length of Mast.....m. (approximate if not unpiled)
4. A.....*TRIG. PILLAR*.....set in conc/rock has been placed/found, bearing.....*187*.....°M from Mast/Plug/Pillar
5. A.....*C.U. MOLA*.....set in conc/rock has been placed/found, bearing.....*172*.....°M from Mast/Plug/Pillar
6. A.....*SSM 22359*.....set in conc/rock has been placed/found, bearing.....*209*.....°M from Mast/Plug/Pillar
7. A.....*SSM 22359*.....set in conc/rock has been placed/found, bearing.....°M from Mast/Plug/Pillar
8. Action required:.....

STANDPOINT: *TRIG PILLAR*

Mark	Direction	Honz. Distance	Height Difference	Mark	Direction	Honz. Distance	Height Difference
<i>BROKEN BACK G.S. (P)</i>	<i>0° 00' 00"</i>		<i>above standpt.</i>	<i>BROKEN BACK G.S. (P)</i>	<i>0° 00' 00"</i>		<i>above standpt.</i>
<i>WARRAWONG G.S.</i>	<i>175 52 37.5</i>		<i>above standpt.</i>	<i>TRIG. PILLAR</i>	<i>162 04 41.5</i>	<i>7 290</i>	<i>above standpt.</i>
<i>C.U. MOLA IN ROCK</i>	<i>179 53 27.5</i>	<i>5.574</i>	<i>above standpt.</i>	<i>WARRAWONG G.S.</i>	<i>175 52 06</i>		<i>above standpt.</i>
<i>SSM 22359</i>	<i>258 34 08</i>	<i>5.262</i>	<i>above standpt.</i>	<i>C.U. MOLA IN ROCK</i>	<i>185 56 07</i>	<i>8.376</i>	<i>above standpt.</i>
<i>PILLAR SPICGOT</i>	<i>342 02 09.5</i>	<i>3.209</i>	<i>above standpt.</i>	<i>SSM 22359</i>	<i>224 45 09</i>	<i>5.890</i>	<i>above standpt.</i>
			<i>below</i>				<i>below</i>

STANDPOINT: *PILLAR SPICGOT*

Mark	Direction	Honz. Distance	Height Difference	Mark	Direction	Honz. Distance	Height Difference
<i>BROKEN BACK G.S. (P)</i>	<i>0° 00' 00"</i>		<i>above standpt.</i>	<i>BROKEN BACK G.S. (P)</i>	<i>0° 00' 00"</i>		<i>above standpt.</i>
<i>WARRAWONG G.S.</i>	<i>175 52 37.5</i>		<i>above standpt.</i>	<i>TRIG. PILLAR</i>	<i>162 04 41.5</i>	<i>7 290</i>	<i>above standpt.</i>
<i>C.U. MOLA IN ROCK</i>	<i>179 53 27.5</i>	<i>5.574</i>	<i>above standpt.</i>	<i>WARRAWONG G.S.</i>	<i>175 52 06</i>		<i>above standpt.</i>
<i>SSM 22359</i>	<i>258 34 08</i>	<i>5.262</i>	<i>above standpt.</i>	<i>C.U. MOLA IN ROCK</i>	<i>185 56 07</i>	<i>8.376</i>	<i>above standpt.</i>
<i>PILLAR SPICGOT</i>	<i>342 02 09.5</i>	<i>3.209</i>	<i>above standpt.</i>	<i>SSM 22359</i>	<i>224 45 09</i>	<i>5.890</i>	<i>above standpt.</i>
			<i>below</i>				<i>below</i>

Prepared by: *Greg Dickson*

Checked:

Noted on U.T.M. Card

Sr 2793-1

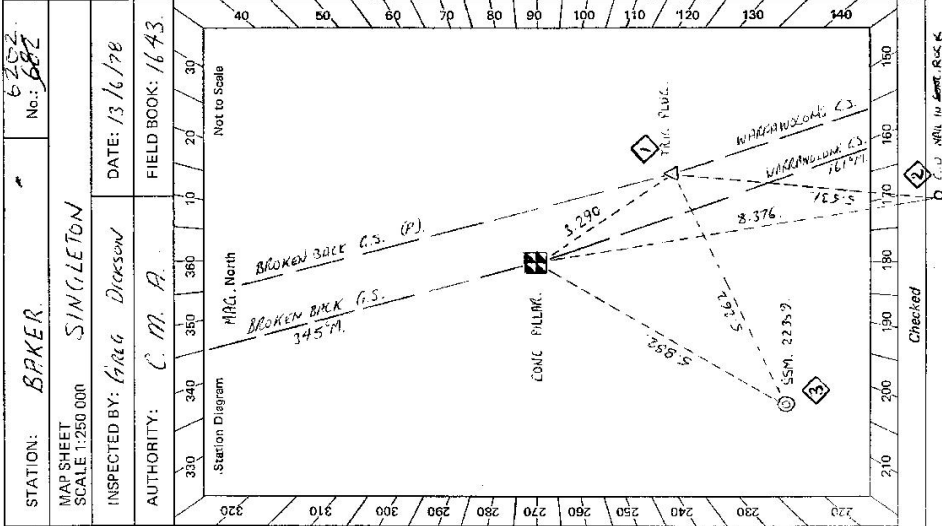

STATION: *BPKER* No: *6202-682*

MAP SHEET SCALE 1:250 000 *SINGLETON*

INSPECTED BY: *Greg Dickson* DATE: *13/6/18*

AUTHORITY: *C.M.A.* FIELD BOOK: *1643*

Checked

C.U. MOLA IN ROCK

STATION BAKER - 6202	Owner's Name: Address: Phone:	Current Occupant: Address: Phone:	Access Report of 12.6.1974 was found suitable/unsuitable. Km. 0.0 0.3 MILLFIELD P.O. HEAD SW TOWARDS KILLOMIST 0.2 TURN RIGHT AT VIEW 0.3 CARVEL ROAD 0.3 BRIDGE 2.9 MILLFIELD FROM ON RIGHT HAND SIDE OF ROAD 5.2 TURN LEFT 5.5 GATE - FOLLOW TRACK PULLY FERRY LINE - HOUSE IN FRONT 6.4 GATE - FOLLOW TRACK AROUND NEAR SIDE OF DYM. 7.1 KEEP RIGHT FOLLOW AROUND ON TREE 7.4 CROSS GULLY 7.9 FOLLOW TRACK AROUND TO LEFT. 8.9 TURN LEFT AT BAZZES HEAD GO THROUGH STENO. 9.1 TRIC.
Beacon Diagram <p style="text-align: right;">Not to Scale</p>		This section to be completed by officer constructing pillar. Original station mark found/not found.	
Description of mark: Original beacon found/not found.		Description of beacon: Height Top of Vane to Top Markm. Height of markm. above rock/concm. below G.L. Diameter of Vanem. Height of Cairnm. Original Beacon has/has not been destroyed by me.	
Date		Record of Station	

CENTRAL MAPPING AUTHORITY

GEODETIC SURVEY OF NSW Batch Id: 1597

GEODETIC STATION RECONNAISSANCE and MAINTENANCE REPORT

Description:

Note: Cross out word or words which do not apply

1. Cleared by lanes bearing $325^{\circ} 19' 27.6''$ from Trig. Mast
2. Mast & Vanes have been painted white & black respectively. ✓
3. The ~~vanes~~ pillar was ~~unplaced~~ ^{found} /constructed on $13 - 3 - 19.81$, dimensions now being: Description of mark **BRASS PILLAR** should be explicit, e.g., S/Steel Pillar Plate, Steel plug, Brass plug, Bolt, G.I. Pipe
Height of mark 1.565 m. ^{above} ~~below~~ **CONCRETE**; Mark is 1.565 m. ^{above} G.L.
Height of Top Vanes to Top ~~black~~ /Pillar plate 1.465 m. Diameter of Vanes (vertical) 60 mm.
Height of Cairn 0 m. Diameter of Cairn 0 m. Name Plate found/~~not found~~ **CONCRETE PILLAR**
Length of Mast 0 m. (approximate if not unplied)
4. A **BRASS PILLAR** set in conc/rock has been ~~placed~~ /found, bearing 140° M from ~~Mast/Plug/Pillar~~ ✓
5. A **COPPER NAIL** set in conc/rock has been ~~placed~~ /found, bearing 159° M from ~~Mast/Plug/Pillar~~ ✓
6. A **CONCRETE PILLAR** set in conc/rock has been placed /found, bearing 0° M from Mast/Plug/Pillar
7. A **BRASS PILLAR** set in conc/rock has been placed /found, bearing 0° M from Mast/Plug/Pillar
8. Action required:

STANDPOINT: PILLAR PLATE		STANDPOINT: BRASS TAIL PILLAR	
Mark	Direction	Horiz. Distance	Height Difference
BROKEN BRASS PILLAR	0 00 00		above standpt.
BRASS PILLAR	162 04 00	3.289	below standpt.
COPPER NAIL	185 55 00	8.382	below standpt.
BRASS PILLAR	272 30 40		below standpt.
			below standpt.
			below standpt.
			below standpt.
			below standpt.
			below standpt.
			below standpt.

Prepared by: **ATL**

Checked: **ATL**

Noted on U.T.M. Card

54 2733-1

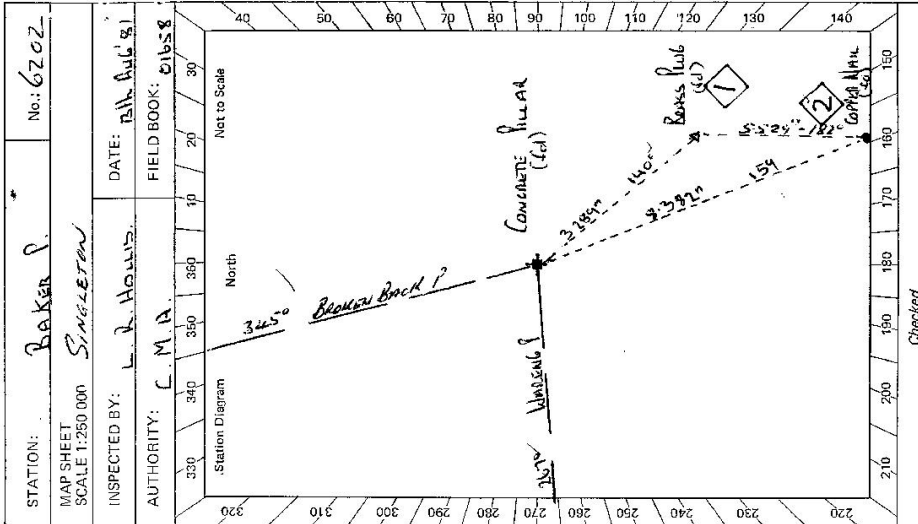

Sr 2733--2 D. West, Government Printer

STATION	BAKER P. - 6202	Owner's Name: Address: Phone:	Current Occupant: Address: Phone:	ACCESS Access Report of 13/2/19. It was found suitable/unsuitable. 5:00 MILLFIELD POST OFFICE TRAVEL TOWARDS WOLLUMBI 6:30 TURN RIGHT SIGN "MOUNTAIN VIEW" 7:30 CROSS BRIDGE 7:50 PASS "LEWIS LANE" ON LEFT 8:50 PASS ROAD ON LEFT 9:30 TURN SHIRT LEFT 9:40 TURN RIGHT THROUGH IRON GATE, PASSING HOUSE ON OTHER SIDE OF FENCE 9:50 THROUGH IRON GATE, FOLLOWING TRAIL TO LEFT ABOUT DAMS 10:00 TAKE RIGHT FORK. 10:10 TAKE LEFT FORK. ABOUT VERY SLIGHT BUMP OUT TRAIL FROM HOLE 10:20 FOLLOW TRAIL RAMPING TO LEFT AND TRAVEL BACK ALONG RIDGE 10:30 TURN LEFT AT BLAZES BAKER G'S.
---------	-----------------	---	---	--

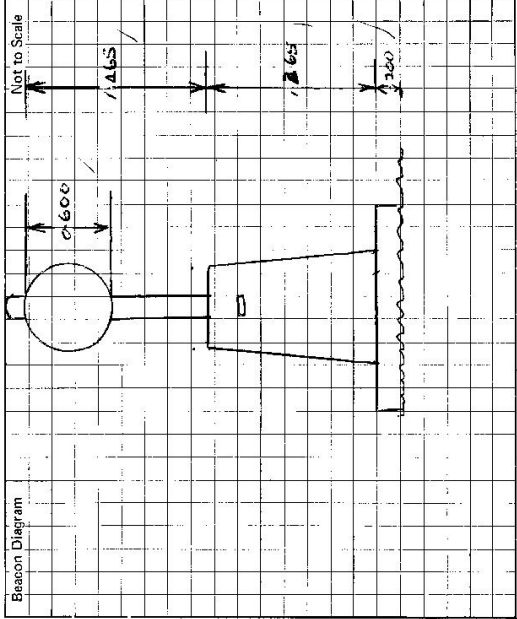

This section to be completed by officer constructing pillar.

Original station mark found/not found.

Description of mark:

Original beacon found/not found.

Description of beacon:

Height Top of Vanes to Top Mark.....m.

Height of mark.....m. above G.L.
 below

Diameter of Vanes.....m. Height of Cairn.....m.

Original Beacon has/has not been destroyed by me.

Date	Record of Station

