

GEODETIC SURVEY OF N.S.W.

CENTRAL MAPPING AUTHORITY

GEODETIC STATION RECONNAISSANCE and MAINTENANCE REPORT

Description:

- Note: Cross out word or words which do not apply
- Cleared by lanes bearing  $230^{\circ} 00'$   $140^{\circ} 00'$   $165^{\circ} 00'$   $265^{\circ} 00'$  from Trig. Mast
  - Mast & Vanes have been painted white & black respectively.
  - The station/pillar was ~~replaced~~ constructed on  $2.1 \times 1.1$  m concrete, dimensions now being: Description of mark ~~Steel~~ ~~concrete~~ should be explicit, e.g., S/Steel Pillar Plate, Steel plug, Brass plug, Bolt, G.I. Pipe Height of mark  $1.525$  m above ~~rock~~ ~~concrete~~ Mark is  $1.525$  m above G.L.
  - Height of Top Vanes to Top ~~Mark~~ ~~Pillar plate~~  $1.525$  m. Diameter of Vanes (vertical)  $1.525$  m.
  - Height of Cairn  $0$  m. Diameter of Cairn  $0$  m. Name Plate ~~Stainless Steel~~ placed.
  - Length of Mast  $0$  m. (approximate if not unpeeled)
  - A ~~Stainless Steel~~ ~~rod~~ set in conc/rock has been placed/found, bearing  $230^{\circ} 00'$   $140^{\circ} 00'$   $165^{\circ} 00'$   $265^{\circ} 00'$  from Mast/Plug/Pillar
  - A ~~Stainless Steel~~ ~~rod~~ set in conc/rock has been placed/found, bearing  $211^{\circ} 00'$   $00'$  from Mast/Plug/Pillar
  - A ~~Stainless Steel~~ ~~rod~~ set in conc/rock has been placed/found, bearing  $211^{\circ} 00'$   $00'$  from Mast/Plug/Pillar
  - A ~~Stainless Steel~~ ~~rod~~ set in conc/rock has been placed/found, bearing  $211^{\circ} 00'$   $00'$  from Mast/Plug/Pillar
  - Action required:  $0$

STANDPOINT:

Mark	Direction	Horiz. Distance	Height Difference	Mark	Direction	Horiz. Distance	Height Difference
ANGULAR PL	$0^{\circ} 00'$	$0$	above standpt.	ANGULAR PL	$0^{\circ} 00'$	$0$	above standpt.
CONC OBS. PILLARS	$140^{\circ} 00'$ $165^{\circ} 00'$ $265^{\circ} 00'$	$140$ $165$ $265$	above standpt.	CONC OBS. PILLARS	$140^{\circ} 00'$ $165^{\circ} 00'$ $265^{\circ} 00'$	$140$ $165$ $265$	above standpt.
SSM 7177	$211^{\circ} 00'$	$1.525$	below	SSM 7177	$211^{\circ} 00'$	$1.525$	below
STAINLESS STEEL P.L.	$211^{\circ} 00'$	$1.525$	below	STAINLESS STEEL P.L.	$211^{\circ} 00'$	$1.525$	below

Prepared by: *[Signature]* Checked: *[Signature]*

ST 2733-1

STATION: *Saint Helms Hill* No: *TS 6181*

MAP SHEET SCALE 1:250 000

INSPECTED BY: *[Signature]*

DATE: *11/11/18*

AUTHORITY: *[Signature]*

FIELD BOOK: *1662*

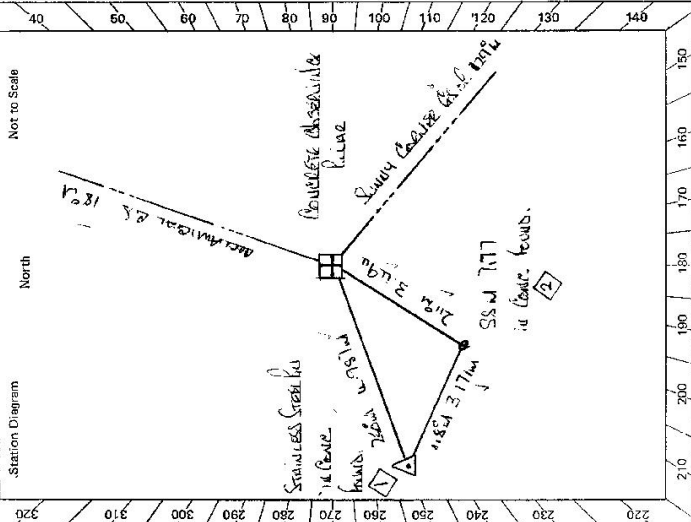

Checked: *[Signature]*

STATION SMITHS BOUND HILL 6181

Owner's Name: FOLKSTONE COMMUNITIES  
 Address: .....  
 Phone: .....  
 Current Occupant: .....  
 Address: .....  
 Phone: .....

**ACCESS**

Access Report of 28/7/1978 was found suitable/unsuitable.

Feb 1978 Yellow cone black catface  
6.00 for sunny earlier head west towards barnicot!  
5.11.5 Turn right seen dark circular sign!  
5.00 Turn left at tin bus shelter take road straight ahead with line fence on right  
6.7a Pass house on left  
7.00 Pass house on right house and shed on left  
7.20 Pass house on right  
7.80 Island gate  
8.35 Island gate  
8.11.0 Pass house on right and left  
8.7c Pass house on right and tin hut on left  
8.80 Turn left and follow faint track  
9.7a Smiths Bound Hill as of

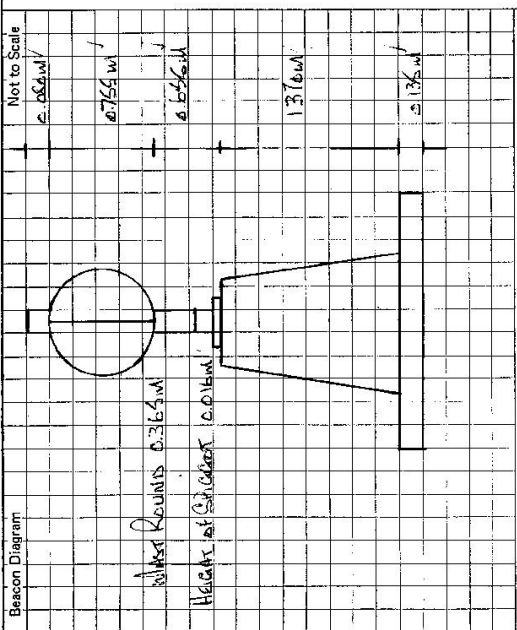

This section to be completed by officer constructing pillar.

Original station mark found/~~not found~~.  
 Description of mark: STAINLESS STEEL TOWER  
 Original beacon found/~~not found~~.  
 Description of beacon: Painted base x pipe  
 Height Top of Vanes to Top Mark: 3.74 m.  
 Height of mark: 0.26 m. above ~~below~~ concrete m. ~~above~~ below G.L.  
 Diameter of Vanes: 1.010 m. Height of Cairn: 0.860 m.  
 Original Beacon has ~~been~~ been destroyed by me.

Date	Record of Station
<u>20/3/88</u>	<u>COMPLETED SURVEYED BY TEN DIA RECONSTRUCTION</u> <u>RUCAR MIV SHOULD BE PAINTED</u>