

CENTRAL MAPPING AUTHORITY
Department of Lands

Trigonometrical Survey of N.S.W.

RECONNAISSANCE and MAINTENANCE REPORT

This Trig. Station has been:-

Note: Cross out word or words which do not apply

1. Completely cleared to permit 360° vision to surrounding Trig.
2. Cleared by lanes bearing 75° to 210° 310° to 340° from Trig. Mast
3. Trig. Mast & Vanes have been painted white & black respectively.
4. The Trig. was ~~unpiled~~/not unpiled, dimensions now being:

Description of mark..... should be explicit, e.g. Steel plug, Brass plug, Bolt, G.I. Pipe
 Height of mark..... m above rock/concrete m below G.L.
 Height of Top Vanes to Top Mark..... m. Diameter of Vanes (vertical)..... m.
 Height of Cairn..... m. Diameter of Cairn..... m.
 Length of Mast..... m. (approximate if not unpiled)

5. A..... set in conc/rock has been placed..... m. bearing.....°M from Trig. Mast
6. A..... set in conc./soil has been placed..... m. bearing.....°M from Trig. Mast
7. A..... set in conc./soil has been placed..... m. bearing.....°M from Trig. Mast
8. A..... set in conc/rock has been placed..... m. bearing.....°M from Trig. Mast
9. Connection..... to..... m. bearing.....°M
10. Connection..... to..... m. bearing.....°M
11. Connection..... to..... m. bearing.....°M
12. Connection..... to..... m. bearing.....°M
13. Diff. Ht. is..... m. above below
14. Diff. Ht. is..... m. above below
15. Diff. Ht. is..... m. above below
16. Diff. Ht. is..... m. above below

Prepared by: M.L. Morrison Checked:

Noted on U.T.M. Card

STATION Resubmitt TS 6153
 Co: AWPS Ph: Resubmitt
 Map Sheet: COWARRAL No: 9335
 Inspected by: M.L. Morrison Date: 15.7.77
 Authority: Field Book: 1580

Beacon Diagram

Not to Scale

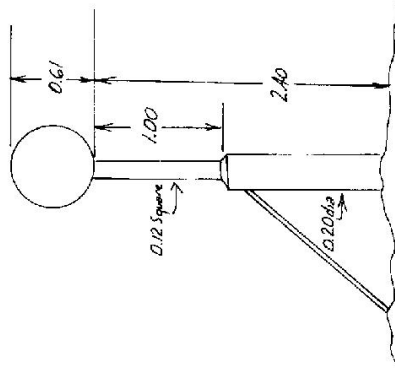

Date

Record of Station
 THIS IN PAST CONSTRUCTION. Mast NEEDS REPAIRING BY
 ONE WOODEN STAY 35M IN GROUND FOR

Checked

CENTRAL MAPPING AUTHORITY

GEODETIC SURVEY OF I.L.S.W.
GEODETIC STATION RECONNAISSANCE and MAINTENANCE REPORT

STATION: **Rushibek Ruwa** No.: **75 6153**
 MAP SHEET SCALE 1:250 000
 INSPECTED BY: **Hassan S** DATE: **31st June 18**
 AUTHORITY: **L. D. Hovis** FIELD BOOK: **01527**

Description:	STANDPOINT: BRASS PLATE		STANDPOINT: BRASS TIE RING	
	Mark	Horiz. Distance	Mark	Horiz. Distance
1. Cleared by lanes bearing.....				
2. Mast & Vanes have been painted white & black respectively.				
3. The station pillar was unplaced/not supplied constructed on concrete concrete .				
Description of marks.....				
Height of mark.....m. above rock/concrete G.L.				
Height of Top Vanes to Top Mark/Pillar plate Mark/Pillar platem. Diameter of Vanes (vertical)..... 768m.				
Height of Cairn.....m. Diameter of Cairn.....m. Name Plate found/not found/placed.				
Length of Mast.....m. (approximate if not supplied)				
4. Anchor Anchorset in conc/ rock rock has been placed placed /found, bearing..... 8° M from Mast/Plug/Pillar Mast/Plug/Pillar				
5. A S.S.M. S.S.M.set in conc/ rock rock has been placed placed /found, bearing..... 387° M from Mast/Plug/Pillar Mast/Plug/Pillar				
6. A.....set in conc/ rock rock has been placed placed /found, bearing.....° M from Mast/Plug/Pillar Mast/Plug/Pillar				
7. A.....set in conc/ rock rock has been placed placed /found, bearing.....° M from Mast/Plug/Pillar Mast/Plug/Pillar				
8. Action required:.....				

Mark	Horiz. Distance	Height Difference	Direction	Mark	Horiz. Distance	Height Difference
YAGERS RING	0 02 00	above standpt	0 02 00	YAGERS RING	0 02 00	above standpt
KONKOR RING	37 03 50	above standpt	37 03 55	KONKOR RING	37 03 55	above standpt
S.S.M.	100 06 00	above standpt	84 04 45	RUWA PLATE	1736	above standpt
BRASS TIE RING	264 04 50	above standpt	141 51 10	S.S.M.	3005	above standpt
		below				below
		above standpt				above standpt
		below				below
		above standpt				above standpt
		below				below

Prepared by: **[Signature]** Checked: **[Signature]**
 Noted on U.T.M. Card

61

<p>ST.2735-3 D. West Government Prince</p> <p>Beacon Diagram</p> <p style="text-align: right;">Not to Scale</p>	<p style="text-align: center;">STATION <u>RUSHBORN PUNE IS 6153</u></p> <p>Owner's Name: Address: Phone:</p> <p>Current Occupant: <u>FORSTEN COMMAND</u> Address: <u>WASHING</u> Phone:</p> <p style="text-align: center;">ACCESS</p> <p>Access Report of <u>27/4/1977</u> was found suitable/unsuitable <u>ON OVERVIEW FROM SIBU NEARBY P.O. 0.5 KM</u> <u>MANUAL EAST BOUNDARY THROUGH</u> <u>TREES LEFT</u> <u>ON ROAD TALK.</u></p> <p>0.00 KM 1160 1130 1185</p>
<p>This section to be completed by officer constructing pillar.</p> <p>Original station mark found/not found</p> <p>Description of mark: <u>ROCKY TALK</u> <u>1160</u> <u>1130</u> <u>1185</u></p> <p>Original beacon found/not found</p> <p>Description of beacon: <u>CONCRETE</u> <u>1160</u> <u>1130</u> <u>1185</u></p> <p>Height Top of Vanes to Top Mark: <u>3.575</u> m. <input checked="" type="checkbox"/> above <input type="checkbox"/> below G.L.</p> <p>Height of mark: <u>1130</u> m. <input checked="" type="checkbox"/> above <input type="checkbox"/> below G.L.</p> <p>Diameter of Vanes: <u>140</u> m. Height of Calm: <u>1160</u> m.</p> <p>Original Beacon has/has not been destroyed by me. <input checked="" type="checkbox"/></p>	
	<p>Date</p> <p style="text-align: right;">Record of Station</p>

CENTRAL MAPPING AUTHORITY

GEODETTIC SURVEY OF N.S.W.

GEODETTIC STATION RECONNAISSANCE and MAINTENANCE REPORT

Description:

1. Cleared by lanes bearing..... *See Diagram*..... from Trig. Mast
 Note: Cross out word or words which do not apply

2. Mast & Vanes have been painted white & black respectively.

3. The station/pillar was unpiled/not unpiled/constructed on..... 19....., dimensions now being:

Description of mark..... *See Diagram*..... would be explicit, e.g., S/Steel Pillar Plate, Steel plug, Brass plug, Bolt, G.I. Pipe

Height of mark..... m. above rock/concrete; Mark is..... m. above G.L.

Height of Top Vanes to Top Mark/Pillar plate..... m. Diameter of Vanes (vertical)..... m.

Height of Cairn..... m. Diameter of Cairn..... m. Name Plate found/not found/placed.

Length of Mast..... m. (approximate if not unpiled)

4. A..... set in conc/rock has been placed/found, bearing..... °M from Mast/Plug/Pillar

5. A..... set in conc/rock has been placed/found, bearing..... °M from Mast/Plug/Pillar

6. A..... set in conc/rock has been placed/found, bearing..... °M from Mast/Plug/Pillar

7. A..... set in conc/rock has been placed/found, bearing..... °M from Mast/Plug/Pillar

8. Action required:.....

STANDPOINT:

STANDPOINT:

Mark	Direction	Horiz. Distance	Height Difference	Mark	Direction	Horiz. Distance	Height Difference
			above standpt. below				above standpt. below
			above standpt. below				above standpt. below
			above standpt. below				above standpt. below
			above standpt. below				above standpt. below
			above standpt. below				above standpt. below
			above standpt. below				above standpt. below
			above standpt. below				above standpt. below

Prepared by: *Flora*

Checked: *30/6/81*

Noted on L.I.M. Card

ST 2733-1

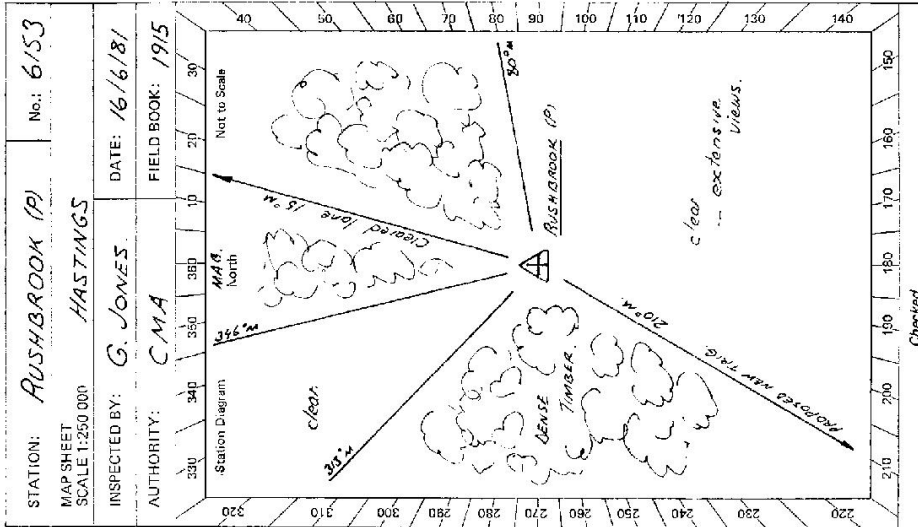

STATION: RUSHBROOK (P) No.: 6153

MAP SHEET SCALE 1:250 000

INSPECTED BY: G. JONES DATE: 16/6/81

AUTHORITY: CMA FIELD BOOK: 1915

Checked

Sr 2753-2 D. West, Government Printer

STATION *RUSHBROOK (P)* TS *6153*

Beacon Diagram	Not to Scale
<i>Concrete pillar found in good condition.</i>	

Owner's Name: *ENFIELD STATE FOREST*
 Address: *MAUCHOPE FORESTRY COMMISSION*
 Phone:
 Current Occupant: *N/A*
 Address:
 Phone:

ACCESS

Access Report of *5/16/1977* was found suitable/unmetretable.
0-0 On *Oxley Highway*. Sign, *Yarrowitch P.O. 0.5 km*
Travel east towards MAUCHOPE.
11-6 Past *Jenview Rd* on left.
12-3 Turn left onto track.
12-85 Rushbrook (P).

2ND ALL WEATHER ACCESS.

This section to be completed by officer constructing pillar.

Original station mark found/not found.

Description of mark:

Original beacon found/not found.

Description of beacon:

Height Top of Vanes to Top Mark.....m.

Height of mark.....m. above rock/conc.....m. below G.L.

Diameter of Vanes.....m. Height of Cairn.....m.

Original Beacon has/has not been destroyed by me.

Date

Record of Station