

CENTRAL MAPPING AUTHORITY
Department of Lands

Trigonometrical Survey of N.S.W.

RECONNAISSANCE and MAINTENANCE REPORT

STATION *MORRISBURIA* TS *6152*

7-4-88

This Trig. Station has been:-

Note: Cross out word or words which do not apply

- 1. Completely cleared to permit 360° vision to surrounding Trig.
- 2. Cleared by lances bearing *210° & 160°* from Trig. Mast
- 3. Trig. Mast & Vanes have been painted white & black respectively. *NOT PAINTED*
- 4. The Trig. was unpiled/not unpiled, dimensions now being: *Original Station Mark*

Description of mark..... should be explicit, e.g. Steel plug, Brass plug, Bolt, G.I. Pipe
 Height of mark..... m above rock/concrete m below G.L.
 Height of Top Vanes to Top Mark..... m. Diameter of Vanes (vertical) *1.01* m.
 Height of Cairn..... m. Diameter of Cairn *2.5* m.

- Length of Mast *1.48* m. (approximate if not unpiled)
- 5. A. *SSM* set in conc/rock has been *FOUND* m. bearing *278* °M from Trig. Mast
- 6. A. *G.I.P.* set in conc/soil has been *FOUND* m. bearing *196* °M from Trig. Mast
- 7. A. set in conc/soil has been placed m. bearing °M from Trig. Mast
- 8. A. set in conc/rock has been placed m. bearing °M from Trig. Mast
- 9. Connection: *SSM* to *G.I.P.* : *3.04* m. bearing *152* °M
- 10. Connection: to m. bearing °M
- 11. Connection: to m. bearing °M
- 12. Connection: to m. bearing °M

- 13. Diff. Ht. is..... m. above below
- 14. Diff. Ht. is..... m. above below
- 15. Diff. Ht. is..... m. above below
- 16. Diff. Ht. is..... m. above below

Prepared by: *P. CHEN* Checked: *P. CHEN* Noted on U.T.M. Card

Ce: _____ Ph: _____
 Map Sheet: *ELLERSTON* No: *9134 N*
 Inspected by: *P. CHEN* Date: *23/4/77*
 Authority: *C.M.A.* Field Book: *1565*

Beacon Diagram

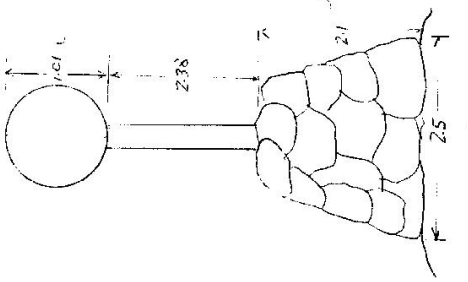

Date	Record of Station

Checked

TS 6152

GEODETIC SURVEY OF A.S.W.

CENTRAL MAPPING AUTHORITY

GEODETIC STATION RECONNAISSANCE and MAINTENANCE REPORT

STATION: WOMBAMURRA

No.: 4826

MAP SHEET: TAMMORTH
SCALE 1:250 000 SH 56-13

ISIS RIVER 9134-IV-S
Scale: 1:25000

INSPECTED BY: H.P. JACKSON

DATE: 8/2/1978

AUTHORITY: Geodetic Survey CMA

FIELD BOOK: 1627

- Description: *Note: Cross out word or words which do not apply*
- Cleared by lanes bearing 207°-213° M. Old Vanes now succeeded as follows: from Trip Mast 28°-37° M, 162°-178° M, 195°-209° M, 253°-260° M.
 - Mast & Vanes have been painted white & black respectively. Mast rotted out - Vanes in good order, painted Black Oxide.
 - The station/pillar was unplaced/not unplaced/constructed on February 8th 1978, dimensions now being: [] should be explicit, e.g., S/Steel Pillar Plate, Steel plug, Brass plug, Bolt, G.I. Pipe
- Description of mark: [] should be explicit, e.g., S/Steel Pillar Plate, Steel plug, Brass plug, Bolt, G.I. Pipe
- Height of mark: [] m. above/below rock/concrete; Mark is [] m. above/below G.L.
- Height of Top Vanes to Top Mark/Pillar plate [] m. Diameter of Vanes (vertical) [] m. 0.12 m. "WOMBAMURRA EAST" on Vanes! (Wrong!)
- Height of Cairn [] m. Diameter of Cairn [] m. Name Plate found/not found/placed.
- Length of Mast [] m. (approximate if not unplaced)
- A [] S.S.M. [] set in conc/teeek has been placed/found, bearing [] M from Mast/Plug/Pillar
 - A [] G.I. Pipe [] set in conc/teeek has been placed/found, bearing [] M from Mast/Plug/Pillar
 - A [] [] set in conc/rock has been placed/found, bearing [] M from Mast/Plug/Pillar
 - A [] [] set in conc/rock has been placed/found, bearing [] M from Mast/Plug/Pillar
- Clearing in immediate vicinity of Station for all-round vision estimated at 2 days.
- Action required: Construction of Concrete Observation Pillar near existing Station. Bottom of

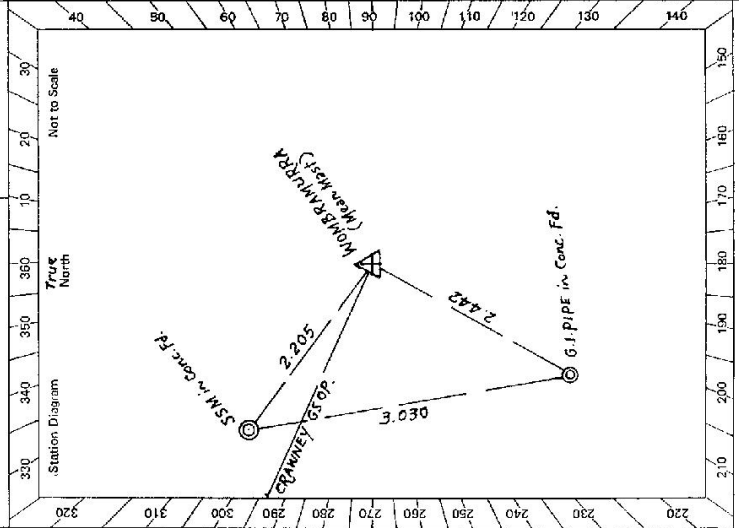

Mark	STANDPOINT: Tripod Offset from Station			STANDPOINT: Mean Mast (Calculated) Vanes			
	Direction	Horiz. Distance	Height Difference	Mark	Direction	Horiz. Distance	Height Difference
S.S.M. in Conc.	28°14'06"	9.741	1.364 above standpt.	S.S.M. in Conc.	306°30'20"	2.205	2.905 below standpt.
Mast (Bottom/Vanes)	40°28'23"	10.292	1.545 above standpt.	G.I. Pipe in Conc.	208°43'19"	2.442	2.798 below standpt.
G.I. Pipe in Conc.	44°04'28"	7.917	1.257 above standpt.	CRAWNEY GS OP	289°04'11"		above standpt.
CRAWNEY GS OP	289°06'34"		above standpt.				below
			below				below
			below				below
			below				below
			below				below

Prepared by: [Signature]

Checked: [Signature]

Noted on U.T.M. Card

STATION	WOMBRAMURRA TS 6152																																																																																																																																																																																																																																																																																																																																																																																													
<p style="font-size: small;">St 2738 - 2 D, West, Government Printer</p> <p>Beacon Diagram Not to Scale</p> <table border="1" style="width: 100%; height: 100%; border-collapse: collapse;"> <tr><td style="width: 10px;"> </td><td style="width: 10px;"> </td><td style="width: 10px;"> </td><td style="width: 10px;"> </td><td style="width: 10px;"> </td><td style="width: 10px;"> </td><td style="width: 10px;"> </td><td style="width: 10px;"> </td><td style="width: 10px;"> </td><td style="width: 10px;"> </td><td style="width: 10px;"> </td><td style="width: 10px;"> </td><td style="width: 10px;"> </td><td style="width: 10px;"> </td><td style="width: 10px;"> </td><td style="width: 10px;"> </td><td style="width: 10px;"> </td><td style="width: 10px;"> </td><td style="width: 10px;"> </td></tr> <!-- Additional empty rows for the grid --> <tr><td> </td><td> </td><td> </td><td> </td><td> </td><td> </td><td> </td><td> </td><td> </td><td> </td><td> </td><td> </td><td> </td><td> </td><td> </td><td> </td><td> </td><td> </td><td> </td><td> </td></tr> <tr><td> </td><td> </td><td> </td><td> </td><td> </td><td> </td><td> </td><td> </td><td> </td><td> </td><td> </td><td> </td><td> </td><td> </td><td> </td><td> </td><td> </td><td> </td><td> </td><td> </td></tr> <tr><td> </td><td> </td><td> </td><td> </td><td> </td><td> </td><td> </td><td> </td><td> </td><td> </td><td> </td><td> </td><td> </td><td> </td><td> </td><td> </td><td> </td><td> </td><td> </td><td> </td></tr> <tr><td> </td><td> </td><td> </td><td> </td><td> </td><td> </td><td> </td><td> </td><td> </td><td> </td><td> </td><td> </td><td> </td><td> </td><td> </td><td> </td><td> </td><td> </td><td> </td><td> </td></tr> <tr><td> </td><td> </td><td> </td><td> </td><td> </td><td> </td><td> </td><td> </td><td> </td><td> </td><td> </td><td> </td><td> </td><td> </td><td> </td><td> </td><td> </td><td> </td><td> </td><td> </td></tr> <tr><td> </td><td> </td><td> </td><td> </td><td> </td><td> </td><td> </td><td> </td><td> </td><td> </td><td> </td><td> </td><td> </td><td> </td><td> </td><td> </td><td> </td><td> </td><td> </td><td> </td></tr> <tr><td> </td><td> </td><td> </td><td> </td><td> </td><td> </td><td> </td><td> </td><td> </td><td> </td><td> </td><td> </td><td> </td><td> </td><td> </td><td> </td><td> </td><td> </td><td> </td><td> </td></tr> <tr><td> </td><td> </td><td> </td><td> </td><td> </td><td> </td><td> </td><td> </td><td> </td><td> </td><td> </td><td> </td><td> </td><td> </td><td> </td><td> </td><td> </td><td> </td><td> </td><td> </td></tr> <tr><td> </td><td> </td><td> </td><td> </td><td> </td><td> </td><td> </td><td> </td><td> </td><td> </td><td> </td><td> </td><td> </td><td> </td><td> </td><td> </td><td> </td><td> </td><td> </td><td> </td></tr> <tr><td> </td><td> </td><td> </td><td> </td><td> </td><td> </td><td> </td><td> </td><td> </td><td> </td><td> </td><td> </td><td> </td><td> </td><td> </td><td> </td><td> </td><td> </td><td> </td><td> </td></tr> <tr><td> </td><td> </td><td> </td><td> </td><td> </td><td> </td><td> </td><td> </td><td> </td><td> </td><td> </td><td> </td><td> </td><td> </td><td> </td><td> </td><td> </td><td> </td><td> </td><td> </td></tr> <tr><td> </td><td> </td><td> </td><td> </td><td> </td><td> </td><td> </td><td> </td><td> </td><td> </td><td> </td><td> </td><td> </td><td> </td><td> </td><td> </td><td> </td><td> </td><td> </td><td> </td></tr> <tr><td> </td><td> </td><td> </td><td> </td><td> </td><td> </td><td> </td><td> </td><td> </td><td> </td><td> </td><td> </td><td> </td><td> </td><td> </td><td> </td><td> </td><td> </td><td> </td><td> </td></tr> <tr><td> </td><td> </td><td> </td><td> </td><td> </td><td> </td><td> </td><td> </td><td> </td><td> </td><td> </td><td> </td><td> </td><td> </td><td> </td><td> </td><td> </td><td> </td><td> </td><td> </td></tr> <tr><td> </td><td> </td><td> </td><td> </td><td> </td><td> </td><td> </td><td> </td><td> </td><td> </td><td> </td><td> </td><td> </td><td> </td><td> </td><td> </td><td> </td><td> </td><td> </td><td> </td></tr> <tr><td> </td><td> </td><td> </td><td> </td><td> </td><td> </td><td> </td><td> </td><td> </td><td> </td><td> </td><td> </td><td> </td><td> </td><td> </td><td> </td><td> </td><td> </td><td> </td><td> </td></tr> <tr><td> </td><td> </td><td> </td><td> </td><td> </td><td> </td><td> </td><td> </td><td> </td><td> </td><td> </td><td> </td><td> </td><td> </td><td> </td><td> </td><td> </td><td> </td><td> </td><td> </td></tr> <tr><td> </td><td> </td><td> </td><td> </td><td> </td><td> </td><td> </td><td> </td><td> </td><td> </td><td> </td><td> </td><td> </td><td> </td><td> </td><td> </td><td> </td><td> </td><td> </td><td> </td></tr> </table>																																																																																																																																																																																																																																																																																																																																																																																												<p>Owner's Name:</p> <p>Address:</p> <p>Phone:</p>	<p>Current Occupant:</p> <p>Address:</p> <p>Phone:</p>	<p style="text-align: center;">ACCESS From NUNDELE (4 Wheel Drive)</p> <p>Access Report of <u>8.7.19</u>. was found suitable/(unsuitable).</p> <p>Kilometres: Feature:</p> <ul style="list-style-type: none"> 0.0 AT NUNDELE Post Office, head South along JENKINS Street at Signpost "CRAWNEY 18" 5.25 Turn Left off bitumen (just before Bridge over Peel River) at Signpost: "HEAD of PEEL RD. 18" and continue on this gravel road 14.4 / Cross Grid, and ford at 14.45km. 15.8 Cross Grid, and Ford at 16.5km. 16.7 Take Left Fork in gravel roads. 18.2 Cross Grid through Electric fence Gate with Sign "RIVER HEAD" 18.4 Through double Iron Gates with Woolshed on right, follow track ahead. 18.5 Cross Ford and pass through Electric fence Gate at 18.6km. 19.3 Cross wooden bridge. 19.4 Turn Right to go uphill at track intersection. 20.0 Through Iron Gate and follow winding track uphill (slippery when wet!) 22.6 Turn Right at Ridge top, passing double Iron Gates on your left which lead onto MORRISON'S GAP Road (about 32km. from NUNDELE via HANGING ROCK) and continue along gravel road along ridge. 24.9 Through Iron Gate "NYCOONA", veer Right along fence. 25.0 Turn Right through Iron Gate at fence intersection, and head uphill through ploughed ground and along left side of fence line. 25.65 Through Wire Gate at fence intersection following track along fence (WOMBRAMURRA EAST GS was in paddock to North of this fence angle/intersection.) 26.05 Through Iron Gate and follow track along left side of fence line. 26.3 Through Wire Gate, follow fence line around to right and stop vehicle at 26.4km. WOMBRAMURRA-65 is 40 metres North from here through fence (year be trait down!).
			<p>Date</p> <p style="text-align: right;">Record of Station</p>																																																																																																																																																																																																																																																																																																																																																																																											
			<p>This section to be completed by officer constructing pillar.</p> <p>Original station mark found/not found.</p> <p>Description of mark:</p> <p>Original beacon found/not found.</p> <p>Description of beacon:</p> <p>Height: Top of Vanes to Top Mark.....m.</p> <p>Height of mark.....m. <small>above</small> rock/conc.....m. <small>below</small> G.L.</p> <p>Diameter of Vanes.....m. Height of Cairn.....m.</p> <p>Original Beacon has/has not been destroyed by me.</p>																																																																																																																																																																																																																																																																																																																																																																																											

CENTRAL MAPPING AUTHORITY

GEODETIC SURVEY OF N.S.W.
 GEODETIC STATION RECONNAISSANCE and MAINTENANCE REPORT

Description:

1. Cleared by lanes bearing $175^{\circ} 27'$ to $211^{\circ} 27'$ from Trig. Mast

2. Mast & Vane have been painted white & black respectively.

3. The Mast/Vane was ~~replaced~~ constructed on $230 \times 230 \times 1976$ dimensions now being:

Description of marks: ~~None~~ should be explicit, e.g., S/Steel Pillar Plate, Steel plug, Brass plug, Bolt, G.I. Pipe

Height of mark: 1.763 m. above ~~lower~~ ~~concrete~~ concrete; Mark is 1.518 m. above G.L.

Height of Top Vane to Top Mark/Pillar plate:m. Diameter of Vane (vertical):m.

Height of Girth:m. Diameter of Girth:m. Name Plate ~~found~~/not found: ~~found~~

Length of Mast:m. (approximate if not unpled)

4. A. Brass Trig. Plug: set in conc/rock has been ~~found~~ found, bearing $61^{\circ} 00'$ from Mast/Plug/Pillar

5. A. S.S.M. set in conc/rock has been ~~found~~ found, bearing $40^{\circ} 00'$ from Mast/Plug/Pillar

6. A. G.I. Pipe set in conc/rock has been ~~found~~ found, bearing $81^{\circ} 00'$ from Mast/Plug/Pillar

7. A. set in conc/rock has been placed/found, bearing $0^{\circ} 00'$ from Mast/Plug/Pillar

8. Action required: ~~None~~ ~~to be~~ ~~concrete~~ Name Plate to be placed

STANDPOINT: Top Hill Top Vane

Mark	Direction	Horiz. Distance	Height Difference	Mark	Direction	Horiz. Distance	Height Difference
OBANNEY C&P	0 00 00		above standpt	OBANNEY C&P	0 00 00		above standpt
SUBANNEY CR	15 26 00		above standpt	S.S.M.	0 08 35	2 19 35	above standpt
S.S.M.	115 02 05	3 739	below standpt	SUBANNEY CR	15 26 05		below standpt
BRASS TRIG. PLUG	138 16 05	5 070	above standpt	BRASS TRIG. PLUG	279 01 15		above standpt
G.I. PIPE	164 21 05	3 504	below standpt	G.I. PIPE	279 01 15	2 070	below standpt
CONCRETE AS OF	279 01 26		above standpt	TOP SIGNET	318 10 00	5 068	below standpt

Prepared by: John 28-5-78 Checked: Noted on U.T.M. Cart

S. 2733-1

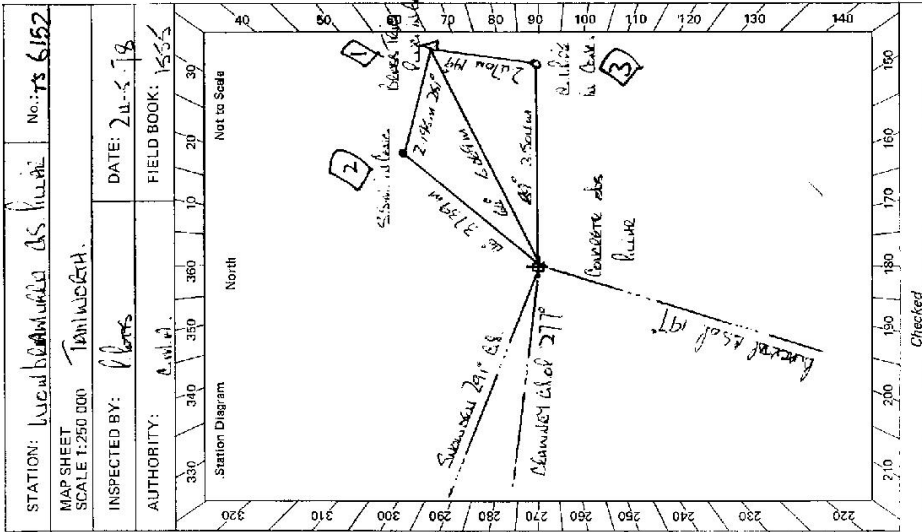

Checked

CENTRAL MAPPING AUTHORITY

GEODETIC SURVEY OF N.S.W.
 GEODETIC STATION RECONNAISSANCE and MAINTENANCE REPORT

Description: *Note: Cross out word or words which do not apply*

1. Cleared by lanes bearing..... from Trig. Mast

2. Mast & Vanes have been painted white & black respectively.

3. The station/pillar was unpiled/not unpiled/constructed on..... 19..... dimensions now being:

Description of mark..... should be explicit, e.g., S/Steel Pillar Plate, Steel plug, Brass plug, Bolt, G.I. Pipe

Height of mark..... m. ^{above} rock/concrete; Mark is..... m. ^{above} G.L., _{below}

Height of Top Vanes to Top Mark/Pillar plate..... m. Diameter of Vanes (vertical)..... m.

Height of Cairn..... m. Diameter of Cairn..... m. Name Plate found/not found/placed.

Length of Mast..... m. (approximate if not unpiled)

4. A..... set in conc./rock has been placed/found, bearing..... °M from Mast/Plug/Pillar

5. A..... set in conc./rock has been placed/found, bearing..... °M from Mast/Plug/Pillar

6. A..... set in conc./rock has been placed/found, bearing..... °M from Mast/Plug/Pillar

7. A..... set in conc./rock has been placed/found, bearing..... °M from Mast/Plug/Pillar

8. Action required:.....

STANDPOINT:		STANDPOINT:					
Mark	Direction	Horiz. Distance	Height Difference	Mark	Direction	Horiz. Distance	Height Difference
			above standpt				above standpt
			below				below
			above standpt				above standpt
			below				below
			above standpt				above standpt
			below				below
			above standpt				above standpt
			below				below
			above standpt				above standpt
			below				below
			above standpt				above standpt
			below				below

Prepared by: *[Signature]* Checked: *[Signature]* Noted on U.I.M. Card

St 2738-1

STATION: *Wombeyanville GA* No.: *TS 6152*
 MAP SHEET SCALE 1:250 000
 INSPECTED BY: *P. BATES* DATE: *9.6.78*
 AUTHORITY: *O.M.A.* FIELD BOOK: *1555*

Station Diagram

Not to Scale

Checked

GS 24

<p>STATION Nowlamuara 0502 TS 6152</p> <p>Owner's Name: MR LEAVE Address: SEE MANAGER Phone:</p> <p>Current Occupant: MR HANU LEAVE Address: MANAGER Phone: HEAD OF THE FEEL</p> <p>Access Report of 25/5/19 was found suitable/unsuitable. ACCESS</p>	<p>Beacon Diagram</p> <p style="text-align: right;">Not to Scale</p> <p>0.165 m</p> <p>0.140 m</p> <p>0.150 m</p> <p>MARK FOUND</p>
<p>This section to be completed by officer constructing pillar.</p> <p>Original station mark found/not found.</p> <p>Description of mark:</p> <p>Original beacon found/not found.</p> <p>Description of beacon:</p> <p>Height Top of Vanes to Top Markm.</p> <p>Height of mark:m. above G.L. above m. below G.L. below</p> <p>Diameter of Vanesm. Height of Cairnm.</p> <p>Original Beacon has/has not been destroyed by me.</p>	
	<p>Date</p> <p>Record of Station</p>

CENTRAL MAPPING AUTHORITY

GEODETTIC STATION RECONNAISSANCE and MAINTENANCE REPORT

STATION: *W. 1000* No.: *6/52*

MAP SHEET SCALE: 1:250 000

INSPECTED BY: *[Signature]* DATE: *29.10*

AUTHORITY: *[Signature]* FIELD BOOK: *016511*

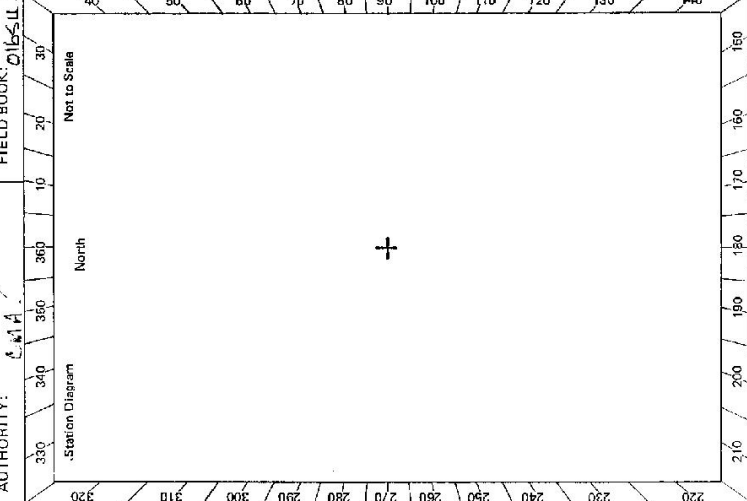

Description: *Note: Cross out word or words which do not apply*

1. Cleared by lanes bearing..... from Trig. Mast

2. Mast & Vanes have been painted white & black respectively.

3. The station/pillar was unpiled/not unpiled/constructed on..... 19....., dimensions now being:

Description of mark..... should be explicit, e.g., S/Steel Pillar Plate, Steel plug, Brass plug, Bolt, G.I. Pipe

Height of mark.....m, ^{above} rock/concrete; Mark is.....m, ^{above} G.L.

Height of Top Vanes to Top Mark/Pillar plate.....m. Diameter of Vanes (vertical).....m.

Height of Cairn.....m. Diameter of Cairn.....m. Name Plate ~~.....~~ /placed.

Length of Mast.....m. (approximate if not unpiled)

4. A..... set in conc/rock has been placed/found, bearing.....°M from Mast/Plug/Pillar

5. A..... set in conc/rock has been placed/found, bearing.....°M from Mast/Plug/Pillar

6. A..... set in conc/rock has been placed/found, bearing.....°M from Mast/Plug/Pillar

7. A..... set in conc/rock has been placed/found, bearing.....°M from Mast/Plug/Pillar

8. Action required.....

STANDPOINT:				STANDPOINT:			
Mark	Direction	Horiz. Distance	Height Difference	Mark	Direction	Horiz. Distance	Height Difference
			above standpt				above standpt
			below standpt				below standpt
			above standpt				above standpt
			below standpt				below standpt
			above standpt				above standpt
			below standpt				below standpt
			above standpt				above standpt
			below standpt				below standpt
			above standpt				above standpt
			below standpt				below standpt

Prepared by: *[Signature]* Checked: *[Signature]* 14/11/98

Noted on U.T.M. Card

G

STATION NAME: MANABAYURRA CR. INLET TS 6152

Owner's Name:
 Address:
 Phone:

Current Occupant:
 Address:
 Phone:

Access Report of/...../19..... was found suitable/unsuitable. ACCESS

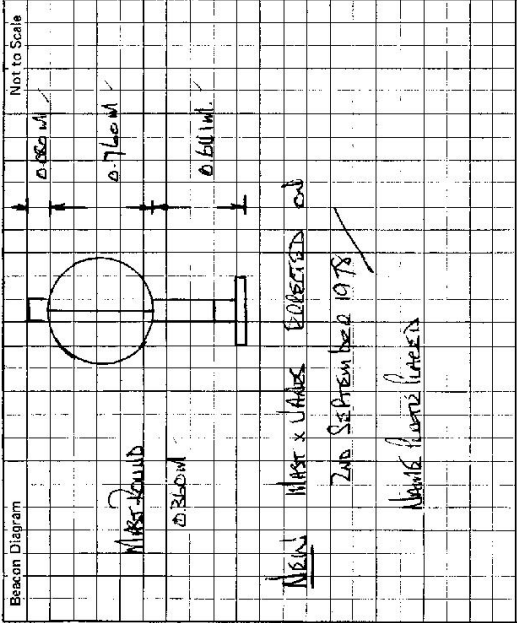

This section to be completed by officer constructing pillar.

Original station mark found/not found.

Description of mark:

Original beacon found/not found.

Description of beacon:

Height Top of Vans to Top Markm.

Height of markm. above rock/concm. below G.L.

Diameter of Vansm. Height of Cairnm.

Original Beacon has/has not been destroyed by me.

Date	Record of Station

CENTRAL MAPPING AUTHORITY

GEODETIC SURVEY OF N.S.W.

GEODETIC STATION RECONNAISSANCE and MAINTENANCE REPORT

- Description: *Note: Cross out word or words which do not apply*
- Cleared by lanes bearing..... from Trig. Mast
 - Mast & Vanes have been painted white & black respectively.
 - The ~~station~~/pillar was unpiled/~~rest-removed~~/concreted on..... 19.78..... dimensions now being: Concrete Observation
Description of mark..... ~~Pillar~~..... ~~should be explicitly~~..... ~~S/Steel Pillar Plate~~..... ~~Steel plug~~..... ~~Brass plug~~..... ~~Dot~~..... ~~C.I. Pipe~~
Height of mark..... 1.355 m. above rock/concrete; Mark is 1.5..... m. above G.L.
Height of Top Vanes to Top ~~Mast~~/Pillar plate..... 1.394..... m. Diameter of Vanes (vertical)..... 0.752..... m.
Height of Cairn..... m. Diameter of Cairn..... m. Name Plate found/~~rest-removed~~/~~placed~~.
Length of Mast..... m. (approximate if not unpiled) Pillar Spiggot is 16 mm above Plate
4. A. Brass PLUG..... set in conc/~~rock~~ has been ~~placed~~/found, bearing..... 56° M from ~~Mast/Plug~~/Pillar
5. A. S.S.M. set in conc/~~rock~~ has been ~~placed~~/found, bearing..... 33° M from ~~Mast/Plug~~/Pillar
6. A. G. I. PIPE set in conc/~~rock~~ has been ~~placed~~/found, bearing..... 83° M from ~~Mast/Plug~~/Pillar
7. A. DUMPY set in ~~soil~~/~~rock~~ has been placed/~~found~~, bearing..... 170° M from ~~Mast/Plug~~/Pillar
8. Action required:.....

STANDPOINT: S/Steel Spiggot & Plate				STANDPOINT: Brass PLUG found in Conc.			
Mark	Direction	Horiz. Distance	Height Difference	Mark	Direction	Horiz. Distance	Height Difference
Brass PLUG fd	67° 17' 21"	5.069	1.400 above standpt.	PILLAR Spiggot	247° 17' 32"	5.070	1.400 above standpt.
S.S.M. fd	44° 09' 01"	3.736	1.435 above standpt.	S.S.M. fd	289° 15' 00"	2.196	0.035 below standpt.
G.I. PIPE fd	93° 31' 03"	3.502	1.326 above standpt.	G.I. PIPE fd	208° 26' 54"	2.472	0.070 above standpt.
CRAWNEY GS OP	289° 07' 22"		above standpt.	CRAWNEY GS OP	289° 06' 31"		above standpt.
YEEROMIN TOWER	19° 28' 53.5"		above standpt.	YEEROMIN TOWER	19° 28' 23"		above standpt.
Satellite DUMPY	181° 09' 25"	65.126	3.142 above standpt.	LOOMBERAH GS	342° 52' 43"		above standpt.
KOOGAH GS OP	210° 35' 18"		above standpt.				above standpt.

Prepared by: *[Signature]* 20/3/79
 Checked: *[Signature]*
 Note on U.T.M. Grid

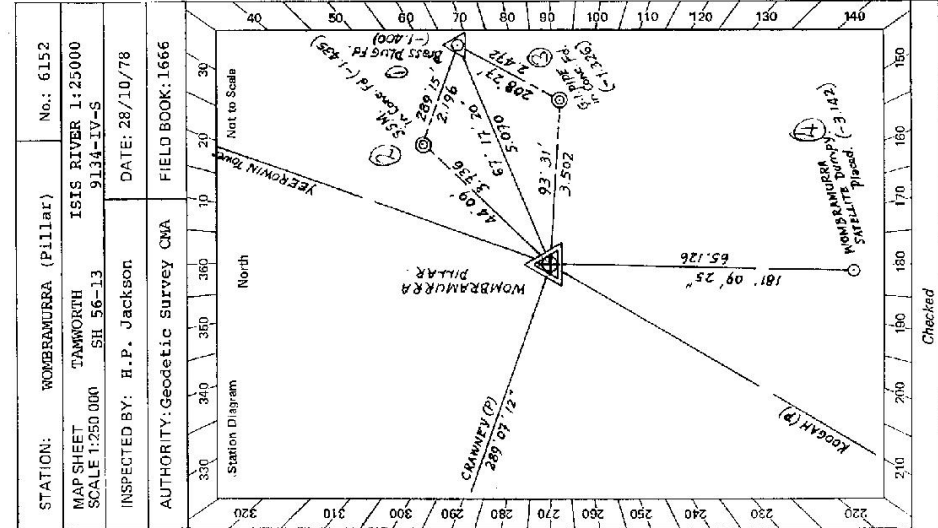

STATION: WOMBAMURRA (Pillar) No.: 6152
 MAP SHEET TAMWORTH ISIS RIVER 1:25000
 SCALE 1:250 000 SH 56-13
 INSPECTED BY: H.P. Jackson DATE: 28/10/78
 AUTHORITY: Geodetic Survey OMA FIELD BOOK: 1666

St 2735-2 D. West, Government Printer

STATION WOMBAMURRA (Pillar) No.: 6152

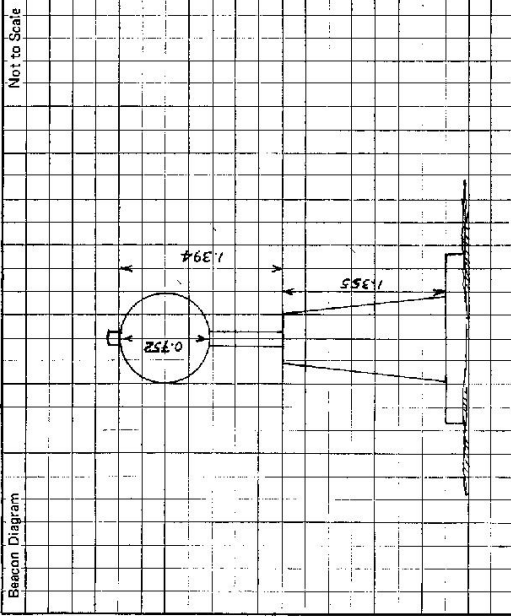

Owner's Name:
 Address:
 Phone:
 Current Occupant:
 Address:
 Phone:

ACCESS 28/10/1978

Kilometres: Feature:

- 0.0 At NUNDELE Post Office, head South along JENKINS Street at Signpost "CRAWLEY 18"
- 5.25 Turn Left off bitumen (just before Bridge over Peel River) at Signpost: "HEAD of PEEL RD. 18" and continue on this gravel road
- 14.4 Cross Grid, and Ford at 14.45km.
- 15.8 Cross Grid, and Ford at 16.5km.
- 16.7 Take Left Fork in gravel roads.
- 18.2 Cross Grid through Electric fence Gate with Sign "RIVER HEAD"
- 18.4 Through double Iron Gates with Woolshed on right, follow track ahead.
- 18.5 Cross Ford and pass through Electric fence Gate at 18.6km.
- 19.3 Cross wooden bridge.
- 19.4 Turn Right to go uphill at track intersection.
- 20.0 Through Iron Gate and follow winding track uphill (slippery when wet!)
- 22.6 Turn Right at Ridge top, passing double Iron Gates on your left which lead onto MORRISON'S GAP Road (about 32km. from NUNDELE via HANGING ROCK) and continue along gravel road along ridge.
- 24.9 Through Iron Gate "NYCOOMA", veer Right along fence.
- 25.0 Turn Right through Iron Gate at fence Intersection, and head uphill through ploughed ground and along left side of fence line.
- 25.65 Through Wire Gate at fence Intersection following track along fence (WOMBAMURRA EAST GS was in paddock to North of this fence angle/intersection.)
- 26.05 Through Iron Gate and follow track along left side of fence line.
- 26.3 Through Wire Gate, follow fence line around to right and stop vehicle at 26.4km. WOMBAMURRA 66-19-46 metres North from here through fence (can be hard down!).

This section to be completed by officer constructing pillar.

Original station mark found/not found.

Description of mark:

Original beacon found/not found.

Description of beacon:

Height Top of Vanes to Top Mark.....m.

Height of mark.....m. above G.L. below rock/conc.....m.

Diameter of Vanesm. Height of Cairnm.

Original Beacon has/has not been destroyed by me.

Date

Record of Station