

GEODETTIC SURVEY OF M.S.W

CENTRAL MAPPING AUTHORITY

GEODETTIC STATION RECONNAISSANCE and MAINTENANCE REPORT

Description:

Note: Cross out word or words which do not apply

1. Cleared by lanes bearing  $23^{\circ}14'43.7''M$ ,  $110^{\circ}04'14.0''M$ ,  $183^{\circ}04'15.5''M$  from Trig. Mast  
Mast & Vanes have been painted white & black respectively. ✓
2. Mast & Vanes have been painted white & black respectively. ✓
3. The section/pillar was ~~unplaced~~ constructed on  $5111$   $19.18$  dimensions now being:  
Description of mark  $Steel$   $19.18$  should be explicit, e.g. S/Steel Pillar Plate, Steel plug, Brass plug, Bolt, G.I. Pipe  
Height of mark  $1.40$  m. above ~~rock~~ <sup>above</sup> concrete; Mark is  $1.40$  m. above G.L.  
Height of Top Vanes to Top ~~Mark~~ <sup>above</sup> Pillar plate  $7.55$  m. Diameter of Vanes (vertical)  $7.55$  m.  
Height of Cairn  $0.00$  m. Diameter of Cairn  $0.00$  m. Name Plate found/not found/placed.  
Length of Mast  $0.00$  m. (approximate if not unplaced)
4. ~~Concrete~~ <sup>Concrete</sup> set in conc/rock has been placed/found, bearing  $266^{\circ}01'10.4339''M$  from ~~Mast/Plug~~ <sup>Mast/Plug</sup> Pillar
5. A. ~~Concrete~~ <sup>Concrete</sup> set in conc/rock has been placed/found, bearing  $266^{\circ}01'10.4339''M$  from ~~Mast/Plug~~ <sup>Mast/Plug</sup> Pillar
6. A. ~~Concrete~~ <sup>Concrete</sup> set in conc/rock has been placed/found, bearing  $266^{\circ}01'10.4339''M$  from Mast/Plug/Pillar
7. A. ~~Concrete~~ <sup>Concrete</sup> set in conc/rock has been placed/found, bearing  $266^{\circ}01'10.4339''M$  from Mast/Plug/Pillar
8. Action required: ~~None~~

STANDPOINT: Pillar Plate		STANDPOINT: Concrete Trig. Plate				
Mark	Direction	Horiz. Distance	Height Difference	Direction	Horiz. Distance	Height Difference
Vertical Pillar	0 00 00		above standpt.	Vertical Pillar	0 00 00	above standpt.
Cairn Mark	24 25 26	51.57	below standpt.	Concrete Trig. Tower	60 10 40	below standpt.
Concrete Trig. Tower	60 10 40	4.339	above standpt.	Pillar	266 01 10.4339	above standpt.
Concrete Trig. Plate	60 10 40	4.340	below standpt.	Concrete Trig. Tower	266 01 10.4339	above standpt.
Cairn Cross Trig. Tower	166 24 40		above standpt.	Cairn Mark	266 01 10.4339	below standpt.
			below			below

Prepared by: \_\_\_\_\_

Checked: \_\_\_\_\_

Noted on U.T.M. Grid

ST 2733-1

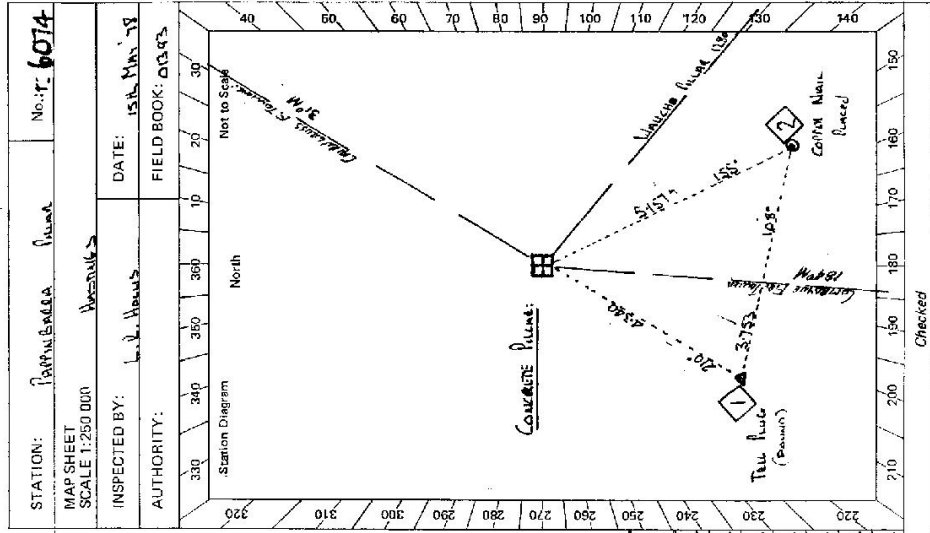

Checked

No. 6074

MAP SHEET SCALE 1:250 000

INSPECTED BY: L.V. Hous

DATE: 15th May '78

AUTHORITY: FIELD BOOK: 01393

GS

STATION **PARU BAKA** QUANT: **TS 6074**

Owner's Name: **Jah. Rasyane**  
 Current Occupant: **Jah. Rasyane**  
 Address: .....  
 Phone: .....  
 Phone: **13-5-1978**

ACCESS **13-5-1978**

Access Report of 15./5./1978, was found suitable/unsuitable.  
 Recommendation P.O. Tawaruk towards Kluang.  
 Turn Left Side Belaukay Side Front, thence Run Westward  
 Turn Left AT L.H. Curve  
 Turn Left  
 Killie Gate  
 Killie Gate  
 Past Trench to house on R.H.S.  
 Turn Left and over bridge.  
 Check Cassava  
 Past Trench on Right H.S.  
 Check Cassava  
 Turn Left  
 Turn Left  
 Killie Gate  
 Killie Gate  
 Geodetic Station 1

114  
 0600  
 070  
 700  
 850  
 920  
 970  
 1000  
 1070  
 1110  
 1115  
 1150  
 1180  
 1220  
 1240  
 1305

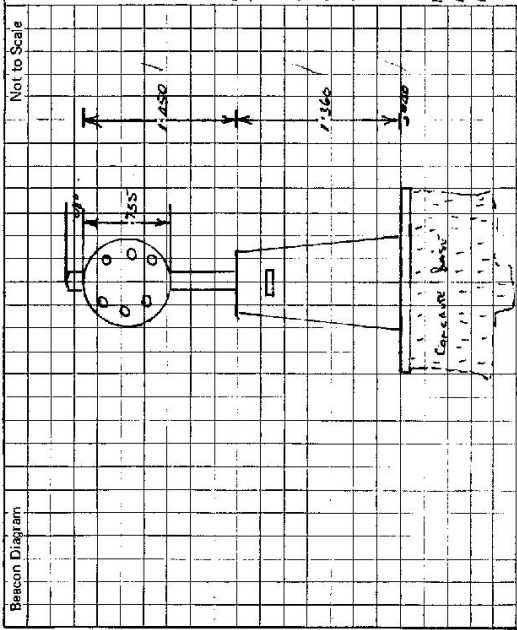

This section to be completed by officer constructing pillar.

Original station mark found/~~not found~~.

Description of mark: **Beacon**

Original beacon found/~~not found~~.

Description of beacon: **Cement Pole h. 1.455m**

Height Top of Vanes to Top Mark: **3.77** m.

Height of mark: **0.05** above rock/~~above~~ **0.55** below G.L.

Diameter of Vanes: **0.05** m. Height of Centre **1.200** m.

Original Beacon has ~~been~~ been destroyed by me.

Date	Record of Station