

CENTRAL MAPPING AUTHORITY
Department of Lands

Trigonometrical Survey of N.S.W.

RECONNAISSANCE and MAINTENANCE REPORT

STATION **MERINDA TS 6061**

Co: **WELLINGTON** Ph: **Merinda**
Map Sheet: **DUBBO 1:250 000** No. **S155-4**
Inspected by: **H.P. Jackson** Date: **7/1/1975**
Authority: **Trig Survey Division** Field Book: **AB1428**
Beacon Diagram Not to Scale

Note: Cross out word or words which do not apply

1. Completely cleared to permit 360° vision to surrounding Trig.
2. Cleared by lanes bearing 14° 18' M, 40° 95' M, 120° 330' M from Trig. Mast
3. Trig. Mast & Vanes have been painted white & black respectively.
4. The Trig. was unipiled dimensions now being:
Description of mark: **Brass Plug in Rock Found** should be explicit, e.g. Steel plug, Brass plug, Bolt, G.I. Pipe
Height of mark: **0.045** m above rock **0.045** m above G.L.
Height of Top Vanes to Top Mark: **3.635** m. Diameter of Vanes (vertical) **1.210** m.
Height of Cairn: **1.300** m. Diameter of Cairn: **2.300** m.
Length of Mast: **3.600** m. (approximate if not unipiled)
5. AN...S.S.M. set in conc has been found **1.964** m. bearing **128** °M from Trig. Mast
6. A set in conc/soil has been placed **0** m. bearing **0** °M from Trig. Mast
7. A set in conc/soil has been placed **0** m. bearing **0** °M from Trig. Mast
8. A set in conc/rock has been placed **0** m. bearing **0** °M from Trig. Mast

9. Connection to **0** m. bearing **0** °M
10. Connection to **0** m. bearing **0** °M
11. Connection to **0** m. bearing **0** °M
12. Connection to **0** m. bearing **0** °M
13. Diff. Ht. S.S.M. in Conc is **0.148** m. above Trig. Plug
14. Diff. Ht. is **0** m. above
15. Diff. Ht. is **0** m. above
16. Diff. Ht. is **0** m. above

Prepared by *[Signature]* Checked: *[Signature]*

Noted on U.T.M. Card

Cl. ed

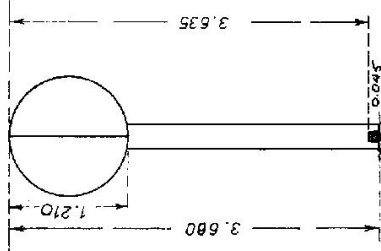

Date: 1975
Record of Station: 25/1 Unipiled
27-10-77 TRIG UNIPILED - FOR HORIZONTAL ANGLES. MAST & VANES IN GOOD CONDITION. TRIG REPILED. ABOVE MEASUREMENTS CONFIRMED FOR MAST & VANES.

STATION MERINDA TS 6061

Owners Name... P. ELYAN Current Occupant.....

Address... CALOOLA Address.....

Via Upper Pinnacles (27-10-77)

Access 7-1-1975
Possible with ordinary 2 wheel drive vehicle

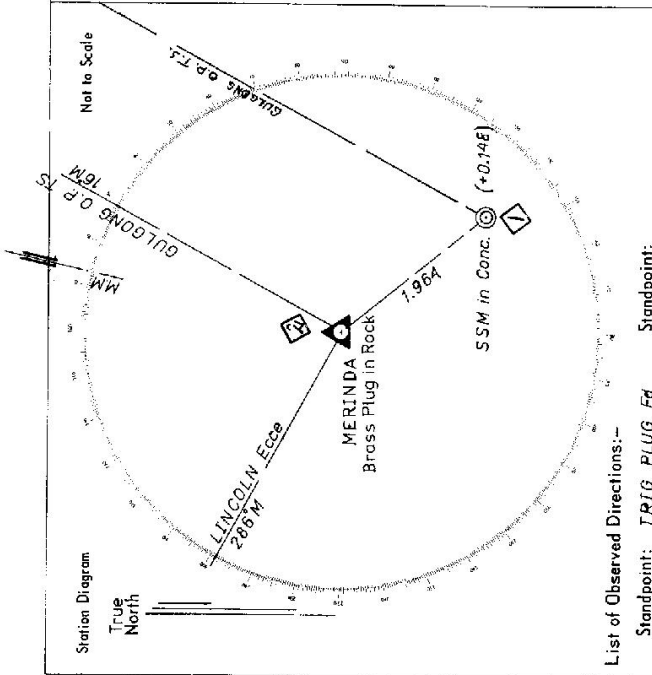

List of Observed Directions:-

Standpoint: TRIG PLUG Fd		Standpoint:	
Station	Direction	Station	Direction
GULGONG PILLAR	359°59'60"		
SSM in Conc. Fd	112°23'		
AT TRIG PLUG Fd Sector			
LINCOLN Edge G.Pipe	359°59'60.0		
GULGONG PILLAR TS	89°54'57.6		

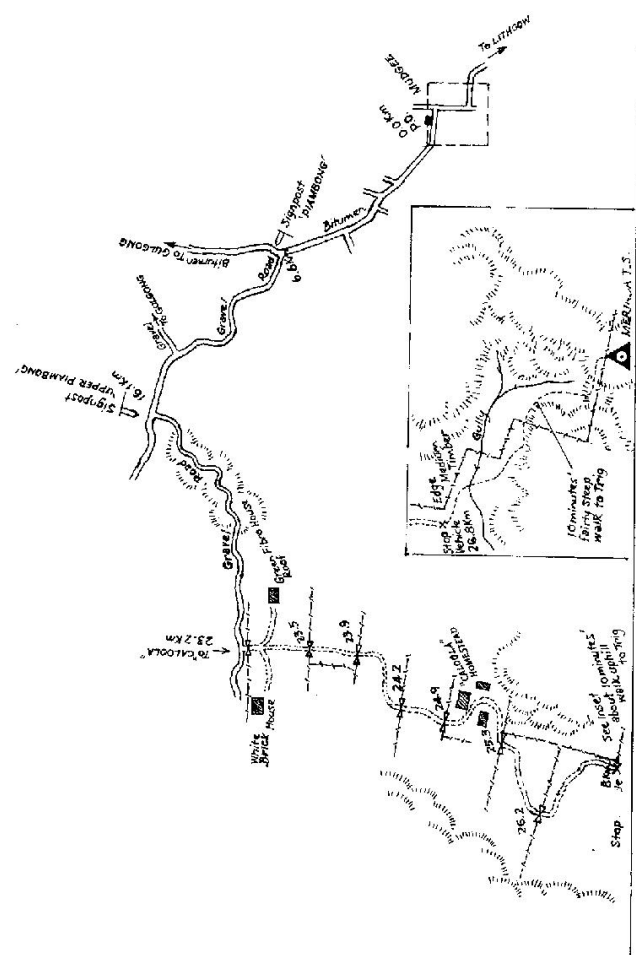

CENTRAL MAPPING AUTHORITY
Department of Lands

Trigonometric survey of N.S.W.

RECONNAISSANCE and MAINTENANCE REPORT 3064 STATION MERINDA TS 6061

This Trig. Station has been:-

Note: Cross out word or words which do not apply

1. Completely cleared to permit 360° vision to surrounding Trigs.
2. Cleared by lanes bearing 20° 57' to 360° from Trig. Mast
3. Trig. Mast & Vanes have been painted white & black respectively.
4. The Trig. was unpiled/~~re-constructed~~, dimensions now being:
Description of mark... BRASS PLUG... should be explicit, e.g. Steel plug, Brass plug, Ball, G.I. Pipe
Height of mark... 0.05 m above ~~level~~ concrete... m above below G.L.
Height of Top Vanes to Top Mark... 3.63 m. Diameter of Vanes (vertical)... 1.2 m.
Height of Cairn... 1.0 m. Diameter of Cairn... 1.7 m.

5. A... SSM... set in conc./soil has been placed... 1.978 m. bearing... 141° 0M from Trig. Mast
found
6. A... set in conc./soil has been placed... m. bearing... 0M from Trig. Mast
7. A... set in conc./soil has been placed... m. bearing... 0M from Trig. Mast
8. A... set in conc./rock has been placed... m. bearing... 0M from Trig. Mast
9. Connection... to... m. bearing... 0M
10. Connection... to... m. bearing... 0M
11. Connection... to... m. bearing... 0M
12. Connection... to... m. bearing... 0M
13. Diff. Ht. ... SSM is 15 m. above Trig. plug
~~below~~
14. Diff. Ht. ... is ... m. above below
15. Diff. Ht. ... is ... m. above below
16. Diff. Ht. ... is ... m. above below

Prepared by: C. STARLEY

Checked: F. SUTHERLAND

Noted on U.T.M. Card

Checked

Map Sheet: No. 3468

Inspected by: C.W. STARLEY

Authority: DEPT LANDS

Date: 21/5/75
Field Book: C.S. 250

Beacon Diagram Not to Scale

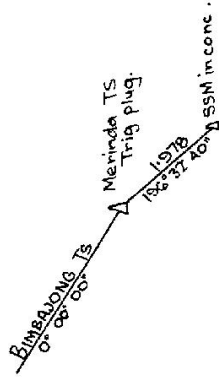
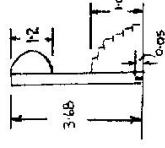

Date Record of Station

St. 2733-2 D. West, Government Printer

Beacon Diagram

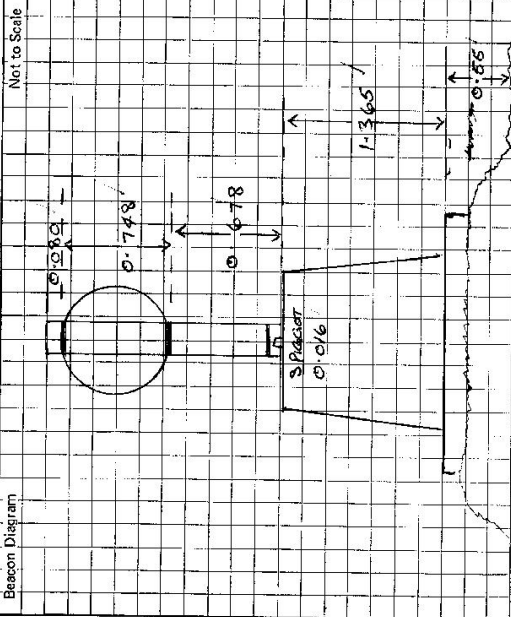

This section to be completed by officer constructing pillar.

Original station mark found/~~not found~~.

Description of mark: BRASS PLATE

Original beacon found/~~not found~~.

Description of beacon: CROWN MAINT. VANES

Height Top of Vanes to Top Mark: 3.625 m.

Height of mark 0.45 m. above G.L. 0.23 m. below rock/stone

Diameter of Vanes: 1.205 m.

Original Beacon has/~~has not~~ been destroyed by me. Height of Cairn: 0.0 m.

STATION MERINDA (PILLAR) TS 6061

Owner's Name:
 Address:
 Phone:

Current Occupant:
 Address:
 Phone:

ACCESS

Access Report of 17.3.1988 was found suitable/unsuitable.

- 0.0 MUDGEE POST OFFICE TAKE ROAD TOWARDS GULCONG.
- 6.6 TURN LEFT ONTO GRAVEL ROAD SIGN PIAMBONG.
- 16.1 TURN LEFT AT SIGNPOST UPPER PIAMBONG.
- 23.2 TURN LEFT THROUGH GATE. FOLLOW CENTRE TRACK.
- 23.5 THROUGH GATE.
- 23.9 THROUGH GATE.
- 24.2 THROUGH DOUBLE GATE.
- 24.8 TURN LEFT OF TRACK JUST BEFORE "CALCULA" HOME SIGN DRIVE ACROSS Paddock TO OPENING IN FENCE TURN RIGHT TO IRON GATE.
- 25.3 THROUGH IRON GATE, HEAD ACROSS Paddock TO WIRE GATE TOP CORNER OF FENCE.
- 25.6 WIRE GATE, TURN RIGHT DOWN HILL & PASS SMALL DAM.
- 29.9 WIRE GATE IN SADDLE GO THROUGH & FOLLOW FAINT TRACK.
- 26.3 VEER LEFT FAINT TRACK.
- 26.4 START OF CLIMB. FOLLOW THIS TRACK TO T.S.
- 27.5 FENCE.
- 27.4 T.S.

Date

Record of Station

GEODETIC SURVEY OF N.S.W.

CENTRAL MAPPING AUTHORITY

GEODETIC STATION RECONNAISSANCE and MAINTENANCE REPORT

Description:

- Note: Cross out word or words which do not apply
1. Cleared by lanes bearing 360° Brass Plate 1.570 m from Trig. Mast
 2.4 m 4.12 m 48 m to 110 m
 2. Mast & Vanes have been painted white & black, respectively. ✓
 $5/5$ like base
 3. The station/pillar was ~~replaced~~ ~~re-erected~~ ~~re-constructed~~ on 6 December 1981, dimensions now being:
 Description of mark: S/Steel Pillar Plate, Steel plug, Brass plug, Bolt, G.I. Pipe
 Height of mark: 1.36 m above ~~base~~ concrete; Mark is 1.570 m above G.L.
 Height of Top Vanes to Top Mark/Pillar plate: 1.425 m. Diameter of Vanes (vertical): 0.265 m.
 Height of Cairn:m. Diameter of Cairn:m. Name Plate found/~~not found~~/placed.
 Length of Mast:m. (approximate if not unpled)
4. A.....set in conc/rock has been placed/found, bearing.....°M from Mast/Plug/Pillar
 5. A.....set in conc/rock has been placed/found, bearing.....°M from Mast/Plug/Pillar
 6. A.....set in conc/rock has been placed/found, bearing.....°M from Mast/Plug/Pillar
 7. A.....set in conc/rock has been placed/found, bearing.....°M from Mast/Plug/Pillar
 8. Action required:.....

STANDPOINT:

Mark	Direction	Horiz. Distance	Height Difference	Mark	Direction	Horiz. Distance	Height Difference
			above standpt.				above standpt.
			below standpt.				below standpt.
			above standpt.				above standpt.
			below standpt.				below standpt.
			above standpt.				above standpt.
			below standpt.				below standpt.
			above standpt.				above standpt.
			below standpt.				below standpt.
			above standpt.				above standpt.
			below standpt.				below standpt.

Prepared by: P. Berts 25/ December 1981. Checked: Noted on U.T.M. Card

St 2733-1

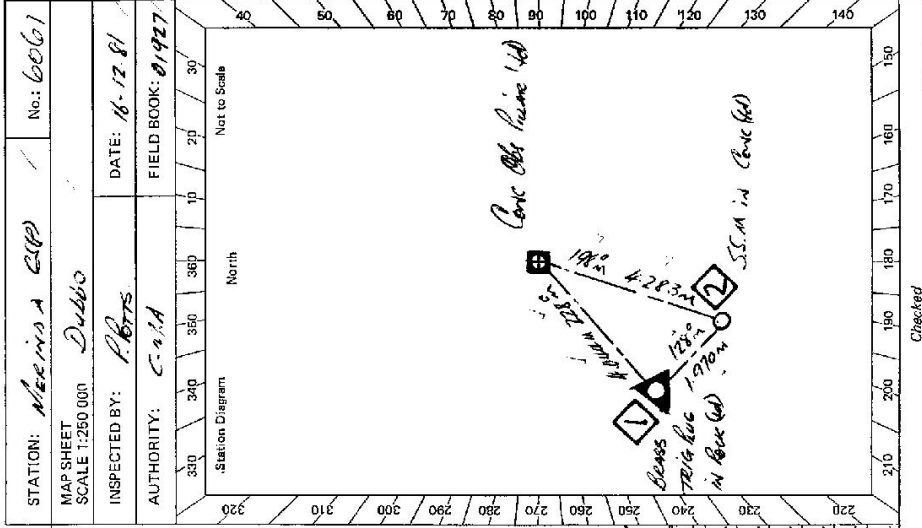

Checked

STATION: *Meeinda Gap* No.: *6061*

MAP SHEET SCALE 1:250 000

INSPECTED BY: *P. Berts* DATE: *18-12-81*

AUTHORITY: *C.M.A.* FIELD BOOK: *019227*

5: 2733-2 D, West, Government Printer

STATION MEKINDA (S.P) IS 6061

Owner's Name: Mr P Flynn Current Occupant:
 Address: CHAROLA Address:
 Phone: Via Upper Painbong Phone:

ACCESS

Access Report of 16/12/1981 was found suitable/unsuitable.

K.M. FEATURE
 200 MET OFFICE MOUGE HEAD TOWARDS BUILDING
 600 TURN LEFT ONB GEORGE ROAD SIGN PAINBONG
 1176 PASS ROAD ON LEFT "FRIDGORE LANE"
 1309 PASS ROAD ON RIGHT "LESTERS LANE"
 1554 TURN LEFT SIGN UPPER PAINBONG
 2209 TURN LEFT SIGN "CALOLA" STRAIGHT AHEAD
 2240 100M GATE
 2278 100M GATE
 2310 VEER LEFT THROUGH DOUBLE 100M GATES
 2382 DOUBLE 100M GATES
 2386 "CALOLA" NAME SHEAD ON LEFT
 2393 TURN LEFT ONB MAIN TRACK - SHED ON RIGHT
 2406 TAKE RIGHT TRACK
 2415 100M GATE - VEER RIGHT & CROSS BRIDCK AT 45° ANGLE TO
 TOP CORNER
 2424 GULLY CROSSING
 2450 100M GATE - VEER RIGHT AT 45° & MAKE WAY TOWARDS GULLY
 2466 PASS DAM ON RIGHT - MAKE OWN TRACK AROUND SPUR
 2477 WIDE GATE - FOLLOW TRACK ALONG GULLY
 2506 AT INTERSECTION AT GULLYS - TAKE CENTRE RIDGE - AUNT
 TRACK - FOLLOW TO 416

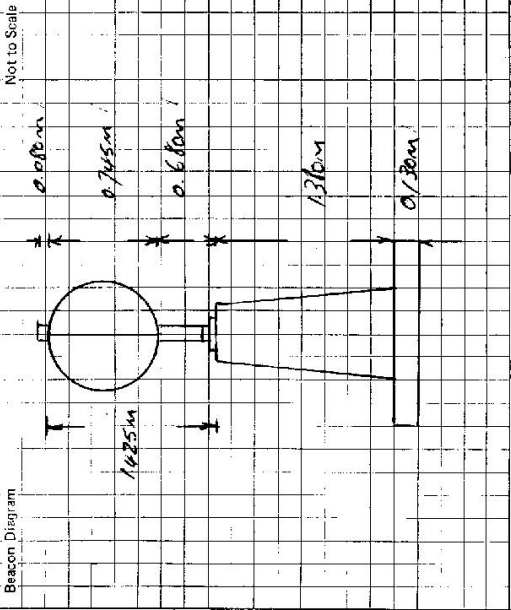

This section to be completed by officer constructing pillar.

Original station mark found/not found.

Description of mark:

Original beacon found/not found.

Description of beacon:

Height Top of Vane to Top Mark:m.

Height of mark:m. above G.L. below

Diameter of Vane:m. Height of Cairn:m.

Original Beacon has/has not been destroyed by me.

2616 At fence 25 metres to 416 ✓