

CENTRAL MAPPING AUTHORITY  
Department of Lands

Trigonometrical Survey of N.S.W.

RECONNAISSANCE and MAINTENANCE REPORT

This Trig. Station has been:-

1. Completely cleared to permit 360° vision to surrounding Trigs.
2. Cleared by lanes bearing..... from Trig. Mast
3. Trig. Mast & Vanes have been painted white & black respectively.
4. The Trig. was unpiled/~~rest-applied~~, dimensions now being: ~~Original Station Mark found~~.....

Description of mark: **CONCRETE OBSERVING PILLAR**... should be explicitly, e.g. Steel plug, Brass plug, Bury, Oil Pipe  
 Height of mark..... m <sup>above</sup> rock/concrete <sub>below</sub> G.L.  
 Height of Top Vanes to Top Mark: **1.45** m. Diameter of Vanes (vertical) **0.600** m.  
 Height of Cairn..... m. Diameter of Cairn..... m.

Length of Mast..... m. (approximate if not unpiled)

5. **BRONZE TRIG PLUG** set in conc/soil has been placed **4.538** m. bearing **99**°M from Trig. Mast **PILLAR**
6. **COPPER NAIL** set in conc/soil has been placed **4.310** m. bearing **115**°M from Trig. Mast **PILLAR**
7. A..... set in conc/soil has been placed..... m. bearing.....°M from Trig. Mast
8. A..... set in conc/rock has been placed..... m. bearing.....°M from Trig. Mast
9. Connection **BRONZE PILLAR COPPER NAIL**: **6.154** m. bearing **734**°M
10. Connection..... to..... m. bearing.....°M
11. Connection..... to..... m. bearing.....°M
12. Connection..... to..... m. bearing.....°M
13. Diff. Ht. **BRONZE TRIG. PLUG** is **1.430** m. <sup>above</sup> **PILLAR PLATE** <sub>below</sub>
14. Diff. Ht. **COPPER NAIL** is **1.600** m. <sup>above</sup> **PILLAR PLATE** <sub>below</sub>
15. Diff. Ht. is..... m. <sup>above</sup> <sub>below</sub>
16. Diff. Ht. is..... m. <sup>above</sup> <sub>below</sub>

Prepared by: *R.A. Williams* Checked: *CP* Noted on U.T.M. Card

STATION: **WHEEL OF FORTUNE (P) T.S. 6040**  
 Co: **CLARENDON** Ph: **DURA**  
 Map Sheet: **TARCUITA** No: **S427**  
 Inspected by: **R.A. WILLIAMS** Date: **15-6-77**  
 Authority: **WAGGA LANDS DEPT.** Field Book: **27 / D.**  
 Beacon Diagram: **Not to Scale**

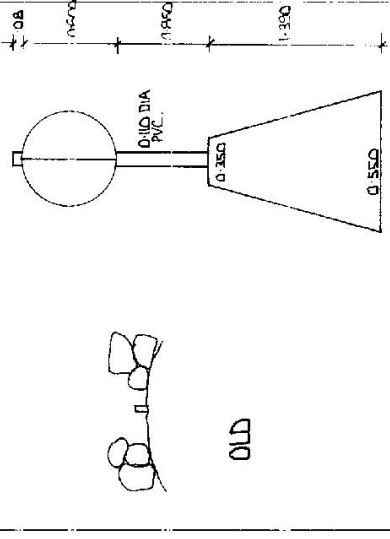

Date	Record of Station

Checked

STATION WHEEL OF FORTUNE (P) T.S. 6040

Owners Name TR 745

Address

Current Occupant

Address

Access 15-6-1977

0.00 KM DRIVE NORTH ALONG FITZMAURICE ST. FROM P.O.  
 0.90 TURN RIGHT OVER MURRUMBIDGEE RIVER AND FOLLOW OLYMPIC WAY  
 2.35 TURN RIGHT TOWARDS OUBA ON OLD GUNDAGAI RD.  
 0.30 TURN LEFT ONTO DIET TRACK LEADING TO PUMPING STATION  
 PROCEED AS SKETCHED

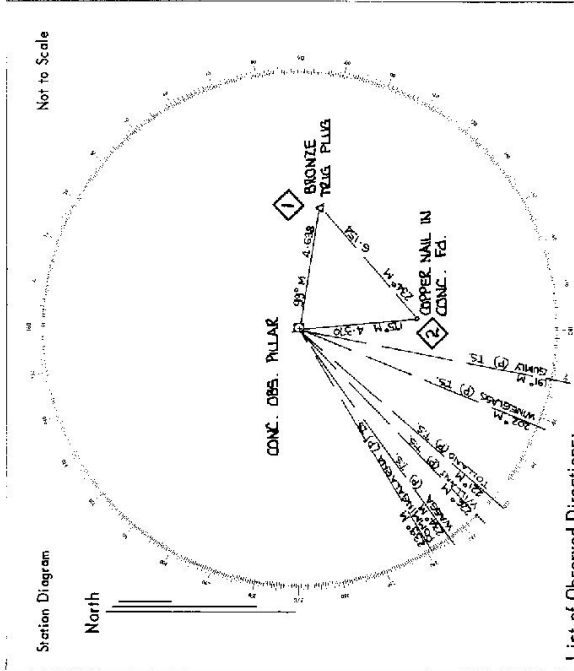
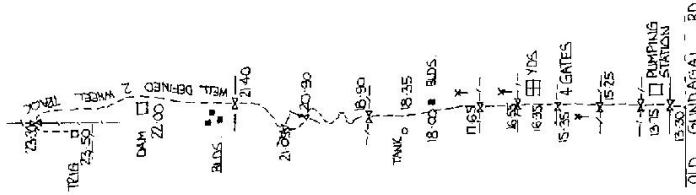

List of Observed Directions:-

CONC. OBS. PILLAR		Standpoint: BRONZE TRIG. PLAG	
Station	Direction	Station	Direction
GUMBY (P) T.S.	300° 00' 00"	GUMBY (P) T.S.	300° 00' 00"
WILLIAMS (P) T.S.	31° 29' 58"	COPPER NAIL IN CONC.	32° 03' 05"
BRONZE TRIG. PLAG	253° 09' 01"	WILLIAMS (P) T.S.	31° 29' 41"
COPPER NAIL IN CONC.	343° 16' 21"	CONC. OBS. PILLAR	11° 08' 01"
Station	Direction	Station	Direction

RECONNAISSANCE and MAINTENANCE REPORT

STATION **TS 6040**  
**T.S. 8738** M. I. OF FORTUNE. (P)

This Trig. Station has been:-  
Note: Cross out word or words which do not apply

Co: **CLARENDON** Ph: **OURA**  
Map Sheet: **TARCUITA** No: **8427**  
Inspected by: **B. MITCHELL** Date: **21.9.77**  
Authority: **DEPT. OF MAIN ROADS** Field Book:

Beacon Diagram

Net to Scale

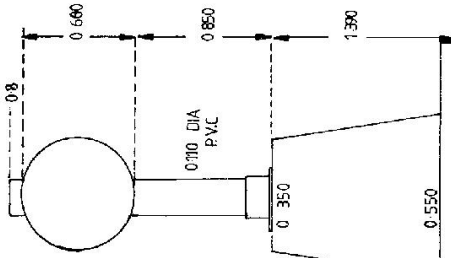

1. Completely cleared to permit 360° vision to surrounding Trigs.  
2. Cleared by lanes bearing ..... from Trig. Mast  
3. Trig. Mast & Vanes have been painted white & black respectively.  
4. The Trig. was ~~unpiled/not supplied~~ <sup>found</sup> ~~dimensions now being~~ <sup>new</sup> ~~STEEL PLATE ON CONC. PILLAR~~ <sup>found</sup> ..... should be explicit, e.g. Steel plug, Brass plug, Bolt, G.I. Pipe  
Description of mark <sup>BUCKAR</sup> ~~STEEL PLATE ON CONC. PILLAR~~ ..... m above below rock/concrete ..... m above below G.L.  
Height of mark ..... m above below rock/concrete ..... m above below G.L.  
Diameter of Vanes (vertical) ..... m.  
Height of Top Vanes to Top Mark <sup>BUCKAR</sup> ~~STEEL PLATE ON CONC. PILLAR~~ ..... m.  
Diameter of Cairn ..... m.  
Height of Cairn ..... m. Diameter of Cairn ..... m.  
Length of Mast ..... m. (approximate if not unpiled)  
5. ~~BUCKAR~~ <sup>found</sup> ~~set in conc/rock has been placed~~ <sup>found</sup> ..... m. bearing .....°M from Trig. Mast  
6. ~~BUCKAR~~ <sup>found</sup> ~~set in conc/soil has been placed~~ <sup>found</sup> ..... m. bearing .....°M from Trig. Mast  
7. ~~BUCKAR~~ <sup>found</sup> ~~set in conc/soil has been placed~~ ..... m. bearing .....°M from Trig. Mast  
8. ~~BUCKAR~~ <sup>found</sup> ~~set in conc/rock has been placed~~ ..... m. bearing .....°M from Trig. Mast  
9. Connection ~~BUCKAR~~ <sup>found</sup> ~~to~~ <sup>found</sup> ..... m. bearing .....°M  
10. Connection ..... to ..... m. bearing .....°M  
11. Connection ..... to ..... m. bearing .....°M  
12. Connection ..... to ..... m. bearing .....°M  
13. Diff. Ht. ~~BUCKAR~~ <sup>found</sup> ~~to~~ <sup>found</sup> is ~~1.430~~ <sup>1.430</sup> m. above below ~~BUCKAR~~ <sup>found</sup>  
14. Diff. Ht. ~~BUCKAR~~ <sup>found</sup> ~~to~~ <sup>found</sup> is ..... m. above below  
15. Diff. Ht. ..... is ..... m. above below  
16. Diff. Ht. ..... is ..... m. above below

Date	Record of Station
21.9.77	visited by hands Dept. 6040A

Checked

Noted on U.T.M. Card

Prepared by: ..... Checked: .....

STATION TS 473 | WHEEL OF FORTUNE. TS 6040

Owners Name .....  
 Current Occupant .....  
 Address .....  
 Access 21.9.1977

Station Diagram

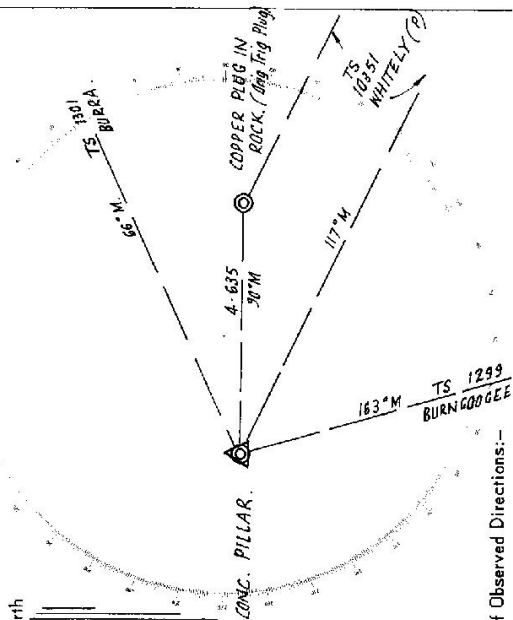

List of Observed Directions:-

Station	Direction	Station	Direction
TS 1299 BURN GOOGEE	0° 00' 00"	TS 10351 WHITELEY PILLAR	0° 00' 00"
COPPER PILLAR (ORIG. TRIG.)	206° 45' 20"	CONCRETE PILLAR	152° 35' 20"

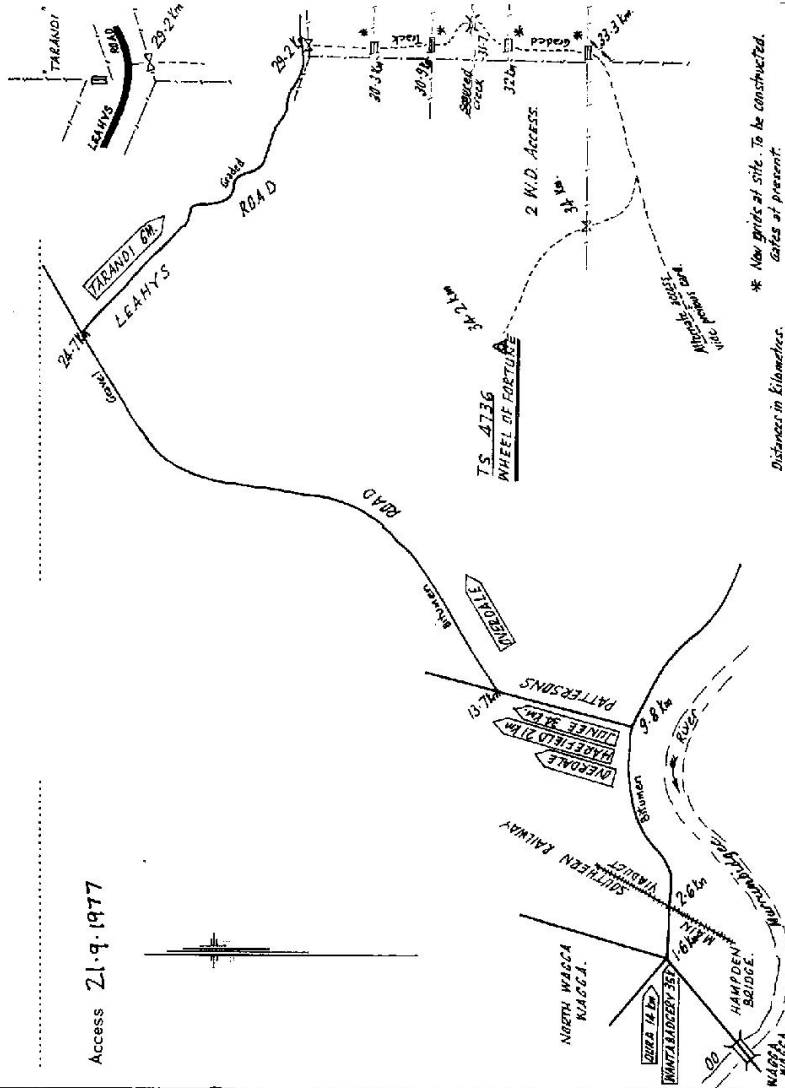

Distances in Kilometres.  
 \* New grids at site. To be constructed.  
 Gates at present.

CENTRAL MAPPING AUTHORITY

GEODETIC SURVEY OF N.S.W.

GEODETIC STATION RECONNAISSANCE and MAINTENANCE REPORT

Description: *Note: Cross out word or words which do not apply*

- Cleared by lanes bearing  $20^{\circ} 34' 30''$   $33^{\circ} 42' 30''$   $33^{\circ} 42' 30''$   $33^{\circ} 42' 30''$  from Trig. Mast
- Mast & Vanes have been painted white & black respectively. ✓

3. The station/pillar was ~~unplaced~~/not unplaced/~~constructed~~ on  $19$ ....., dimensions now being:

Description of mark..... should be explicit, e.g., S/Steel Pillar Plate, Steel plug, Brass plug, Bolt, G.I. Pipe

Height of mark.....m. <sup>above</sup> rock/concrete; Mark is.....m. <sup>above</sup> below G.L.

Height of Top Vanes to Top Mark/Pillar plate.....m. Diameter of Vanes (vertical)..... $0.6$  m.

Height of Cairn.....m. Diameter of Cairn.....m. Name Plate found/not found/placed.

Length of Mast.....m. (approximate if not unplaced)

4. A.....set in conc/rock has been placed/found, bearing.....°M from Mast/Plug/Pillar

5. A.....set in conc/rock has been placed/found, bearing.....°M from Mast/Plug/Pillar

6. A.....set in conc/rock has been placed/found, bearing.....°M from Mast/Plug/Pillar

7. A.....set in conc/rock has been placed/found, bearing.....°M from Mast/Plug/Pillar

8. Action required:.....

STANDPOINT:				STANDPOINT:			
Mark	Direction	Horiz. Distance	Height Difference	Mark	Direction	Horiz. Distance	Height Difference
			above standpt.				above standpt.
			below standpt.				below standpt.
			above standpt.				above standpt.
			below standpt.				below standpt.
			above standpt.				above standpt.
			below standpt.				below standpt.
			above standpt.				above standpt.
			below standpt.				below standpt.
			above standpt.				above standpt.
			below standpt.				below standpt.

Prepared by: *ghaw...* 31/05/20 Checked: *ghaw...*

S: 2783-1

Noted on U.T.M. Card

STATION: *WHEEL OF FORTUNE.* No.: *6040*

MAP SHEET SCALE 1:250 000 *WAGGA WAGGA* 51 55-15

INSPECTED BY: *R. LANBER* DATE: *23/10/80*

AUTHORITY: *CMA* FIELD BOOK: *01900*

Station Diagram

North

Not to Scale



GEODETTIC SURVEY OF N.S.W.

CENTRAL MAPPING AUTHORITY

GEODETTIC STATION RECONNAISSANCE and MAINTENANCE REPORT

Description:

Note: Cross out word or words which do not apply

1. Cleared by lanes bearing:  $08^{\circ} 7' 11''$ ,  $70^{\circ} 8' 19''$ ,  $45^{\circ} 0' 51''$ ,  $12^{\circ} 5' 21''$ ,  $93^{\circ} 28' 04''$  from Trig. Mast
2. Mast & Vanes have been painted white & black respectively.
3. The ~~station~~/pillar was ~~unpiled~~/not unpiled/~~concrete~~ on  $2.1$  m.  $19.80$  dimensions now being:  $5/Steel$
- Description of mark:  $5/Steel$  should be explicit, e.g. S/Steel Pillar Plate, Steel plug, Brass plug, Bolt, G.I. Pipe
- Height of mark:  $1.400$  m. above ~~rock~~/concrete, Mark is  $1.400$  m. above ~~rock~~ below G.L.
- Height of Top Vanes to Top ~~rock~~/Pillar plate  $1.455$  m. Diameter of Vanes (vertical)  $0.600$  m.
- Height of Cairn:  $0.600$  m. Diameter of Cairn:  $0.600$  m. Name Plate found/not found/placed.
- Length of Mast:  $0.600$  m. (approximate if not unpiled)
4. A. ~~Base~~  $700$  Bus set in conc/~~rock~~ has been placed/found, bearing  $87^{\circ}$  M from ~~Mast~~/Pillar
5. A. set in conc/rock has been placed/found, bearing  $^{\circ}$  M from Mast/Plug/Pillar
6. A. set in conc/rock has been placed/found, bearing  $^{\circ}$  M from Mast/Plug/Pillar
7. A. set in conc/rock has been placed/found, bearing  $^{\circ}$  M from Mast/Plug/Pillar
8. Action required:  $^{\circ}$

STANDPOINT:

Mark	Direction	Horiz. Distance	Height Difference	Mark	Direction	Horiz. Distance	Height Difference
			above standpt.				above standpt.
			below standpt.				below standpt.
			above standpt.				above standpt.
			below standpt.				below standpt.
			above standpt.				above standpt.
			below standpt.				below standpt.
			above standpt.				above standpt.
			below standpt.				below standpt.

Prepared by: *Rob My* Checked: *19/10/19* Noted on U.T.M. Card

ST 2733-1

STATION: *WHEEL OF FORTUNE (P)* No.: *6040*  
 MAP SHEET SCALE 1:250 000 *WAECCA WAACEA*  
 INSPECTED BY: *C. FORD* DATE: *24/1/80*  
 AUTHORITY: *C.M.A* FIELD BOOK: *1823*

Station Diagram  
Not to Scale

Checked

St 2735-2 D. West, Government Printer

STATION *WHEEL OF FORTUNE (?) TS 6040*

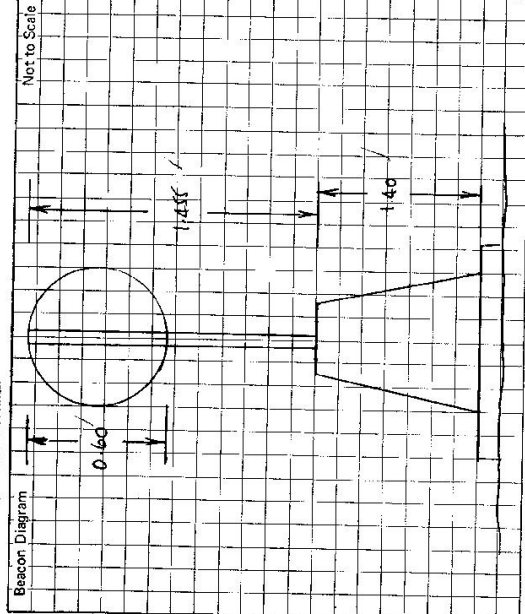

Owner's Name: .....  
 Address: .....  
 Phone: .....  
 Current Occupant: .....  
 Address: .....  
 Phone: .....

ACCESS  
 Access Report of ...../19..... was found suitable/unsuitable.

This section to be completed by officer constructing pillar.

Original station mark found/not found.  
 Description of mark: .....  
 Original beacon found/not found.  
 Description of beacon: .....  
 Height Top of Vanes to Top Mark.....m.  
 Height of mark.....m. above rock/conc.....m. below G.L.  
 Diameter of Vanes.....m. Height of Cairn.....m.  
 Original Beacon has/has not been destroyed by me.

Date	Record of Station



IS 6040

GEODETTIC SURVEY OF M.S.W.

CENTRAL MAPPING AUTHORITY

GEODETTIC STATION RECONNAISSANCE and MAINTENANCE REPORT

Description:

1. Cleared by lanes bearing.....  
*Note: Cross out word or words which do not apply*
2. Mast & Vanes have been painted white & black respectively.  
..... from Trig. Mast
3. The station/pillar was unpiled/not unpiled/constructed on.....  
....., dimensions now being:  
Description of mark.....should be explicit, e.g., S/Steel Pillar Plate, Steel plug, Brass plug, Bolt, G.I. Pipe  
Height of mark.....m. <sup>above</sup> <sub>below</sub> rock/concrete; Mark is.....m. <sup>above</sup> <sub>below</sub> G.L.  
Height of Top Vanes to Top Mark/Pillar plate.....m. Diameter of Vanes (vertical).....m.  
Height of Cairn.....m. Diameter of Cairn.....m. Name Plate found/not found/placed.  
Length of Mast.....m. (approximate if not unpiled)
4. A.....set in conc/rock has been placed/found, bearing.....° M from Mast/Plug/Pillar
5. A.....set in conc/rock has been placed/found, bearing.....° M from Mast/Plug/Pillar
6. A.....set in conc/rock has been placed/found, bearing.....° M from Mast/Plug/Pillar
7. A.....set in conc/rock has been placed/found, bearing.....° M from Mast/Plug/Pillar
8. Action required:.....

STANDPOINT:

Mark	Direction	Horiz. Distance	Height Difference	Mark	Direction	Horiz. Distance	Height Difference
			above standpt.				above standpt.
			below				below
			above standpt.				above standpt.
			below				below
			above standpt.				above standpt.
			below				below
			above standpt.				above standpt.
			below				below
			above standpt.				above standpt.
			below				below

Prepared by:

Checked:

ed on U.T.M. Card

Checked

SI 2735-1

STATION: WHEEL OF FORTUNE [P] No.: TS4386  
 MAP SHEET SCALE 1:250 000 WACCA WACCA.  
 INSPECTED BY: J. J. FILDCAMO. DATE: 17-6-83.  
 AUTHORITY: CROWN LANDS OFFICE FIELD BOOK:

Station Diagram  
 Not to Scale  
 North

