

CENTRAL MAPPING AUTHORITY

GEODETIC SURVEY OF N.S.W.

GEODETIC STATION RECONNAISSANCE and MAINTENANCE REPORT

STATION: PARRAMATTA (PILLAR) TS No.: 6032

MAP SHEET SCALE 1:250 000

INSPECTED BY: L. N. HOLLIS DATE: 15 FEBRUARY 1979

AUTHORITY: HASSTULS FIELD BOOK: 01540

Description: 3.1.1.0 Note: Cross out word or words which do not apply

1. Cleared by lanes bearing 3.1.1.0 from Trig, Mast

2. Mast & Vanes have been painted white & black respectively. ✓

3. The ~~station~~/pillar was ~~replaced/re-erected~~/constructed on 1.1.1.1 F.2.1.1 19.7.1.1, dimensions now being:

Description of mark S.S.H should be explicit, e.g. S/Steel Pillar Plate, Steel plug, Brass plug, Bolt, G.I. Pipe

Height of mark 1.3.1.1 above ~~rock~~/concrete; Mark is 1.3.1.1 above G.L.

Height of Top Vanes to Top ~~Mark~~/Pillar plate 1.4.1.1 m. Diameter of Vanes (vertical) 7.6.0 m.

Height of Cairn 1.4.1.1 m. Diameter of Cairn 1.4.1.1 m. Name Plate ~~found/lost~~/found/placed.

Length of Mast 1.4.1.1 m. (approximate if not unriped)

4. A Beass Pillar set in conc/rock has been ~~placed~~/found, bearing 3.1.1.0 M from Mast/Pillar/Pillar

5. A S.S.M set in conc/rock has been ~~placed~~/found, bearing 5.0 M from Mast/Pillar/Pillar

6. A C.I.M set in conc/rock has been ~~placed~~/found, bearing 1.9.0 M from Mast/Pillar/Pillar

7. A 1.9.0 set in conc/rock has been placed/found, bearing 1.9.0 M from Mast/Pillar/Pillar

8. Action required: Beass Pillar

STANDPOINT: CONCRETE PILLAR

STANDPOINT: Beass Pillar

STATION: PARRAMATTA

STATION: PARRAMATTA

STATION: PARRAMATTA

STATION: PARRAMATTA

STATION: PARRAMATTA

STATION: PARRAMATTA

STATION: PARRAMATTA

STATION: PARRAMATTA

STATION: PARRAMATTA

STATION: PARRAMATTA

STATION: PARRAMATTA

STATION: PARRAMATTA

STATION: PARRAMATTA

STATION: PARRAMATTA

STATION: PARRAMATTA

STATION: PARRAMATTA

STATION: PARRAMATTA

STATION: PARRAMATTA

STATION: PARRAMATTA

STATION: PARRAMATTA

STATION: PARRAMATTA

STATION: PARRAMATTA

STATION: PARRAMATTA

STATION: PARRAMATTA

STATION: PARRAMATTA

STATION: PARRAMATTA

STATION: PARRAMATTA

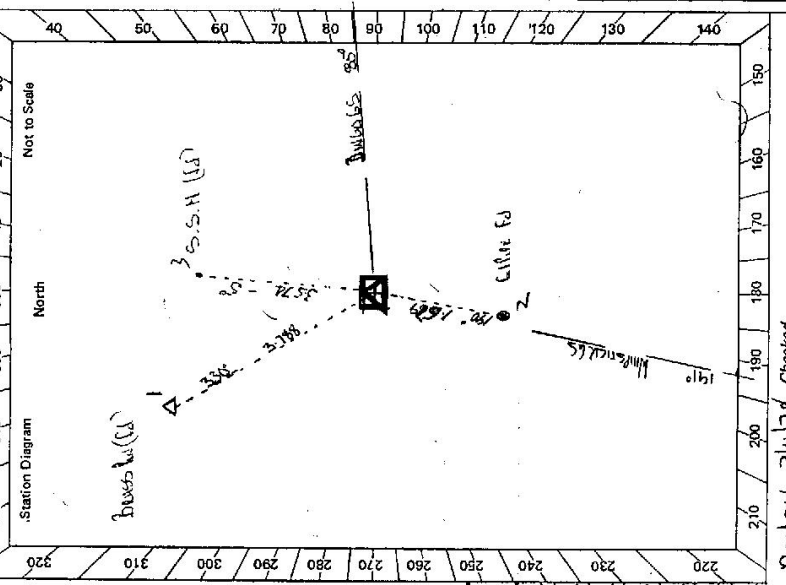

Prepared by: Boxlow 3478 Checked: Boxlow 3478

ST 2733-1

STATION POUNCEBORN QUARRY TS 6032

Owner's Name:
 Address:
 Phone:

Current Occupant:
 Address:
 Phone:

ACCESS 18-2-1979

NEW Access Report of 18/2/1979 was found suitable/unsuitable.

00-00 HT BESIDE P.O. TOWNHALL WEST
 2-75 TULLY RIVER SWAY OULET HIGHWAY 73, KUONINGHALL RD.
 1180 TULLY LEFT SWAY WESTERN BOUNDARY
 1140 TULLY SWAY LEFT
 1500 GEOMETRIC STATION

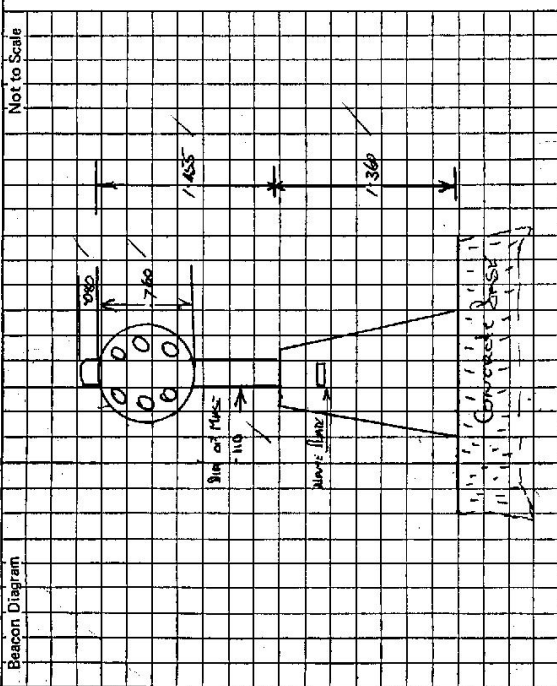

This section to be completed by officer constructing pillar.

Original station mark found/~~not found~~.

Description of mark: 30mm dia

Original beacon found/~~not found~~.

Description of beacon: Concrete base 910 dia

Height Top of Vanes to Top Mark: 2.682 m.

Height of mark: 1038 m. above ~~below~~ G.L.

Diameter of Vanes: 910 m. Height of Cairn: 1.63 m.

Original Beacon has/~~has not~~ been destroyed by me.

Date	Record of Station