

CENTRAL MAPPING AUTHORITY  
Department of Lands

Trigonometrical Survey of N.S.W.

RECONNAISSANCE and MAINTENANCE REPORT

This Trig. Station has been:-

Note: Cross out word or words which do not apply

1. Completely cleared to permit 360° vision to surrounding Trig.
2. Cleared by limes bearing 179° - 180° M from Trig. Mast
3. Trig. Mast & Vanes have been painted white & black respectively.
4. The Trig. was ~~unpiled~~/not unpiled, dimensions now being:

Description of mark..... should be explicit, e.g. Steel plug, Brass plug, Bolt, G.I. Pipe  
 Height of mark..... m above rock/concrete ..... m below G.I.  
 Height of Top Vanes to Top Mark..... m. Diameter of Vanes (vertical)..... m.  
 Height of Cairn 0.7 m. Diameter of Cairn 2 m.  
 Length of Mast 3.1 m. (approximate if not unpiled)

5. A..... set in conc/rock has been placed..... m. bearing.....°M from Trig. Mast
6. A..... set in conc/soil has been placed..... m. bearing.....°M from Trig. Mast
7. A..... set in conc/soil has been placed..... m. bearing.....°M from Trig. Mast
8. A..... set in conc/rock has been placed..... m. bearing.....°M from Trig. Mast
9. Connection..... to..... m. bearing.....°M
10. Connection..... to..... m. bearing.....°M
11. Connection..... to..... m. bearing.....°M
12. Connection..... to..... m. bearing.....°M
13. Diff. Ht. .... is..... m. above below
14. Diff. Ht. .... is..... m. above below
15. Diff. Ht. .... is..... m. above below
16. Diff. Ht. .... is..... m. above below

Prepared by: *Alastair* Checked: \_\_\_\_\_

Noted on U.T.M. Card

STATION **ESKDALE G.S. IS 6022**  
 Co: **ROXBURGH** Ph: **ESKDALE**  
 Map Sheet: **B BATHURST** No: **8831**  
 Inspected by: **P. CARR** Date: **15/2/77**  
 Authority: **C.M.A.** Field Book:  
 Beacon Diagram Not to Scale

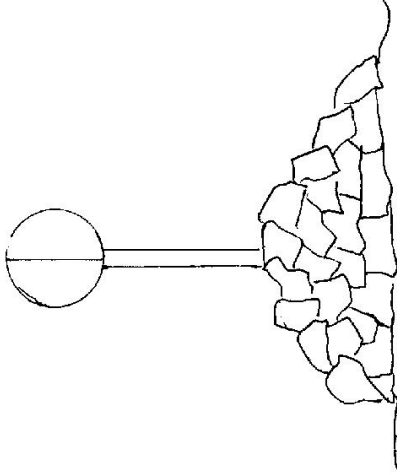

Date	Record of Station

Checked

STATION **ESKDALE G.S. TS 6022**

Owners Name.....  
 Current Occupant.....  
 Address.....  
 Address.....  
 Access.....

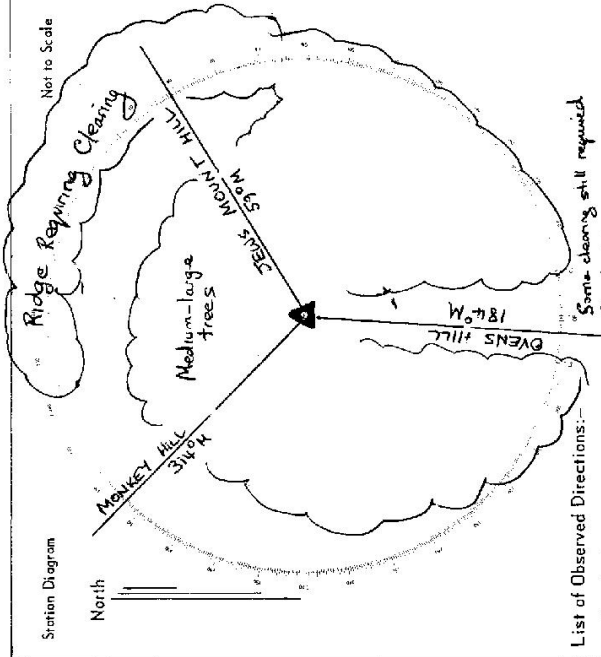

List of Observed Directions:—

Standpoint:	
Station	Direction

Standpoint:	
Station	Direction

Some clearing still required

CENTRAL MAPPING AUTHORITY  
Department of Lands

Trigonometrical Survey of N.S.W.

RECONNAISSANCE and MAINTENANCE REPORT

This Trig. Station has been:-

Note: Cross out word or words which do not apply

1. ~~Completely cleared to permit 360° vision to surrounding Trig.~~
2. Cleared by lanes bearing  $171^{\circ}$  to  $183^{\circ}$  from Trig. Mast
3. Trig. Mast & Vanes have been painted white & black respectively.
4. The Trig. was unplied/not unplied, dimensions now being: ~~One and a half~~ Station Mark found ~~not found~~

Description of mark: Brass Plug should be explicit, e.g. Steel plug, Brass plug, Bolt, G.I. Pipe

Height of mark: ..... m above rock/concrete ..... m above G.L.  
 Height of Top Vanes to Top Mark: ..... m Diameter of Vanes (vertical): ..... m  
 Height of Cairn: ..... m Diameter of Cairn: ..... m

- Length of Mast: ..... m. (approximate if not unplied)
5. A. .... set in conc/rock has been placed ..... m. bearing .....°M from Trig. Mast
  6. A. .... set in conc/soil has been placed ..... m. bearing .....°M from Trig. Mast
  7. A. .... set in conc/soil has been placed ..... m. bearing .....°M from Trig. Mast
  8. A. .... set in conc/rock has been placed ..... m. bearing .....°M from Trig. Mast

9. Connection: ..... to: ..... m. bearing .....°M
10. Connection: ..... to: ..... m. bearing .....°M
11. Connection: ..... to: ..... m. bearing .....°M
12. Connection: ..... to: ..... m. bearing .....°M
13. Diff. Ht. .... is: ..... m. <sup>above</sup>/<sub>below</sub>
14. Diff. Ht. .... is: ..... m. <sup>above</sup>/<sub>below</sub>
15. Diff. Ht. .... is: ..... m. <sup>above</sup>/<sub>below</sub>
16. Diff. Ht. .... is: ..... m. <sup>above</sup>/<sub>below</sub>

Prepared by: Glen Jones Checked: ..... Noted on U.T.M. Card

STATION ESKDALE 73-6022

Co: ROXBURGH ✓ Ph: ESKDALE ✓

Map Sheet: BATHURST No: 8831-S

Inspected by: R Whitfield Date: 23-6-77

Authority: C.M.A. Field Book:

Beacon Diagram: Not to Scale

Trig found and left unplied  
Mast rotten at base.

Date: ..... Record of Station

Checked



CENTRAL MAPPING AUTHORITY  
Department of Lands

Trigonometrical Survey of N.S.W.

RECONNAISSANCE and MAINTENANCE REPORT

This Trig. Station has been:-

Note: Cross out word or words which do not apply

1. ~~Completed~~ ~~cleared to permit 360° vision to surrounding trig~~ **NOTHING CLEARED AT ALL**
2. Cleared by lanes bearing **182° M. TOWARDS DVEN GS. ONLY** from Trig. Mast
3. Trig. Mast & Vanes have been painted white & black respectively.

4. The Trig. was unpiled/not unpiled, dimensions now being: ~~Original Station Mark found at 1.1~~

Description of mark: ~~should be explicit, e.g. Steel plug, Brass plug, Balr, G.I. Pipe~~

Height of mark: ~~..... m above rock/concrete ..... m below G.L.~~

Height of Top Vanes to Top Mark ~~..... m. Diameter of Vanes (vertical) ..... m.~~

Height of Cairn ~~..... m. Diameter of Cairn ..... m.~~

Length of Mast ~~..... m. (approximate if not unpiled)~~

5. A. ~~..... set in conc/rock has been placed ..... m. bearing ..... ° M from Trig. Mast~~

6. A. ~~..... set in conc/soil has been placed ..... m. bearing ..... ° M from Trig. Mast~~

7. A. ~~..... set in conc/soil has been placed ..... m. bearing ..... ° M from Trig. Mast~~

8. A. ~~..... set in conc/rock has been placed ..... m. bearing ..... ° M from Trig. Mast~~

9. Connection ~~..... to ..... m. bearing ..... ° M~~

10. Connection ~~..... to ..... m. bearing ..... ° M~~

11. Connection ~~..... to ..... m. bearing ..... ° M~~

12. Connection ~~..... to ..... m. bearing ..... ° M~~

13. Diff. Ht. ~~..... is ..... m. above below~~

14. Diff. Ht. ~~..... is ..... m. above below~~

15. Diff. Ht. ~~..... is ..... m. above below~~

16. Diff. Ht. ~~..... is ..... m. above below~~

Prepared by:

Noted on U.T.M. Card

Checked:

Checked

STATION **ESKDALE GS TS 6022**

Co: **ROXBURGH** Ph: **ESKDALE**

Map Sheet: **BATHURST** No: **8831**

Inspected by: **W. MILLER** Date: **24-6-77**

Authority: **CMA** Field Book: \_\_\_\_\_

Beacon Diagram Not to Scale

**NEW ACCESS : SEE BACKPAGE**  
**(REPLACES A. PATTERSON'S DRAWING 13-12-73)**

Date

Record of Station

STATION **ESKDALE GS IS. 6022**

Owners Name:.....

Current Occupant:.....

Address:.....

Address:.....

Access 24-6-1977

Station Diagram

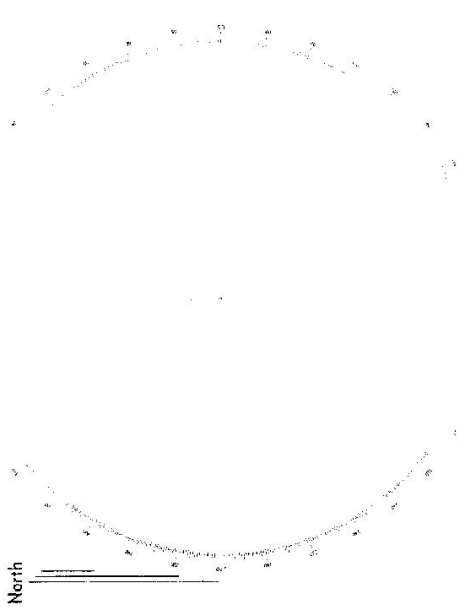

List of Observed Directions:--

Standpoint:		Standpoint:	
Station	Direction	Station	Direction
.....	.....	.....	.....
.....	.....	.....	.....
.....	.....	.....	.....
.....	.....	.....	.....
.....	.....	.....	.....
.....	.....	.....	.....
.....	.....	.....	.....
.....	.....	.....	.....
.....	.....	.....	.....
.....	.....	.....	.....
.....	.....	.....	.....

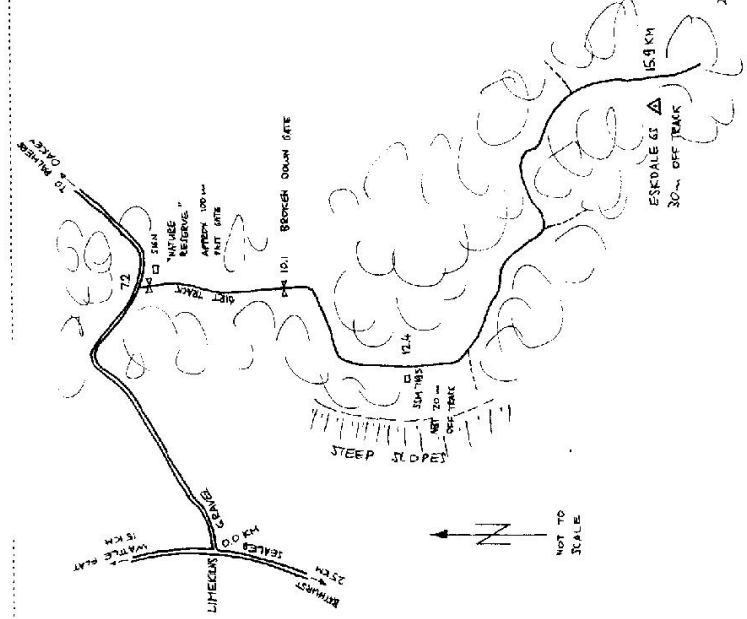

STATION: ESKDALE (Pillar) No: 1987  
 MAP SHEET SCALE 1:250 000 Bartholomew  
 INSPECTED BY: P. Berts DATE: 16.2.78  
 AUTHORITY: C.M.S. FIELD BOOK: C.M.S. 6022

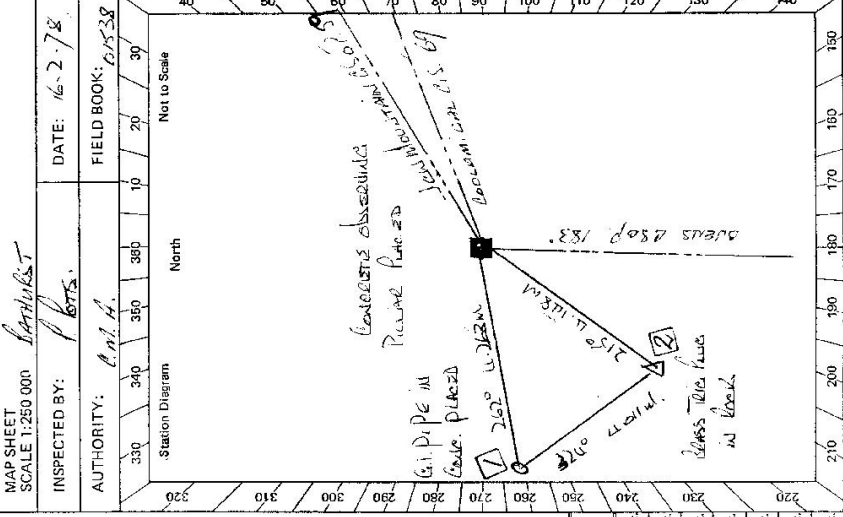

CENTRAL MAPPING AUTHORITY  
 GEODETTIC SURVEY OF N.S.W.  
 GEODETTIC STATION RECONNAISSANCE and MAINTENANCE REPORT

Description:  
 1. Cleared by lanes bearing 173° 20' 19" 211° 30' 26" 209° 32' 26" 50° 46' 16" 161° 47' 38" from Trig. Mast P. 442.  
 Note: Cross out word or words which do not apply.  
 2. Mast & Vanes have been painted white & black respectively.  
 3. The station/pillar was reconstructed on concrete 1978, dimensions now being:  
 Description of mark: 1.5 x 1.5 x 1.5 m should be explicit, e.g., S/Steel Pillar Plate, Steel plug, Brass plug, Bolt, G.I. Pipe  
 Height of mark: 1.36 m above concrete; Mark is 1.5 x 1.5 m above G.L.  
 Height of Top Vanes to Temp. Pillar 1.443 m. Diameter of Vanes (vertical) 0.750 m.  
 Height of Cairn: 0 m. Diameter of Cairn: 0 m. Name Plate not placed.  
 Length of Mast: 1.523 m. (approximate if not unipiled)  
 4. MASS 1.5 m set in conc/rock has been found, bearing 215° 00' M from Temp. Pillar  
 5. G.I. Pipe set in conc/rock has been placed, bearing 262° 00' M from Temp. Pillar  
 6. G.I. Pipe set in conc/rock has been placed, bearing 224° 00' M from Temp. Plug/Pillar  
 7. A set in conc/rock has been placed, bearing 0° M from Mast/Plug/Pillar  
 8. Action required: Pillar Plate.

Mark	Direction	Horiz. Distance	Height Difference	Mark	Direction	Horiz. Distance	Height Difference
<u>MASS</u>	<u>0 00 00</u>	<u>0 m</u>	<u>above standpt.</u>	<u>MASS</u>	<u>0 00 00</u>	<u>0 m</u>	<u>above standpt.</u>
<u>G.I. PIPE IN CONC.</u>	<u>22 15 30</u>	<u>11.118</u>	<u>above standpt.</u>	<u>G.I. PIPE IN CONC.</u>	<u>131 17 35</u>	<u>4.011</u>	<u>above standpt.</u>
<u>G.I. PIPE IN CONC.</u>	<u>19 13 00</u>	<u>4.263</u>	<u>below</u>	<u>PILLAR PLATE</u>	<u>202 17 00</u>	<u>4.148</u>	<u>above standpt.</u>
<u>TEMP. MOUNTAIN PILLAR</u>	<u>236 28 00</u>	<u>1.502</u>	<u>above standpt.</u>	<u>TEMP. MOUNTAIN PILLAR</u>	<u>236 37 00</u>	<u>1.500</u>	<u>above standpt.</u>
<u>CONCRETE</u>	<u>215 50 15</u>	<u>1.502</u>	<u>below</u>	<u>CONCRETE</u>	<u>208 49 40</u>	<u>1.500</u>	<u>below</u>
			<u>below</u>	<u>MASS</u>	<u>5 00 00</u>	<u>5.000</u>	<u>below</u>
			<u>below</u>				<u>below</u>

STATION: ESKDALE (Pillar) No: 1987  
 MAP SHEET SCALE 1:250 000 Bartholomew  
 INSPECTED BY: P. Berts DATE: 16.2.78  
 AUTHORITY: C.M.S. FIELD BOOK: C.M.S. 6022  
 Station Diagram  
 Prepared by: P. Berts 16/2/78. Checked: A. Valje 27/4/78  
 Noted on U.T.M. Card

STATION ESKDALE (PILLAR) TS 6022

Owner's Name: FORESTRY COMMISSION  
 Current Occupant: FORESTRY COMMISSION  
 Address: 61R BRIMMING AND WILLIAM STREETS  
 Address: BATHURST 2795  
 Phone: 31 2044  
 Phone:         

ACCESS

Access Report of 16/2/1978 was found suitable/unsuitable.  
FEATURES  
 0.00 To VESLO HEAD SOUTHWEST TOWARDS SYDNEY.  
 0.05 TURN LEFT ONTO LIME KINGS ROAD.  
 21.55 END OF SEALED ROAD.  
 21.65 TURN RIGHT SLOW PALMER'S DRIVE LHM.  
 25.65 LAUSEWAY.  
 32.25 TURN LEFT. SLOW BOUNDARY SIGN.  
 32.30 WOODEN GATE. SIGN ON GATE NO ENTRY PRIVATE PROPERTY.  
 32.80 DRIVE WAY IN FENCE.  
 36.30 BLOCKED DOWN GATE SIGN PRIVATE PROPERTY.  
 37.60 SSM 7195 ON RIGHT HAND SIDE OF ROAD BLAZE ON TREE PRINTED WHITE.  
 39.50 PART TRACK ON RIGHT.  
 39.70 GATE WAY IN FENCE.  
 41.10 COEDERIC STATIONS ESKDALE!

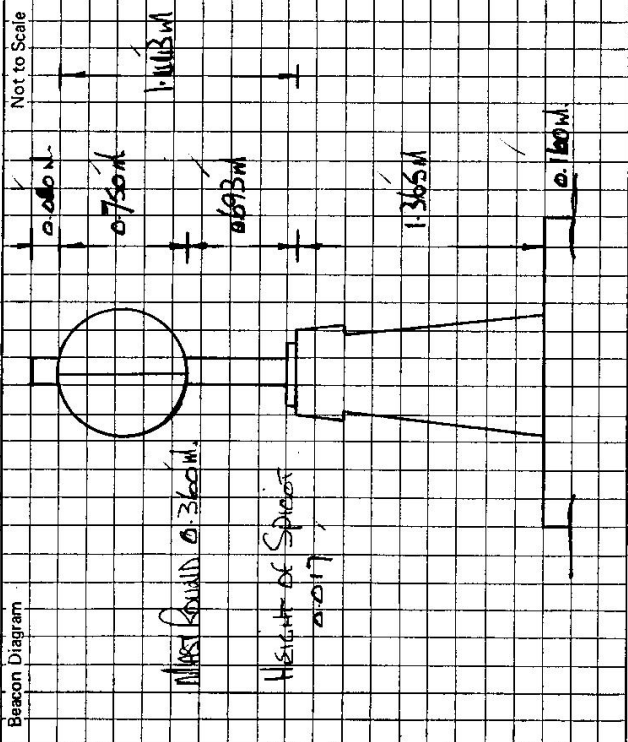

This section to be completed by officer constructing pillar.

Original station mark found/~~not found~~  
 Description of mark: BLAZE TRIP PILLAR  
 Original beacon found/~~not found~~:  
 Description of beacon: CAIRN, MAST & VANES  
 Height Top of Vanes to Top Mark: 3.353 m.  
 Height of mark: 0.160 m. above rock/~~0.160~~ m. below  
 Diameter of Vanes: 0.95 m. Height of Cairn: 5.00 m.  
 Original Beacon has/~~was~~ been destroyed by me.

Date	Record of Station



GEODETIC SURVEY OF N.S.W.

CENTRAL MAPPING AUTHORITY

GEODETIC STATION RECONNAISSANCE and MAINTENANCE REPORT

STATION: **ESKDALE G.S.** No: **6022**

MAP SHEET **BATHURST**  
SCALE 1:250 000

INSPECTED BY: **R. ELLIS** DATE: **26-06-81**

AUTHORITY: **C.M.A.** FIELD BOOK: **01917**

Description: *Note: Cross out word or words which do not apply*

1. Cleared by lanes bearing  $50^{\circ}M$  to  $61^{\circ}M$ ,  $68^{\circ}M$  to  $77^{\circ}M$ ,  $82^{\circ}M$  to  $91^{\circ}M$ ,  $97^{\circ}M$  to  $106^{\circ}M$  from Trig. Mast  
 $265^{\circ}M$  to  $272^{\circ}M$ ;  $311^{\circ}M$  to  $320^{\circ}M$
2. Mast & Vanes have been painted white & black respectively. ✓
3. The ~~station~~ pillar was unpiled/not unpiled/constructed on **08 JANUARY 1978**, dimensions now being:  
Description of mark: ~~S/Steel Pillar~~ should be explicit, e.g., S/Steel Pillar Plate, Steel plug, Brass plug, Bolt, G.I. Pipe  
Height of mark  $1.365$  m. <sup>above</sup> ~~rock~~/concrete; Mark is  $1.525$  m. <sup>above</sup> G.L. <sub>below</sub>  
Height of Top Vanes to ~~Top~~ rock/Pillar plate  $1.443$  m. Diameter of Vanes (vertical)  $0.755$  m.  
Height of Cairn.....m. Diameter of Cairn.....m. Name Plate found/~~not found~~/placed.  
Length of Mast  $1.523$  m. (approximate if not unpiled)
4. A **ST PIPE** set in conc/~~rock~~ has been ~~placed~~/found, bearing  $262^{\circ}M$  from Mast/~~plug~~/Pillar
5. A.....set in conc/rock has been placed/round, bearing..... $^{\circ}M$  from Mast/~~plug~~/Pillar
6. A.....set in conc/rock has been placed/round, bearing..... $^{\circ}M$  from Mast/~~plug~~/Pillar
7. A.....set in conc/rock has been placed/round, bearing..... $^{\circ}M$  from Mast/~~plug~~/Pillar
8. Action required: **RECLEANING OF LANS IF REQUIRED**

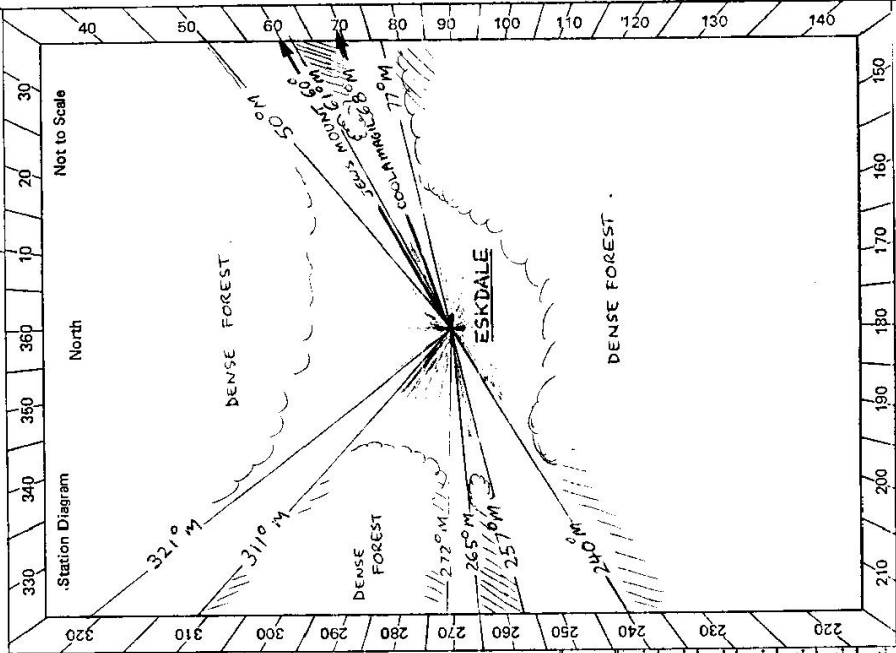

STANDPOINT:				STANDPOINT:			
Mark	Direction	Horiz. Distance	Height Difference	Mark	Direction	Horiz. Distance	Height Difference
			above standpt				above standpt
			below standpt				below standpt
			above standpt				above standpt
			below standpt				below standpt
			above standpt				above standpt
			below standpt				below standpt
			above standpt				above standpt
			below standpt				below standpt
			above standpt				above standpt
			below standpt				below standpt

Prepared by: *Ellis* 27/06/81 Checked:

Noted on U.T.M. Card

Checked

St 2733-2 D. West, Government Printer

STATION **ESKDALE** TS **6022**

Beacon Diagram	Not to Scale
<p>PILLAR / MAST / VANES IN GOOD ORDER.</p>	

Owner's Name: **FORESTRY COMMISSION**  
 Address: **Cnr BATHURST & WILLIAM STS**  
**BATHURST 2795**  
 Phone: **31-2044**

Current Occupant: .....  
 Address: .....  
 Phone: .....

**ACCESS**

Access Report of 16.12.19. It was found suitable.

- | KM    | FEATURE   |
|-------|---|
| 0.0   | PO. KELSO HEAD EAST TOWARDS SYDNEY                        |
| 0.1   | TURN LEFT AND HEAD ALONG LIMEKILNS ROAD                   |
| 7.8   | "WINBURDALE RIVULET" BRIDGE                               |
| 14.0  | "CLEAR CREEK" BRIDGE                                      |
| 14.8  | PASS PEEL - LIMEKILNS ROAD ON LEFT                        |
| 17.8  | BRIDGE  |
| 24.0  | END OF BITUMEN  |
| 24.2  | TURN RIGHT TO "PALMERS OAK"                               |
| 25.1  | CAUSEWAY  |
| 31.5  | TURN RIGHT AFTER SHIRE BOUNDARY SIGN                      |
| 31.55 | WOODEN GATE - SIGN "PRIVATE NO ENTRY" & "WILDLIFE REFUGE" |
|       | PROCEED THROUGH GATE                                      |
|       | GATEWAY IN FENCE  |
| 32.04 | }   |
| 34.47 |   |
| 36.07 | BLAZE ON TREE - RHS OF TRACK.                             |
| 37.71 | }   |
| 38.55 |   |
| 38.76 | GATE IN FENCE   |
| 39.58 | PASS TRACK ON LEFT  |
| 40.17 | ESKDALE G.S. ON RIGHT - 30 metres.                        |

This section to be completed by officer constructing pillar.

Original station mark found/not found.

Description of mark: .....

Original beacon found/not found.

Description of beacon: .....

Height Top of Vanes to Top Mark.....m.

Height of mark.....m. above rock/conc.....m. below G.L.

Diameter of Vanes.....m.

Height of Cairn.....m.

Original Beacon has/not been destroyed by me.

Date	Record of Station

GEODETTIC SURVEY OF ALSIAK

CENTRAL MAPPING AUTHORITY

GEODETTIC STATION RECONNAISSANCE and MAINTENANCE REPORT

Description:

1. Cleared by lanes bearing..... *COMPLETED, CAVEALED BY RECD. STH.* from Trig. Mast  
*Note: Cross out word or words which do not apply*
2. Mast & Vanes have been painted white & black respectively.
3. The station/pillar was unpiled/not unpiled/constructed on..... 19....., dimensions now being:  
Description of mark..... should be explicit, e.g., S/Steel Pillar Plate, Steel plug, Brass plug, Bolt, G.I. Pipe  
Height of mark..... m. above below G.L. Mark is..... m. above below  
Height of Top Vanes to Top Mark/Pillar plate..... m. Diameter of Vanes (vertical)..... m.  
Height of Cairn..... m. Diameter of Cairn..... m. Name Plate found/not found/placed.  
Length of Mast..... m. (approximate if not unpiled)
4. A..... set in conc/rock has been placed/found, bearing.....°M from Mast/Plug/Pillar
5. A..... set in conc/rock has been placed/found, bearing.....°M from Mast/Plug/Pillar
6. A..... set in conc/rock has been placed/found, bearing.....°M from Mast/Plug/Pillar
7. A..... set in conc/rock has been placed/found, bearing.....°M from Mast/Plug/Pillar
8. Action required: *PILLAR NEEDS REPAIRING + PAINTING*

STANDPOINT:

Mark	Direction	Horiz. Distance	Height Difference	Mark	Direction	Horiz. Distance	Height Difference
			above standpt				above standpt
			below standpt				below standpt
			above standpt				above standpt
			below standpt				below standpt
			above standpt				above standpt
			below standpt				below standpt
			above standpt				above standpt
			below standpt				below standpt
			above standpt				above standpt
			below standpt				below standpt

Prepared by: *J. C. M.*

Checked: *[Signature]*

Noted on: *J. M. Carr*

Checked

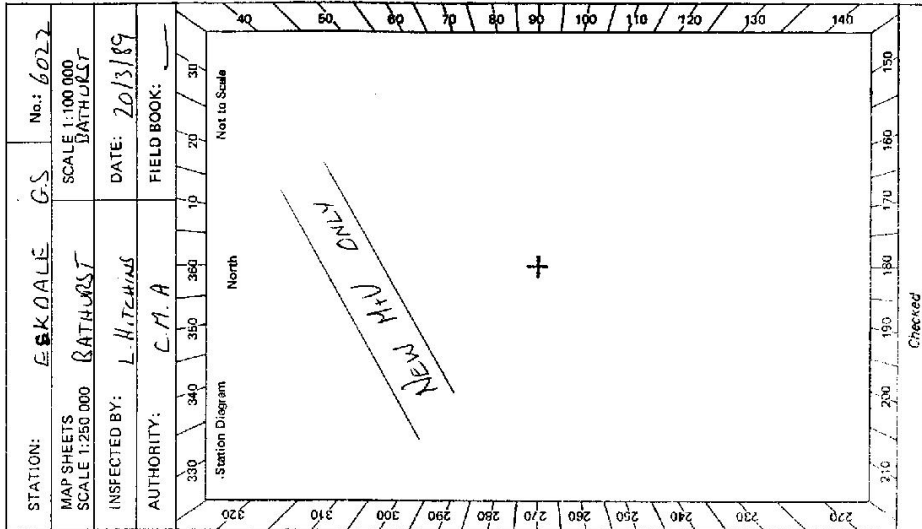

STATION: *ESKDALE GS* No.: *6022*

MAP SHEETS SCALE 1:250 000 *BATHURST* SCALE 1:100 000

INSPECTED BY: *L. H. TEALING* DATE: *20/3/89*

AUTHORITY: *C. M. A* FIELD BOOK:

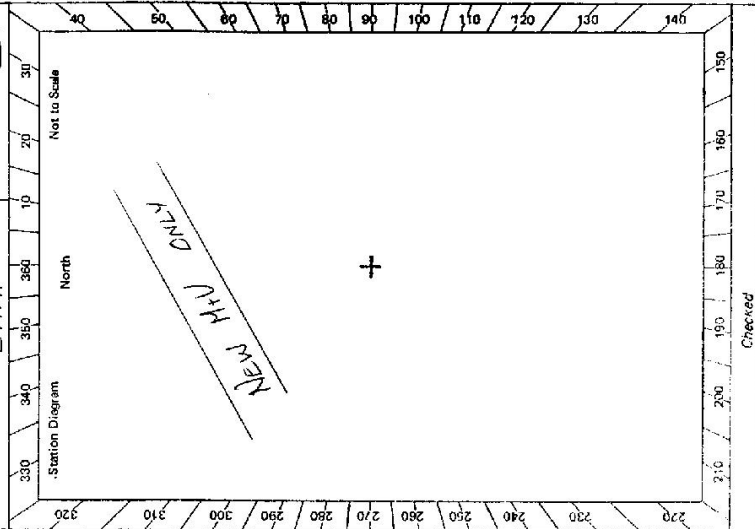

<p>STATION <b>ESKDALE TS 6022</b></p> <p>Owner's Name ..... <b>FORESTRY COMMISSION</b>                  Address ..... <b>Carlisle Barracks, William St                  BATHURST 2295</b>                  Project ..... <b>063 - 312044</b></p> <p>Current Occupant:                  Address:                  Phone:</p> <p>Access Report of <b>26/6/1981</b> was found suitable <del>for</del> <b>ACCESS</b>.</p>	<p>Not to Scale                  0/100                  0/745                  0/685</p> <p style="text-align: center;"><b>NEW MIV PLACED</b></p> <p>This section to be completed by officer constructing pillar.</p> <p>Original station mark found/not found.</p> <p>Description of mark: .....</p> <p>Original beacon found/not found.</p> <p>Description of beacon: .....</p> <p>Height Top of Varies to Top Mark .....m.                  above                  Height of mark .....m. below G.L.                  rock/conc .....m. below</p> <p>Diameter of Varies .....m. Height of Cairn .....m.</p> <p>Original Beacon has/has not been destroyed by me.</p>
	<p>Date</p> <p>Record of Station</p>

LAND INFORMATION CENTRE

GEODETIC SURVEY OF N.S.W.

GEODETIC STATION RECONNAISSANCE and MAINTENANCE REPORT

Description:

1. Cleared by lanes bearing..... *Horizon not visible* ..... from Trig. Mast  
 Note: *Cross out word or words which do not apply*

2. Mast & Vanes have been painted white & black respectively.

3. The ~~station~~/pillar was ~~unpiled~~/not unpiled/~~constructed~~ on *2nd July 1994*, dimensions now being:

Description of mark/~~qs. Pillar. Plates~~ should be explicit, e.g., S/Steel Pillar Plate, Steel plug, Brass plug, Bolt, G.I. Pipe

Height of mark.....m. above rock/concrete; Mark is.....m. above G.L. below

Height of Top Vanes to Top Mark/Pillar plate .....m. Diameter of Vanes (vertical).....m.

Height of Cairn.....m. Diameter of Cairn.....m. Name Plate found/not found/placed.

Length of Mast .....m. (approximate if not unpiled)

4. A. *G.I. Pipe*.....set in conc/~~rock~~ has been ~~above~~/found, bearing, *262*° M from ~~Mast/Plug~~/Pillar

5. A.....set in conc/rock has been placed/found, bearing.....° M from Mast/Plug/Pillar

6. A.....set in conc/rock has been placed/found, bearing.....° M from Mast/Plug/Pillar

7. A.....set in conc/rock has been placed/found, bearing.....° M from Mast/Plug/Pillar

8. Action required: *Pillar mast & vanes in fair condition. No work required. Painting cleaning required for any standpoint: trig.*

STANDPOINT:

Mark	Direction	Horiz. Distance	Height Difference	Mark	Direction	Horiz. Distance	Height Difference
			above standpt.				above standpt.
			below				below standpt.
			above standpt.				above standpt.
			below				below standpt.
			above standpt.				above standpt.
			below				below standpt.
			above standpt.				above standpt.
			below				below standpt.
			above standpt.				above standpt.
			below				below standpt.

Prepared by:

*J. Smith 26/7/94*

Checked:

*C. Meeks 26/7/94*

Noted on U.T.M. Card

Checked

STATION: **ESKDALE (P)** No.: **6072**

MAP SHEET **BATHURST** No.: **BATHURST**

SCALE **1:100000**

INSPECTED BY: **J. SUTTON** DATE: **23 7 94**

AUTHORITY: **LIC** FIELD BOOK: **—**

Station Diagram North

Not to Scale

*New access from Sunny Corner*

Beacon Diagram: 	STATION <b>ESKDALE (P) TS 6022</b>	Owner's Name: <u>FORESTRY COMMISSION</u> Address: ..... Phone: ..... Current Occupant: <u>FORESTRY COMMISSION</u> Address: <u>Mr William A. Beaumont Street, Bathurst 2795</u> Phone: <u>(063) 31-7044</u> ACCESS <u>Through Sunny Corner - ZWD</u>
Kms. 0.0 19.85 28.30 29.60 30.70 32.75 33.30 34.20 35.35 37.00 37.55 37.95 39.85 40.60 43.70 44.20 44.35 44.45	Access Report <u>ok 26.6.1988</u> (was found suitable/ <del>unsuitable</del> ) From Mobil Service Station at Raylen head east on highway towards Lithgow. At signpost 'SUNNY CORNER' turn left off highway & follow bitumen. Pass 'West Mitchell Road' on your left - Store on your right. At road intersection SP 'DARK CORNER' 'SUNNY CORNER' 'BATHURST 37' turn left. Pass 'DAYLIGHT ROAD' to your right. Follow bitumen. Pass Signpost 'CEMETERY' on your left. Go straight ahead. Pass 'BLACKBUTT MOUNTAIN ROAD' on your right. Follow bitumen. Turn left at 'CUPITS ROAD' and follow main road - ignore all side tracks going into pine forest. Pass 'MOUNT SCHOFIELD ROAD' on your left. Straight ahead. At crossroads at end of pine forest - follow main road. Road intersection SP 'SMITHS ROUND HILL TRAIL' on left. Go straight ahead. From this point onwards, ignore all minor tracks going into pine forest. Ignore track on left. Straight ahead along edge of pine forest. Pass track on your left. Straight ahead along edge of pine forest. At road intersection turn half left along 'ESKDALE FOREST ROAD'. Ignore minor tracks to left and right. Pass signpost 'CLEAR CREEK TRAIL' on your left. Straight ahead. Sign 'WATER 100 m' on tree. Follow track to left at signpost 'ESKDALE TRIG'. <u>ESKDALE TRIG 30m on left</u>	Date Record of Station
This section to be completed by officer constructing pillar. Original station mark found/not found. Description of mark: ..... Original beacon found/not found. Description of beacon: ..... Height: Top of Vanes to Top Mark .....m. Height of mark: .....m. above G.L. below Diameter of Vanes .....m. Height of Cairn .....m. Original Beacon has/has not been destroyed by me.		