

CENTRAL MAPPING AUTHORITY  
Department of Lands

Trigonometrical Survey of N.S.W.

RECONNAISSANCE and MAINTENANCE REPORT

This Trig. Station has been:-

Note: Cross out word or words which do not apply

1. Completely cleared to permit 360° vision to surrounding Trigs.
2. Cleared by lances bearing... 32° 0' - 30° M. i. 123° - 133° M. i. 256° - 267° M. from Trig. Mast
3. Trig. Mast & Vanes have been painted white & black respectively.
4. The Trig. was unpiled  
Description of mark... Brass Plug in Rock in Conc. well  
Height of mark... 0.025 m above rock ..... m above G.L.  
Height of Top Vanes to Top Mark... 3.480 m. Diameter of Vanes (vertical) 0.910 m.  
Height of Cairn... m. Diameter of Cairn... m.  
Length of Mast... 3.540 m. (approximate if not unpiled) Hole in Mast base is 0.010 m deep
5. A. G.I. NAIL set in conc/rock has been placed... 7.147 m. bearing... 10° M from Trig. Mast  
Copper
6. A. NAIL set in conc/rock has been placed... 3.572 m. bearing... 260° M from Trig. Mast
7. A. set in conc/soil has been placed... m. bearing... °M from Trig. Mast
8. A. set in conc/rock has been placed... m. bearing... °M from Trig. Mast
9. Connection G.I. Nail to Cu. Nail... 9.035 m. bearing... 212° M
10. Connection... to... m. bearing... °M
11. Connection... to... m. bearing... °M
12. Connection... to... m. bearing... °M
13. Diff. Ht. G.I. Nail... is 0.024 m. above below Trig. Plug
14. Diff. Ht. Copper Nail... is 0.153 m. above below Trig. Plug
15. Diff. Ht. Copper Nail... is 0.128 m. above below G.I. Nail
16. Diff. Ht. ... is ... m. above below

Prepared by: *Shackles* Checked: \_\_\_\_\_

Noted on U.T.M. Card

7.6.98

STATION **WXALDRA TS 5953**

Co: **PHILLIP** Ph: **Wyaldra**

Map Sheet: **DUBBO 1:250,000** No: **SI 55-4**

Inspected by: **H. P. Jackson** Date: **14/1/1975**

Authority **Trig Survey Division** Field Book: **AB1427/28**

Beacon Diagram Not to Scale

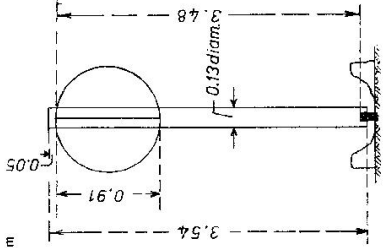

Date

1975 14/1 Unpiled  
1975 17/4 & 1/5 Connections effected  
1975 2/5 Temp Replied

Record of Station

Checked

STATION WYALDRA TS 5953

Owners Name.....  
 Current Occupant.....  
 Address.....  
 Address.....

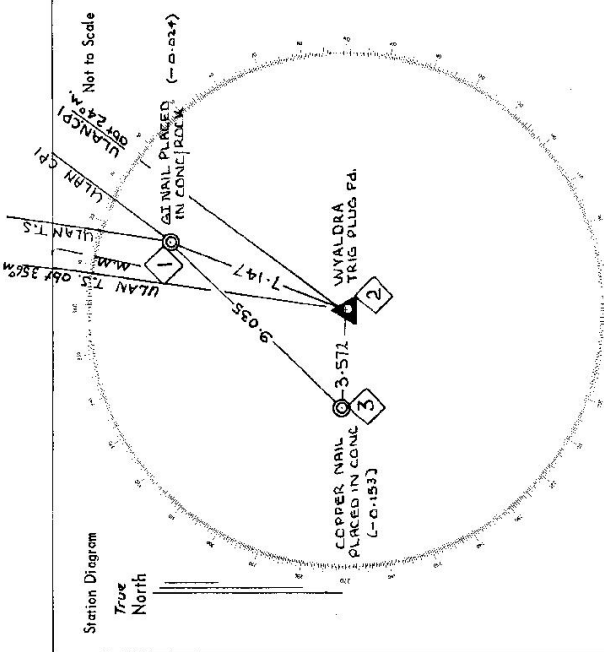
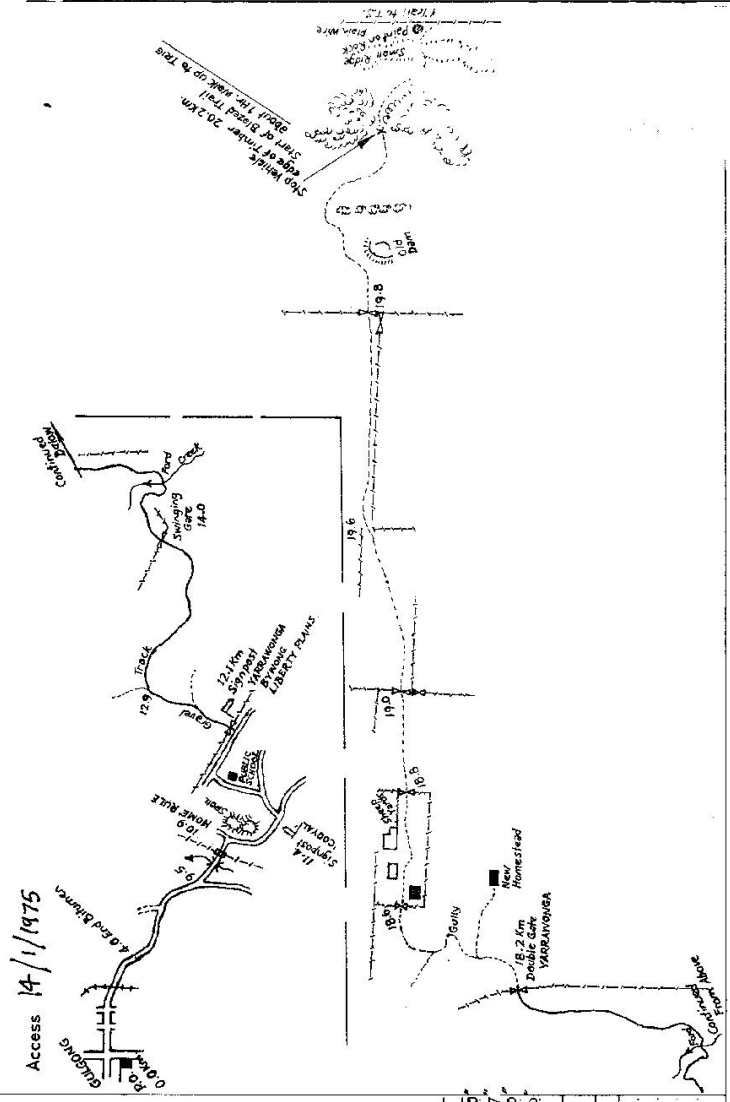

List of Observed Directions:-

Station	Direction	Station	Direction
ULAN T.S.	359.59.60	ULAN T.S.	359.59.60
G.I. NAIL PLACED IN CONC/ROCK	13.21.00	ULAN C.P. 1	28.12.57
ULAN C.P. 1	28.12.11	WYALDRA TRIG. PLUG	193.21.00
Copper NAIL PLACED IN CONC	263.05	Copper NAIL PLACED IN CONC	215.08.00

Standpoint: G.I. NAIL Placed.

CENTRAL MAPPING AUTHORITY  
Department of Lands

Trigonometrical Survey of N.S.W.

RECONNAISSANCE and MAINTENANCE REPORT

STATION Kullup Ph: WYALD K.A.  
No: 8332  
Map Sheet: 8822  
Inspected by: P. BATES Date: 19/19/77  
Authority: E.M.O. Field Book: 1555

This Trig. Station has been:- Note: Cross out word or words which do not apply

1. Completely cleared to permit 360° vision to surrounding Trig.
2. Cleared by lances bearing 32° 11' 13" 133° 43' 71" 163° 41' 28" 228° 11' 275° from Trig. Meet Illaw
3. Trig. Mast & Vanes have been painted white & black respectively.
4. The Trig. was unpiled/~~not unpiled~~, dimensions now being:

Description of mark: concrete with 2 vanes Trig. Mast should be explicit, e.g. Steel plug, Brass plug, Bolt, G.I. Pipe  
Height of mark: 1.375 m above rock/concrete G.L.  
Height of Top Vanes to Top Mark: 1.472 m. illaw Meet Diameter of Vanes (vertical): 0.755 m.  
Height of Cairn: ..... m. Diameter of Cairn: ..... m.

- Length of Mast ..... m. (approximate if not unpiled)
5. Aluminium set in conc./rock has been placed 114 m. bearing 114 from Trig. Meet Illaw
  6. Aluminium set in conc./soil has been placed 3.711 m. bearing 135 from Trig. Meet Illaw
  7. A.L.M. set in conc./soil has been placed 7.715 m. bearing 2 from Trig. Meet Illaw
  8. A. set in conc./rock has been placed ..... m. bearing ..... from Trig. Meet
  9. Connection Aluminium to G.I. Mast: 3.576 m. bearing ..... from Trig. Meet
  10. Connection Aluminium to G.I. Mast: 7.151 m. bearing ..... from Trig. Meet
  11. Connection ..... to ..... m. bearing ..... from Trig. Meet
  12. Connection ..... to ..... m. bearing ..... from Trig. Meet

13. Diff. Ht. Aluminium to G.I. Mast is 3.576 m. above/below  
14. Diff. Ht. Aluminium to Illaw is 1.375 m. above/below  
15. Diff. Ht. G.I. Mast to Illaw is 1.376 m. above/below  
16. Diff. Ht. G.I. Mast to Illaw is ..... m. above/below

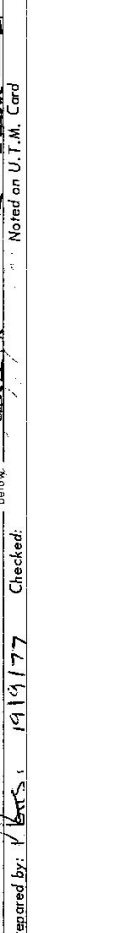

Bencon Diagram  
Date: 19/19/77  
Record of Station: Illaw

Prepared by: P. BATES 19/19/77 Checked: \_\_\_\_\_

STATION WALUKA G.S TS 5953

Owners Name: Tha. Le. R. R. R. Current Occupant: .....

Address: .....

Access 19/9/1977

1400 FEATURE

1500 PC. WISSAGE HEAD EAST ALONG WALKER STREET,

1600 TURN LEFT SIGN WALKER STREET - PASSILLIA

1700 PASS HANG KANG ROAD ON LEFT.

1800 PASS ROAD ON LEFT FOLLOW SIGNLED ROAD TOWARDS JUNG.

1900 PASS ROAD LEAD PO. ON RIGHT

2000 TURN LEFT ONTO KIDDE ROAD.

2100 TURN LEFT 260 METRES THREE END HOUSE.

2200 TURN LEFT THROUGH FENCE OPENING

2300 FOLLOW TRACK ALONG FENCE LINE

2400 LEAVE FIRE IN BOUNDARY FENCE

2500 FOLLOW BOUNDARY FENCE TO TRIP

2600 WALUKA G.S

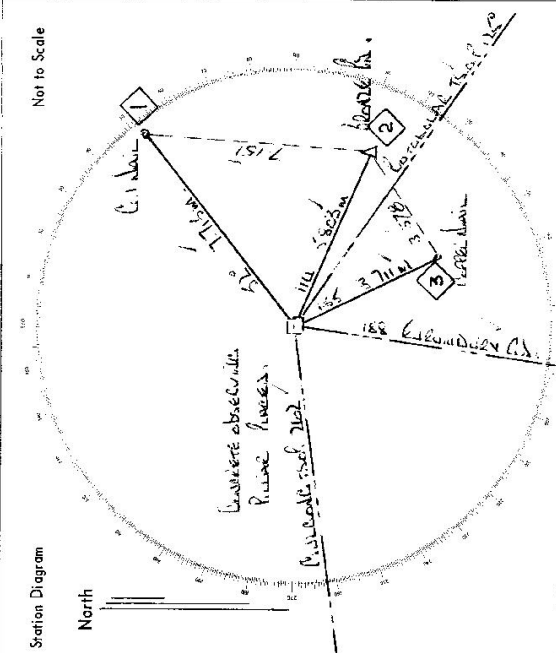

List of Observed Directions:-

Standpoint: WALKER ST Station: WALUKA G.S

Station	Direction	Station	Direction
<u>WALUKA G.S</u>	<u>157 32 00</u>	<u>WALUKA G.S</u>	<u>19 00 00</u>
<u>WALUKA G.S</u>	<u>219 31 20</u>	<u>WALUKA G.S</u>	<u>39 29 45</u>
<u>WALUKA G.S</u>	<u>226 04 30</u>	<u>WALUKA G.S</u>	<u>111 44 30</u>
<u>WALUKA G.S</u>	<u>255 55 35</u>	<u>WALUKA G.S</u>	<u>216 05 00</u>
<u>WALUKA G.S</u>	<u>257 24 50</u>	<u>WALUKA G.S</u>	<u>257 24 00</u>

STATION: **WALDRA G.S.P.** No: **5453**

MAP SHEET SCALE 1:250 000 **Dudhoo**

INSPECTED BY: **P.Potts** DATE: **18.8.81**

AUTHORITY: **C.M.A.** FIELD BOOK: **1825**

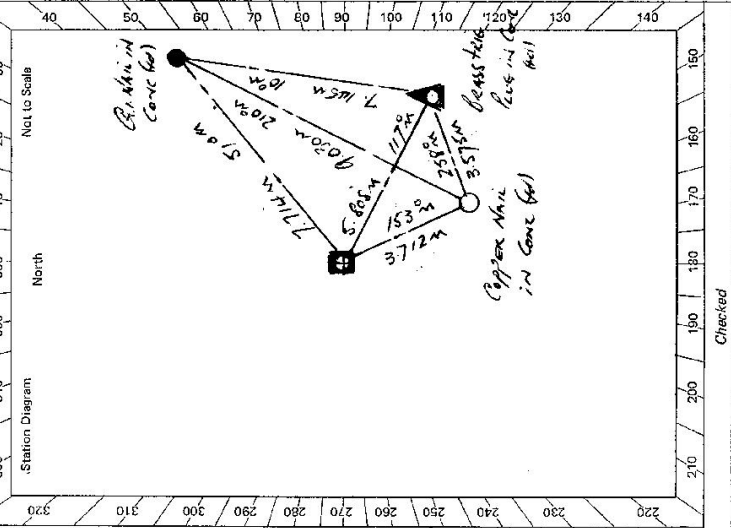

CENTRAL MAPPING AUTHORITY GEODETIC SURVEY OF N.S.W. GEODETIC STATION RECONNAISSANCE and MAINTENANCE REPORT

Description: Note: Cross out word or words which do not apply

- Cleared by lanes bearing **60m to 172m** **182m to 190m** **201m to 220m** **235m to 235m** from Trig. Mast
- Mast & Vanes have been painted white & black respectively. ✓
- The ~~station~~ pillar was unpiled/~~replaced~~/~~constructed~~ on **18th August 1981**, dimensions now being: **56mm** **56mm** **56mm** should be explicit, e.g. S/Steel Pillar Plate, Steel plug, Brass plug, Bolt, G.I. Pipe
- Description of mark: **56mm** **56mm** **56mm** above **rock**/concrete; Mark is **1.490m** above G.L.
- Height of mark **1.380m** Diameter of Vanes (vertical) **0.750m**.
- Height of Top Vanes to Top Mark/Pillar plate **1.465m** Diameter of Cairn **0.750m** Name Plate found/~~replaced~~/placed.
- Height of Cairn **0.750m** Diameter of Cairn **0.750m** Name Plate found/~~replaced~~/placed.
- Length of Mast **0.750m** (approximate if not unpiled)
- A **Brass tube** set in conc/~~rock~~ has been ~~placed~~/found, bearing **117.0°** M from ~~Mast/Plate~~/Pillar
- A **G.I. Nail** set in conc/~~rock~~ has been ~~placed~~/found, bearing **51.0°** M from ~~Mast/Plate~~/Pillar
- A **Copper Nail** set in conc/~~rock~~ has been ~~placed~~/found, bearing **153.0°** M from ~~Mast/Plate~~/Pillar
- A **Brass tube** set in conc/~~rock~~ has been placed/~~found~~, bearing **105.0°** M from Mast/~~Plate~~/Pillar
- Action required: **None**

STANDPOINT:				STANDPOINT:			
Mark	Direction	Horiz. Distance	Height Difference	Mark	Direction	Horiz. Distance	Height Difference
			above standpt.				above standpt.
			below				below
			above standpt.				above standpt.
			below				below
			above standpt.				above standpt.
			below				below
			above standpt.				above standpt.
			below				below
			above standpt.				above standpt.
			below				below
			above standpt.				above standpt.
			below				below

Prepared by: **P.Potts** **20th August** Checked: **Noted on U.T.M. Card**

STATION <b>WALDRA CS (P) TS 5953</b>	Owner's Name: <b>TRIG RESERVE</b> Address: <b>SUBDIVIDED BY BRIMON 61</b> <b>NR N.G. &amp; E. MATHESON</b> <b>17 BALMORAL RD KELLYVILLE</b> Phone: ..... Current Occupant: ..... Address: ..... Phone: .....  Access Report of 18.8.1981 was found suitable/unsuitable. ACCESS KM FEATURE 0.00 BUSY OFFICE MUDGEE HEAD EAST TOWARDS CENTRE OF TOWN 0.27 TURN LEFT ONTO CASSILIS ROAD 0.79 PASS ROAD ON RIGHT TO MOLLAR & BYLONG 28.61 TURN LEFT ONTO "RIDGE ROAD" 31.21 TURN LEFT UP BANK FOLLOW FAINT TRACK 31.33 FENCE OPENING - FOLLOW FAINT TRACK 31.99 WIRE GATE - FOLLOW TRACK 33.17 WALDRA CS(P)
Beacon Diagram Not to Scale	
This section to be completed by officer constructing pillar.	
Original station mark found/not found.	
Description of mark: .....	
Original beacon found/not found.	
Description of beacon: .....	
Height Top of Vanes to Top Mark ..... m.	
Height of mark ..... m. above G.L. below	
Diameter of Vanes ..... m. Height of Cairn ..... m.	
Original Beacon has/has not been destroyed by me.	
Date	Record of Station