

CENTRAL MAPPING AUTHORITY
 Department of Lands
 Triangometrical Survey of N.S.W.
 RECONNAISSANCE and MAINTENANCE REPORT

STATION DOUGLAS CONC PILLAR TS 5923
 Co: DURHAM Ph: BARFORD
 Map Sheet: NEWCASTLE No: 13231
 Inspected by: W. McILVRA Date: 22/6/77
 Authority: CENTRAL MAPPING Field Book: 1405
 Beacon Diagram Not to Scale

- This Trig. Station has been:- Note: Cross out word or words which do not apply
1. Completely cleared to permit 360° vision to surrounding Trigs.
 2. Cleared by lines bearing from Trig. Mast
 3. Trig. Mast & Vanes have been painted white & black respectively.
 4. The Trig. was unpiled/~~not unpiled~~, dimensions now being:
 - Description of mark CONC OBS PILLAR should be explicit, e.g. Steel plug, Brass plug, Bolt, G.I. Pipe
 - Height of mark 0.016 m above PILLAR PLATE rock/concrete
 - Height of Top Vanes to Top Mark 1.425 m
 - Height of PILLAR 1.375 m. Diameter of Cairn m.
 - Length of Mast 1.505 m. (approximate if not unpiled)
 5. BRASS PLUG set in conc/rock has been placed 2.604 m, bearing 183°M from Trig. Mast PILLAR
 6. COPPER NAIL set in conc/soil has been placed 3.587 m, bearing 254°M from Trig. Mast PILLAR
 7. A set in conc/soil has been placed m, bearing°M from Trig. Mast
 8. A set in conc/rock has been placed m, bearing°M from Trig. Mast
 9. Connection COPPER NAIL to PLUG : 3.736 m, bearing 117°M
 10. Connection to m, bearing°M
 11. Connection to m, bearing°M
 12. Connection to m, bearing°M
 13. Diff. Ht. BRASS PLUG is 1.683 m, above PILLAR PLATE
 14. Diff. Ht. COPPER NAIL is 1.594 m, above PILLAR PLATE
 15. Diff. Ht. COPPER NAIL is 0.090 m, above BRASS PLUG
 16. Diff. Ht. is m, above below
- Prepared by: W. McILVRA 18-7-77 Noted on U.T.M. Card
 Checked: S. C. ... 7/2/77

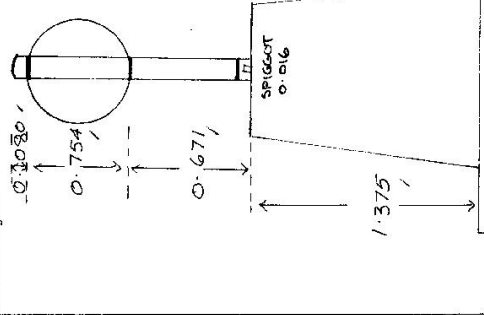

Date: 18/6/77 Record of Station
CONCRETE PILLAR CONSTRUCTED
 Checked: S. C. ... 7/2/77

STATION **DOUGLAS PILLAR TS 5123**

Current Occupant.....

Address.....

Owners Name.....

Address.....

Access **22-6-1977**

- 0.0 Post Office DUNGOG TAKE ROAD TOWARDS MAITLAND
- 7.40 INTERSECTION TAKE PATERSON ROAD
- 14.50 RAIL CROSSING
- 20.70 GRAVEL TRACK ON LEFT.
- 20.75 GATE FOLLOW TRACK TO G.S.
- 24.10 G.S.

Not to Scale

Station Diagram

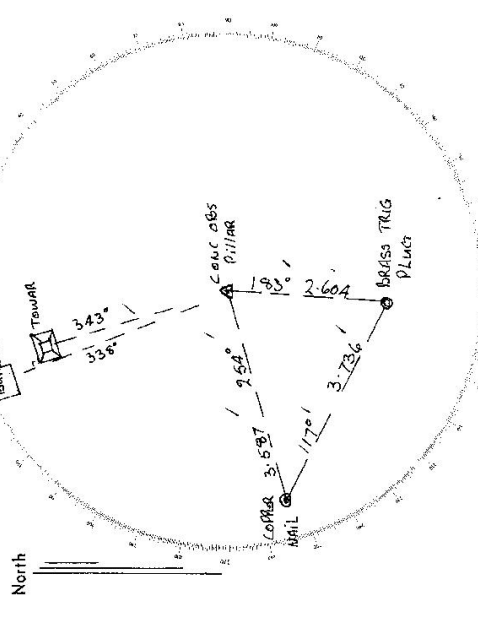

List of Observed Directions:-

Station	Direction	Station	Direction
G.S.	357.59.60	GEORGE G.S.	357.57.60
COPPER NAIL	00.29.30	COPPER NAIL	42.06.25
COALS TON G.S.	54.32.15	COALS TON G.S.	54.32.10
BRASS TRIG PLUG	28.8.12.20	BRASS PILLAR	108.11.30

Standpoint: ~~COAC OBS~~ PILLAR Standpoint: BRASS PLUG

Station	Direction	Station	Direction

