

CENTRAL MAPPING AUTHORITY
Department of Lands

Trigonometrical Survey of N.S.W.

RECONNAISSANCE and MAINTENANCE REPORT

TS 5828

STATION TOOTAWALLIN CONC. OBS. PILLAR

This Trig. Station has been:

Note: Cross out word or words which do not apply

1. Completely cleared to permit 360° vision to surrounding Trigs.
 2. Cleared by lanes bearing from Trig. Mast
 3. Trig. Mast & Vanes have been painted white & black respectively. ✓
CONC. OBS. PILLAR WAS CONSTRUCTED 30-3-77
 4. The Trig. was unplied/not unplied, dimensions now being:
- Description of mark: CONC. OBS. PILLAR should be explicit, e.g. Steel plug, Brass plug, Bolr, G.I. Pipe
SPICET PILLAR PLATE
Height of Mast: 0.015 m above red/concrete 1.375 m above G.L.
- Height of Top Vanes to Top Mark: 1.055 m Diameter of Vanes (vertical) 0.755 m.
PILLAR
Height of Mast: 1.370 m. Diameter of Mast:

5. A COPPER NAIL set in conc./rock has been placed 3.682 m, bearing 273° from Trig. Mast PILLAR
6. A G.I. PIPE set in conc./rock has been placed 5.588 m, bearing 35° from Trig. Mast PILLAR
7. A TRIG. PLUG set in rock/soil has been placed 2.644 m, bearing 309° from Trig. Mast PILLAR
8. A set in conc./rock has been placed m, bearing° from Trig. Mast
9. Connection COPPER NAIL TO G.I. PIPE : 8.978 m, bearing 46°
10. Connection COPPER NAIL TO TRIG. PLUG : 3.411 m, bearing 20°
11. Connection G.I. PIPE TO TRIG. PLUG : 6.087 m, bearing 240°
12. Connection to m, bearing°
13. Diff. Ht. COPPER NAIL is 1.343 m. above / below PILLAR PLATE
14. Diff. Ht. G.I. PIPE is 1.714 m. above / below PILLAR PLATE
15. Diff. Ht. TRIG. PLUG is 1.918 m. above / below PILLAR PLATE
16. Diff. Ht. COPPER NAIL is 0.372 m. above / below G.I. PIPE

Prepared by: H.C. BORDER Checked:

Noted on U.T.M. Card

Co: CAMDEN
Map Sheet: KIAMA NORTH
No: 902B
Inspected by: H.C. BORDER
Date: 31-3-77
Authority: C.M.A.
Field Book: O1410

Beacon Diagram

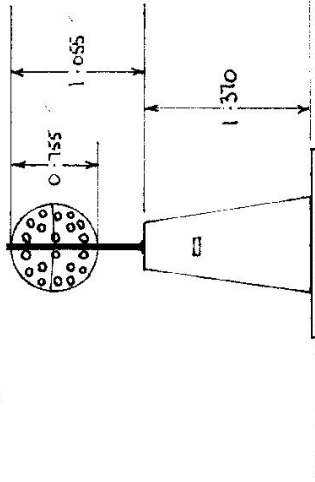

Date

Record of Station

Checked

CENTRAL MAPPING AUTHORITY

GEODETIC SURVEY OF N.S.W.

GEODETIC STATION RECONNAISSANCE and MAINTENANCE REPORT

- Description: *Note: Cross out word or words which do not apply*
1. Cleared by lanes bearing..... from Trig. Mast
 2. Mast & Vanes have been painted white & black respectively. ✓
 3. The station/pillar was unpiled/not unpiled/constructed on.....19..... dimensions now being:
 - Description of mark.....should be explicit, e.g., S/Steel Pillar Plate, Steel plug, Brass plug, Bolt, G.I. Pipe
 - Height of mark.....m. ^{above} rock/concrete; Mark is.....m. ^{above} G.L.
 - Height of Top Vanes to Top Mark/Pillar plate.....m. Diameter of Vanes (vertical).....m.
 - Height of Cairn.....m. Diameter of Cairn.....m. Name Plate found/~~not found~~/placed.
 - Length of Mast.....m. (approximate if not unpiled)
 4. A.....set in conc/rock has been placed/found, bearing.....° M from Mast/Plug/Pillar
 5. A.....set in conc/rock has been placed/found, bearing.....° M from Mast/Plug/Pillar
 6. A.....set in conc/rock has been placed/found, bearing.....° M from Mast/Plug/Pillar
 7. A.....set in conc/rock has been placed/found, bearing.....° M from Mast/Plug/Pillar
 8. Action required:..... **KIAMA**
 Stat. Topo

STANDPOINT:

Mark	Direction	Horiz. Distance	Height Difference	Mark	Direction	Horiz. Distance	Height Difference
			above standpt				above standpt
			below				below
			above standpt				above standpt
			below				below
			above standpt				above standpt
			below				below
			above standpt				above standpt
			below				below
			above standpt				above standpt
			below				below
			above standpt				above standpt
			below				below

Prepared by: *[Signature]* 231 Checked: *[Signature]*
 Note on U.T.M. Card

STATION: **TOOTA WALLIN (P)** No: **5828**

MAP SHEET SCALE 1:250 000 **Wallongens**

INSPECTED BY: **A. Sivertsen** DATE: **8-1-79**

AUTHORITY: **CMA** FIELD BOOK: **1723**

Station Diagram

Checked

STATION TOOTAWALLIN TRIG PLUG NS 5828

Owners Name.....
 Current Occupant.....
 Address.....
 Address.....

Access 30-3-1977.

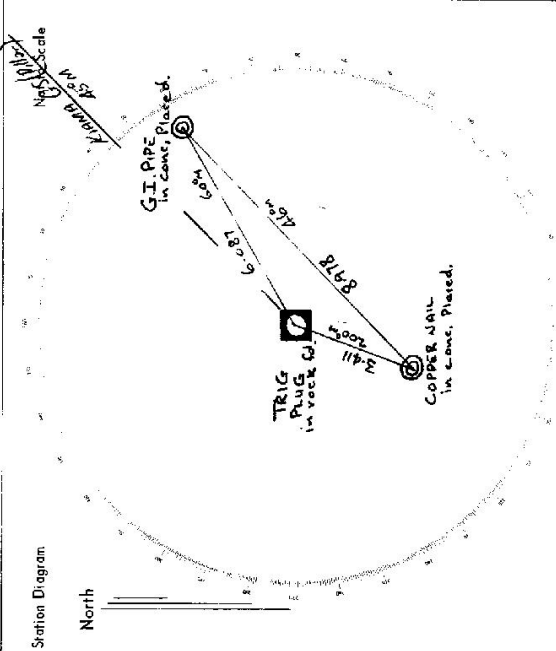

List of Observed Directions:-

Standpoint: TRIG PLUG 30-3-77		Standpoint: TRIG PLUG 31-3-77	
Station	Direction	Station	Direction
KIAMA OP	0 00 00	KIAMA OP	0 00 00
G.I. PIPE in conc. Placed	14 06 10	G.I. PIPE in conc. Placed	14 06 25
CONC. OBS. PILLAR Placed	80 58 20	CONC. OBS. PILLAR Placed	80 58 35
COOKADGATTA OP	149 18 20		
COPPER NAIL in conc. Placed	154 18 40	COPPER NAIL in conc. Placed	154 18 20
STOCKYARD OP	218 39 15	STOCKYARD OP	218 39 10

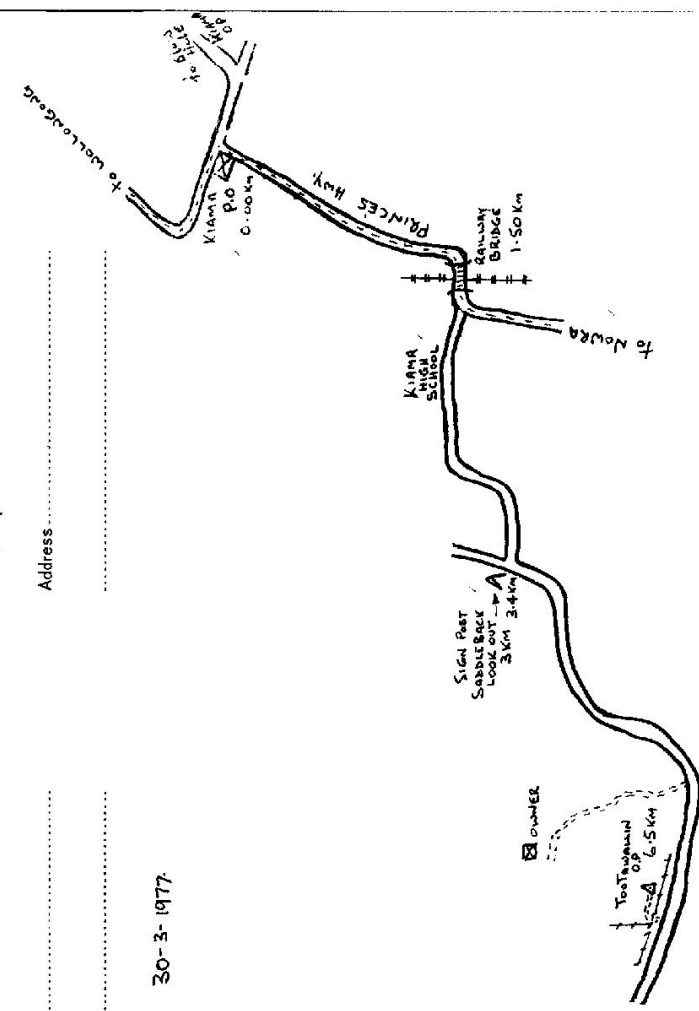

CENTRAL MAPPING AUTHORITY

GEODETIC SURVEY OF N.S.W.

GEODETIC STATION RECONNAISSANCE and MAINTENANCE REPORT

Description:

Note: Cross out word or words which do not apply

1. Cleared by lanes bearing..... Clear for cars 39.7° - 72° from Trig. Mast
2. Mast & Vanes have been painted white & black respectively ✓
3. The station/pillar was unplugged/not unplugged/constructed on..... 19..... dimensions now being:

Description of mark..... should be explicit, e.g., S/Steel Pillar Plate, Steel plug, Brass plug, Bolt, G.L. Pipe
 Height of mark..... m. ^{above} rock/concrete; Mark is..... m. ^{above} G.L.
 Height of Top Vanes to Top Mark/Pillar plate..... m. Diameter of Vanes (vertical)..... m.
 Height of Cairn..... m. Diameter of Cairn..... m. Name Plate found/not found/placed.
 Length of Mast..... m. (approximate if not unplugged)

4. A..... TRIG. PLUG set in conc/rock has been placed/found, bearing..... ° M from Mast/Plug/Pillar
5. A..... CU. NAIL set in conc/rock has been placed/found, bearing..... ° M from Mast/Plug/Pillar
6. A..... GI PIPE set in conc/rock has been placed/found, bearing..... ° M from Mast/Plug/Pillar
7. A..... set in conc/rock has been placed/found, bearing..... ° M from Mast/Plug/Pillar
8. Asbestos required for Terry Callagher Does not want the pillar removed, he wants it to be part of his yard and names his land after it. Will see over the roof or STANDPOINT: THE HOUSE IT WILL BE ON AN

Owner's Name: MR. TERRY CALLAGHER
 Address: SADDLEBACK RD
VIA KIAMA
 Phone: 42321588
 Fax: 42321597

Prepared by: GAZAL 23/6/00 Checked: _____

Noted on U.T.M. Card

STATION: TOOTAWALLIN (P) No: 5828
 MAP SHEET SCALE 1:250 000 WOLLONGONG
 INSPECTED BY: G. FORD DATE: 7/1/2000
 AUTHORITY: L. I.C. FIELD BOOK: 1943

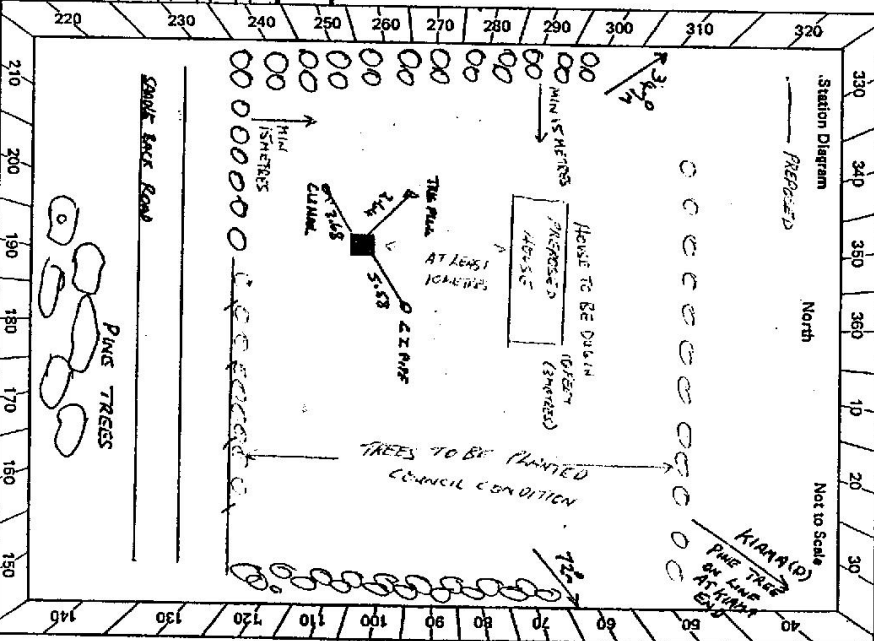

58 2733-1