

CENTRAL MAPPING AUTHORITY
Department of Lands

Trigonometrical Survey of N.S.W.

RECONNAISSANCE and MAINTENANCE REPORT

This Trig. Station has been:-

Note: Cross out word or words which do not apply

- 1. Completely cleared to permit 360° vision to surrounding Trigs. ✓
- 2. Cleared by lanes bearing from Trig. Mast
- 3. Trig. Mast & Vanes have been painted white & black respectively. ✓
- 4. The Trig. was unpiled/~~not unpiled~~, dimensions now being: Original Station Mark found / ~~not found~~

Description of mark... CONCRETE CONCRETE CONCRETE CONCRETE should be explicit, e.g. Steel plug, Brass plug, Bolt, G.I. Pipe
 Height of ~~mark~~ ^{plug} m above rock/concrete m above G.L.
 Height of Top Vanes to Top ~~Mark~~ ^{Plug} m. Diameter of Vanes (vertical) 0.755 m.
 Height of ~~Cairn~~ ^{Solent} m. Diameter of Cairn m.

- Length of Mast m. (approximate if not unpiled)
- 5. Ball Ball set in conc/~~set~~ has been ~~placed~~ ^{found} 7.410 m. bearing 200°M from Trig. Mast PILLAR
- 6. Cross Wall set in conc/~~set~~ has been placed 10.075 m. bearing 74°M from Trig. Mast PILLAR
- 7. A.P.M. Mark set in conc/~~set~~ has been ~~placed~~ ^{found} 27.778 m. bearing 150°M from Trig. Mast PILLAR
- 8. A set in conc/rock has been placed m. bearing°M from Trig. Mast

- 9. Connection Ball Ball to Cross Wall : 17.40 m. bearing 120°M
- 10. Connection to m. bearing°M
- 11. Connection to m. bearing°M
- 12. Connection to m. bearing°M
- 13. Diff. Ht. Cross Wall Station Ball Ball is 130.3 m. ~~above~~ ^{below} Ball Ball Plate
- 14. Diff. Ht. Cross Wall Plate is 176 m. ~~above~~ ^{below} Ball Ball Plate
- 15. Diff. Ht. Ball Ball Plate is 1.688 m. ~~above~~ ^{below} Ball Ball Plate
- 16. Diff. Ht. Cross Wall Plate is 1.7 m. ~~above~~ ^{below} Ball Ball Plate

Prepared by:

Checked:

Noted on U.T.M. Card

STATION CLOUDY HEAD TS 5821
 Co: MRC 60000
 Map Sheet: 60000
 Inspected by: L. R. HOWES
 Authority: L. R. HOWES
 No: 9434-11-11
 Date: 5th March 1977
 Field Book: 11390

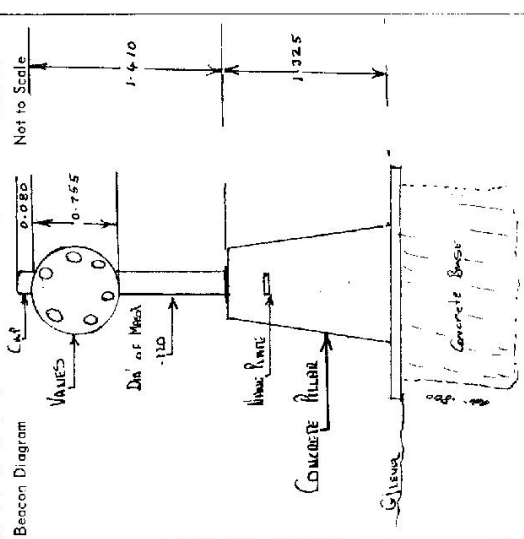

Beacon Diagram
 Date
 Record of Station
 Checked

<p>STATION Cannon Head FS 5821</p> <p>Current Occupant: The Registrar, District</p> <p>Address: Salford, Salford, Greater Manchester, M6 6PU, U.K.</p> <p>Access 5th March 1977</p> <p>MILKWAYS FERRULE 0-00 HAMILTON P.O. TRUNK EMER 0-10 TURN RIGHT SWD CROWN HEAD BRMS 7-20 TURN RIGHT INTO DESERTY ST CANNON HEAD 7-00 TURN RIGHT. TERMINABLE TO LIGHT HOUSE 7-70 HEROIC STATION</p> <p><u>NOTE</u> TURN TO BE NORMAL COAL.</p>	<p>Owners Name:</p> <p>Address:</p> <p>Access 5th March 1977</p> <p>MILKWAYS FERRULE 0-00 HAMILTON P.O. TRUNK EMER 0-10 TURN RIGHT SWD CROWN HEAD BRMS 7-20 TURN RIGHT INTO DESERTY ST CANNON HEAD 7-00 TURN RIGHT. TERMINABLE TO LIGHT HOUSE 7-70 HEROIC STATION</p> <p><u>NOTE</u> TURN TO BE NORMAL COAL.</p>
--------------------------------------------------------------------------------------------------------------------------------------------------------------------------------------------------------------------------------------------------------------------------------------------------------------------------------------------------------------------------------------------------------------------------------------------------------------------------------------------------------------------------------------------------------------------------	------------------------------------------------------------------------------------------------------------------------------------------------------------------------------------------------------------------------------------------------------------------------------------------------------------------------------------------------------------------------------------------------------------------------------------------------------------

Station Diagram

List of Observed Directions:-

Station	Concrete Observations	Direction	Station	Concrete Observations	Direction
Hamilton G.S.	0	00	Hamilton G.S.	0	00
Crown Hill (Road)	137	14	Diamond Hill G.S.	147	18
Crown Hill (Road)	138	08	Crown Hill (Road)	143	00
Public Works Survey, March 6	146	21	Public Works Survey, March 6	147	25
Concrete Central Drill Hole	324	01	Public Works Survey	149	30

CENTRAL MAPPING AUTHORITY
Department of Lands

Trigonometrical Survey of N.S.W.

RECONNAISSANCE and MAINTENANCE REPORT

This Trig. Station has been:-

Note: Cross out word or words which do not apply

1. Completely cleared to permit 360° vision to surrounding Trigs.
2. Cleared by lances bearing Blocked by Lighthouse early from Trig. Mast
3. Trig. Mast & Vanes have been painted white & black respectively. → End Cap needs replacing.
4. The Trig. was unpiled/~~net-empted~~, dimensions now being: ()

Description of mark..... Conc. Piler..... should be explicit, e.g. Steel plug, Brass plug, Bolt, G.I. Pipe
 Height of mark..... m above below rock/concrete m above below G.L.
 Height of Top Vanes to Top Mark..... m. Diameter of Vanes (vertical)..... m.

Height of Cairn..... m. Diameter of Cairn..... m.

Length of Mast..... m. (approximate if not unpiled)

5. A. No. 38 set in conc/~~rock~~ has been placed bound 27.792 m. bearing 17° from Trig. Mast
6. A..... set in conc/soil has been placed..... m. bearing.....°M from Trig. Mast
7. A..... set in conc/soil has been placed..... m. bearing.....°M from Trig. Mast
8. A..... set in conc/rock has been placed..... m. bearing.....°M from Trig. Mast

9. Connection..... to..... m. bearing.....°M
10. Connection..... to..... m. bearing.....°M
11. Connection..... to..... m. bearing.....°M
12. Connection..... to..... m. bearing.....°M

13. Diff. Ht. PWD Mark No 38 is 1.691 m. ~~above~~ below Piler Plate
14. Diff. Ht. is..... m. ^{above} _{below}
15. Diff. Ht. is..... m. ^{above} _{below}
16. Diff. Ht. is..... m. ^{above} _{below}

Prepared By: [Signature] 28.7.77 Checked: [Signature]

Noted on U.T.M. Card

STATION CROWDY GS (Piler) YS 5821
 Co: Macquarie Ph: Harrington
 Map Sheet: CAMDEN HAVEN No: 9434
 Inspected by: P. Chen Date: 25.7.77
 Authority: CMAA Field Book: 1564
 Beacon Diagram: Not to Scale

Date _____ Record of Station _____

CENTRAL MAPPING AUTHORITY GEODETIC SURVEY OF M.S.W.
GEODETIC STATION RECONNAISSANCE and MAINTENANCE REPORT
 STATION: **CRAWFORD (C)** No.: **5821**
 MAP SHEET: **HPS110005**
 SCALE: **1:250 000**
 INSPECTED BY: **C PAPAKES** DATE: **28/8/81**
 AUTHORITY: **C.M.A.** FIELD BOOK: **1913**

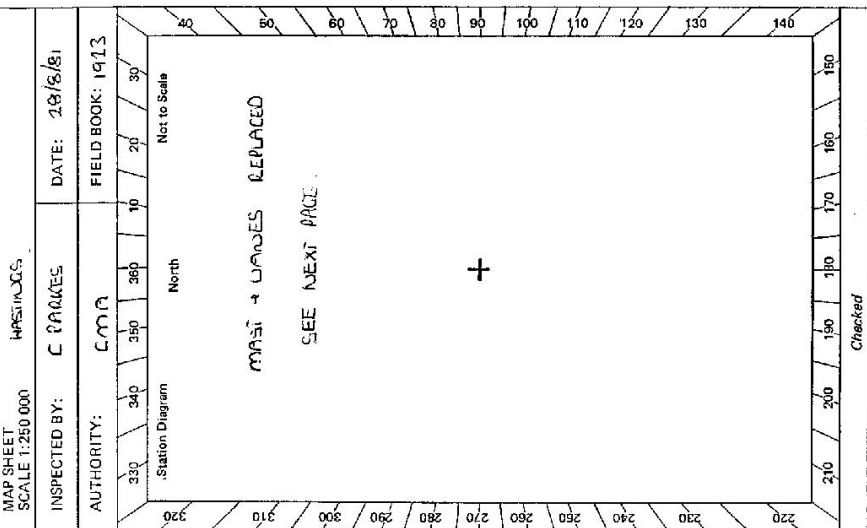

Description:
 1. Cleared by lances bearing **60** to **27** from Trig. Mast
 Note: Cross out word or words which do not apply
 2. Mast & Vanes have been painted white & black respectively. ✓
 3. The station/pillar was unpiled/not unpiled/constructed on **19**, dimensions now being:
 Description of mark **S/S Pillar** should be explicit, e.g., S/Steel Pillar Plate, Steel plug, Brass plug, Bolt, G.I. Pipe
 Height of mark **1.32** m. ^{above} ~~below~~ **feet/concrete**; Mark is **1.42** m. ^{above} ~~below~~ G.L.
 Height of Top Vanes to Top ~~Mark~~ Pillar plate **1.45** m. Diameter of Vanes (vertical) **0.76** m.
 Height of Cairn **0** m. Diameter of Cairn **0** m. Name Plate found/~~not found~~/placed.
 Length of Mast **0** m. (approximate if not unpiled)
 4. A **0** set in conc/rock has been placed/found, bearing **0** M from Mast/Plug/Pillar
 5. A **0** set in conc/rock has been placed/found, bearing **0** M from Mast/Plug/Pillar
 6. A **0** set in conc/rock has been placed/found, bearing **0** M from Mast/Plug/Pillar
 7. A **0** set in conc/rock has been placed/found, bearing **0** M from Mast/Plug/Pillar
 8. Action required: **0**

STANDPOINT:

Mark	Direction	Horiz. Distance	Height Difference	Mark	Direction	Horiz. Distance	Height Difference
			^{above} below standpt.				^{above} below standpt.
			^{above} below standpt.				^{above} below standpt.
			^{above} below standpt.				^{above} below standpt.
			^{above} below standpt.				^{above} below standpt.
			^{above} below standpt.				^{above} below standpt.
			^{above} below standpt.				^{above} below standpt.
			^{above} below standpt.				^{above} below standpt.
			^{above} below standpt.				^{above} below standpt.

STANDPOINT:

Prepared by: **C PAPAKES** Checked: **MS** Noted on U.T.M. Card
 Checked: **MS**

Station Diagram North Not to Scale
 MAST & VANES REPLACED
 SEE NEXT PAGE
 +
 Checked

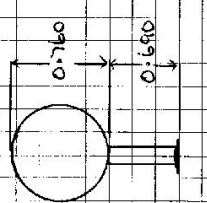
ST 2733-2 D. West, Government Printer Beacon Diagram	Not to Scale 	STATION CROWN-1 (P) TS-5821 Owner's Name: ASSISTANT DIRECTOR Address: SURFACE OPERATIONS P.O. BOX 308 MILSENS Ptent 2061 Phone: ACCESS Access Report of 5/2/1977 was found suitable/ unsuitable . 0.00 HARRINGTON RD. TRAVEL EAST. 0.10 TURN RIGHT SIGN CROWN HEAD. 7-26 TURN RIGHT INTO DEBORAH ST CROWN HEAD. 7.60 TURN RIGHT TRAVELLING TO LIGHTHOUSE. 7.70 CROWN G.S. of.
This section to be completed by officer constructing pillar. Original station mark found/not found. Description of mark: Original beacon found/not found. Description of beacon: Height Top of Vanes to Top Markm. Height of markm. above rock/concm. below G.L. Diameter of Vanesm. Height of Cairnm. Original Beacon has/has not been destroyed by me.		Current Occupant: Address: Phone: Date Record of Station

LAND INFORMATION CENTRE

GEODETIC SURVEY OF N.S.W.

GEODETIC STATION RECONNAISSANCE and MAINTENANCE REPORT

STATION: **CROWDY (P)**
 MAP SHEET SCALE 1:250 000
 INSPECTED BY: **J. SUTTON**
 No.: **5821**
CAMDEN HAVEN
 DATE: **5 AUG. 1992**
 FIELD BOOK: **Z108**

Description: *Note: Cross out word or words which do not apply*

1. Cleared by lanes bearing **60°M** to **27°M** from Trig. Mast
2. Mast & Vanes have been painted white & black respectively.
3. The ~~station~~ pillar was unpiled/~~found~~ on **5th August 1992**, dimensions now being: **Stainless Steel Pillar Plate** should be explicit, e.g. S/Steel Pillar Plate, Steel plug, Brass plug, Bolt, G.I. Pipe
 Height of mark **1.315** m. above ~~rock~~/concrete; Mark is **1.78** m. above G.L.
 Height of Top Vanes to Top ~~mark~~/Pillar plate **1.450** m. Diameter of Vanes (vertical) **0.590** m.
 Height of Cairn **1.54** m. Diameter of Cairn **0.150** m. Name Plate found/~~not found~~
4. A **C.V. Nail** set in conc/~~rock~~ has been ~~placed~~/found, bearing **7**° M from ~~Mark/Plug~~/Pillar
5. A **P.W.D. Survey Markset** in conc/~~rock~~ has been ~~placed~~/found, bearing **16**° M from ~~Mark/Plug~~/Pillar
6. A **Light house** set in conc/~~rock~~ has been ~~placed~~/found, bearing **56**° M from ~~Mark/Plug~~/Pillar
7. A **Drillhole (Original)** in conc/~~rock~~ has been ~~placed~~/found, bearing **199**° M from ~~Mark/Plug~~/Pillar
8. Action required: **N/A**

STANDPOINT: CROWDY Pillar Plate		STANDPOINT:					
Mark	Direction	Horiz. Distance	Height Difference	Mark	Direction	Horiz. Distance	Height Difference
Stewart (P)	0° 00' 00"		above standpt. below				above standpt. below
Cu Nail in Conc fl.	56° 13' 02"	10.081	below standpt.				above standpt. below
P.W.D. Svy Mk. fl.	64° 55' 01"	27.779	below				above standpt. below
Light house (Firmal)	104° 54' 25"	16.471	above standpt.				above standpt. below
Drillhole (Original) Conc fl.	199° 48' 14"	7.412	below				above standpt. below

Prepared by: *J. Sutton* 8.8.92 Checked: *J. Sutton*
 Noted on U.T.M. Card
 S: 2735-1

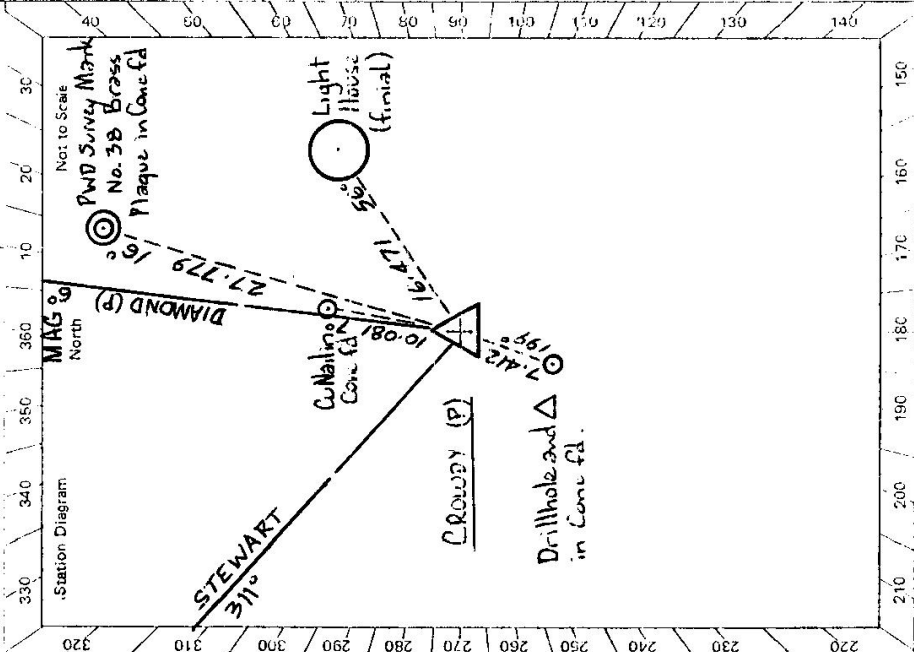

STATION **CROWDY (P) TS 5821**

Owner's Name: *The Assistant Director*
 Current Occupant: *Attn: NDE, Surface Operations*
 Address: *P.O. BOX 308*
Milsons Point 2061
 Phone: *5-8-9992*

CONVENTIONAL DRIVE ACCESS *5-8-9992*

Access Report of *5.3/19.7.7* was found ~~unsuitable~~.

0.00 At Harrington Post Office, drive South along Pilot Street.
0.05 Turn left. Signposted 'Crowdy Head' and 'Pilot Hill Lookout'.
7.05 Turn right into Deborah Street at Crowdy Head.
7.40 Turn right, travel to Light House.
7.60 Geodetic Station.

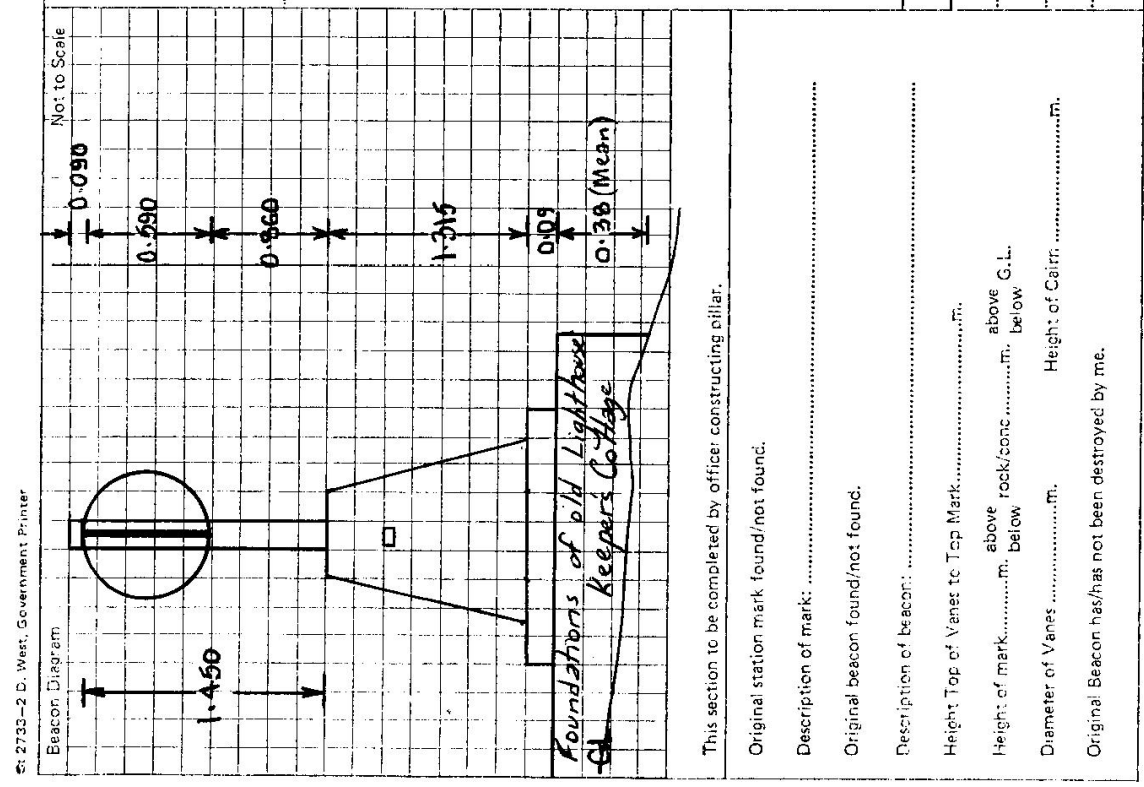

Date	Record of Station