

7488

Trigonometrical Survey of N.S.W.

Department of Lands

RECONNAISSANCE and MAINTENANCE REPORT

This Trig. Station has been:-

Note: Cross out word or words which do not apply

1. Completely cleared to permit 360° vision to surrounding Trig.
2. Cleared by lanes bearing FAIRWAY LOOKOUT OWN FIRE ROSE from Trig. Mast
3. Trig. Mast & Vanes have been painted white & black respectively. ✓
4. The Trig. was unpiled/~~not unpiled~~, dimensions now being:
 Description of mark... CONCRETE ABS. PILLAR ✓ should be explicit, e.g. Steel plug, Brass plug, Bolt, G.I. Pipe
 Height of MARK... 1.340 m above RECK/CONCRETE m above below
 Height of Top Vanes to Top MARK... 1.425 m. Diameter of Vanes (vertical) : 755 m.
 Height of SPICER... 0.015 m. Diameter of Cairn m.

Length of Mast m. (approximate if not unpiled)

5. ABS. PIN set in conc/RECK has been placed. 2.999 m. bearing 228 °M from Trig. Mast

6. S.S.M. set in conc/SOIL has been placed. 3.607 m. bearing 266 °M from Trig. Mast

7. A..... set in conc/SOIL has been placed..... m. bearing..... °M from Trig. Mast

8. A..... set in conc/ROCK has been placed..... m. bearing..... °M from Trig. Mast

9. Connection. RECK to S.S.M. : 2.132 m. bearing 323 °M

10. Connection..... to..... :..... m. bearing..... °M

11. Connection..... to..... :..... m. bearing..... °M

12. Connection..... to..... :..... m. bearing..... °M

13. Diff. Ht. RECK Trig. P. is 1870 m. RECK RECK

14. Diff. Ht. S.S.M. W.LONG is 1222 m. RECK RECK

15. Diff. Ht. RECK TRIG. is 649 m. RECK S.S.M.

16. Diff. Ht. is m. above below

Prepared by: WAO

Checked:

Noted on U.T.M. Card

Checked

STATION COLLIMBATTI (PILLAR) G.S.

Co: DUDLEY Ph: HICKEY

Map Sheet: MACKSVILLE SOUTH No: 3436-S

Inspected by: L.R. HOUSS ✓ Date: 30 November 76

Authority C.M.A. Field Book: 01533 ✓

Beacon Diagram

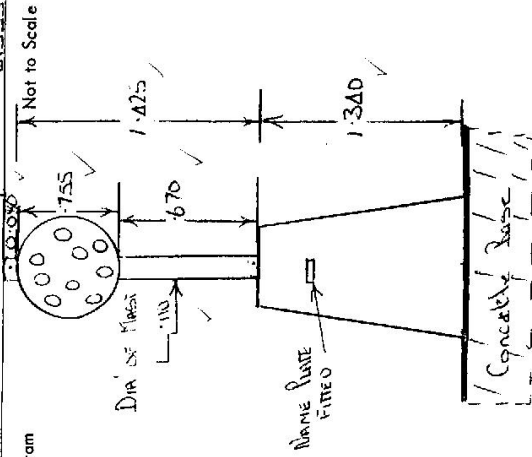

Date

Record of Station

21/1/76 Cone Pillar constructed.

STATION **COLLOMBATI (PILLAR) G.S.**

TS-5619

Owners Name.....
 Current Occupant..... **FORESTRY**

Address.....
 Address..... **KENPETA OFFICE**

3-11-1976
FEATURE
 KILLERAGAL P.O AND GENERAL STORE TOWARDS KENPETA ✓
 TOWN LEFT ON TO DAI W ✓
 TOWN LEFT ✓
 GRID ✓
 GRID ✓
 GRID ✓
 GRID ✓
 TALL LIGHT HOUSE TRACT SORAVALLI W ✓
 MUNGAY CREEK ✓
 PASS HOUSE W ✓
 TOWN RIGHT ✓
 TOWN LEFT PASSAVALLI FOREST OFFICE W ✓
 TOWN RIGHT SIDE COLLOMBATI LOOK-OUT ✓
 TALL ✓

Access
 0:00
 1:45
 5:10
 7:25
 8:50
 8:50
 9:40
 9:45
 10:30
 11:00
 12:40
 12:50
 13:40
 14:40

Station Diagram
 Not to Scale

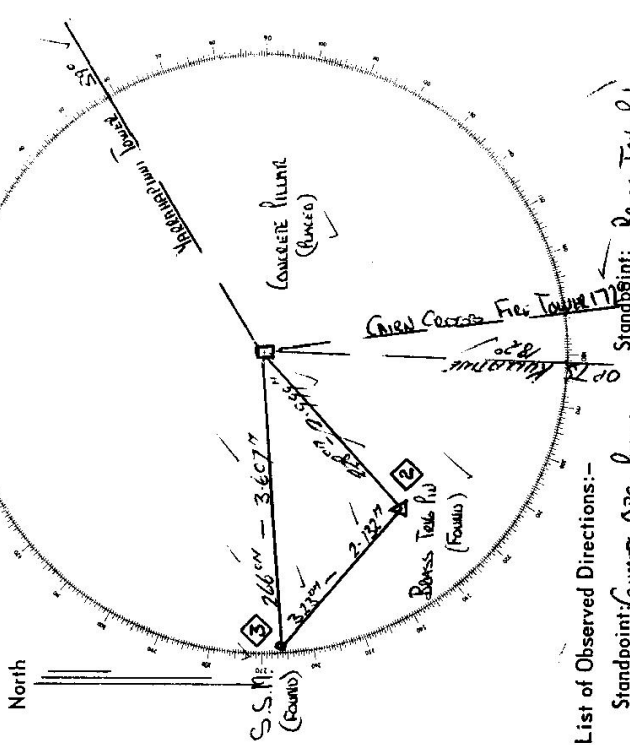

List of Observed Directions:-

Station	Direction	Station	Direction
KULLATHINE T.S. OP	0 00 00	KULLATHINE T.S. OP	19 00 00
BOSS TALK P.O. (FOUND)	50 35 40	S.S.M. P.O. CANT	142 57 40
S.S.M. P.O. CANT	86 47 20	BOSS TALK P.O.	130 37 30
YARATHIRAMANI TOWER	234 02 10	KARATHIRAMANI TOWER	259 02 30
GREEN CROSS FIRE TOWER	1351 18 20	GREEN CROSS FIRE TOWER	251 18 30

Standpoint: **CONCRETE PILLAR**
 Standpoint: **BOSS TALK P.O.**

CENTRAL MAPPING AUTHORITY
Department of Lands

Trigonometrical Survey of N.S.W.

RECONNAISSANCE and MAINTENANCE REPORT

STATION

TS- 5619

COLLONBATTI (C.P.)

This Trig. Station has been:-

Note: Cross out word or words which do not apply

1. Completely cleared to permit 360° vision to surrounding Trigs.
2. Cleared by limes bearing..... from Trig. Mast
3. Trig. Mast & Vanes have been painted white & black respectively.
4. The Trig. was unpiled/not unpiled, dimensions now being:

Description of mark..... should be explicit, e.g. Steel plug, Brass plug, Bolt, G.I. Pipe
 Height of mark..... m above below rock/concrete..... m above below G.L.
 Height of Top Vanes to Top Mark..... m Diameter of Vanes (vertical)..... m.
 Height of Cairn..... m. Diameter of Cairn..... m.

Length of Mast..... m. (approximate if not unpiled)

5. A..... set in conc/rock has been placed..... m. bearing.....°M from Trig. Mast
6. A..... set in conc/soil has been placed..... m. bearing.....°M from Trig. Mast
7. A..... set in conc/soil has been placed..... m. bearing.....°M from Trig. Mast
8. A..... set in conc/rock has been placed..... m. bearing.....°M from Trig. Mast

No change.

9. Connection..... to..... m. bearing.....°M

10. Connection..... to..... m. bearing.....°M

11. Connection..... to..... m. bearing.....°M

12. Connection..... to..... m. bearing.....°M

13. Diff. Ht. is..... m. above below

14. Diff. Ht. is..... m. above below

15. Diff. Ht. is..... m. above below

16. Diff. Ht. is..... m. above below

Prepared by:

Checked:

Noted on U.T.M. Card

Co: DUDLEY

Phi: HICKLEY

Map Sheet: WILLAWARRIN 1:25000

No:

Inspected by: R. ACKERMAN

Date: 10.11.77

Authority: D.M.R.

Field Book:

Beacon Diagram

Not to Scale

Date

Record of Station

10-11-77

D.M.R. Concrete pillar, mast & vanes A. Cairn.

CENTRAL MAPPING AUTHORITY

GEODETIC SURVEY OF N.S.W.
 GEODETIC STATION RECONNAISSANCE and MAINTENANCE REPORT

Description: *Note: Cross out word or words which do not apply*

1. Cleared by lanes bearing..... from Trig/Mast
2. Mast & Vanes have been painted white & black respectively.
3. The station/pillar was unpiled/not unpiled/constructed on.....19....., dimensions now being:
 Description of mark..... should be explicit, e.g., S/Steel Pillar/Plate, Steel plug, Brass plug, Bolt, G.I. Pipe
 Height of mark..... above rock/concrete; Mark is.....m. above below G.L.
 Height of Top Vanes to Top Mark/Pillar plate.....m. Diameter of Vanes (vertical).....m.
 Height of Cairn.....m. Diameter of Cairn.....m. Name Plate found/not found/placed.
 Length of Mast.....m. (approximate if not unpiled)
4. A..... set in conc/rock has been placed/found, bearing.....° M from Mast/Plug/Pillar
5. A..... set in conc/rock has been placed/found, bearing.....° M from Mast/Plug/Pillar
6. A..... set in conc/rock has been placed/found, bearing.....° M from Mast/Plug/Pillar
7. A..... set in conc/rock has been placed/found, bearing.....° M from Mast/Plug/Pillar
8. Action required:.....

STANDPOINT:

Mark	Direction	Horiz. Distance	Height Difference	Mark	Direction	Horiz. Distance	Height Difference
			above standpt.				above standpt.
			below standpt.				below standpt.
			above standpt.				above standpt.
			below standpt.				below standpt.
			above standpt.				above standpt.
			below standpt.				below standpt.
			above standpt.				above standpt.
			below standpt.				below standpt.
			above standpt.				above standpt.
			below standpt.				below standpt.

Prepared by: *V. K...*

Checked: *W. J. 17/1/22*

Noted on U.T.M. Card

SI 2733-1

Checked

STATION: COLLOMBAITI GSDP No.: 5619
 MAP SHEET SCALE 1:250 000 D08E100
 INSPECTED BY: C. ZAHERA DATE: 6-6-19
 AUTHORITY: CMA FIELD BOOK: *Map Copy in Field*

CENTRAL MAPPING AUTHORITY

STATION: COLLOMBATI No.: 5619

MAP SHEETS SCALE 1:250 000 DORRICO

INSPECTED BY: L. HITCHINS DATE: 11-12-86

AUTHORITY: C.M.A. FIELD BOOK: —

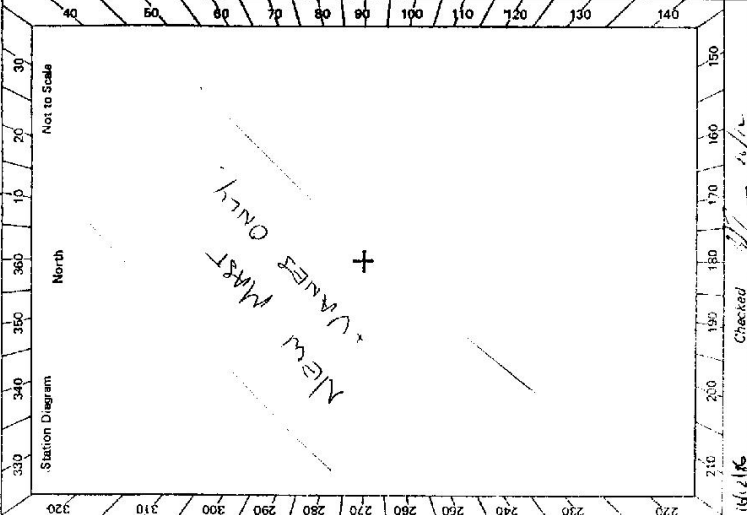

GEODETTIC STATION RECONNAISSANCE and MAINTENANCE REPORT

Description: ~~Cleared by vanes-bearing~~ ~~from Trip-Mast~~

1. Mast & Vanes have been painted white & black respectively.
2. The station/pillar was unaltered/not unplaced/constructed on.....19....., dimensions now being: Description of mark..... should be explicit, e.g., S/Steel-Pillar Plate, Steel plug, Brass plug, Bolt, G.I. Pipe
3. Height of mark..... m. ~~above~~ ~~below~~ ~~rock/concrete~~ Mark is..... m. ~~above~~ ~~below~~ Diameter of Vanes (vertical).....0.75.....m.

Height of Top Vanes to Top Mark/Pillar plate.....1.44.....m. Diameter of Cairn.....m. Name Plate found/not found/placed.

Length of Mast.....m. (approximate if not unplaced)

4. A..... set in conc/rock has been placed/found, bearing.....°M from Mast/Plug/Pillar

5. A..... set in conc/rock has been placed/found, bearing.....°M from Mast/Plug/Pillar

6. A..... set in conc/rock has been placed/found, bearing.....°M from Mast/Plug/Pillar

7. A..... set in conc/rock has been placed/found, bearing.....°M from Mast/Plug/Pillar

8. Action required:.....

STANDPOINT:

Mark	Direction	Horiz. Distance	Height Difference	Mark	Direction	Horiz. Distance	Height Difference
			above standpt				above standpt
			below standpt				below standpt
			above standpt				above standpt
			below standpt				below standpt
			above standpt				above standpt
			below standpt				below standpt
			above standpt				above standpt
			below standpt				below standpt
			above standpt				above standpt
			below standpt				below standpt

Prepared by: *[Signature]* Checked: *[Signature]* Noted on U.T.M. Card

<p>STATION: COLLONBATHI TS 5619</p> <p>Owner's Name: FORESTRY COMM Address: WEST KEMPOSIT Phone:</p> <p>Current Occupant: Address:</p> <p>Phone:</p> <p>Access Report of 18.5.19 was found suitable/unsuitable.</p> <p style="text-align: right;">ACCESS:</p>	<p>Beacon Diagram</p> <p>Not to Scale</p> <p>This section to be completed by officer constructing pillar.</p> <p>Original station mark found/not found.</p> <p>Description of mark:</p> <p>Original beacon found/not found.</p> <p>Description of beacon:</p> <p>Height Top of Vanes to Top Markm.</p> <p>Height of markm. above G.L. m. below</p> <p>Diameter of Vanesm. Height of Cairnin.</p> <p>Original Beacon has/has not been destroyed by ma.</p>												
	<table border="1" style="width: 100%; border-collapse: collapse;"> <thead> <tr> <th style="width: 50%;">Date</th> <th style="width: 50%;">Record of Station</th> </tr> </thead> <tbody> <tr> <td> </td> <td> </td> </tr> <tr> <td> </td> <td> </td> </tr> <tr> <td> </td> <td> </td> </tr> <tr> <td> </td> <td> </td> </tr> <tr> <td> </td> <td> </td> </tr> </tbody> </table>	Date	Record of Station										
Date	Record of Station												