

74-08

TRIGONOMETRICAL SURVEY OF N.S.W.  
RECONNAISSANCE and MAINTENANCE REPORT

CENTRAL MAPPING AUTHORITY  
Department of Lands

STATION KAMBAROG (Pillar) T.S. 5602  
 Co: DUQUHAM / Pr: BALFOREAL  
 Map Sheet: CAMBERWELL NORTH No: 9133  
 Inspected by: DAVID J. KAIN Date: 29 Nov 2020  
 Authority: \_\_\_\_\_ Field Book: 01397

This Trig. Station has been:-  
 Note: Cross out word or words which do not apply

1. ~~Completely cleared to permit access to adjoining Trigs.~~
2. Cleared by lanes bearing 217 - 185 m ~ 190 - 203 m from Trig. Mast
3. Trig. Mast & Vanes have been painted white & black respectively. ✓
4. The Trig. was unpiled/~~replaced~~, dimensions now being: Original Station Mark found ~~here~~ from  
 Description of mark BRONZE NA should be explicit, e.g. Steel plug, Brass plug, Bolt, G.I. Pipe  
 Height of mark 0.45 <sup>Live</sup> <sup>above</sup> Iron rock/concrete AT m above G.L.  
 Height of Top Vanes to Top Mast 1.417 m. Diameter of Vanes (vertical) 0.750 m.  
 Height of Cairn \_\_\_\_\_ m. Diameter of Cairn \_\_\_\_\_ m.

- Length of Mast \_\_\_\_\_ m. (approximate if not unpiled)
5. A. Pillar set in conc/~~rock~~ has been placed. 2.088 m. bearing 179 <sup>To</sup> <sup>from</sup> Trig. Mast
  6. A. Copper Nail set in conc/~~soil~~ has been placed. 3.715 m. bearing 235 <sup>from</sup> Trig. Mast
  7. A. G.I. Pipe set in conc/~~soil~~ has been placed. 5.214 m. bearing 178 <sup>from</sup> Trig. Mast
  8. A. \_\_\_\_\_ set in conc/rock has been placed. \_\_\_\_\_ m. bearing \_\_\_\_\_ <sup>from</sup> Trig. Mast

9. Connection W.P. Nail G.I. Pipe: 4.308 m. bearing 136 <sup>Original site. Station measurements below station was vacated.</sup>
10. Connection Iron Plug Copper Nail: 3.124 m. bearing 270
11. Connection Iron Plug G.I. Pipe: 3.157 m. bearing 181
12. Connection \_\_\_\_\_ to \_\_\_\_\_ \_\_\_\_\_ m. bearing \_\_\_\_\_
13. Diff. Ht. BRONZE PIN is 1.540 m. <sup>above</sup> PILLAR PLATE
14. Diff. Ht. COPPER NAIL is 1.600 m. <sup>above</sup> PILLAR PLATE
15. Diff. Ht. G.I. PIPE is 1.361 m. <sup>below</sup> PILLAR PLATE
16. Diff. Ht. \_\_\_\_\_ is \_\_\_\_\_ m. <sup>below</sup> \_\_\_\_\_

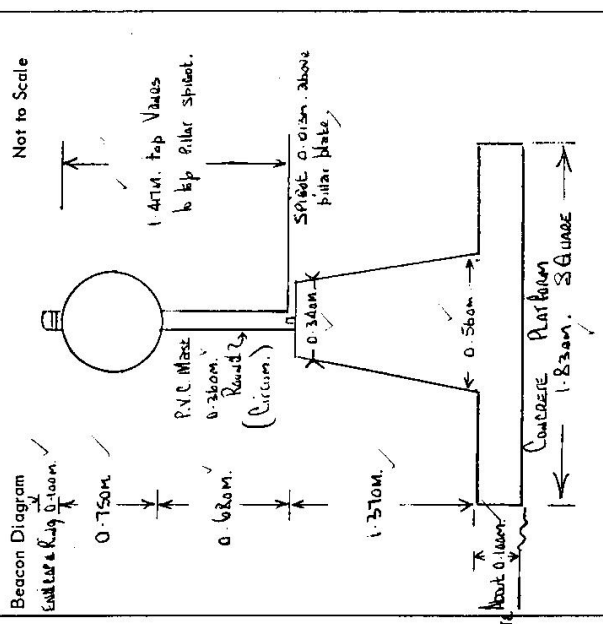

Date \_\_\_\_\_ Record of Station



Prepared by: \_\_\_\_\_ Checked: Ed 27/07/16  
 Noted on U.T.M. Card

STATION KANBAROO (Pillar) T.S. 5602

Owners Name... Mr. KEITH ATKINS.  
 Current Occupant... Grassland  
 Address... McCULLYS GAP  
 Phone No... McCullys Gap 3

Access 29-11-1975 Access to Kanbaroo Pillar T.S. from Muswellbrook.  
 AT MUSWELLBROOK Post Office at 0.0 miles toward via New England Highway  
 toward Stone.

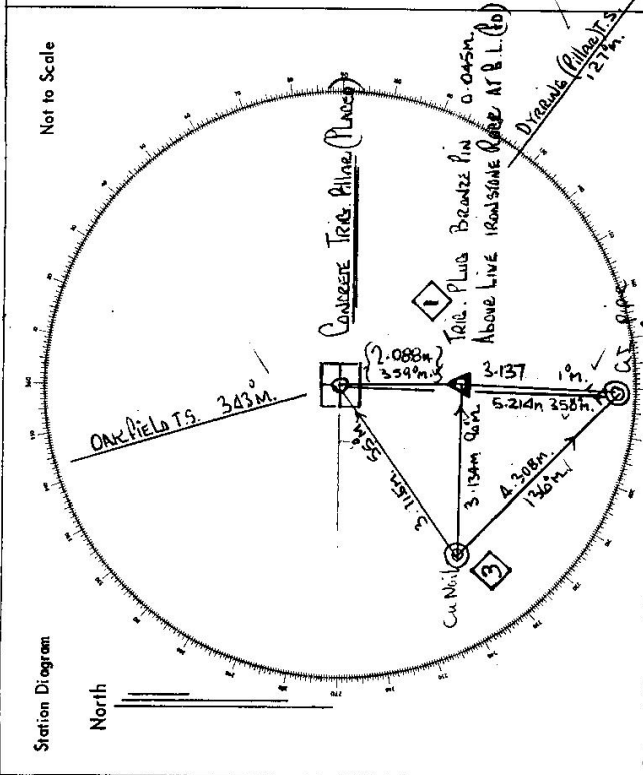
- MILEAGE
- 1-90 TAKE SIGNED ROAD TO YOUR RIGHT, SIGNPOST, <sup>FENCE</sup> McCULLYS GAP 9KM. /
  - 11-45 GRID AND HOUSE OF OWNER OF LAND ON WHICH TRIG IS SITUATED. <sup>FENCE</sup>
  - 13-10 GRID, TAKE TRACK TO RIGHT BETWEEN MR. KEITH ATKINS. FENCES, THERE IS NOW HOUSE ON YOUR LEFT.
  - 13-15 THROUGH WOOD GATE AND ACCESS GULLY. /
  - 13-35 THROUGH IRON GATE. /
  - 13-45 THROUGH IRON GATE NEAR OLD TIN HUT, FOLLOW TRACK TO RIGHT. /
  - 13-70 CREEK CROSSING. /
  - 13-90 CREEK CROSSING, FOLLOW TRACK ALONG SOUTHERN SIDE OF CREEK. /
  - 14-25 IRON GATE TAKE TRACK UP THIS FENCE TO YOUR RIGHT. /
  - 14-35 TOP OF RIDGE, FOLLOW FENCE LINE ALONG RIDGE TO YOUR LEFT. /
  - 15-10 IRON GATE ATOP FAIRLY STEEP KNAB, TRACK CONTINUES TO YOUR RIGHT, FOLLOW TRACK AROUND WINDING, HORSHOE SHAPED RIDGE. /
  - 16-10 PASS CATTLE YARDS ON YOUR RIGHT AND DAM ON YOUR FAR LEFT, FOLLOW TRACK UP RIDGE. /
  - 16-60. THROUGH WOOD GATE IN DOG-ROOF-FENCE WORK YOUR OWN WAY THROUGH ROCKS AND DEAD TIMBER TO TRIG PILLAR ATOP THIS RIDGE AT 16.80MILS. /
  - YOUR WHEEL DRIVE VEHICLES ONLY AND NEGOTIABLE IN DRY WEATHER ONLY



List of Observed Directions:-

Standpoint: CONCRETE OBSERVING PILLAR Standpoint: TRIG PLUG

Station	Direction	Station	Direction
OK-FIELDS T.S.	0 00 00	DYRRING PILLAR TS	0 00 00
COPPER NAIL	257 23 50	G.I. PIPE	55 58 20
G.I. PIPE	197 50 10	COPPER NAIL	140 47 20
TRIG PLUG	194 57 00	CONC. OBS. PILLAR	229 11 20
DYRRING PILLAR TS	145 47 04		
COPPER NAIL			
DYRRING PILLAR TS	0 00 00		
G.I. PIPE	176 20		
CONC. OBS. PILLAR	286 37 20		
TRIG PLUG	320 47 50		

CENTRAL MAPPING AUTHORITY  
Department of Lands

Trigonometrical Survey of N.S.W.

RECONNAISSANCE and MAINTENANCE REPORT

This Trig. Station has been:-

Note: Cross out word or words which do not apply

1. Completely cleared to permit 360° vision to surrounding Trigs.
2. Cleared by lones bearing..... from Trig. Mast
3. Trig. Mast & Vanes have been painted white & black respectively.
4. The Trig. was unpiled/~~not unpiled~~, dimensions now being:

Description of mark ~~CONC. PIER~~ PIER IN ROCK..... should be explicit, e.g. Steel plug, Brass plug, Bolt, G.I. Pipe  
 Height of mark..... m <sup>above</sup> rock/concrete PIER ~~PLATE~~..... m <sup>above</sup> G.L.  
 Height of Top Vanes to Top PLATE 1.430 m. Diameter of Vanes (vertical) 0.249 m.

Height of Centre..... m. Diameter of Centre..... m.

Length of Mast..... m. (approximate if not unpiled)

5. A. ~~Iron Pipe~~ set in ~~conc/soil~~ rock has been found 2.022 m. bearing 175°M from Trig. Meet Pillar
6. A. ~~Iron Pipe~~ set in ~~conc/soil~~ rock has been found 5.218 m. bearing 178°M from Trig. Meet Pillar
7. A. ~~Concrete Mast~~ set in ~~conc/soil~~ rock has been found 3.715 m. bearing 232°M from Trig. Mast Pillar
8. A..... set in ~~conc/rock~~ rock has been placed..... m. bearing.....°M from Trig. Mast
9. Connection Iron Pipe to St. Pipe..... m. bearing.....°M
10. Connection Iron Pipe to Concrete Mast..... m. bearing.....°M
11. Connection..... to..... m. bearing.....°M
12. Connection..... to..... m. bearing.....°M
13. Diff. Ht. Iron Pipe is 1.510 m. <sup>above</sup> PIERS PLATE
14. Diff. Ht. St. Pipe is 1.362 m. <sup>below</sup> PIERS PLATE
15. Diff. Ht. Concrete Mast is 1.593 m. <sup>above</sup> PIERS PLATE
16. Diff. Ht. St. Pipe is..... m. <sup>above</sup> PIERS PLATE

Prepared by: K. J. Murphy Checked: K. J. Murphy 14-4-78 Noted on U.T.M. Card

STATION KANGAROO C.P. TS 5602  
 Co: DUBOINA | P.H: BALMORUN  
 Map Sheet: CANNINGWELL | No: 1133-N  
 Inspected by: C. BROWN | Date: 24th JANUARY 1976  
 Authority: C.M.A. | Field Book: 1477  
 Beacon Diagram: Not to Scale

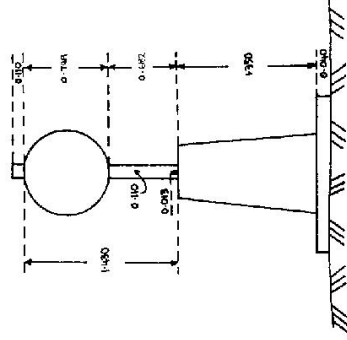

Date: \_\_\_\_\_ Record of Station

Checked

STATION KANGAROO CP TS 5602

Owners Name: .....  
 Current Occupant: .....

Address: .....  
 Address: .....

Access: .....

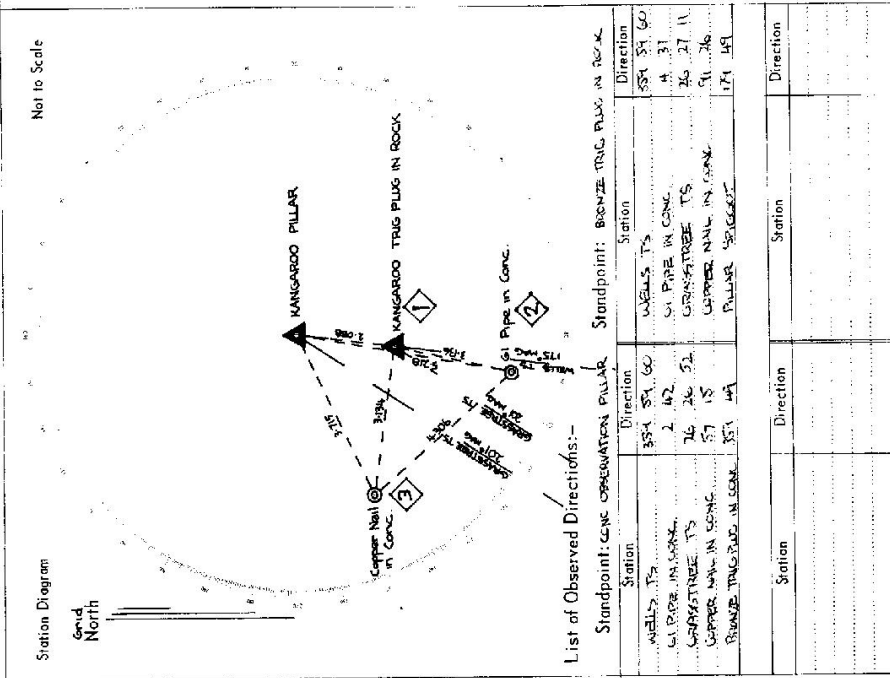

STATION **LANGRADO (P)**  
 Co: **DURHAM**  
 Ph: **D.R.M. OBI**  
 Map Sheet: **CAIRO (N)**  
 No: **9133**  
 Inspected by: **A.R. GILHAM**  
 Date: **14-7-76**  
 Authority: **I.S.D. NICLE**  
 Field Book: **00741**

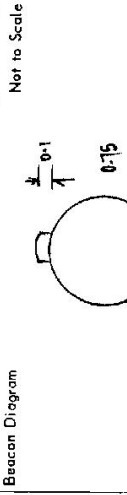

Beacon Diagram  
Not to Scale

Department of Lands  
 Reconnaissance and MAINTENANCE REPORT

This Trig. Station has been: completely cleared to permit 360° vision to surrounding Trigs.  
 Note: Cross out word or words which do not apply

1. Completely cleared to permit 360° vision to surrounding Trigs. ✓
2. Cleared by James-bearing from Trig. Mast
3. Trig. Mast & Vanes have been painted white & black respectively. ✓
4. The Trig. was unpiled/ not unpiled, dimensions now being:

Description of mark: concrete pillar should be explicit, e.g. Steel plug, Brass plug, Bolt, Concrete Pillar  
 Height of mark: 1.36 m <sup>above</sup> ~~below~~ concrete 1.36 m <sup>above</sup> ~~below~~ G.L.  
 Height of Top Vanes to Top pillar plate 1.43 m Diameter of Vanes (vertical) 0.75 m.  
 Height of Cairn: 1.36 m. Diameter of Cairn: 35/53 m.  
 Length of Mast: 1.53 m. (approximate if not unpiled)

5. Trig. Plug set in conc/rock has been placed/d. 2.082 m bearing 175° M from Trig. Mast pillar
6. GIP set in conc/soil has been placed/d. 5.249 m bearing 178° M from Trig. Mast pillar
7. C.S. set in conc/soil has been placed/d. 3.716 m bearing 233° M from Trig. Mast pillar
8. A set in conc/rock has been placed/d.            m bearing            M from Trig. Mast pillar
9. Connection: Trig Plug to C.S. 3.124 m bearing 247° M
10. Connection: Trig Plug to GIP 3.138 m bearing 180° M
11. Connection:            to                       m bearing            M
12. Connection:            to                       m bearing            M
13. Diff. Ht. Pillar Plate is 1.535 m <sup>above</sup> ~~below~~ Trig. Plug
14. Diff. Ht. Pillar Plate is 1.362 m <sup>above</sup> ~~below~~ G.L.P.
15. Diff. Ht. Pillar Plate is 1.555 m <sup>above</sup> ~~below~~ C.S.
16. Diff. Ht.            is            m <sup>above</sup> ~~below~~

Prepared by: A.R. Gilham Checked: Alan Burgess  
 Date: 22-11-75 Record of Station  
 Pillar Placed

STATION LANGI 30 (P) 5602

Current Occupant: K. ATKINS

Owners Name: K. ATKINS

Address: M. Culliv's Gap Rd.

Phone: McCulliv's Gap 3

TS-14-7-1976

Access: At Misedbrook P.N. at 0.1 km. travel via New England Highway towards Some.

- 3.4 Take sealed road on right signpost "McCulliv's Gap"
- 19.1 Grid & house of owner
- 21.8 Grid, take track on right between fences, house on L.H.S.
- 22.1 Wooden Gate then cross gully.
- 22.4 Iron Gate.
- 22.55 Iron Gate near old tin hut - follow track to right
- 23.0 Creek Crossing
- 23.4 Creek Crossing, follow track along Sth side of Creek.
- 23.9 Iron Gate. take track up ridge fence on R.H.S.
- 24.1 Top of ridge, follow fence along ridge to left.
- 25.6 Iron Gate at top of steep knob, track continues to right along horse shoe shaped ridge.
- 26.0 At top of ridge follow track down towards adam to left.
- 27.2 Two cattle yards on right and dam on left, follow track up ridge.
- 28.2 Dog proof Gate, veer to right and make way to Trig
- 28.8 Trig.

4 wheel drive vehicles only - only when dry.

D. West, Government Printer, New South Wales - 1976

