

Department of Lands

Integration of N.S.W. RECONNAISSANCE and MAINTENANCE REPORT 543 STATION

COLDVILLE (P) 5589

This Trig. Station has been:

Co: **BATHURST** Ph: **COLDVILLE**

- 1. ~~Completely cleared to permit 360° vision to surrounding Trig.~~
- 2. ~~Cleared by lanes-bearing.~~ **THERE ARE SCATTERED TREES & CLUMPS OF TREES OF FROM Trig. Mast**
- 3. Trig. Mast & Vanes have been painted white & black respectively. **TREES ON THE HILL AND VISIBILITY IS HAZY IN MOST DIRECTIONS**
- 4. The Trig. ~~was not re-surveyed~~ **was surveyed**, dimensions now being:

Description of mark: **CONCRETE PILLAR** should be explicit, e.g. Steel plug, Brass plug, Bolt, Concrete Pillar

Height of mark: **1.23** m above ~~level~~ **feet/concrete** **1.23** m above ~~level~~ **G.L.**

Height of Top Vanes to Top Mark/Top pillar plate: **1.90** m Diameter of Vanes (vertical): **0.75** m.

Height of ~~Crown~~ **Centre**: **2.38** m. **Diameter of Crown**: **2.38** m.

Length of Mast: **1.98** m. (approximate if not unplied)

5. A. **CS** set in conc/teck has been placed/id **3.279** m, bearing **192** °M from Trig. Mast/pillar

6. A. **SP** set in conc/soil has been placed/id **7.900** m, bearing **117** °M from Trig. Mast/pillar

7. A. set in conc/soil has been placed/id m, bearing °M from Trig. Mast/pillar

8. A. set in conc/rock has been placed/id m, bearing °M from Trig. Mast/pillar

9. Connection: **PILLAR** to **TRIG PUIS**: **6.257** m, bearing **98** °M

10. Connection: **TRIG PUIS** to **CS**: **2.874** m, bearing **275** °M

11. Connection: **TRIG PUIS** to **SP**: **2.928** m, bearing **164** °M

12. Connection: to m, bearing °M

13. Diff. Ht. **CS** is **1.165** m, ~~above~~ **PILLAR PLATE** ~~below~~

14. Diff. Ht. **SP** is **1.166** m, ~~above~~ **PILLAR PLATE** ~~below~~

15. Diff. Ht. **TRIG PUIS** is **1.236** m, ~~above~~ **PILLAR PLATE** ~~below~~

16. Diff. Ht. is m, ~~above~~ **PILLAR PLATE** ~~below~~

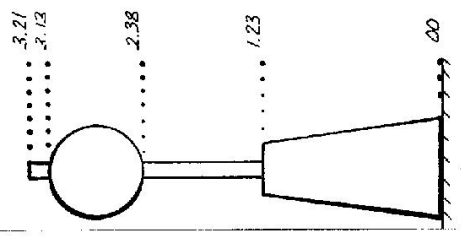

Date: **OCT 75** Record of Station
MAY 76 **PILLAR SELECTED**
SECOND DANCE CONNECTION TO A.M.D.

Prepared by: **...** Checked: **...**

STATION COLVILLE TS 5589

Owners Name: GAGAN, C.H.
 Current Occupant:
 Address: Box 30 Vittoria
 via Blayney

Access Nov 1975
 00 Junction Mitchell Highway and Road to Multhorpe at Car Wrecking Yard
 1.3 Proceed towards Multhorpe
 1.3 Gate on left at Multhorpe
 1.45 Triple Gate Take Extreme Left and Follow Fence to End of Pines
 1.55 Gate & Dam on Left go thru and veer right up hill
 1.75 Pullar near concrete tank

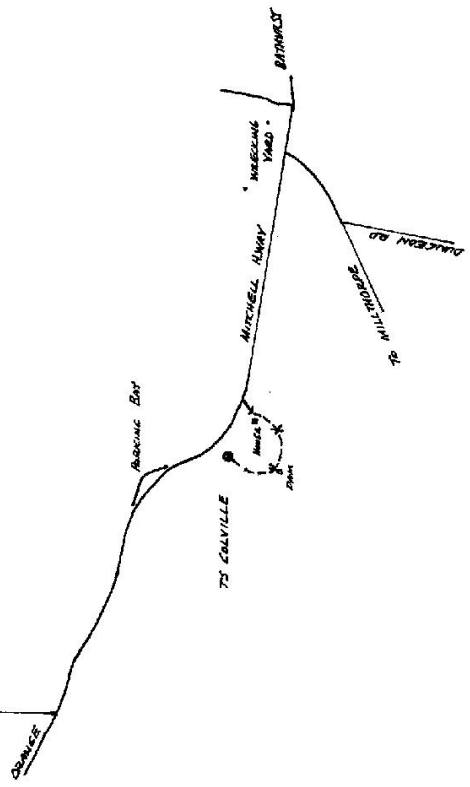

Not to Scale

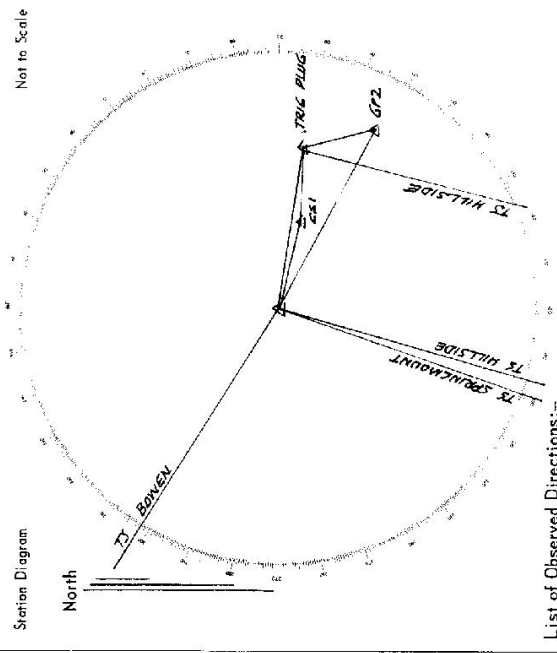

List of Observed Directions:-

Standpoint: PULLAR		Standpoint: TRIG PLUG	
Station	Direction	Station	Direction
HILLSIDE TS	359 59 40	HILLSIDE TS	329 59 40
SPRINGMOUNT TS	2 57 28.6	CSI	69 32 11
BOWEN TS	96 07 01.2	COLVILLE TS (A)	72 02 26
TRIG PLUG	252 06 12	GP2	318 16 28
CSI	254 15 06		
Station	Direction	Station	Direction
GP2	271 58 22		

CENTRAL MAPPING AUTHORITY
Department of Lands

Topographical Survey of N.S.W.

RECONNAISSANCE and MAINTENANCE REPORT

This Trig. Station has been:-

Note: Cross out word or words which do not apply

1. Completely elevated to permit 360° vision to surrounding Trig.
2. Cleared by lances bearing 420m, 150m, 188m, 305m, 223m, 228m, 274m, 300m from Trig. Mast
3. Trig. Mast & Vanes have been painted white & black respectively.
4. The Trig. was unpiled/not unpiled, dimensions now being:

Description of mark: *CONC. PILE* *ALUM. PLATE* should be explicit, e.g. Steel plug, Brass plug, Bolt, GI Pipe
 Height of mark: *0.015* m above *rock-concrete* *ALUM. PLATE* above *G.L.*
 Height of Top Vanes to Top Mark: *1.899* m. Diameter of Vanes (vertical): *0.350* m.
 Height of Cairn: *1.24* m. Diameter of Cairn: m.
 Length of Mast: *1.983* m. (approximate if not unpiled)
 5. A. Trig. Plug set in ~~conc~~/~~rock~~ has been placed: *6.249* m, bearing: *99*° *ALUM.* from Trig. Mast
 6. A. G.I. PIPE set in conc./soil has been placed: *1.90* m, bearing: *119*° *ALUM.* from Trig. Mast
 7. A. G.I. PIPE set in conc./soil has been placed: *3.378* m, bearing: *101*° *ALUM.* from Trig. Mast
 8. A. set in conc./rock has been placed: m, bearing:°M from Trig. Mast

9. Connection *Co. Nail* to *G.I. PIPE*: *4.792* m, bearing: *135*°M
10. Connection *Trig. Plug* to *Co. Nail*: *3.874* m, bearing: *272*°M
11. Connection *Trig. Plug* to *G.I. PIPE*: *2.930* m, bearing: *165*°M
12. Connection to m, bearing:°M
13. Diff. Ht. *Trig. Plug* is: *1.536* m. *ALUM. PLATE* *Co. Nail* is *0.070*m above *TRIG. PLUG*
14. Diff. Ht. *Co. Nail* is: *1.066* m. *ALUM. PLATE* *G.I. PIPE* is *0.070*m above *TRIG. PLUG*
15. Diff. Ht. *G.I. PIPE* is: *1.165* m. *ALUM. PLATE* *G.I. PIPE* is *0.070*m above *TRIG. PLUG*
16. Diff. Ht. *Co. Nail* is: *0.000* m. *G.I. PIPE* *G.I. PIPE*

Prepared by: *D. BATH* Checked: *D. BATH* Noted on U.T.M. Card

TS 5589
STATION COLVILLE (JULIA) T S
Co: BATHURST Ph: COLVILLE

Map Sheet: VITTORIA 1:25,000 No: 8731-11-S
 Inspected by: D. BATH Date: 21.5.20
 Authority: N.A. Field Book: C1433

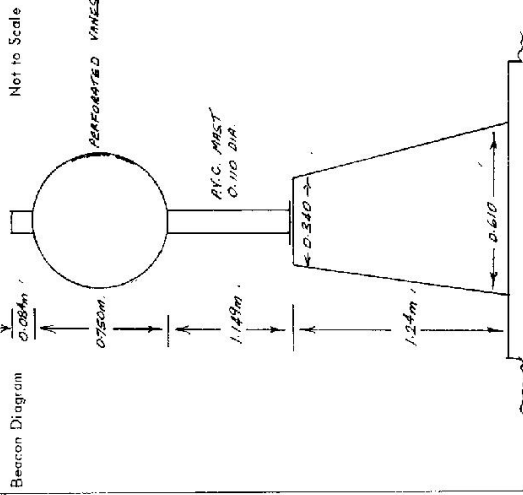

Date	Record of Station

Checked

STATION COLVILLE (Pillar) TS 5589

Current Occupant.....

Address.....

Owners Name.....

Address.....

Access 24-6-1976

Not to Scale

Station Diagram

North

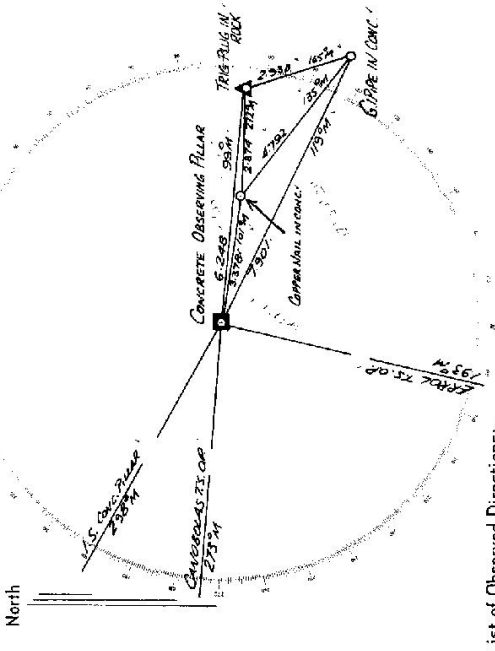

List of Observed Directions:-

Station: conc. obs. pillar		Standpoint: TRIG. PILLAR	
Station	Direction	Station	Direction
ERRAZ. T.S.O.P.	02° 00' 00"	CANBERRAS T.S.O.P.	80° 00' 00"
CANBERRAS T.S.O.P.	81° 55' 15"	PILLAR SPOT	80° 48' 50"
E.S. CONC. PILLAR	106° 48' 00"	T.S. CONC. PILLAR	84° 45' 50"
TRIG. PILLAR	162° 49' 40"	G.I. PIPE	847° 03' 00"
CU. MANH.	168° 52' 05"	CU. MANH.	358° 17' 45"
G.I. PIPE	202° 35' 10"		

CENTRAL MAPPING AUTHORITY
Department of Lands

Trigonometrical: Survey of N.S.W.

RECONNAISSANCE and MAINTENANCE REPORT

This Trig. Station has been:

Note: Cross out word or words which do not apply

1. Completely cleared to permit 360° vision to surrounding Trigs.
2. Cleared by lanes bearing..... from Trig. Mast
3. Trig. Mast & Vanes have been painted white & black respectively.
4. The Trig. was unpiled/not unpiled, dimensions now being: Original Station Mark found / not found

Description of mark..... should be explicitly e.g. Steel plug, Brass plug, Bolt, G.I. Pipe

Height of mark..... m above rock/concrete ~~rock/concrete~~ ~~above G.L.~~ ~~below G.L.~~

Height of Top Vanes to Top Mark..... m. Diameter of Vanes (vertical)..... m.

Height of Cairn..... m. Diameter of Cairn..... m.

Length of Mast..... m. (approximate if not unpiled)

5. A..... set in conc./rock has been placed..... m. bearing.....°M from Trig. Mast

6. A..... set in conc./soil has been placed..... m. bearing.....°M from Trig. Mast

7. A..... set in conc./soil has been placed..... m. bearing.....°M from Trig. Mast

8. A..... set in conc./rock has been placed..... m. bearing.....°M from Trig. Mast

9. Connection..... to..... m. bearing.....°M

10. Connection..... to..... m. bearing.....°M

11. Connection..... to..... m. bearing.....°M

12. Connection..... to..... m. bearing.....°M

13. Diff. Ht. is..... m. ^{above}/_{below}

14. Diff. Ht. is..... m. ^{above}/_{below}

15. Diff. Ht. is..... m. ^{above}/_{below}

16. Diff. Ht. is..... m. ^{above}/_{below}

Prepared by: M. Kadus 10.3.77 Checked: [Signature] Noted on U.T.M. Card

STATION COLVILLE GSDP 75 5589

Co: BATHURST Ph: COLVILLE

Map Sheet: ORANGE No: 406

Inspected by: P. CHEN & L. KARABUS Date: 9.3.77

Authority: C.M.A. Field Book: 1543

Beacon Diagram

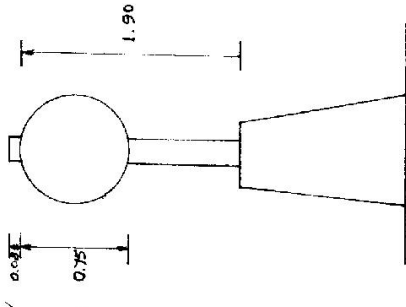

Date

Record of Station

Checked

STATION COLVILLE G-SOP IS-5589

Owners Name.....

Current Occupant.....

Address.....

Access 9-3-1977

Not to Scale

North

Station Diagram

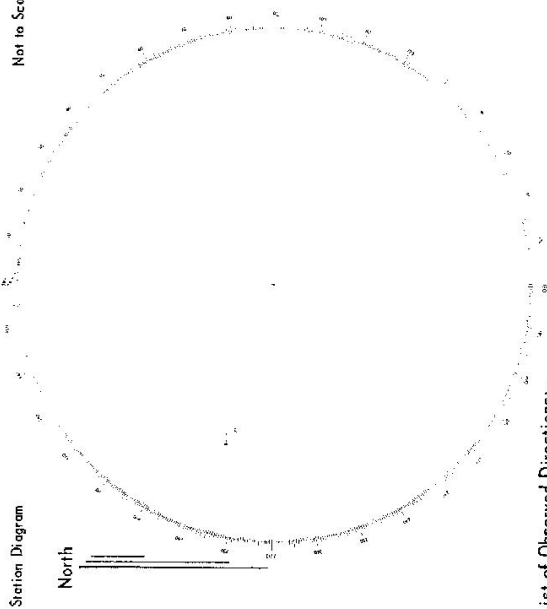

List of Observed Directions:-

Standpoint:

Station

Direction

Station

Direction

Station

Direction

Station

Direction

Station

Direction

- km 00.0 Caltex Service Station "Half Way House" Vittoria approx. 22 km from Bathurst towards Orange on Mitchell Hwy.
- 04.5 Double iron gate on left. Go through and follow track around L.H.S. of house.
- 04.6 House on right. Head towards iron gate as shown above.
- 04.8 Iron gate. Go through and follow fence line up to next iron gate.
- 05.0 Iron gate. Dam on left. Go through gate and follow faint track which bends slightly to the right and up the hill.
- 05.3 G.S.O.P. [Near water tank and small dam.]

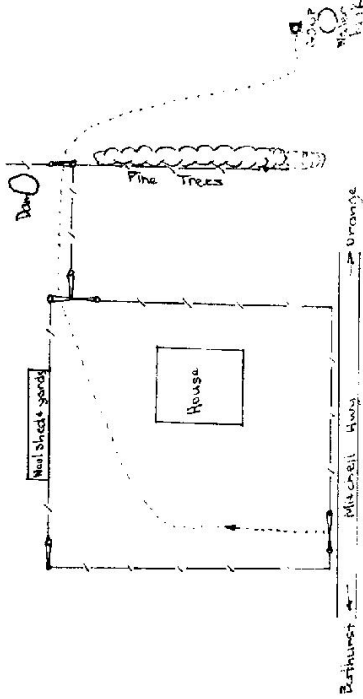

CENTRAL MAPPING AUTHORITY GEODETIC SURVEY OF N.S.W. GEODETIC STATION RECONNAISSANCE and MAINTENANCE REPORT

STATION: COLVILLE GS (P) No.: 5589
 MAP SHEET SCALE 1:250 000 BATHURST
 INSPECTED BY: D TURNER DATE: 22.1.81
 AUTHORITY: CMA FIELD BOOK: —

Description: *Note: Cross out word or words which do not apply*
 1. Cleared by lanes bearing..... from Trig. Mast
 2. Mast & Vanes have been painted white & black respectively.
 3. The station/pillar was unpiled/not unpiled/~~set~~ on ~~2.2m~~ ^{19.8m} ~~19.8m~~, dimensions now being:
 Description of mark: ~~STEEL PILLAR~~ ^{STEEL PILLAR} should be explicit, e.g., S/Steel Pillar Plate, Steel plug, Brass plug, Bolt, G.I. Pipe
 Height of mark: ~~2.30~~ ^{2.30} m. ~~above~~ ^{above} ~~rocks/concrete;~~ ^{rocks/concrete;} Mark is ~~2.30~~ ^{2.30} m. ~~above~~ ^{above} G.L.
 Height of Top Vanes to Top Mark/Pillar plate ~~1.900~~ ^{1.900} m. Diameter of Vanes (vertical) ~~250~~ ²⁵⁰ m.
 Height of Cairn.....m. Diameter of Cairn.....m. Name Plate found/not found/placed.
 Length of Mast.....m. (approximate if not unpiled)
 4. A.....set in conc/rock has been placed/found, bearing.....°M from Mast/Plug/Pillar
 5. A.....set in conc/rock has been placed/found, bearing.....°M from Mast/Plug/Pillar
 6. A.....set in conc/rock has been placed/found, bearing.....°M from Mast/Plug/Pillar
 7. A.....set in conc/rock has been placed/found, bearing.....°M from Mast/Plug/Pillar
 8. Action required: ~~NEW SPICOT COVER NEEDED~~

STANDPOINT:

Mark	Direction	Horiz. Distance	Height Difference	Mark	Direction	Horiz. Distance	Height Difference
			above standpt.				above standpt.
			below standpt.				below standpt.
			above standpt.				above standpt.
			below standpt.				below standpt.
			above standpt.				above standpt.
			below standpt.				below standpt.
			above standpt.				above standpt.
			below standpt.				below standpt.
			above standpt.				above standpt.
			below standpt.				below standpt.

Prepared by: *[Signature]* 27/1/81 Checked: *[Signature]* 27/1/81
 Noted on U.T.M. Card *[Signature]* 27/1/81 Checked: *[Signature]* 27/1/81

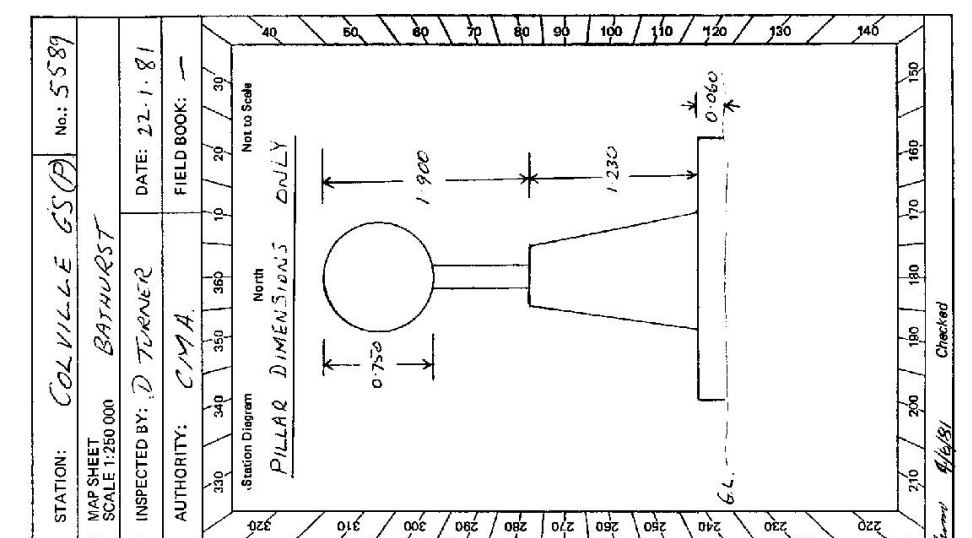

STATION **CEVILLE 65 (P) B 5589**

Owner's Name: **C. H. GAGEN**
 Address: **BRIGHTSIDE**
 Phone: **M. T. HORRE**
 Current Occupant:
 Address:
 Phone:

ACCESS
 Access Report of **9.3.19** was found suitable/~~unsuitable~~.

6. 2733-2 D. West Government Printer

Beacon Diagram	Not to Scale

This section to be completed by officer constructing pillar.

Original station mark found/not found.

Description of mark:

Original beacon found/not found.

Description of beacon:

Height Top of Vanes to Top Markm.
above below

Height of markm. above below rock/condm. G.L.

Diameter of Vanesm. Height of Cairnm.

Original Beacon has/has not been destroyed by me.

Date	Record of Station