

3-498

Trigonometrical Survey of N.S.W.

Department of Lands

RECONNAISSANCE and MAINTENANCE REPORT

STATION **Ellalong (Pillar) T.S. 5485**

Co: **Northern Tablelands** Ph: **ELLALONG**
Map Sheet: **CESSENORIV SOUTH** No: **9132 - S**
Inspected by: **DAVID O'NEIL** Date: **26 AUGUST 1975**
Authority: **01394** Field Book: **01394**

This Trig. Station has been:- Note: Cross out word or words which do not apply

- 1. ~~Completely cleared to permit 360° vision to surrounding things.~~
- 2. Cleared by lanes bearing **151° ~ 90° M** from Trig. ~~Mast~~ **Pillar**

3. Trig. Mast & Vanes have been painted white & black respectively. ✓

4. The Trig. was unpiled / ~~unpiled~~ dimensions now being: Original station mark found / ~~found~~

Description of mark **BEARING** in **the original sketch** **work** should be explicit, e.g. Steel plug, Brass plug, Bolt, G.I. Pipe
Height of mark **0.22 m** above **rock/concrete** **A.T.** **G.L.**

Height of Top Vanes to Top **0.392 m** ✓ Diameter of Vanes (vertical) **0.150 m** ✓

Height of Cairn **0.22 m** Diameter of Cairn **0.150 m**

Length of Mast **0.150 m** (approximate if not unpiled)

5. **A. Pillar** set in conc/ ~~rock~~ has been placed **2.329 m** bearing **124°** **to** **Plug** **Mast**

6. **A. S.W. Pillar** set in conc/ ~~rock~~ has been placed **5.604 m** bearing **315°** **to** **Trig. Pillar**

7. **A. R.I. Pipe** set in conc/ ~~rock~~ has been placed **3.344 m** bearing **246°** **to** **Trig. Mast**

8. **A.** set in conc/rock has been placed **0.150 m** bearing **0°** from Trig. Mast

9. Connection **Cairn** to **R.I. Plug** **3.365 m** bearing **147°** **to** **Old Trig. Station Measurements Here**

10. Connection **G.I. Pipe** to **R.I. Plug** **2.696 m** bearing **24°** **to** **Diameter of Vanes** **1.010 m**

11. Connection **Cairn** to **G.I. Pipe** **5.212 m** bearing **170°** **to** **Mast Square** **0.100 m**

12. Connection **Cairn** to **G.I. Pipe** **5.212 m** bearing **170°** **to** **Least Mast to Bottom Vanes** **1.965 m**

13. Diff. Ht. **Trig. Plug** is **1.576 m** above **Trig. Pillar** **Diameter of Cairn** **0.900 m**

14. Diff. Ht. **G.I. Mast** is **1.744 m** above **Trig. Pillar** **Diameter of Cairn** **1.500 m**

15. Diff. Ht. **G.I. Pipe** is **1.709 m** above **Trig. Pillar**

16. Diff. Ht. **G.I. Mast** is **0.172 m** above **Trig. Plug**

Prepared by:

Checked:

Noted on U.T.M. Card

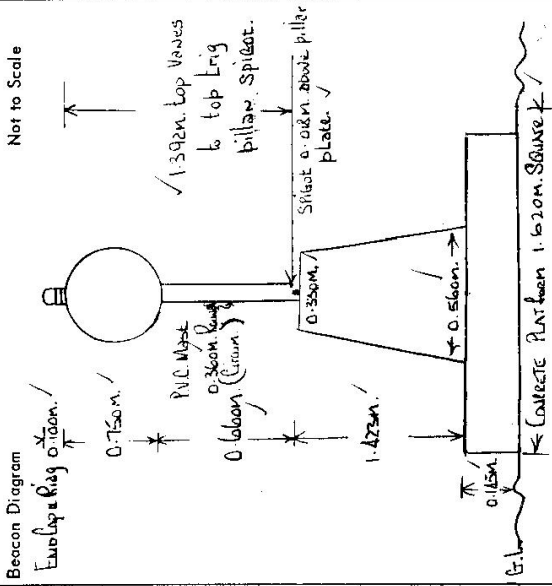

Date	Record of Station

Checked

STATION AELLEN LANE (Pillar) T.S. 5485
 Current Occupant... POULTRY FARMER...
 Address... PAXTON...

Owners Name... Mrs. TOWNSEND...
 Address... PAXTON...

Access 26-8-1975
 To LESSNICK

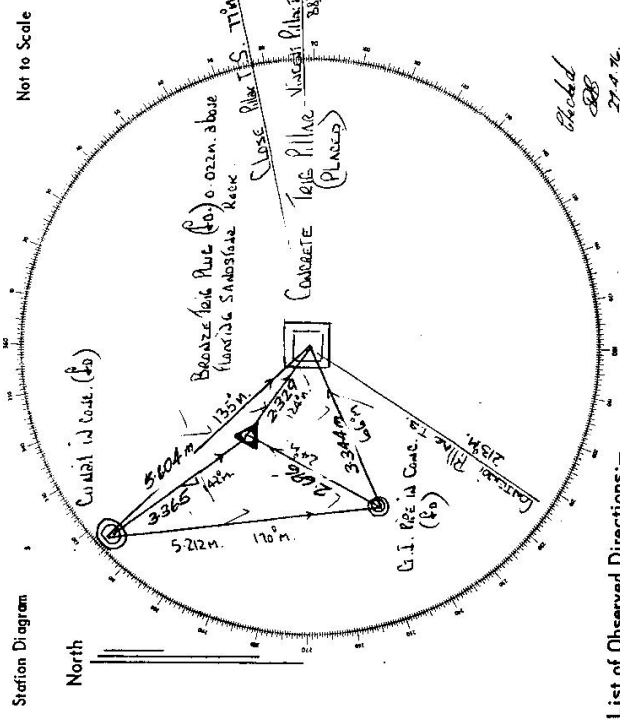
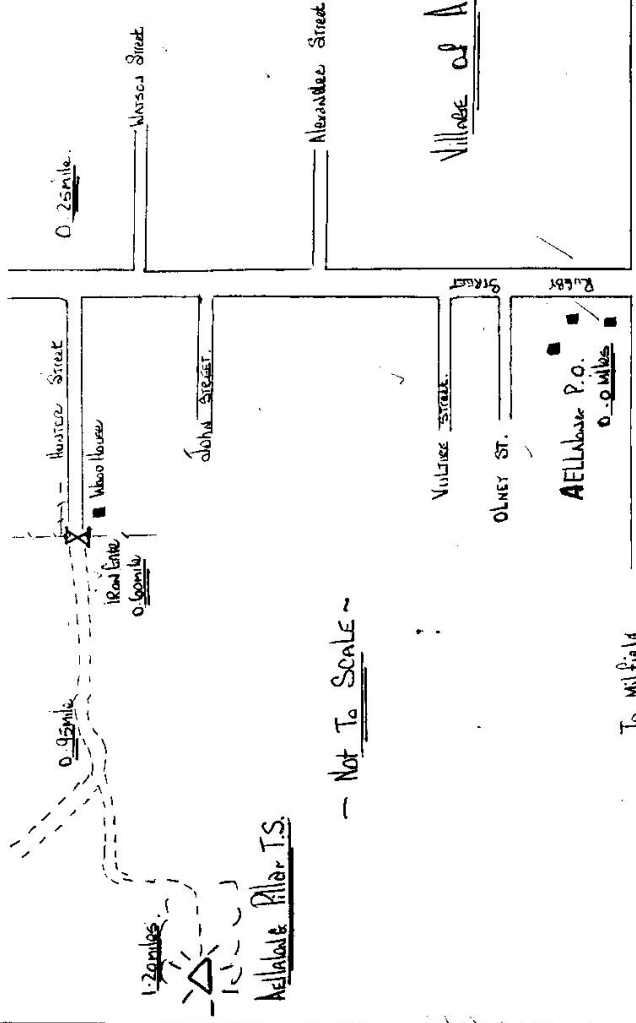

List of Observed Directions:-

Station	Direction	Station	Direction
CONCRETE PILLAR T.S.	00 00 00	VINCENT PILLAR T.S.	00 00 00
G.F. PILE	35 45 01	CONC. TRIG. PILLAR	33 30 09
TRIG. PILE	88 56 43	G.F. PILE	116 29 56
CORNER MARK	101 16 59	CONCRETE PILLAR T.S.	124 31 94
VINCENT PILLAR T.S.	255 07 10	CU. NAIL	284 36 18
STANDPOINT: CU. NAIL	87°	CLOSE PILLAR T.S.	351 47 46
CLOSE PILLAR T.S.	00 00 00		
VINCENT PILLAR T.S.	08 11 40		
CONCRETE TRIG. PILLAR STA. P.O.	42 47 38		
G.I. PILE	189 57 56		

CONCRETE PILLAR T.S. 132 41 28'

- Not To SCALE -

To MILFIELD

To MULBERRY

CENTRAL MAPPING AUTHORITY
Department of Lands

Trigonometrical Survey of N.S.W.

RECONNAISSANCE and MAINTENANCE REPORT

This Trig. Station has been:-

Note: Cross out word or words which do not apply

1. Completely cleared to permit 360° vision to surrounding Trips.
2. Cleared by lanes bearing..... from Trig. Mast
3. Trig. Mast & Vanes have been painted white & black respectively. ✓
4. The Trig. was unpiled/~~not unpiled~~, dimensions now being: ~~2.5m x 1.5m x 1.5m~~ ~~MAST~~ ~~TRIP~~

Description of mark Copper Nail..... should be explicit, e.g. Steel plug, Brass plug, Bolt, G.I. Pipe

Height of mark..... m above rock/concrete 1.55 m above base G.L. ✓
 Diameter of Vanes (vertical) 0.750 m.

Height of Centre..... m. Diameter of Centre..... m.
 Length of Mast 0.663 m. (approximate if not unpiled)

5. A G.I. Pipe set in conc./~~rock~~ has been placed 3.344 m. bearing 246°M from Trig. Mast ✓
6. A Copper Nail set in conc./soil has been placed 5.604 m. bearing 312°M from Trig. Mast ✓
7. A..... set in conc./soil has been placed..... m. bearing.....°M from Trig. Mast ✓
8. A Trig. Plug set in ~~conc~~/rock has been placed 2.330 m. bearing 229°M from Trig. Mast ✓
9. Connection Trig Plug to Copper Nail: 3.362 m. bearing 320°M ✓
10. Connection Trig Plug to G.I. Pipe: 2.698 m. bearing 202°M ✓

11. Connection..... to..... m. bearing.....°M
12. Connection..... to..... m. bearing.....°M
13. Diff. Ht. G.I. Pipe in Conc. is 1.702 m. ~~above~~ below Pillar Plate
14. Diff. Ht. Brass Trig Plug is 1.576 m. ~~above~~ below Pillar Plate
15. Diff. Ht. Copper Nail in Conc. is 1.748 m. ~~above~~ below Pillar Plate
16. Diff. Ht. is .. m. ~~above~~ below ..

Prepared by: C. J. Brown Checked: .. Noted on U.T.M. Card

STATION **ELLALONG O.P. TS 5485**

Cor: WORTHUMBERLAND Ph: ELLALONG

Map Sheet: CESSNOCK No: 9/32

Inspected by: C. J. BROWN Date: 15th October 1935

Authority: C. M. A. Field Book: 1457

Beacon Diagram Not to Scale

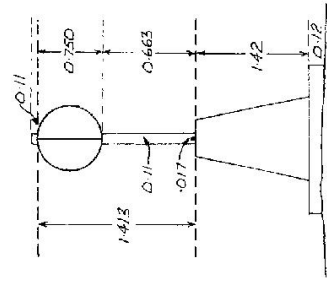

Date .. Record of Station ..

STATION AELLALONG O.P. TS 5485

Owners Name:
 Current Occupant:
 Address:
 Address:

Access 15 - 16 - 1975

Not to Scale

Station Diagram

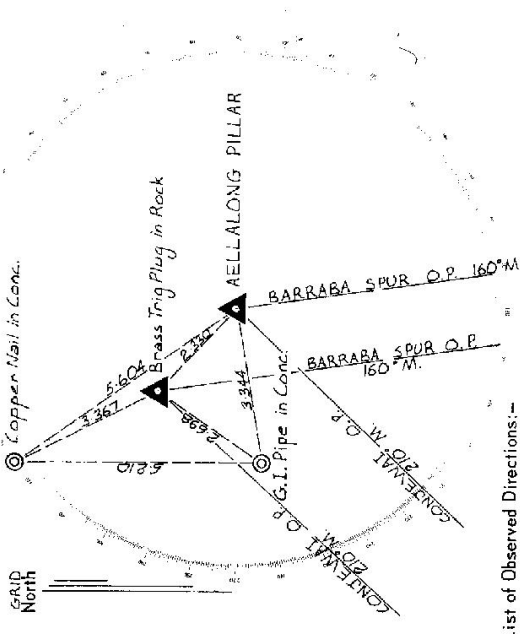

List of Observed Directions:-

Station	Direction	Station	Direction
BARRABA SPUR O.P.	59	BARRABA SPUR O.P.	59
CONTEWAI O.P.	50	G.I. Pipe in Conc.	42
G.I. Pipe in Conc.	86	CONTEWAI O.P.	50
Brass Trig Plug in Rock	39	Copper Nail in Conc.	160
Copper Nail in Conc.	51	Pillar Spigot	30

CENTRAL MAPPING AUTHORITY

GEODETTIC SURVEY OF N.S.W.

GEODETTIC STATION RECONNAISSANCE and MAINTENANCE REPORT

Description: *Note: Cross out word or words which do not apply*

1. Cleared by lances bearing..... from Trig. Mast
2. Mast & Vanes ~~have been painted white. See sketch respectively, NEED PHOTING.~~
3. The station/pillar was unpiled/not unpiled/constructed on..... 19..... dimensions now being:
Description of mark..... should be explicit, e.g. S/Steel Pillar Plate, Steel plug, Brass plug, Bolt, G.I. Pipe
Height of mark.....m. ^{above} _{below} rock/concrete; Mark is.....m. ^{above} _{below} G.L.
- Height of Top Vanes to Top Mark/Pillar plate.....m. Diameter of Vanes (vertical).....m.
- Height of Cairn.....m. Diameter of Cairn.....m. Name Plate found/not found/placed.
- Length of Mast.....m. (approximate if not unpiled)
4. A..... set in conc/rock has been placed/found, bearing.....° M from Mast/Plug/Pillar
5. A..... set in conc/rock has been placed/found, bearing.....° M from Mast/Plug/Pillar
6. A..... set in conc/rock has been placed/found, bearing.....° M from Mast/Plug/Pillar
7. A..... set in conc/rock has been placed/found, bearing.....° M from Mast/Plug/Pillar
8. Action required:..... *ALL TO BE CLEARED*

STANDPOINT:

STANDPOINT:

Mark	Direction	Horiz. Distance	Height Difference	Mark	Direction	Horiz. Distance	Height Difference
			above standpt				above standpt
			below				below
			above standpt				above standpt
			below				below
			above standpt				above standpt
			below				below
			above standpt				above standpt
			below				below
			above standpt				above standpt
			below				below

Prepared by: *GL*

Checked: *29/5/21*

Noted on U.T.M. Card

S: 2733-1

STATION: *ELLALONG (P)* No: *5485*

MAP SHEET SCALE 1:250 000 *SINGLETON*

INSPECTED BY: *G. JONES* DATE: *7-4-81*

AUTHORITY: *CMA* FIELD BOOK: *1913*

Station Diagram

North

Not to Scale

LEFT CLEARING ONLY (ONE CBY)

+

Checked

GS 24

<p>STATION ELLALONG. (P) IS 5485</p> <p>Owner's Name: <u>MR & ALLIED BY LTD.</u> Address: <u>MR BILL FLETT</u> <u>TENN VALLEY CULLERY</u> <u>PO BOX 140</u> <u>ELLALONG</u></p> <p>Phone: <u>043 588 747 (HOME)</u> <u>043 588 146 (BUSINESS)</u></p> <p>Access: <u>Report of 10/11/10 was found suitable/inaccessible.</u> <u>MR FLETT HAS GIVEN PERMISSION FOR ACCESS, CLEARING AND POSITIONING OF STAKES ON THE HILL. (8/4/21)</u></p> <p>Access: <u>NO ACCESS ONLY.</u> <u>NOT POSSIBLE TO DRIVE TO TOP IN WET WEATHER.</u></p>	<p>STATION <u>ELLALONG. (P) IS 5485</u> CHIEF OF PARTY: <u>MR LEE SIBERTMAN</u> Address: <u>HILL ST</u> <u>PAYTON</u> Phone: <u>049 981228</u></p> <p>Owner's Name: <u>MR & ALLIED BY LTD.</u> Address: <u>MR BILL FLETT</u> <u>TENN VALLEY CULLERY</u> <u>PO BOX 140</u> <u>ELLALONG</u></p> <p>Phone: <u>043 588 747 (HOME)</u> <u>043 588 146 (BUSINESS)</u></p> <p>Access: <u>Report of 10/11/10 was found suitable/inaccessible.</u> <u>MR FLETT HAS GIVEN PERMISSION FOR ACCESS, CLEARING AND POSITIONING OF STAKES ON THE HILL. (8/4/21)</u></p> <p>Access: <u>NO ACCESS ONLY.</u> <u>NOT POSSIBLE TO DRIVE TO TOP IN WET WEATHER.</u></p>
<p>Beacon Diagram</p> <p>Concrete pillar found.</p> <p style="text-align: center;">Not to Scale</p>	<p>This section to be completed by officer constructing pillar.</p> <p>Original station mark found/not found.</p> <p>Description of mark:</p> <p>Original beacon found/not found.</p> <p>Description of beacon:</p> <p>Height Top of Vanes to Top Mark:m.</p> <p>Height of mark:m. above G.L. m. below G.L.</p> <p>Diameter of Vanes:m. Height of Cairn:m.</p> <p>Original Beacon has/has not been destroyed by me.</p>
<p>Date</p> <p>Record of Station</p>	

CENTRAL MAPPING AUTHORITY

GEODETIC STATION RECONNAISSANCE and MAINTENANCE REPORT

STATION: ELLALONE PILLAR No: 5485

MAP SHEET SCALE: 1:250 000

INSPECTED BY: D. J. KAIG DATE: 1 July 1981

AUTHORITY: C.M.A. FIELD BOOK: 013&1

Description:

- Note: Cross out word or words which do not apply
1. Cleared by lanes bearing..... 148..... 191..... M..... from Trig. Mast Pillar.
 2. Mast & Vanes have been painted white & black respectively.
 3. The standst. pillar was found on..... 2 July..... 1981..... dimensions now being:
Description of mark: S.I. Pillar should be explicit, e.g., S/Steel Pillar Plate, Steel plug, Brass plug, Bolt, G.I. Pipe
Height of mark..... 1.575..... m. above G.L.
Height of Top Vanes to Top Mast Pillar plate..... 1.410..... m. Diameter of Vanes (vertical)..... 750..... m.
 4. A..... Concrete..... set in conc/rock has been placed /found, bearing..... 297..... °M from Mast Plug Pillar
 5. A..... Concrete..... set in conc/rock has been placed /found, bearing..... 308..... °M from Mast Plug Pillar
 6. A..... G.I. Pipe..... set in conc/rock has been placed /found, bearing..... 241..... °M from Mast Plug Pillar
 7. A..... Concrete..... set in conc/rock has been placed /found, bearing..... °M from Mast Plug Pillar
 8. Action required.....

STANDPOINT: <u>Concrete</u>	Mark	Direction	Horiz. Distance	Height Difference	Direction	Trig. Dist.	Height Difference
<u>Bright Pillar</u>	<u>Bright Pillar</u>	<u>0 00</u>	<u>0 00</u>	<u>above standst.</u>	<u>0 00</u>	<u>0 00</u>	<u>above standst.</u>
<u>Vancent Pillar</u>	<u>Vancent Pillar</u>	<u>110 35 46</u>	<u>110 35 27</u>	<u>above standst.</u>	<u>110 35 27</u>	<u>110 35 27</u>	<u>above standst.</u>
<u>Barabara Spur (?)</u>	<u>Conc. obj. pillar</u>	<u>184 43 26</u>	<u>184 07 49</u>	<u>above standst.</u>	<u>184 41 58</u>	<u>2 336</u>	<u>above standst.</u>
<u>G.I. Pipe</u>	<u>Barabara Spur (?)</u>	<u>210 51 16</u>	<u>3 346</u>	<u>1 707</u>	<u>227 05 30</u>	<u>2 700</u>	<u>1 132</u>
<u>Bronze Trig. Pn.</u>	<u>G.I. Pipe</u>	<u>324 07 04</u>	<u>2 336</u>	<u>1 573</u>	<u>345 10 06</u>	<u>3 368</u>	<u>1 167</u>
<u>Gaffer Nail</u>	<u>Gaffer Nail</u>	<u>336 35 10</u>	<u>5 612</u>	<u>1 743</u>	<u>.....</u>	<u>.....</u>	<u>above standst.</u>

Prepared by: Checked:
Noted on U.T.M. Card

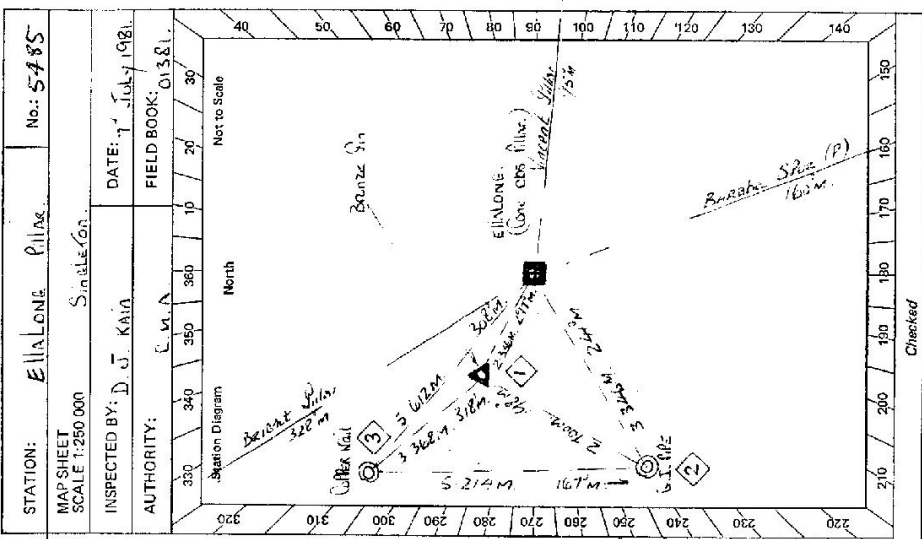

GS 24

STATION	ELLALONG PILLAR TS 5485
<p>Owner's Name: <u>COAST & ALLIED Pty Ltd</u> Address: <u>15/161 Valley Colliery</u> Phone: <u>(043) 588 147</u> Access Report of: <u>1/4/1988</u> was found suitable/<u>unsuitable</u>.</p> <p>St: <u>P.O. Doyleston</u> Contact: <u>Mr. Bill Flett</u> Phone: <u>(043) 588 146 Business</u> Access</p> <p><u>KN</u></p>	<p>Owner's Name: <u>ELLALONG PILLAR</u> Address: <u>On Property MR. LEE SWEETMAN</u> Phone: <u>(044) 981 228</u></p> <p>0.0. <u>ELLALONG POST OFFICE TENDRIL NORTH ALONG RUGBY STREET</u> <u>TOWARD CESSNOCK.</u></p> <p>0.4 <u>TURN LEFT INTO HUNTER STREET.</u></p> <p>0.9 <u>WOODROW HOUSE ON LEFT, PROCEED THROUGH IRON GATE & TAKE TRACK TO RIGHT.</u></p> <p>1.5 <u>PASS TRACK ON LEFT THEN TURN LEFT, THEN TURN LEFT FOLLOWING FAINT TRACK UP HILL.</u></p> <p>2.0 <u>ELLALONG CONC. ABS. PILLAR.</u> <u>4WD ACCESS ONLY.</u> <u>NOT POSSIBLE TO DRIVE TO STATION WHEN WET.</u></p>
<p>Beacon Diagram</p> <p>Not to Scale</p> <p>1.75m</p> <p>1.41m</p> <p>1.41m</p> <p>Station</p> <p>Station Mark (Metal Pipe)</p> <p>Cairn</p> <p>Station</p> <p>Aerial Photo</p> <p>Ground Level</p>	<p>This section to be completed by officer constructing pillar.</p> <p>Original station mark found/<u>not found</u>.</p> <p>Description of mark: <u>Stone pillar</u></p> <p>Original beacon <u>found</u>/<u>not found</u>.</p> <p>Description of beacon:</p> <p>Height Top of Vanes to Top Mark:m.</p> <p>Height of mark: <u>0.20m</u> above rock/<u>0.10m</u> below G.L.</p> <p>Diameter of Vanes:m. Height of Cairn:m.</p> <p>Original Beacon <u>found</u>/<u>not found</u>/<u>destroyed</u> by: <u>cars</u>.</p>
<p>Date</p>	<p>Record of Station</p>

CENTRAL MAPPING AUTHORITY

GEODETIC SURVEY OF NSW

GEODETIC STATION RECONNAISSANCE and MAINTENANCE REPORT

Description:

Note: Cross out word or words which do not apply

1. Cleared by lanes bearing 153° 103° M.
2. Mast & Vanes have been painted white & black respectively. ✓
 Mast & Vanes were ~~replaced~~ ~~reconnected~~ on 21.1.1934, dimensions now being:
 Description of mark: ~~S/S~~ ~~Pillar~~ ~~Plate~~ should be explicit, e.g., S/Steel Pillar Plate, Steel plug, Brass plug, Bolt, G.I. Pipe
 Height of mark: 1.415 m above ~~rock~~/concrete; Mark is 1.515 m above G.L.
 Height of Top Vanes to Top ~~mark~~/Pillar plate 1.440 m. Diameter of Vanes (vertical) 75P
 Height of Cairn m. Diameter of Cairn m. Name Plate found/~~replaced~~/placed.
 Length of Mast 1.540 m. (~~approximate if substituted~~)
4. A set in conc/rock has been placed/found, bearing ° M from Mast/Plug/Pillar
5. A set in conc/rock has been placed/found, bearing ° M from Mast/Plug/Pillar
6. A set in conc/rock has been placed/found, bearing ° M from Mast/Plug/Pillar
7. A set in conc/rock has been placed/found, bearing ° M from Mast/Plug/Pillar
8. Action required:

STANDPOINT:

Mark	Direction	Horiz. Distance	Height Difference	Mark	Direction	Horiz. Distance	Height Difference
			above standpt.				above standpt.
			below				below
			above standpt.				above standpt.
			below				below
			above standpt.				above standpt.
			below				below
			above standpt.				above standpt.
			below				below
			above standpt.				above standpt.
			below				below

Prepared by: D. KAIN

Checked: Noted on U.T.M. Card

SY 2733-1

STATION: ELLABONG Conc. Obs. (P) No.: TS 5485
 MAP SHEET SCALE 1:250 000
 INSPECTED BY: D. J. KAIN DATE: 21 JANUARY 1984
 AUTHORITY: C. M.A. FIELD BOOK:
 Station Diagram North
 330 340 350 360 370 380 390 400
 220 230 240 250 260 270 280 290 300 310 320
 140 130 120 110 100 90 80 70 60 50 40
 Not to Scale
 MASS AND VANES MISSING FROM THIS STATION.
 MASS & VANES WERE REPLACED. NEW MEASUREMENTS OTHER SIDE.
 4

GS 24

<p>STATION ELLALONG CONC. PILE TS 5485</p> <p>Owner's Name: CONAL S. ALLIEN PTY. LTD. Address: 120/130 VANDER KAMPEY COLLIERY Phone: (043) 588 747 Access Report of: 7.7.1984</p> <p>Current Equipment: MR. LEE SWEETMAN Address: THE SWEETMANS HALL STREET, PASADENA Phone: (043) 981 228 MR. SWEETMAN FOR KEY 8' O'CLOCK OR AFTER NIGHT BEFORE VISITING SUNDAY.</p> <p>Access Report of: 7.7.1984 was found restorable/unsuitable.</p>	<p>0.0 ELLALONG POST OFFICE, TRAVEL NORTH ALONG RUGBY STREET TOWARDS CESSNOCK.</p> <p>0.4 TURN LEFT INTO HUNTER STREET.</p> <p>0.9 WOODEN HOUSE ON LEFT, PROCEED THROUGH *LOCKED IRON GATE * AND TAKE TRACK TO YOUR RIGHT.</p> <p>1.5 PASS TRACK ON LEFT THEN TURN LEFT FOLLOWING FAINT TRACK UP HILL.</p> <p>2.0 ELLALONG CONC. PILE.</p> <p>LOW RAINAGE COULD BE REQUIRED FROM ABOUT 1.60 KMS.</p>
<p>Beacon Diagram</p> <p>Not to Scale</p>	<p>This section to be completed by officer constructing pillar.</p> <p>Original station mark found/not found.</p> <p>Description of mark:</p> <p>Original beacon found/not found.</p> <p>Description of beacon:</p> <p>Height Top of Vanes to Top Mark:m.</p> <p>Height of mark:m. above G.L. below</p> <p>Diameter of Vanes:m. Height of Cairn:m.</p> <p>Original Beacon has/not been destroyed by me.</p>
	<p>Date</p> <p>Record of Station</p>