



TS 5472 STATION RANDWICK PARKVIEW TS

Owners Name: .....  
 Current Occupant: .....  
 Address: .....  
 Address: .....

6-Nov-1975  
 CONVENTIONAL VEHICLE

Take the Denman Road from Jareys farms for about 8 miles.  
 Turn left into the road giving access to Woodlands and  
 "Randwick Park" property (second house on left)  
 Access is past this house, through the house.  
 paddock and thence to trig. ~~Gate~~

Note Owner insists on being contacted.  
 by all visitors to the trig station.  
 Timber is not to be cleared without  
 owners permission.

Observations not to be used.

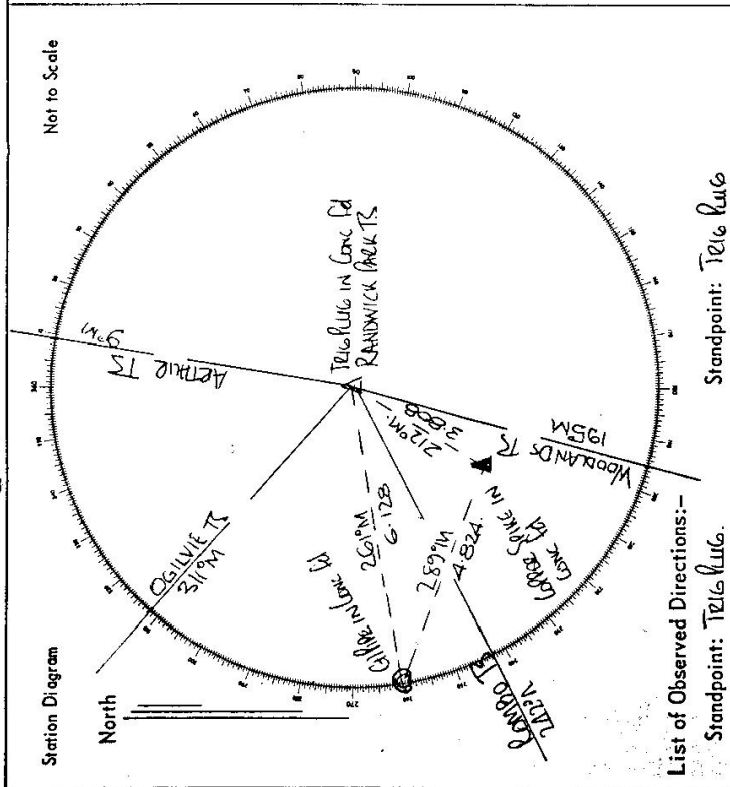

List of Observed Directions:-

Station	Direction	Station	Direction
OGLIVE TS	389.59	OGLIVE TS	389.59
ACTRAIR TS	56.35	ACTRAIR TS	56.35
WOODLANDS TS	20.0	WOODLANDS TS	20.0
RANWICK TS	2.9	RANWICK TS	2.9
GILFIE IN CONC PD	6.125	GILFIE IN CONC PD	6.125
WOODLANDS TS	19.5	WOODLANDS TS	19.5
ACTRAIR TS	9.6	ACTRAIR TS	9.6
OGLIVE TS	311.0	OGLIVE TS	311.0
TELUG IN CONC PD	0.0	TELUG IN CONC PD	0.0



Not to Scale

Station Diagram

North

74-98

TRIGONOMETRICAL SURVEY OF N.S.W.

CENTRAL MAPPING AUTHORITY

RECONNAISSANCE and MAINTENANCE REPORT

Department of Lands

STATION **RANDWICK PARK (Pillar) T.S. 5472**

Note: Cross out word or words which do not apply

This Trig. Station has been:

Co: **DURHAM** Ph: **WYNN**  
 Map Sheet: **MUSGRAVE SOUTH No 9033**  
 Inspected by: **DAVID J. HALL** Date: **1st December 1975**  
 Authority: Field Book: **013-07**

1. Completely cleared to permit 360° vision to surrounding Trigs. ✓
2. Cleared by lanes bearing ..... from Trig. Mast
3. Trig. Mast & Vanes have been painted white & black respectively. ✓  
AND NOT PAINTED
4. The Trig. was unpiled/..... dimensions now being:  
 Description of mark: **Steel Pipe** should be explicit, e.g. Steel plug, Brass plug, Bolt, G.I. Pipe  
 Height of mark: **0.31** m above **rock/concrete** AT ..... m above G.L.  
 Height of Top Vanes to Top **Mast**: **3.98** m. Diameter of Vanes (vertical): **0.150** m.  
 Height of Cairn: ..... m. Diameter of Cairn: ..... m.

- Length of Mast: ..... m. (approximate if not unpiled)  
Concrete 1.016
5. **A. Pillar** set in conc/rock has been placed **2.083** m. bearing **169** °M from Trig. Mast  
found
6. **Concrete Nail** set in conc/rock has been placed **3.063** m. bearing **251** °M from Trig. Mast  
found
7. **A. G.I. Pipe** set in conc/rock has been placed **3.363** m. bearing **171** °M from Trig. Mast
8. **A.** set in conc/rock has been placed ..... m. bearing ..... °M from Trig. Mast  
Original Station Measurements Balance
9. Connection **Steel Nail to G.I. Pipe**: **3.632** m. bearing **112** °M  
Original Station Measurements Balance
10. Connection **1.616** m. to **Steel Nail**: **3.808** m. bearing **215** °M
11. Connection **1.616** m. to **G.I. Pipe**: **4.430** m. bearing **169** °M
12. Connection ..... to ..... m. bearing ..... °M
13. Diff. Ht. **Steel Pillar** is **1.428** m. above **Pillar Plate**
14. Diff. Ht. **Concrete Nail** is **1.528** m. above **Pillar Plate**
15. Diff. Ht. **G.I. Pipe** is **1.647** m. above **Pillar Plate**
16. Diff. Ht. ..... is ..... m. above/below

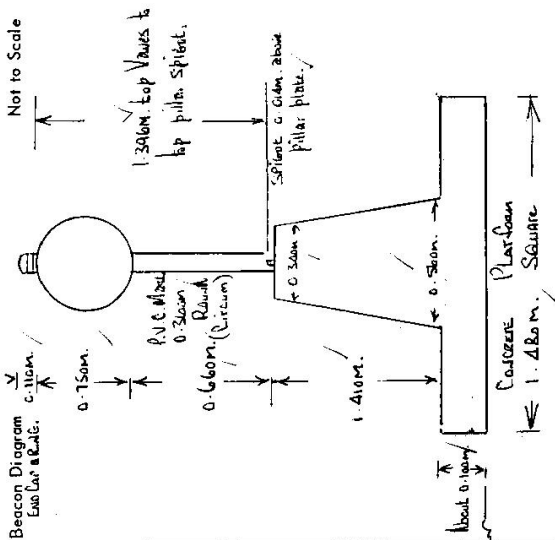

Date	Record of Station

Prepared by: ..... Checked: **SD 7/10/76** Noted on U.T.M. Card

STATION RANDWICK PARK (Pillar) T.S. 5472

Owners Name: MR. JAN WOLFGANG / Current Occupant: C. GAZDAR

Address: 546 MY ACCESS REPORT / Address: .....

UNDERGROUND

Access 1-12-1975 Access to RANDWICK PARK (Pillar) T.S.

AT MUSWELLBROOK POST OFFICE AT 0.0 MILES, TRAVEL TOWARD DENMAN. FEATURE

- MILEAGE
- 0.20. PASS SINGLETON / STONEY ROAD ON YOUR LEFT.
  - 5.85. TAKE SEALED ROAD TO YOUR LEFT, SIGNPOSTS, 2.6 KM. JERRYS PLAINS, SYDNEY.
  - 15.40. AT T JUNCTION TAKE BRADSHAW ROAD TO YOUR RIGHT, SIGNPOSTS, MAIN ROAD, DENMAN 19 KM.
  - 17.85. TAKE SEALED TO YOUR LEFT, SIGNPOSTS, (RANDWICK PARK HOMESTEAD, JAN WOLFGANG)
  - 18.75. TAKE ROAD TO YOUR LEFT TO, RANDWICK PARK HOMESTEAD.
  - 19.00. THROUGH IRON GATE BEHIND HOUSE, FOLLOW TRACK THAT WORKS ITS WAY UP VERY GENTLE SLOPE TO YOUR LEFT.
  - 19.30. THROUGH IRON GATE, FOLLOW TRACK THAT WORKS ITS WAY UP VERY GENTLE SLOPE TO YOUR LEFT.
  - 20.10. TRIG. PILLAR.

THIS STATION IS OF VERY EASY ACCESS AND IN DRY WEATHER COULD BE DRIVEN TO BY STATION SEDAN TYPE VEHICLE.

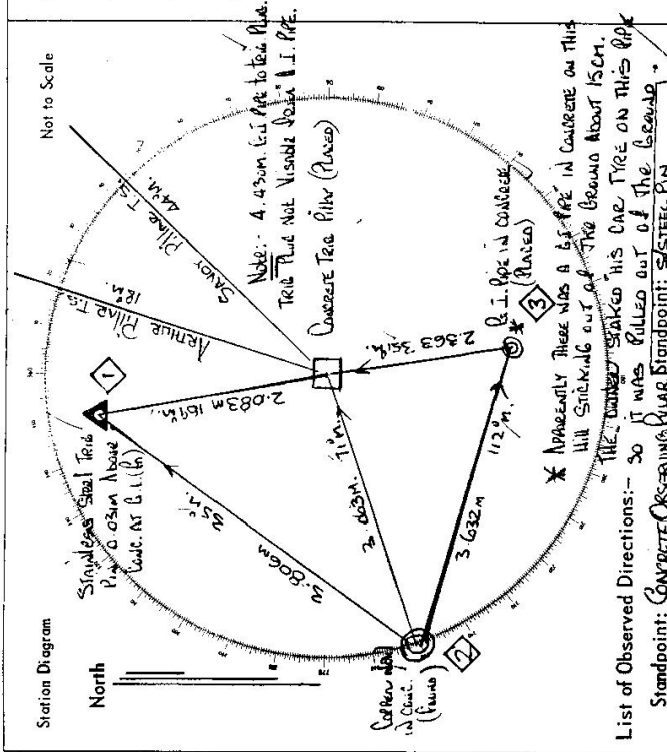

List of Observed Directions: - 30 IT WAS PULLED OUT OF THE GROUND

Stamdpint: CONCRETE OBSERVING PILLAR STAMPPOINT: STEEL PIN

Station	Direction	Station	Direction
SAVOY PILLAR T.S.	0 00	SAVOY PILLAR T.S.	0 00
COPPER NAIL	175 10	LONG OBS PILLAR	171 32
STEEL PIN	208 05	COPPER NAIL	174 58
ARTHUR PILLAR T.S.	301 31	ARTHUR PILLAR T.S.	355 41
ARTHUR PILLAR T.S.	355 41		

Station	Direction	Station	Direction
ARTHUR PILLAR T.S.	0 00		
STEEL PIN	19 16		
SAVOY PILLAR T.S.	24 17		
LONG OBS PILLAR	52 21		
G.I.P.F.E	97 36		

7-4-88

CENTRAL MAPPING AUTHORITY  
Department of Lands

Trigonometrical Survey of N.S.W.

RECONNAISSANCE and MAINTENANCE REPORT

STATION RANDWICK PARK NEW O.P. 5472

This Trig. Station has been:-

Note: Cross out word or words which do not apply

- 1. Completely cleared to permit 360° vision to surrounding Trigs. ✓
- 2. Cleared by lones bearing..... from Trig. Mast
- 3. Trig. Mast & Vanes have been painted white & black respectively. ✓
- 4. The Trig. was unpiled/ ~~set~~ <sup>re-set</sup>, dimensions now being:

Co: DU/RHAM Ph: WYNN  
 Map Sheet: MUSWELLBROOK-SOUTH No: 9033-S  
 Inspected by: C. J. BROWN Date: 6<sup>th</sup> January '76  
 Authority: C. M. A. Field Book: 1477

Beacon Diagram

Not to Scale

Description of mark Concrete Observation Pillar should be explicit, e.g. Steel plug, Brass plug, Bolt, G.L. Pipe

Height of mark..... m <sup>above</sup> ~~below~~ rock/concrete ..... 1.49 m <sup>above</sup> ~~below~~ G.L. ✓

Height of Top Vanes to Top Mark 1.412 m. / Diameter of Vanes (vertical) 0.754 m. /

Height of Centre..... m. Diameter of Centre..... m.

Length of Mast 0.658 m. (approximate if not unpiled)

5. A Copper Al set in conc/ ~~rock~~ has been placed... 3.063 m. bearing 246 °M from Trig. Mast

6. A Trig. Pila set in conc/ ~~rock~~ has been placed... 2.022 m. bearing 340 °M from Trig. Mast

7. A..... set in conc/soil has been placed..... m. bearing..... °M from Trig. Mast

8. A..... set in conc/rock has been placed..... m. bearing..... °M from Trig. Mast

9. Connection Sp Trig to Copper Al..... 3.805 m. bearing 213 °M

10. Connection..... to..... m. bearing..... °M

11. Connection..... to..... m. bearing..... °M

12. Connection..... to..... m. bearing..... °M

13. Diff. Ht. Copper Nail in Conc is 1.522 m. <sup>above</sup> ~~below~~ Pillar Plate.

14. Diff. Ht. Trig Sp. Pila in Conc is 1.424 m. <sup>above</sup> ~~below~~ Pillar Plate.

15. Diff. Ht. .... is .. m. <sup>above</sup> ~~below~~

16. Diff. Ht. .... is .. m. <sup>above</sup> ~~below~~

Prepared by: C. J. Brown Checked: S. Williams Noted on U.T.M. Card

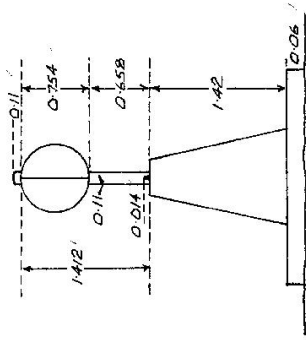

Date	Record of Station

Checked

C. J. B. 21/1/76  
SENIOR TRIGONOMETRICAL SURVEYOR

STATION RANDWICK PARK NEW O.P.

TS 5472

Owners Name.....  
 Address.....  
 Access.....

Current Occupant.....  
 Address.....  
 Access.....

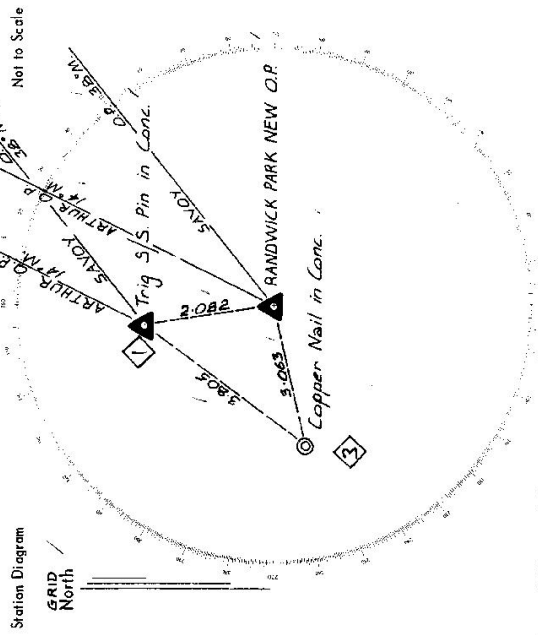

List of Observed Directions:-

Standpoint: Conc. Observation Piller Standpoint: Trig 5/5 Pin in Conc. /

Station	Direction	Station	Direction
ARTHUR O.P.	359 .59 .60	ARTHUR O.P.	359 .59 .60
SAYOY O.P.	24 .18 .53	SAYOY O.P.	24 .18 .56
Copper Nail in Conc.	232 .85	Pillar Spigot	145 .50
Trig 5/5 Pin in Conc.	325 .50	Copper Nail in Conc.	199 .18

Station	Direction	Station	Direction

Department of Lands  
 This Trig. Station has been:-  
 STATION **Randwick Park** (P) is **5472**

Integral survey of N.S.W.  
 RECONNAISSANCE and MAINTENANCE REPORT 5472  
 Co: **DURHAM** Ph: **WYNN**  
 Map Sheet: **Muswellbrook** No: **3033**  
 Inspected by: **R. GRAHAM** Date: **18-12-76**  
 Authority: **Integration Surveys** Field Book: **CS 289**

Note: Cross out word or words which do not apply  
 This Trig. Station has been:-  
 1. Completely cleared to permit 360° vision to surrounding Trigs.  
 2. Cleared by lanes bearing                      from Trig. Mast  
 3. Trig. Mast & Vanes have been painted white & black respectively.  
 4. The Trig. was unpiled/~~replaced~~, dimensions now being:  
 Description of mark: **Concrete Pillar** should be explicit, e.g. Steel plug, Brass plug, Bolt, Concrete Pillar  
 Height of mark: 1.41 m above ~~mark~~ concrete 1.41 m above G.L.  
 Height of Top Vanes to ~~mark~~ Top pillar plate 1.41 m Diameter of Vanes (vertical) 0.75 m.  
 Height of Cairn 1.41 m. Diameter of Cairn 0.35 ~~0.57~~ m.  
 Length of Mast: 1.54 m. (approximate if not unpiled)

5. A. ~~Copper Spike~~ set in conc/~~mark~~ has been placed/fd 3.065 m, bearing 252 °M from Trig. ~~mark~~ pillar
6. ~~Trig. Plug~~ set in conc/~~mark~~ has been placed/fd 2.082 m, bearing 343 °M from Trig. ~~mark~~ pillar
7. ~~AGI Pipe~~ set in conc/~~mark~~ has been placed/fd 0.128 m, bearing 261 °M from Trig. ~~mark~~ pillar
8. A. ~~set in conc/rock~~ has been placed/fd            m, bearing            °M from Trig. Mast/pillar
9. Connection: ~~Copper Spike~~ to Trig. Plug: 3.806 m, bearing 272 °M
10. Connection: ~~GI Pipe~~ to Trig. Plug: 0.128 m, bearing 261 °M
11. Connection:            to            m, bearing            °M
12. Connection:            to            m, bearing            °M
13. Diff. Ht. ~~Copper Spike~~ is 1.425 m, ~~above~~ below **Pillar Plate**
14. Diff. Ht. ~~Trig. Plug~~ is 1.525 m, ~~above~~ below **Pillar Plate**
15. Diff. Ht.            is            m, ~~above~~ below
16. Diff. Ht.            is            m, ~~above~~ below

Prepared by: L.M. Hayes Checked:             
 Date: 1-12-76 Record of Station: Pillar Erected

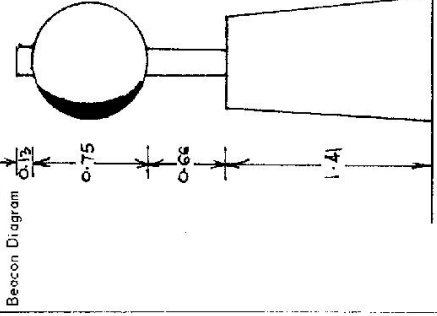

STATION Randwick Park (P) TS 5472.

Owners Name.....  
Current Occupant.....

Address.....  
Address.....

Access 18-12-1976  
Conventional Vehicle

Take Denman Rd from Jemys Plains for about 8 miles  
Turn left into road giving access to Woodlands" and  
"Randwick Park" property (second house on left)  
Access is past this house through the house paddock  
and thence thru several gates to trig.

NB Owner insists on being contacted by ALL visitors  
to trig station.  
Timber is not to be cleared without owners  
permission

D. West, Government Printer, New South Wales - 1976

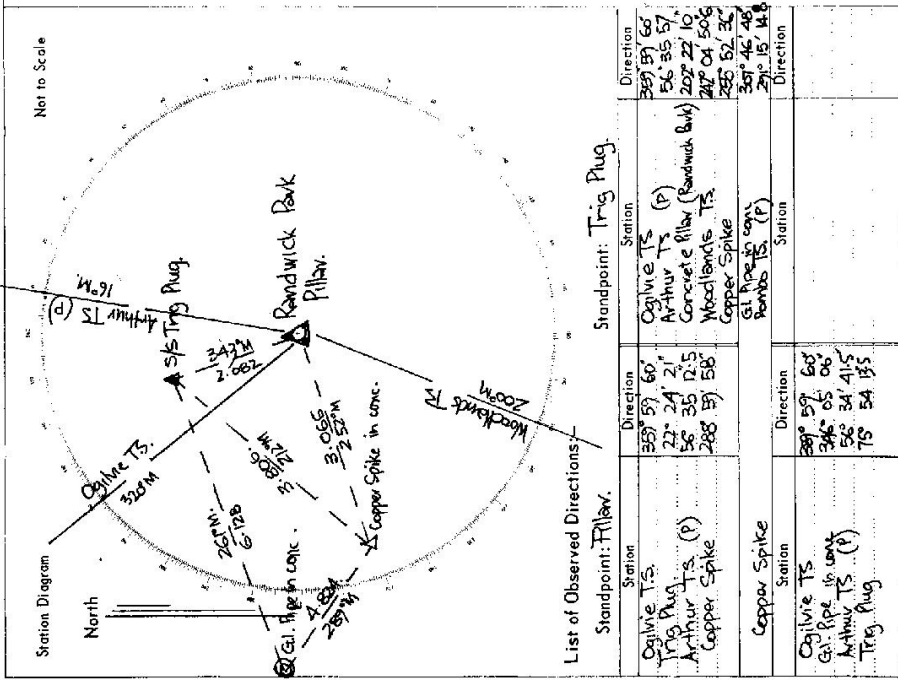



GEODETIC SURVEY OF N.S.W.

CENTRAL MAPPING AUTHORITY

GEODETIC STATION RECONNAISSANCE and MAINTENANCE REPORT

STATION: **RAWDNICK PARK** No.: **5472**  
 MAP SHEET **SINGLETON** 1:250 000  
 INSPECTED BY: **C. ZAHERA** DATE: **18-7-79**  
 AUTHORITY: **C.M.A.** ANGLE BOOK: **1612/36**

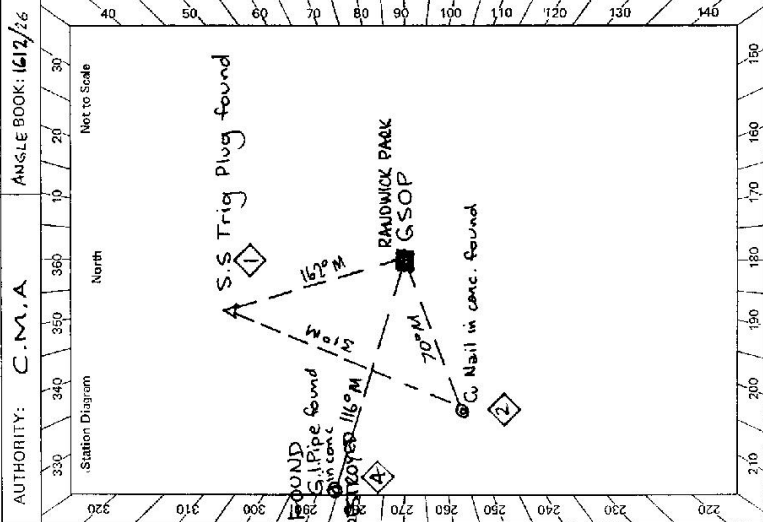

- Description: *Note: Cross out word or words which do not apply*
- Cleared by James-bearing: **36.0°** from Trig. Mast
  - Mast & Vanes have been painted white & black respectively.
  - The station/mast was ~~unplaced~~<sup>found</sup> ~~not~~<sup>unplaced</sup> ~~constructed~~<sup>constructed</sup> on **10** ~~dimensions~~<sup>dimensions</sup> ~~new~~<sup>new</sup> ~~height~~<sup>height</sup>
  - Description of mark: ~~S/Steel Pillar~~<sup>S/Steel Pillar</sup> should be explicit, e.g., S/Steel Pillar Plate, Steel plug, Brass plug, Bolt, G.I. Pipe  
 Height of mark: **1.40** ~~m.~~<sup>m.</sup> ~~above~~<sup>below</sup> ~~rock~~<sup>rock</sup>/~~concrete~~<sup>concrete</sup>; **1.40** ~~sec over~~<sup>sec over</sup> ~~1.40~~<sup>1.40</sup> ~~m.~~<sup>m.</sup> ~~above~~<sup>below</sup> ~~G.L.~~<sup>G.L.</sup>  
 Height of Top Vanes to Top Mark/Pillar plate ~~.....m.~~<sup>.....m.</sup> ~~1.40~~<sup>1.40</sup> ~~m.~~<sup>m.</sup> ~~above~~<sup>below</sup> ~~G.L.~~<sup>G.L.</sup> Diameter of Vanes (vertical) **0.75** ~~m.~~<sup>m.</sup>  
 Height of Cairn ~~.....m.~~<sup>.....m.</sup> ~~Diameter of Cairn~~<sup>Diameter of Cairn</sup> Name Plate found/not found/placed.  
 Length of Mast **0.65** ~~m.~~<sup>m.</sup> (approximate if not applied) ~~bottom vanes to pillar plate~~
  - A **S.S. Trig** plug set in conc/rock has been ~~placed~~<sup>placed</sup>/found, bearing **342°** ~~M~~<sup>M</sup> from Mast/Plug/Pillar
  - A **C.C. Nail** ~~.....set in conc/rock has been placed~~<sup>placed</sup>/found, bearing **250°** ~~M~~<sup>M</sup> from Mast/Plug/Pillar ~~destroyed~~
  - A **S.S. P.P.S.** ~~.....set in conc/rock has been placed~~<sup>placed</sup>/found, bearing **286°** ~~M~~<sup>M</sup> from Mast/Plug/Pillar
  - A ~~.....set in conc/rock has been placed~~<sup>placed</sup>/found, bearing ~~.....°~~ ~~M~~<sup>M</sup> from Mast/Plug/Pillar
  - Action required: **Replacement of S.S. Pipe in conc. if required.**

STANDPOINT:

Mark	Direction	Horiz. Distance	Height Difference	Mark	Direction	Horiz. Distance	Height Difference
			above standpt.				above standpt.
			below standpt.				below standpt.
			above standpt.				above standpt.
			below standpt.				below standpt.
			above standpt.				above standpt.
			below standpt.				below standpt.
			above standpt.				above standpt.
			below standpt.				below standpt.
			above standpt.				above standpt.
			below standpt.				below standpt.

Prepared by: **J. W. Robins, 24/7/79** Checked: **W. Fisher, 24/7/79** Noted on U.T.M. Card

GS

**STATION RANDWICK PARK GSOP IS 5472**

Owner's Name: Jon Wolfgang  
 Address: "Randwick Park"  
 Phone: Denman 472363  
 Current Occupant: .....  
 Address: .....  
 Phone: .....

**ACCESS 18-7-1979**

Access Report of 18/7/1979 was found suitable/unsuitable.  
 From Singleton & Jerry's Plains  
 0.0 km Single to RD Take Windsor Road N69  
 11.4 Major intersection Turn right towards Denman (Signposted) & Jerry's Plains  
 35.8 Jerry's Plains P.O. Continue towards Denman  
 46.7 Pass Edderton Road on RHS  
 49.1 End of Bitumen  
 49.7 Turn left into Bitumen road to "Woodlands Stud Farm" and "Randwick Park"  
 51.25 Properties (Signposted)  
 Turn left to "Randwick Park" (signposted) homestead. Drive around the house past  
 machinery sheds  
 51.65 Through iron & wire gates Continue up ridge towards hill  
 32.05 Through bon gate. Continue towards trig hill, then veer right following  
 faint track  
 52.7 Top of ridge, turn left and follow track up ridge through trees to GS  
 53.1 Randwick Park GSOP

**NOTES:** 1) Conventional vehicles may be driven to Trig  
 2) Owner insists on being contacted by all visitors to trig. No timber is to be cleared without his permission.

Beacon Diagram	Not to Scale
x 0.75 x 0.65 1.41 y	

This section to be completed by officer constructing pillar.  
 Original station mark found/not found: .....

Description of mark: .....

Original beacon found/not found: .....

Description of beacon: .....

Height Top of Vanes to Top Mark .....m.  
 Height of mark .....m. above G.L. / below G.L.  
 Diameter of Vanes .....m. Height of Cairn .....m.  
 Original Beacon has/has not been destroyed by me.

Date	Record of Station

SI 2733-2 D. West, Government Printer