

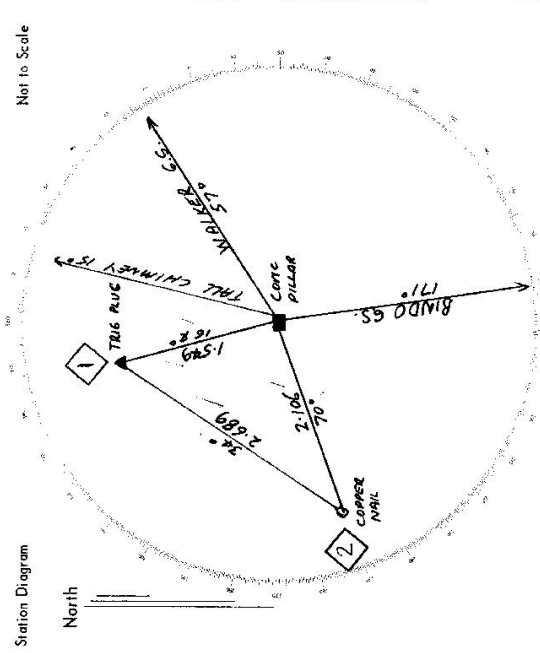

**STATION ANDY STACK 5457 G.S. (PILLAR)**

Owners Name.....  
 Current Occupant.....  
 Address.....  
 Address.....

Access 30-9-75  
 MILEAGE FROM LITHGOW TO RYDAL 10 MILE  
 00 T- JUNCTION. SODWALLS 19, HAMPTON ZI,  
 TAKE HAMPTON RD.  
 1-15 TURN RIGHT, TRACK TO HOUSE, (BLUE MAIL BOX).  
 PASS HOUSE AND THROUGH GATE.  
 FOLLOW TRACK BETWEEN SHEDS AND THROUGH GATE  
 FOLLOW TRACK TO T.S.



List of Observed Directions:-  
 Standpoint: PILLAR RATE  
 Standpoint: TRIG PLUG

Station	Direction	Station	Direction
BLINDO G.S.	0 00 00	CONC. PILLAR - OUT OF FALLS	0 00 00
COPPER NAIL	79 32 30	BLINDO G.S.	44 23 40
TRIG PLUG	172 53 50	COPPER NAIL	204 15 10
TRIG CHIMNEY	204 15 10	CHIMNEY	246 19 00
WALKER G.S.	246 19 30	WALKER G.S.	246 19 00

7-498

Trigonometrical Survey of N.S.W.

Department of Lands

RECONNAISSANCE and MAINTENANCE REPORT

STATION ANDY STACK\* 5457 O.P.

Co: COOK Ph: LIDSDALE  
 Map Sheet: KATOOMBAA No: 8930 - N  
 Inspected by: C. J. BROWN Date: 26<sup>th</sup> November '75  
 Authority: C.M.A. Field Book: 1472

Beacon Diagram Not to Scale

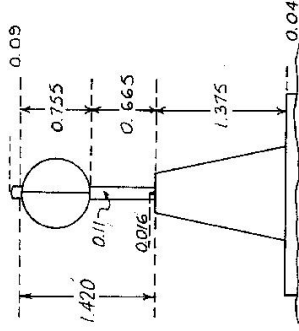

Note: Cross out word or words which do not apply

This Trig. Station has been:-

- 1. Completely cleared to permit 360° vision to surrounding Trigs.
- 2. Cleared by lanes bearing ..... from Trig. Mast
- 3. Trig. Mast & Vanes have been painted white & black respectively. ✓
- 4. The Trig. was unpiled/not unpiled, dimensions now being: \_\_\_\_\_

Description of mark: *Concrete Observation Pillar* ..... should be explicit, e.g. Steel plug, Brass plug, Bolt, G.I. Pipe  
 Height of mark: ..... m above ~~rock/concrete~~ G.L.  
 Height of Top Vanes to Top Mark: *1.42* m. Diameter of Vanes (vertical): *0.755* m.

Height of Cairn: ..... m. Diameter of Cairn: ..... m.

Length of Mast: *0.665* m. (approximate if not unpiled)

- 5. A. Trig. Plug set in conc/rock has been placed. *1.552 (1.42m)* bearing ..... *343*°M from Trig. Mast
- 6. A. Copper. Plug set in conc/soil has been placed. *2.168* m. bearing ..... *249*°M from Trig. Mast
- 7. A. .... set in conc/soil has been placed. .... m. bearing .....°M from Trig. Mast
- 8. A. .... set in conc/rock has been placed. .... m. bearing .....°M from Trig. Mast

9. Connection Trig. Plug to Copper. Nail: *2.631* m. bearing ..... *244*°M

10. Connection: ..... to: ..... m. bearing .....°M

11. Connection: ..... to: ..... m. bearing .....°M

12. Connection: ..... to: ..... m. bearing .....°M

13. Diff. Ht. Trig. Plug is *1.42M (1.42M)* ~~above~~ *Pillar Plate* below

14. Diff. Ht. Copper. Nail in Conc. is *1.544* m. ~~above~~ *Pillar Plate* below

15. Diff. Ht. .... is. .... m. ~~above~~ below

16. Diff. Ht. .... is. .... m. ~~above~~ below

*C. B. 5/11/76*  
 SENIOR TRIGONOMETRICAL SURVEYOR

Prepared by: *D. O'Shannessy* Checked: *[Signature]* Noted on U.T.M. Card

Date

Record of Station

Checked

STATION ANDY STACK 5457 01

Owners Name.....  
 Current Occupant.....  
 Address.....  
 Address.....  
 Address.....

Access 26-11-75

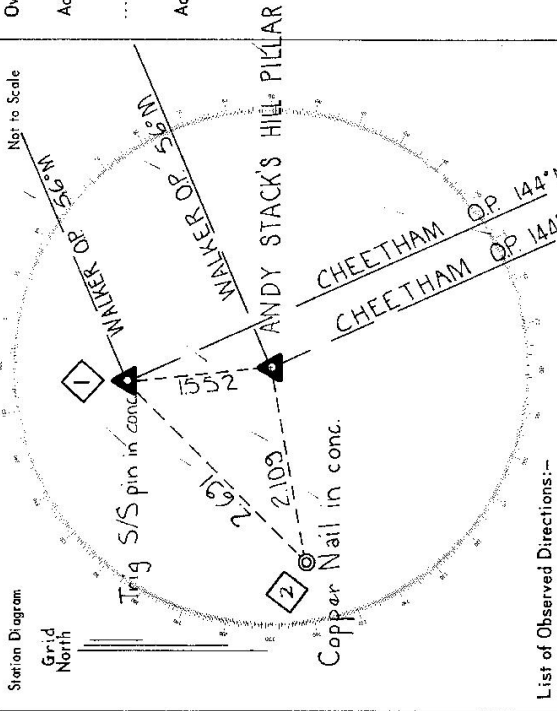

List of Observed Directions:-

Standpoint: Conc. Observation Pillar Standpoint: Trig S/S pin in conc.

Station	Direction	Station	Direction
WALKER O.P.	369.89.60	WALKER O.P.	359.59.69
CHEETHAM O.P.	88.40.86	CHEETHAM O.P.	88.40.23
Copper nail in conc.	193.15	Pillar Spigot	106.37
Trig S/S pin in conc.	286.39	Copper nail in conc.	158.06

Station	Direction	Station	Direction

