

CENTRAL MAPPING AUTHORITY

GEODETIC SURVEY OF N.S.W.

GEODETIC STATION RECONNAISSANCE and MAINTENANCE REPORT

STATION: NM/C1114 No.: 5292

MAP SHEET SCALE 1:250 000 NYNGBAN

INSPECTED BY: D. FREDRIKSEN DATE: 26/6/79

AUTHORITY: C. M. A. FIELD BOOK: 1572

Description: *Note: Cross out word or words which do not apply*

1. Cleared by lanes bearing..... from Trig. Mast
2. Mast & Vanes have been painted white & black respectively.
3. The station/pillar was unpiled/not unpiled/constructed on..... 19..... dimensions now being:  
Description of mark *Cl. Tube*..... should be explicit, e.g. S/Steel Pillar Plate, Steel plug, Brass plug, Bolt, G.I. Pipe  
Height of mark..... m. <sup>above</sup> rock/concrete; Mark is..... m. <sup>above</sup> <sub>below</sub> G.L.  
Height of Top Vanes to Top Mark/Pillar plate..... m. Diameter of Vanes (vertical)..... m.  
Height of Cairn..... m. Diameter of Cairn..... m. Name Plate found/not found/placed.  
Length of Mast..... m. (approximate if not unpiled)
4. A. *Steel* ~~Pillar~~ *RM* set in conc/rock has been ~~placed~~/found, bearing *3.42*... ° M from ~~Mast~~/Plug/Pillar
5. A..... *RM* set in conc/rock has been ~~placed~~/found, bearing *11.0*... ° M from ~~Mast~~/Plug/Pillar
6. A..... *RM* set in conc/rock has been ~~placed~~/found, bearing *2.29*... ° M from ~~Mast~~/Plug/Pillar
7. A. *Blaze on tree* set in conc/rock has been ~~placed~~/found, bearing *2.32*... ° M from ~~Mast~~/Plug/Pillar
8. Action required:.....

STANDPOINT: *Cu Tube in conc. fd.*

Mark	Direction	Horiz. Distance	Height Difference	Mark	Direction	Horiz. Distance	Height Difference
Blaze in tree	241° 53'		above standpt.				above standpt.
Tree pp1 7m High			below				below
Tree 6m High	288° 10'	73.9	above standpt.				above standpt.
Tree 6m High			below				below
Tree 6m High	260° 30'	24.8	above standpt.				above standpt.
Tree 6m High			below				below
Tree 7m High	35° 00'	108.6	above standpt.				above standpt.
			below				below
			above standpt.				above standpt.
			below				below

Prepared by: D. FREDRIKSEN 29/8/79

Checked: *df*

Checked

Noted on U.T.M. Card

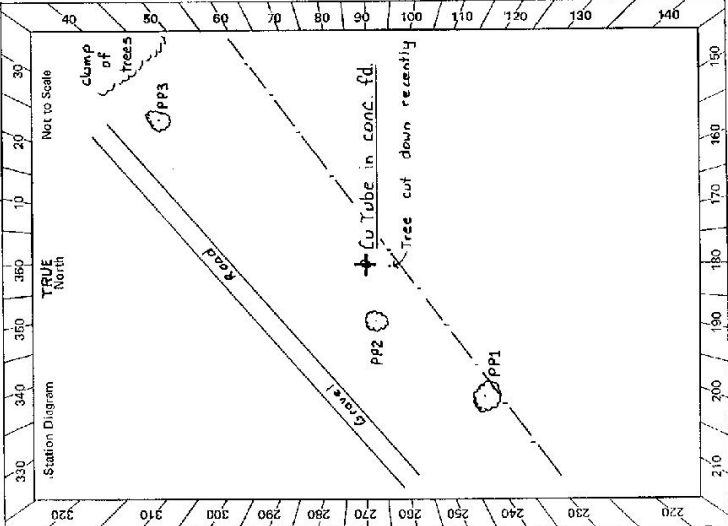

STATION NM/C/114 TS 5292

Owner's Name: .....  
 Address: .....  
 Phone: .....

Current Occupant: .....  
 Address: .....  
 Phone: .....

**ACCESS**

Access Report of 26/6/19. Was found suitable/unsuitable.  
**FEATURE**

At NEVERTIRE take the Tullamore Road in a South West direction  
 Pass over water channel at 'Gobbla' turn off.  
 Straight ahead towards 'Bogan River'.  
 Turn LEFT off bitumen 'Tabratong Lane'  
 Grid  
 Pass over water channel  
 Pass turn off to 'Tabratong t Quandong' on L.H.S.  
 NM/C/114 on L.H.S. of road see sketch.

KMS
0.0
8.3
14.1
18.9
22.4
27.0
27.4
28.4

NM/C/114 was pinned on C.M.A. photo NSW2170/37  
 " " " " R.A.S.C. " NSW2178/37

**Note**:- NM/C/114 appears to be forgotten on this photography and remains of a target were found at the site.

Date	Record of Station

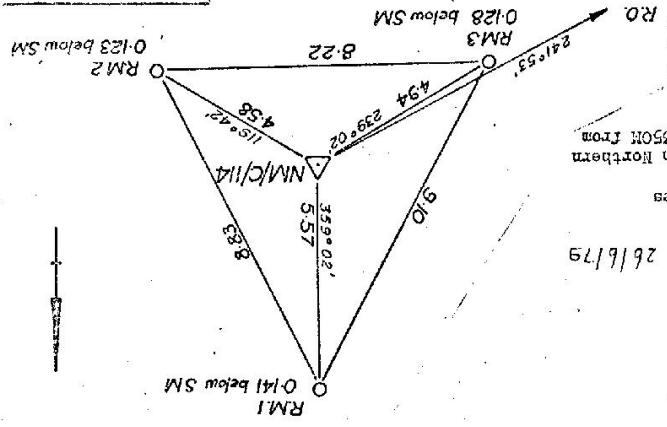

All marks found. 26/6/19  
 Bearings are true  
 Distances are in metres  
 RMs are steel pickets  
 RO is placed on tree on Northern  
 side of road approx. 350M from  
 RM/C/114.

Authority..... **DIVISION OF NATIONAL MAPPING**

**NM/C/114 TS 5292**

Original Station Established by: **Division of National Mapping** Date: **1971**

Existing Station Marked by: **Division of National Mapping** Date: **1971**

Reference Books: **NM: 9497, 10297, 10581, 11004, 11127, 11128, 11428**

Cadastral Location: **State New South Wales** Country/District

Parish/Hundred Allotment/Section/Portion

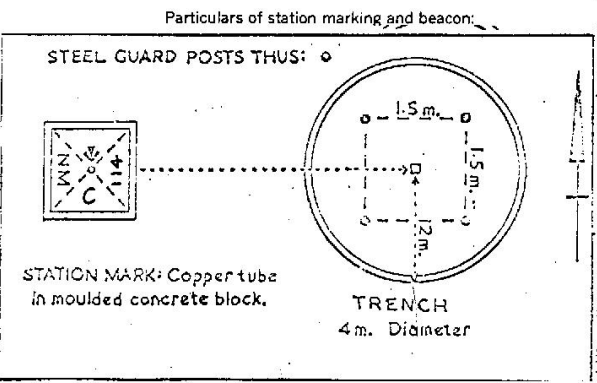
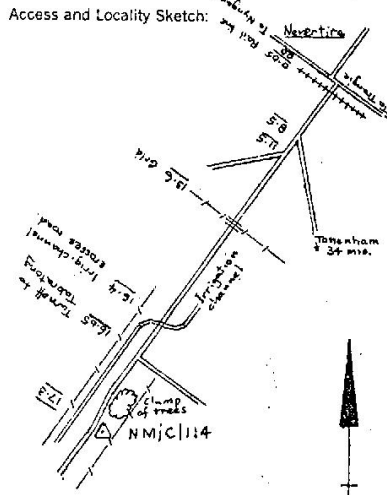

**NOT TO SCALE**  
**DISTANCES IN MILES**

