

74488

CENTRAL MAPPING AUTHORITY
Department of Lands

Trigonometrical Survey of N.S.W.

RECONNAISSANCE and MAINTENANCE REPORT

STATION **NORMAN T.S. 5166**

This Trig. Station has been:-

Note: Cross out word or words which do not apply

1. ~~Completely cleared to permit 360° vision to surrounding Trigs.~~
2. ~~Cleared by lanes bearing. No clearing required.~~ from Trig. Mast /
3. Trig. Mast & Vanes have been painted white & black respectively.
4. The Trig. was unpiled/not unpiled, dimensions now being: Original Station Mark found / not found

Description of mark *Cartridge case in conc. pit.* should be explicit, e.g. Steel plug, Brass plug, Bolt, G.I. Pipe /

Height of mark.....m above below rock/concrete m above below G.L.

Height of Top Vanes to Top Mark *4.405* m. / Diameter of Vanes (vertical) *0.210* m.

Height of Cairn.....m. Diameter of Cairn.....m.

Length of Mast *See diag* m. (approximate if not unpiled) /

5. A *large cairn with base of mast found placed approx. 2.30* m. bearing.....°M from Trig. Mast /
6. A..... set in conc./soil has been placed..... m. bearing.....°M from Trig. Mast
7. A..... set in conc./soil has been placed..... m. bearing.....°M from Trig. Mast
8. A..... set in conc./rock has been placed..... m. bearing.....°M from Trig. Mast

9. Connection.....to.....; m. bearing.....°M
10. Connection.....to.....; m. bearing.....°M
11. Connection.....to.....; m. bearing.....°M
12. Connection.....to.....; m. bearing.....°M
13. Diff. Ht. is..... m. above below
14. Diff. Ht. is..... m. above below
15. Diff. Ht. is..... m. above below
16. Diff. Ht. is..... m. above below

Prepared by: *P. K. B. AMOLA* Checked: *[Signature]*

Noted on U.T.M. Card *[Signature]*

Co: *B.L.D. - BENTINCK* / Ph: *TENTERFIELD*
Map Sheet: *Stanthorpe* / No: *9240-S*
Inspected by: *K. Zahra* / Date: *7-3-75*
Authority: *CMA 72/73* / Field Book: *014381*

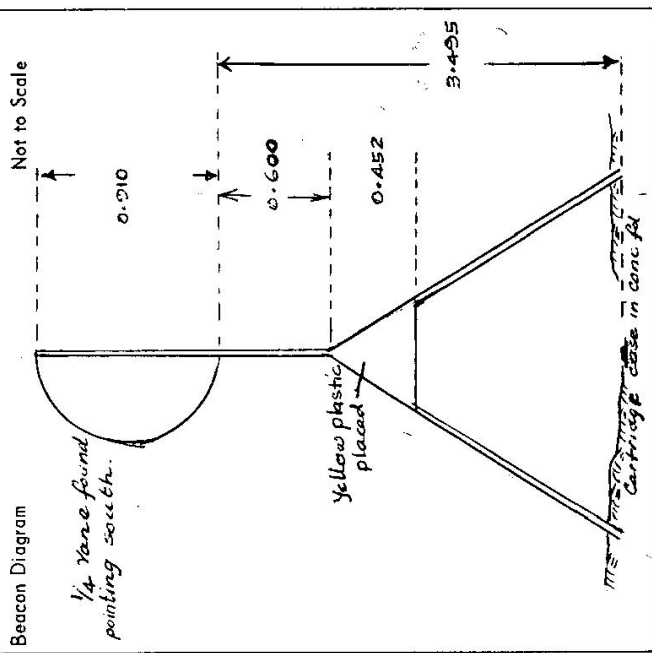

Date	Record of Station

Checked

STATION **NORMAN TS 5166**

Owners Name..... Current Occupant.....

Address..... Address.....

Access.....

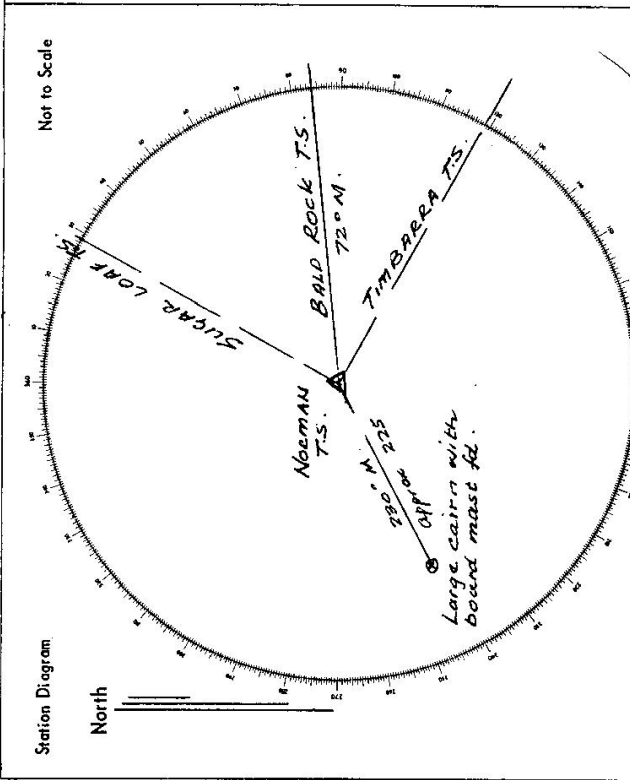

List of Observed Directions:-

Standpoint:	
Station	Direction

Standpoint:	
Station	Direction

6/6/

CENTRAL MAPPING AUTHORITY

GEODETIC SURVEY OF N.S.W.

GEODETIC STATION RECONNAISSANCE and MAINTENANCE REPORT

Description:

1. Cleared by lanes bearing..... *No trees at station*..... from Trig. Mast
 Note: Cross out word or words which do not apply
Success
2. Mast & Vanes have been painted white & black respectively, X ——— Vanes need replacement, occupied (no cairn - over-laid beacon)
3. The station/pillar was ~~unpiled/not-unpiled~~ constructed on..... 19.80....., dimensions now being: CARTRIDGE CASE FOUND
- Description of mark..... in Granite Rock should be explicit, e.g., S/Steel-Pillar-Plate-Steel-Plug, Brass plug, Bolt, G.I. Pipe—
- Height of mark..... 0.000 m. above rock/concrete— Mark is..... m. above G.L. *Vanes non-existent*
- Height of Top Vane-to Top Mark/Pillar-plate..... 2.885 m. Diameter of Vanes (vertical)..... m.
- Height of Cairn..... m. Diameter of Cairn..... m. Name Plate found/not found/placed.
- Length of Mast..... m. (approximate if not unpiled)
4. A LEAD PLUG "R.M. 1" set in ~~concrete~~ rock has been ~~placed~~ found, bearing..... ⁵⁵°M from Mast/Plug/Pillar
5. A LEAD PLUG "R.M. 2" set in ~~concrete~~ rock has been ~~placed~~ found, bearing..... 185°M from Mast/Plug/Pillar
6. A LEAD PLUG "R.M. 3" set in ~~concrete~~ rock has been ~~placed~~ found, bearing..... 301°M from Mast/Plug/Pillar
7. A..... set in conc/rock has been placed/found, bearing.....°M from Mast/Plug/Pillar

8. Action required:..... New Vanes & nameplate to existing (Original) over-head quadrupod.....

STANDPOINT: CARTRIDGE CASE in Rock found / STANDPOINT: "R.M. 3" LEAD PLUG in Rock found ✓

Mark	Direction	Horiz. Distance	Height Difference	Mark	Direction	Horiz. Distance	Height Difference
CAPOOMPETA (P)	175° 22' 17"	/	above standpt	CAPOOMPETA (P)	175° 22' 11"	/	above standpt
DOCTORS NOSE (P)	181° 44' 01"	/	above standpt	"R.M. 1"	100° 18' 54"	0.853	below standpt
"R.M. 2" LEAD PLUG found in Rock	195° 47' 10"	2.694	above standpt	Overhead Beacon Job in Quadrupod	131° 02' 30"	2.411	below standpt
"R.M. 3" LEAD PLUG found in Rock	311° 02' 29"	2.412	above standpt	CARTRIDGE CASE in Rock	131° 02' 45"	2.412	below standpt
"R.M. 1" LEAD PLUG found in Rock	65° 39' 20"	2.170	above standpt	"R.M. 2"	165° 26' 05"	4.315	below standpt
DAIRY (P)	162° 40' 59.5"	/	above standpt	SUGARLOAF (P)	27° 45' 04"	/	above standpt
SUNNYSIDE (P)	171° 30' 19.5"	/	above standpt	RIVERTREE (P)	66° 10' 45"	/	above standpt

Prepared by: *H. P. Jackson* 15/8/80 Checked: *10.2.80* Noted on U.T.M. Card

St 2733-1

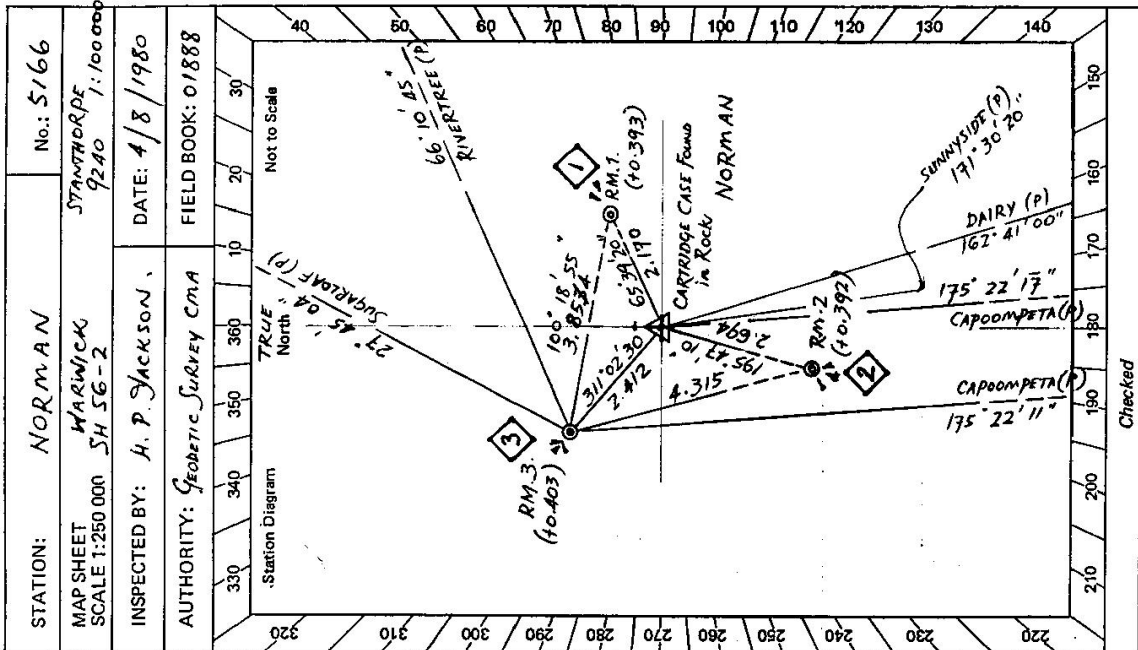

STATION: NORMAN No.: 5166

MAP SHEET WARRIWICK SH 56-2 STANTHORPE 9240 1:100,000

INSPECTED BY: H. P. JACKSON DATE: 4/8/1980

AUTHORITY: Geometric Survey CMA FIELD BOOK: 01888

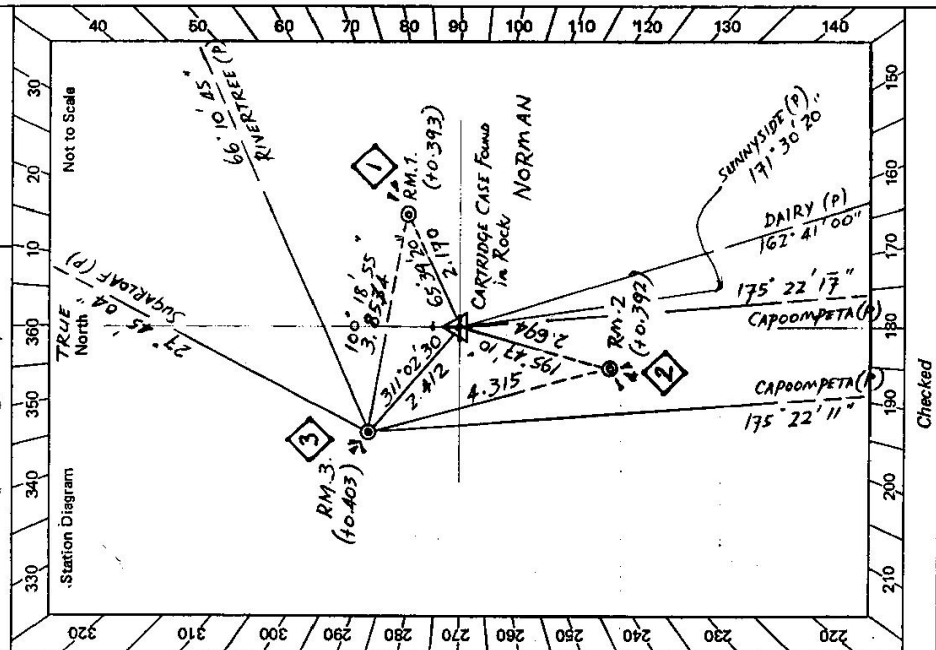

Checked

2733-2 D. West, Government Printer

STATION **NORMAN (2)** TS **5166**

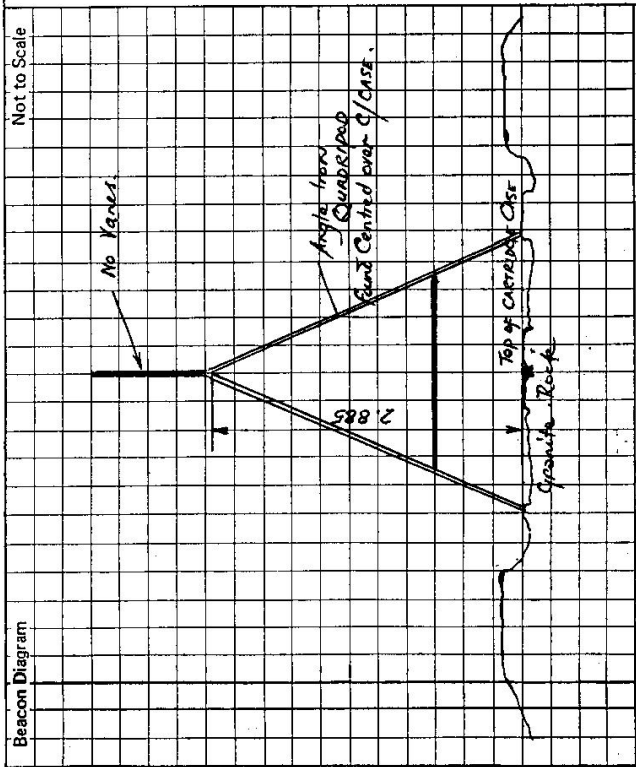

Owner's Name: **(PAUL GRIMSHAW) RANGER IN CHARGE**
 Address: **MT. NORMAN / CARRAMUEEN NATIONAL PARK**
 Phone: **(076) 84 5157**

Current Occupant:
 Address:
 Phone:

ACCESS
 Access Report of **4.8.1980** was found suitable/unsuitable.
 ACCESS SHOWN ON STATION SUMMARY CARD *Unsuitable*

- | KM | FEATURE |
|------|---|
| 0.00 | Travelling north into Wallangarra |
| 0.2 | Turn Right at Post OFFICE in a NE Direction |
| 0.5 | Turn Left |
| 0.9 | Turn right over rail bridge then turn left |
| 1.2 | Intersection, Follow bitumen. |
| 1.7 | Causeway, Follow bitumen. |
| 2.3 | Intersection Straight Ahead |
| 3.2 | Follow Bitumen |
| 3.3 | End of Bitumen. 112 Sup Coy's Army Buildings LHS + RHS |
| 3.4 | Follow main track LHS. |
| 4.7 | Turn right, over grid |
| 5.0 | Y Intersection. Turn right. Reservoirs R.H.S. |
| 5.1 | Go thru gate |
| 7.3 | Timber, netting gate LHS. Straight ahead |
| 7.7 | Hugh stone, rail gate RHS. Straight ahead |
| 8.3 | Rail gate LHS. Straight ahead |
| | Barriers on LHS. LEAVE VEHICLE. Do not turn left around barriers! |

This section to be completed by officer constructing pillar.
 Original station mark found/~~not found~~.
 Description of mark:
 Original beacon found/not found.
 Description of beacon:
 Height Top of Vanes to Top Markm.
 Height of markm. above G.L. below
 Diameter of Vanesm. Height of Cairnm.
 Original Beacon has/has not been destroyed by me.

Date	Record of Station
	Walk over barriers + along track for about 700m to a clearing then walk in general direction of 274°M for approx 1500m across granite fields following white painted lines around to back of MT. NORMAN. Start climbing rock at VERTICAL white painted lines to top of Mt Norman.
	APPROX. 40 mins climb including cliff. TAKE ROPES FOR CLIMB.