

7.5.10.3

Department of Lands  
 Integration of N.S.W.  
 RECONNAISSANCE and MAINTENANCE REPORT **TS 4988**  
 STATION **CAMPBELLTOWN S**  
 Co: **Cumberland** Ph: **ST Peters**  
 Map Sheet: **Campbelltown** No: **B222**  
 Inspected by: **M.W.S.B.** Date:  
 Authority: Field Book:  
 Beacon Diagram

Not to Scale

Note: Cross out word or words which do not apply

This Trig. Station has been:-

1. Completely cleared to permit 360° vision to surrounding Trigs.
2. Cleared by lanes bearing ..... from Trig. Mast

ABSTRACT OF OBSERVATIONS

To	R.L. (metres)	Direction or Vert. Angle	Variance	Observer	Date	Dist. in metres at M.S.L.	Variance	Inst.	Observer	Date
<p>STATION <b>CAMPBELLTOWN STH. RES.</b> R.L. <b>165.3</b> <small>STANDARD FOR TOP OF OBS. PLATE</small> meters</p> <p>See Reverse for Location Diagram.</p> <p><i>J. Nykl. 24th Jan. 1974</i></p> <p><i>Note: Lanes eccentric - public to water 45.36° - 0.003m (F. 4720 R.E. No. 1911)</i></p>										
<p>All directions Corrected to centre</p> <p>All Vert's corrected ground to ground</p>										

SEE REAR OF CARD FOR REMARKS.

13. Diff. Ht. .... is ..... m. above below

14. Diff. Ht. .... is ..... m. above below

15. Diff. Ht. .... is ..... m. above below

16. Diff. Ht. .... is ..... m. above below

Prepared by: \_\_\_\_\_ Checked: \_\_\_\_\_

Date \_\_\_\_\_ Record of Station \_\_\_\_\_

STATIONS 4988  Campbelltown S  
BEADBURY 4088

Current Occupant.....

Address.....

Owners Name.....

Address.....

Access

STATION CAMPBELLTOWN STH.RES (centre)

To

Remarks

Station Diagram

North

Not to Scale

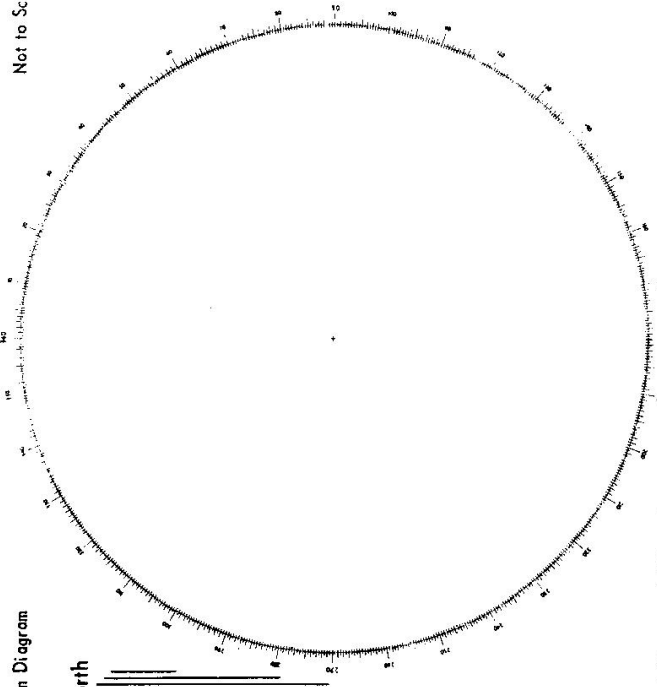

List of Observed Directions:-

Standpoint:

Station	Direction	Station	Direction

Station	Direction	Station	Direction

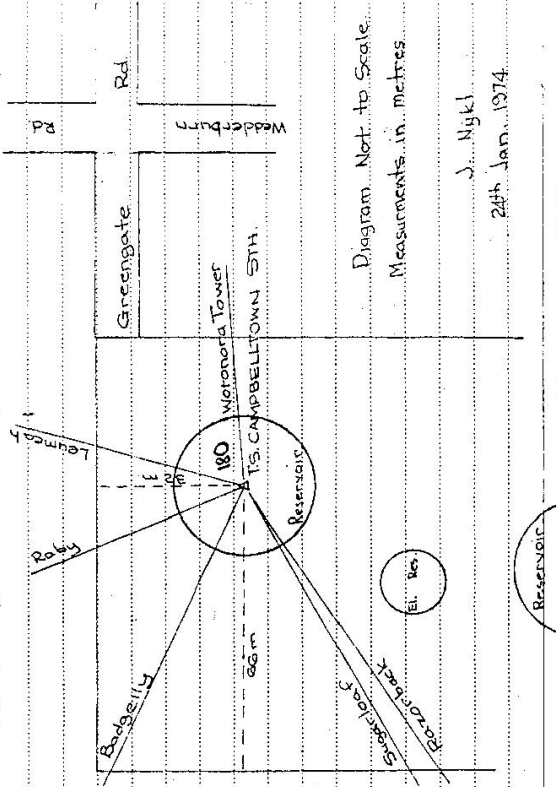

Diagram Not to Scale.  
Measurements in metres.

J. Nyki  
24th Jan. 1974

G 38

75 19 3

Department of Lands  
 STATION CAMPBELLTOWN BRAD BURY  
 Co: Cumberland Ph: St Peters  
 Map Sheet: Campbelltown 1:19,000 No: 8222  
 Inspected by: L.M HANES Date: 7/8/75  
 Authority: DEPT OF LANDS Field Book: 6BL 86

Beacon Diagram  
 Not to Scale

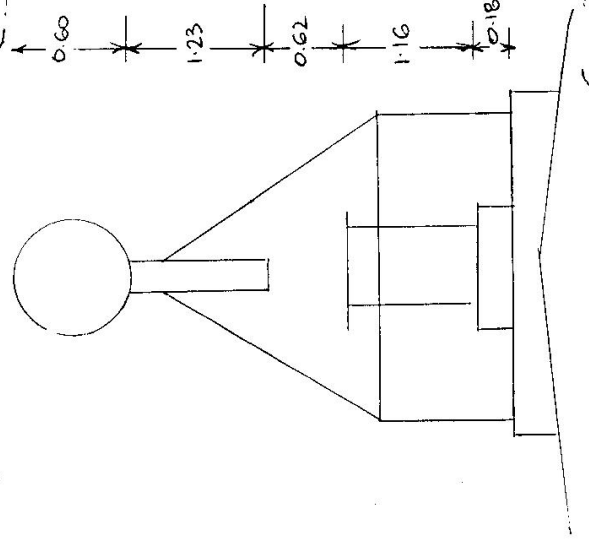

Date	Record of Station

IS  
 RECONNAISSANCE and MAINTENANCE REPORT 4988

Integrat Survey of N.S.W.

Note: Cross out word or words which do not apply

This Trig. Station has been:-

1. Completely cleared to permit 360° vision to surrounding Trigs.
2. Cleared by lones bearing ..... from Trig. Mast
3. Trig. Mast & Vanes have been painted white & black respectively.
4. The Trig. was unpiled/~~not-unpiled~~, dimensions now being:

Description of mark ROCKY PILLAR should be explicit, e.g. Steel plug, Brass plug, Bolt, Concrete Pillar

Height of mark 1.96 m <sup>above</sup> rock-concrete <sub>below</sub> 6.1 m

Height of Top Vanes to ~~Top Mark~~/Top pillar plate 1.45 m Diameter of Vanes (vertical) 0.60 m.

Height of Cairn ..... m. Diameter of Cairn ..... m.

Length of Mast 1.83 m. (~~approximate if not-unpiled~~)

5. A ..... set in conc/rock has been placed/fd ..... m. bearing ..... °M from Trig. Mast/pillar
6. A ..... set in conc/soil has been placed/fd ..... m. bearing ..... °M from Trig. Mast/pillar
7. A ..... set in conc/soil has been placed/fd ..... m. bearing ..... °M from Trig. Mast/pillar
8. A ..... set in conc/rock has been placed/fd ..... m. bearing ..... °M from Trig. Mast/pillar

9. Connection ..... to ..... m. bearing ..... °M
10. Connection ..... to ..... m. bearing ..... °M
11. Connection ..... to ..... m. bearing ..... °M
12. Connection ..... to ..... m. bearing ..... °M

13. Diff. Ht. .... is ..... m. <sup>above</sup> <sub>below</sub>
14. Diff. Ht. .... is ..... m. <sup>above</sup> <sub>below</sub>
15. Diff. Ht. .... is ..... m. <sup>above</sup> <sub>below</sub>
16. Diff. Ht. .... is ..... m. <sup>above</sup> <sub>below</sub>

Prepared by: L.M HANES Checked: Duffy

STATION **CAMPBELLTOWN S**

TS **4988** **BRADBURY**  
Current Occupant.....

Owners Name **Metropolitan Water Board**

Address.....

Address.....

**7-8-1975**  
Access **URD MAP 108 N-G** **CNR GREENGATE & WEDDEBOURN RDS.**  
**ENTRANCE OFF WEDDEBOURN RD.**

**CONVENTIONAL VEHICLE ACCESS**

Not to Scale

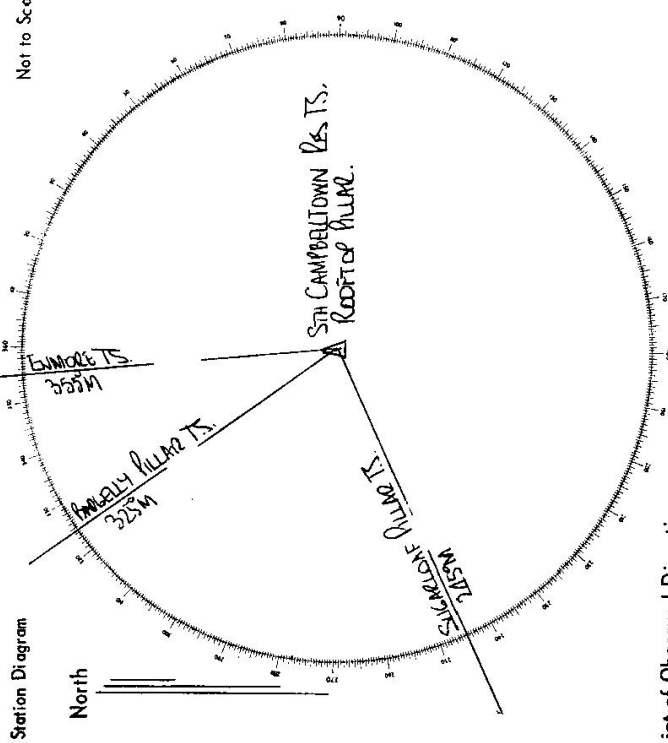

List of Observed Directions:-

Station	Direction	Station	Direction
SUNNYSIDE HILL TS.	329° 59' 60"	STH CAMPBELLTOWN Rds. TS. ROOFTOP MOUNT.	
LINDALEY HILL TS.	75° 47' 25"		
SUNNYSIDE HILL TS.	98° 50' 24"		
CEIL MACK. ING. TOWER	108° 23' 24"		
LINDALEY HILL TS.	137° 27' 06"		
WINDONIA TOWER	206° 51' 11"		
RAZORBACK TOWER	350° 54' 07"		
RAZORBACK TS.	354° 55' 21"		

Department of Lands  
 Reconnaissance and Maintenance Report  
 Integra Survey of N.S.W.

**SRADBUFFY**  
 STATION TS 4988 CAMPBELLTOWNS  
 Co: CUMBERLAND PH: ST. PETERS  
 Map Sheet: CAMPBELTOWN No: U8222  
 Inspected by: R. CUBIS Date: 15/3/19  
 Authority DEPT OF LANDS Field Book: POP 12914/14

This Trig. Station has been: from Trig. Mast

1. Completely cleared to permit 360° vision to surrounding Trigs.
2. ~~Cleared by James bearing~~ from Trig. Mast
3. Trig. Mast & Vanes have been painted white & ~~black~~ respectively.
4. The Trig. was unpiled/not unpiled, dimensions now being:
  - Description of mark: ROOFTOP PILLAR should be explicit, e.g. Steel plug, Brass plug, Bolt, Concrete Pillar (see 0116525A-05 BOX)
  - Height of mark: 1.36 m above ROOFTOP PLATFORM 17.942 m above SEA PM49703
  - Height of Top Vanes to Top Mark/Top pillar plate ..... m Diameter of Vanes (vertical) ..... m.
  - Height of Cairn ..... m. Diameter of Cairn ..... m.
  - Length of Mast 1.83 m. (approximate if not unpiled)
5. A PM49703 (see 0116525A) set in conc/rock has been placed/d 115.832 m bearing 72.0°M from Trig. Mast/pillar
6. A PM49703 set in conc/soil has been placed/d 168.244 m bearing 75.0°M from Trig. Mast/pillar
7. A PM49703 set in conc/soil has been placed/d 186.056 m bearing 78.0°M from Trig. Mast/pillar
8. A ..... set in conc/rock has been placed/d ..... m bearing .....°M from Trig. Mast/pillar
9. Connection PM49703 to PM49703 is 53.036 m bearing 80.0°M
10. Connection PM49703 to PM49703 is 71.710 m bearing 88.0°M
11. Connection PM49703 to PM49703 is 20.269 m bearing 107.0°M
12. Connection ..... to ..... m bearing .....°M
13. Diff. Ht. PILLAR PLATE is 17.942 m above PM49703 (see 0116525A-05 BOX)
14. Diff. Ht. .... is ..... m above / below .....
15. Diff. Ht. .... is ..... m above / below .....
16. Diff. Ht. .... is ..... m above / below .....

Prepared by: R. Cubis Checked: .....

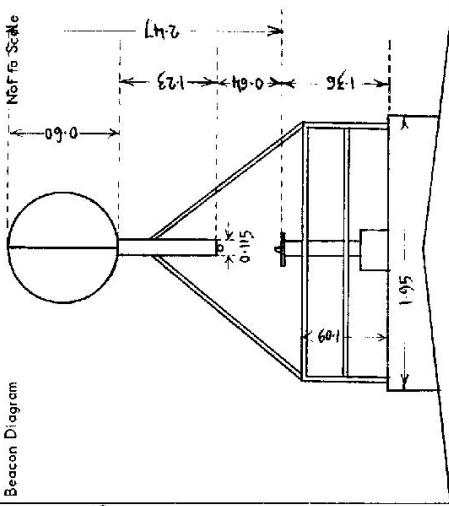

Date	Record of Station

NOTE  
 All Distances by adjustment from POP station summaries

STATION TS 4988 CAMPBELLTOWNS

Current Occupant: BRADBURY MWS & DB

Owners Name: MWS & DB

Address: 15-3-1979  
 Access Conventional Vehicle - Entrance to MWS & DB Reservoir at intersection of Wadderburn Road & Greenacre Road, Bradbury  
 UBD Street Directory (16th Edition)  
 Map 10B H/5 (Inset Map 10BA O/1)

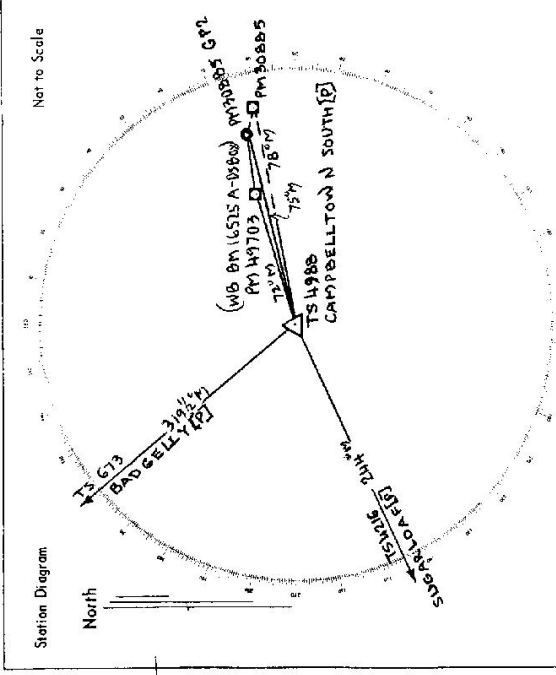

List of Observed Directions: - (DISTANCES BY ADJUSTMENT IN POPSUMMARY)

Station	Direction	Station	Direction
TS4988 CAMPBELLTOWN SOUTH	0° 00' 00"	ROOF TOP PILLAR	0° 00' 00"
TS4988 CAMPBELLTOWN SOUTH	75° 42' 26.1"	PM 30885 GPZ	190° 44' 07.2"
TS4988 CAMPBELLTOWN SOUTH	108° 20' 29.8"	PM 30885	194° 03' 01.9"
PM 30885 GPZ	190° 44' 07.2"		
PM 30885	194° 03' 01.9"		
Standpoint: PM 30885 GPZ			
Station	Direction	Station	Direction
ROOF TOP PILLAR	0° 00' 00"		
PM 49703	5° 14' 09"		
PM 30885	212° 03' 14.2"		

D. West, Government Printer, New South Wales - 1976