

LAND INFORMATION CENTRE

GEODETIC SURVEY OF N.S.W.

GEODETIC STATION RECONNAISSANCE and MAINTENANCE REPORT

Barrow 2857

Description:

Note: Cross out word or words which do not apply

1. Cleared by James bearing..... **0 very green 360°** from Trig. Mast
2. Mast & Vanes have been painted white & black respectively. **N/A**
3. The station/pillar was unplied/~~not unplied~~/~~not set~~ on **5.111** 19.98, dimensions now being:

Description of mark **Brass Plug** should be explicit, e.g., S/Steel Pillar Plate, Steel plug, Brass plug, Bolt, G.I. Pipe
 Height of mark..... m. ^{above} rock/concrete; Mark is..... m. ^{above} G.L.
 Height of Top Vanes to Top Mark/Pillar plate..... m. Diameter of Vanes (vertical)..... m.
 Height of Cairn..... **1.0** m. Diameter of Cairn..... **2.0** m. Name Plate ~~found~~/~~not found~~/~~sheet~~
 Length of Mast..... **No Mast** m. (approximate if not unplied)

4. A. **Drill Hole**..... set in ~~conc~~/~~rock~~ has been placed/~~found~~, bearing **300°** °M from ~~truss~~/~~plug~~/~~pillar~~
5. A. **G.I. Pipe**..... set in ~~conc~~/~~rock~~ has been placed/~~found~~, bearing **109°** °M from ~~truss~~/~~plug~~/~~pillar~~
6. A. **Tower**..... ~~set in conc/rock~~ has been placed/~~found~~, bearing **22°** °M from ~~truss~~/~~plug~~/~~pillar~~
7. A. **PH 61662**..... set in ~~conc~~/~~rock~~ has been placed/~~found~~, bearing **271°** °M from ~~truss~~/~~plug~~/~~pillar~~
8. Action required: **Nil - tower replaces cairn/pole/disc as beacon.**

STANDPOINT: **Drill Hole in Rock** STANDPOINT: **G.I. Pipe in Soil**

Mark	Direction	Horiz. Distance	Height Difference	Mark	Direction	Horiz. Distance	Height Difference
PH 61662	0 00 00	98.4570.328	^{above} standpt	PH 61662	0 00 00	086.0010.074	^{above} standpt
Trig Plug	22 26 15	723.3400.142	^{above} standpt	Drill Hole	252.49 43.028	8500.351	^{above} standpt
G.I. Pipe	56 33 59	728.8500.355	^{above} standpt	Tower	302.25 11.7		^{above} standpt
Tower	305.43 08.5		^{above} standpt	Trig Plug	306.47 07.016	1980.497	^{above} standpt
			^{below} standpt				^{below} standpt
			^{below} standpt				^{below} standpt
			^{below} standpt				^{below} standpt

Prepared by: *W. K. Krahe* Checked:

Noted on U.T.M. Card

18/11/98

S: 2733-1

STATION: **WARRANARY** No.: **4623**

MAP SHEET SCALE 1:250 000

INSPECTED BY: **N. K. Krahe** DATE: **5/11/98**

AUTHORITY: **Surveyor General's** FIELD BOOK:

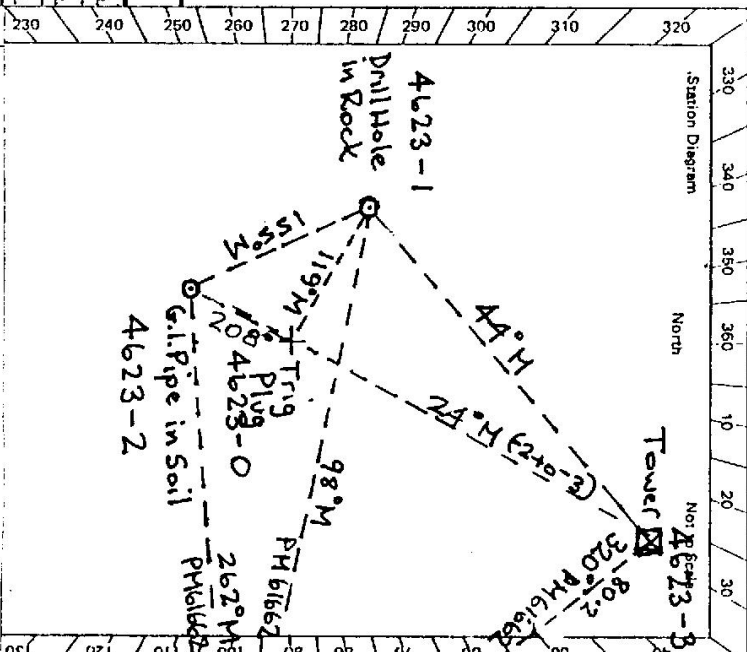

Mark	Direction	Horiz. Distance	Height Difference
Drill Hole	0 00 00	098.448	0.328
Tower	41 33 46.5		
G.I. Pipe	343.44 18.7	85.992	0.023

Noted on U.T.M. Card

S 2733-3 D West Government Printer

STATION **WARRANRY 4623**

Beacon Diagram	Not to Scale

This section to be completed by officer constructing pillar.

Original station mark found/not found.

Description of mark:

Original beacon found/not found.

Description of beacon:

Height: Top of Vanes to Top Mark.....m.

Height of mark.....m. above rock/conc.....m. above G.L. below

Diameter of Vanesm. Height of Cairnm.

Original Beacon has/has not been destroyed by me.

Owner's Name: **MR JOHN McKEON**
 Address: **MR SUE McKEON MOUNTAIN WELLS**
 Phone: **02 69678135**
 Access Report of/19..... was found suitable/unsuitable. **ACCESS**
 0.00 At Railway Crossing Rota head north taking left fork
 1.2 Coombie Rd (right fork to Gilgunnia Rd)
 5.0 Grid Mountain Wells
 5.1 Grid
 5.1 Pass right hand track into Mountain Wells (owners residence)
 5.3 Entrance on left to old homestead
 5.4 Turn left onto track (about 100 metres before causeway)
 9.5 Through Two Tree Gate head in a northerly direction following track
 10.4 Windmill on right
 12.7 Set of goat yards on right
 14.5 Abandoned saw mill on left
 14.9 Cross dry rock gully
 15.6 Leave fence veering to left on gradual climb
 18.8 Warranry TS

INSPECTED BY: **N. Krahe**

DATE: **5/11/98**

Record of Station

Date

O vergrown 360°
MoHast-tower replaces cairn/pole/disc as beacon.