

GEODETTIC SURVEY OF N.S.W.

CENTRAL MAPPING AUTHORITY

GEODETTIC STATION RECONNAISSANCE and MAINTENANCE REPORT

STATION: *WALMER* No.: *4587*

MAP SHEET SCALE 1:250 000 *NARRONGINE*

INSPECTED BY: *P. K. BARNOLD* DATE: *25/9/78*

AUTHORITY: *C. M. A.* FIELD BOOK:

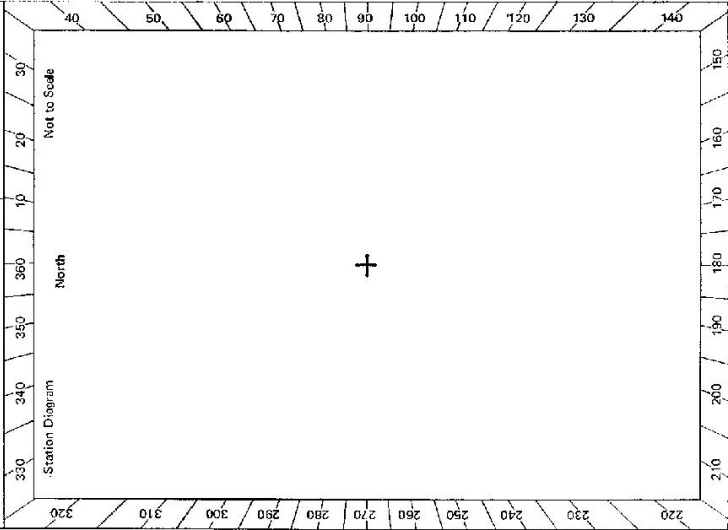

- Description: *Note: Cross out word or words which do not apply from Top Mast*
- Cleared by James bearing. from Top Mast*
 - Mast & Vanes have been painted white & black respectively. found in cairn of rocks*
 - The station letter was not unpled*
- Description of mark.....should be explicit, e.g., S/Steel Pillar Plate, Steel plug, Bolt, G.I. Pipe
- Height of mark.....m. ^{above} _{below} rock/concrete; Mark is.....m. ^{above} _{below} G.I.L.
- Height of Top Vanes to Top Mark/Pillar plate.....m. Diameter of Vanes (vertical).....m.
- Height of Cairn.....m. Diameter of Cairn.....m. Name Plate found/not found/placed.
- Length of Mast.....m. (approximate if not unpled)
- A.....set in conc/rock has been placed/found, bearing.....° M from Mast/Plug/Pillar*
 - A.....set in conc/rock has been placed/found, bearing.....° M from Mast/Plug/Pillar*
 - A.....set in conc/rock has been placed/found, bearing.....° M from Mast/Plug/Pillar*
 - A.....set in conc/rock has been placed/found, bearing.....° M from Mast/Plug/Pillar*
- Action required: *2 steps clearing and painting. Station S. liable for pillar construction*

STANDPOINT:

| Mark | Direction | Horiz. Distance | Height Difference | Mark | Direction | Horiz. Distance | Height Difference |
|------|-----------|-----------------|-------------------|------|-----------|-----------------|-------------------|
| | | | above standpt. | | | | above standpt. |
| | | | below | | | | below |
| | | | above standpt. | | | | above standpt. |
| | | | below | | | | below |
| | | | above standpt. | | | | above standpt. |
| | | | below | | | | below |
| | | | above standpt. | | | | above standpt. |
| | | | below | | | | below |
| | | | above standpt. | | | | above standpt. |
| | | | below | | | | below |

Prepared by: _____ Checked: _____

Noted on U.T.M. Card

52 2733-1

GEODETIC SURVEY OF N.S.W.

CENTRAL MAPPING AUTHORITY

GEODETIC STATION RECONNAISSANCE and MAINTENANCE REPORT

Description:

1. Cleared by lanes bearing... *164.9 to 225.0 to 280.0 to 310.0 to 350.0 to 55.0 to 120.0*
2. Mast & Vanes have been painted white & black respectively. ✓
3. The station/~~Mast~~ was unpiled/~~not constructed~~ on... *29-9-80*, dimensions now being: *19.80*
- Description of mark... *Beass Trig* should be explicit, e.g., S/Steel Pillar Plate, Steel plug, Brass plug, Bolt, G.I. Pipe
- Height of mark... *0.032* m. above rock/concrete; Mark is... m. above G.L.
- Height of Top Vanes to Top Mark/~~Mast~~ plate... *3.648* m. Diameter of Vanes (vertical)... *106* mm.
- Height of Cairn... *1.270* m. Diameter of Cairn... *2.00* m. Name Plate ~~found~~/... and/placed.
- Length of Mast... *3.680* m. (approximate if not unpiled)
4. A. *Copper Nail*... set in ~~conc~~/rock has been placed/~~found~~, bearing... *180.0* M from Mast/Plug/Pillar
5. A. *BRIDGE SPIKE*... set in ~~conc~~/rock has been placed/~~found~~, bearing... *6.0* M from Mast/Plug/Pillar
6. A. set in conc/rock has been placed/~~found~~, bearing... M from Mast/Plug/Pillar
7. A. set in conc/rock has been placed/~~found~~, bearing... M from Mast/Plug/Pillar
8. Action required: *REPAIRMENT OF CONCRETE OBSERVING PIER.*

STANDPOINT: *Beass Trig Area in Rock* STANDPOINT: *Copper Nail in Rock (2)*

| Mark | Direction | Horiz. Distance | Height Difference | Mark | Direction | Horiz. Distance | Height Difference |
|---------------------|------------------|-----------------|-------------------|-----------------------|------------------|-----------------|-------------------|
| <i>ENMAN GS</i> | <i>0 00 00</i> | | above standpt. | <i>ENMAN GS</i> | <i>0 00 00</i> | | above standpt. |
| <i>BOGAN CSP</i> | <i>29 46 50</i> | | above standpt. | <i>BOGAN GS (2)</i> | <i>29 41 20</i> | | above standpt. |
| <i>BRIDGE SPIKE</i> | <i>177 52 20</i> | <i>2.011</i> | above standpt. | <i>BEASS TRIG LOG</i> | <i>173 52 30</i> | <i>2.234</i> | above standpt. |
| <i>COPPER NAIL</i> | <i>332 52 30</i> | <i>2.233</i> | below standpt. | <i>BRIDGE SPIKE</i> | <i>175 44 30</i> | <i>4.239</i> | above standpt. |
| | | | above standpt. | | | | above standpt. |
| | | | below standpt. | | | | below standpt. |
| | | | above standpt. | | | | above standpt. |
| | | | below standpt. | | | | below standpt. |

Prepared by: *P. HOTS* 29-9-80

Checked: *Dr. M. Smith* 11/5/81 Noted on U.T.M. Card

ST 2793-1

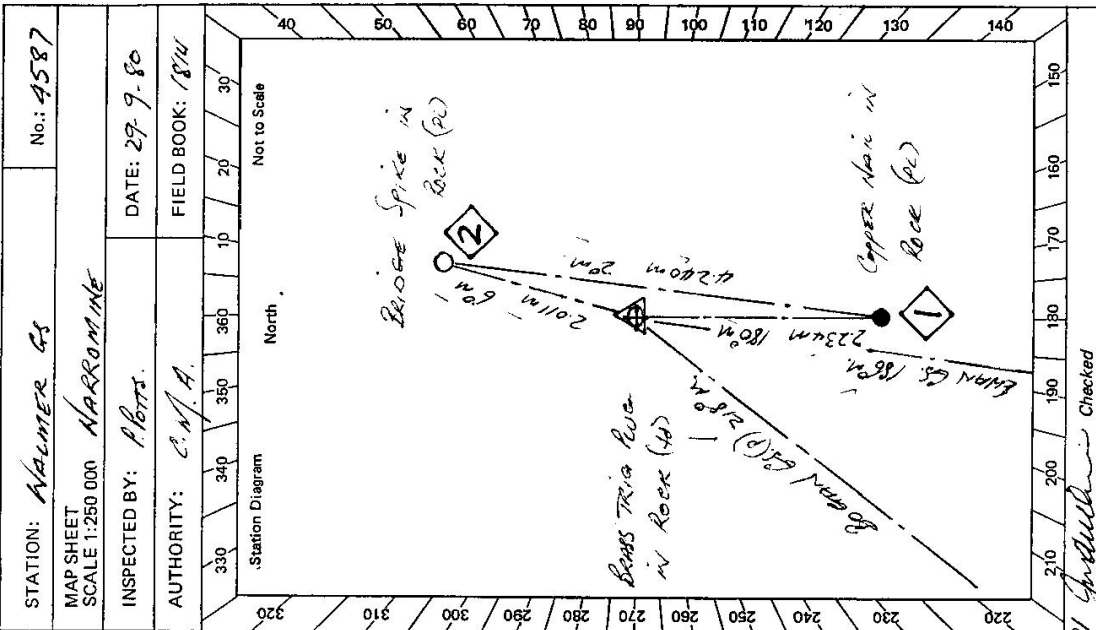

STATION: *NAUMER GS* No.: *4587*

MAP SHEET SCALE 1:250 000 *NARRONGINE*

INSPECTED BY: *P. HOTS* DATE: *29-9-80*

AUTHORITY: *C.M.A.* FIELD BOOK: *1874*

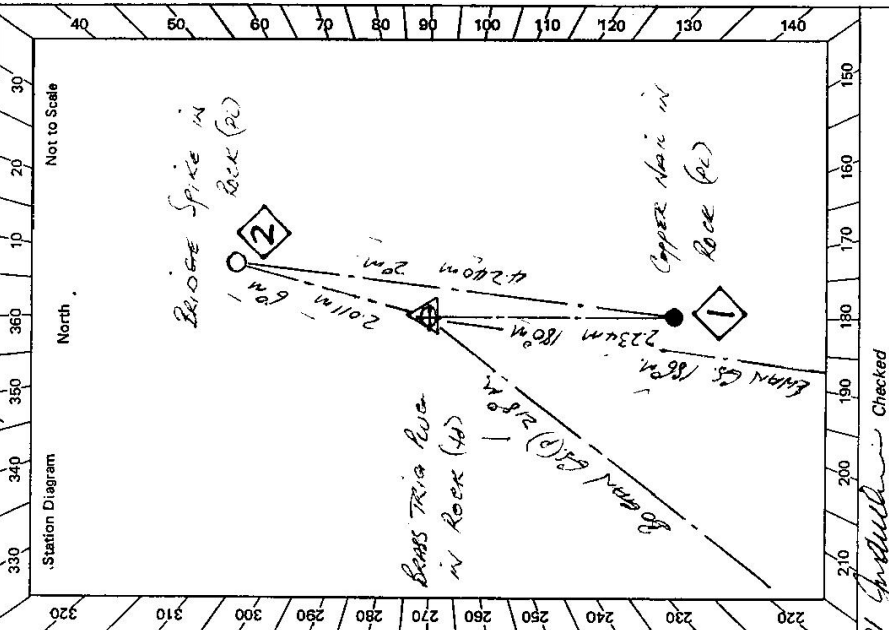

GS

STATION *WALNER GS. TS 4587*

Owner's Name: *Mr. P.M. & Mrs. MASON*
 Address: *"KOLLAROO"*
 Phone:

Current Occupant:

Address:

Phone:

ACCESS

Access Report of 29/1/1980 was found suitable/unsuitable.

*0.00: LEPTURE
 0.10: PO. PARKES HERB'S NURSM ON COLLINGWOOD STREET
 0.30: TURN LEFT INTO CHURCH STREET
 0.50: TURN RIGHT INTO CLARINDA STREET
 1.30: TURN LEFT INTO BUSHMAN STREET
 1.40: TURN RIGHT INTO PARKES - CONSOLIDATION ROAD
 1.42: ALLEYWAY LINE CROSSING
 1.48: TURN RIGHT
 1.56: END SHELTERS ROAD
 1.57: TURN RIGHT
 1.59: TURN LEFT SIGN TRUNDLE 31 KM.
 1.59: CAUSEWAY
 1.59: CAUSEWAY
 1.59: CAUSEWAY
 1.59: CAUSEWAY
 1.59: TURN RIGHT THROUGH IRON GATE OPPOSITE WALNER PROPERTY
 1.59: LAND OWNER A FURTHER 1 KM DIRT ROAD
 1.59: GO THROUGH IRON GATE & TURN RIGHT FOLLOW TRACK ALONG FENCE
 1.59: FENCE OPENING MAKE WAY TO LEFT AROUND DAM THEN
 1.59: FOLLOW OLD FENCE LINE NORTH.
 1.59: TRIG STATION WALNER.*

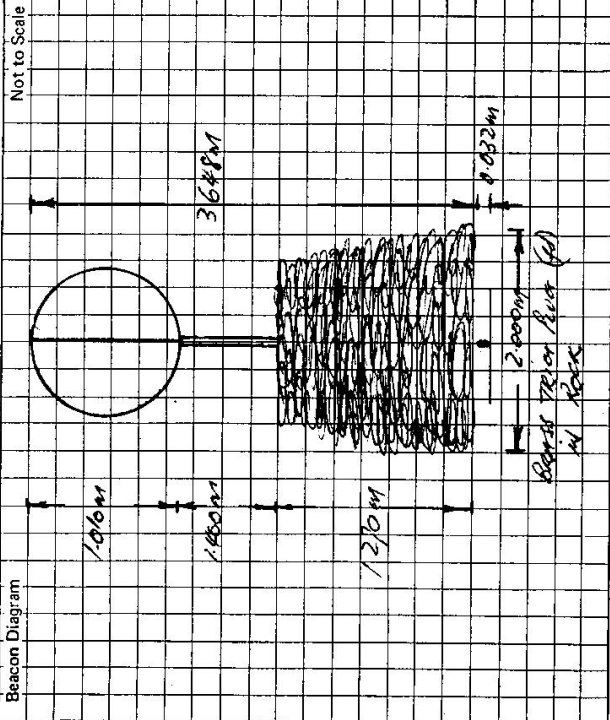

This section to be completed by officer constructing pillar.

Original station mark found/~~not found~~.
 Description of mark: *BRASS TRIG PUG*
 Original beacon found/~~not found~~.
 Description of beacon: *CAIRN POLE & DISC*
 Height Top of Vanes to Top Mark: *3.500* m.
 Height of mark: *0.033* m. above rock/ceac. *1.700* m. below G.L.
 Diameter of Vanes: *0.765* m. Height of Cairn: *1.700* m.
 Original Beacon has/has not been destroyed by me. *(DOUBLE VANES)*

Date **Record of Station**

| | |
|-----------------------|-------------------------|
| <i>ENAM G</i> | <i>0 00 00</i> |
| <i>BOGAN BRG</i> | <i>29 41 00</i> |
| <i>UPPER HAVI</i> | <i>355 5 00</i> |
| <i>BRASS TRIG PUG</i> | <i>357 50 30</i> |
| | <i>2 010' 0.026</i> |
| | <i>BELOW STANDPOINT</i> |