

CENTRAL MAPPING AUTHORITY

Trigonometrical Survey of N.S.W.

Department of Lands

RECONNAISSANCE and MAINTENANCE REPORT

This Trig. Station has been:-

Note: Cross out word or words which do not apply

1. Completely cleared to permit 360° vision to surrounding Trigs.
2. Cleared by lanes bearing
3. Trig. Mast & Vanes have been painted white & black respectively.
4. The Trig. was unpiled/not unpiled, dimensions now being:
 - Description of mark..... m above below *rock/concrete* *new found*
 - Height of mark..... m above below *G.L.*
 - Height of Top Vanes to Top Mark..... m. Diameter of Vanes (vertical)..... m.
 - Height of Cairn..... m. Diameter of Cairn..... m.
 - Length of Mast..... m. (approximate if not unpiled)
5. A..... set in conc/rock has been placed..... m. bearing.....°M from Trig. Mast
6. A..... set in conc/soil has been placed..... m. bearing.....°M from Trig. Mast
7. A..... set in conc/soil has been placed..... m. bearing.....°M from Trig. Mast
8. A..... set in conc/rock has been placed..... m. bearing.....°M from Trig. Mast
9. Connection..... to..... m. bearing.....°M
10. Connection..... to..... m. bearing.....°M
11. Connection..... to..... m. bearing.....°M
12. Connection..... to..... m. bearing.....°M
13. Diff. Ht. is..... m. above below
14. Diff. Ht. is..... m. above below
15. Diff. Ht. is..... m. above below
16. Diff. Ht. is..... m. above below

Prepared by: *[Signature]*

Checked: *[Signature]*

Noted on U.T.M. Card

7.4.98

STATION *WEGAR* TS **4548**

Co: *HANES* Ph: *WEGAR*

Map Sheet: *UPPER MANNING* No: *5734*

Inspected by: *P.L. PARSONS* Date: *12/10/77*

Authority: *P.L. PARSONS* Field Book: *1561*

Beacon Diagram Not to Scale

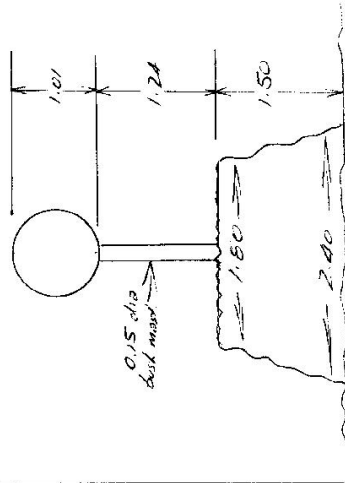

Date

Record of Station
TRIG ID IN GOOD ORDER Mast - HANES 2247
Painting 5379 in conc for APRIL 13 1977
By CHERRIE PARSONS

Checked

GEODETTIC SURVEY OF N.S.W.

CENTRAL MAPPING AUTHORITY

GEODETTIC STATION RECONNAISSANCE and MAINTENANCE REPORT

- Description:
- Note: Cross out word or words which do not apply
- Cleared by lanes bearing..... from Trig. Mast
 - Mast & Vanes have been painted white & black respectively. ✓
 - The station/... was unpilled/... dimensions now being: 19....., dimensions now being:
 - Description of mark..... should be explicit, e.g., S/Steel Pillar Plate, Steel plug, Brass plug, Bolt, G.I. Pipe
 - Height of mark.....m. above/below rock/concrete; Mark is.....m. above/below G.L.
 - Height of Top Vanes to Top Mark/.....m. Diameter of Vanes (vertical).....m.
 - Height of Cairn.....m. Diameter of Cairn.....m. Name Plate.....placed.
 - Length of Mast.....m. (approximate if not unpilled)
 - A..... S.S.M..... set in conc/... has been placed/found, bearing.....°M from Mast/Plug/Pillar
 - A..... Cairn Nail..... set in conc/... has been placed/found, bearing.....°M from Mast/Plug/Pillar
 - A..... set in conc/rock has been placed/found, bearing.....°M from Mast/Plug/Pillar
 - A..... set in conc/rock has been placed/found, bearing.....°M from Mast/Plug/Pillar
 - Action required:.....

STANDPOINT:		STANDPOINT:		STANDPOINT:	
Mark	Direction	Horiz. Distance	Height Difference	Mark	Direction
MVLA GS	0 00 00 ✓		above standpt.	MVLA GS	0 00 00 ✓
CROSSING GS of	210 11 20 ✓		above standpt.	BRASS PUG	71 04 00 2376 ✓
S.S.M	251 10 00 2315 ✓		above standpt.	CROSSING GS of	210 10 30 ✓
Cairn Nail	255 03 20 5006 ✓		below standpt.	Cairn Nail	254 04 10 2242 ✓
			above standpt.		
			below standpt.		
			above standpt.		
			below standpt.		

Prepared by: Checked: Noted on U.T.M. Card:
 S: 2733-1

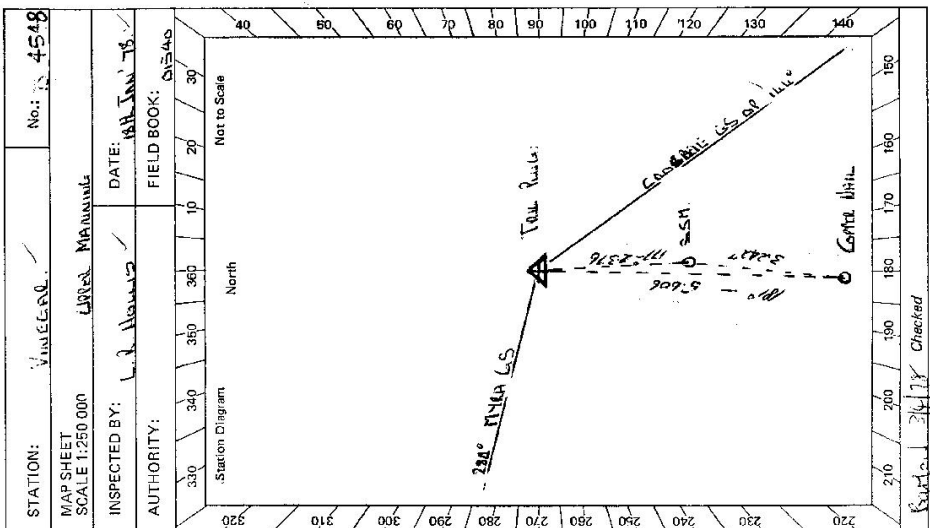

STATION: VINDIGAN. ✓ No.: 4548

MAP SHEET SCALE 1:250 000 LINES MAINTENANCE

INSPECTED BY: L.J. Houghton DATE: 18 JAN 78

AUTHORITY: FIELD BOOK: 61545

St 2735-2 D. West, Government Printer

STATION TS 4548	V. Access
Owner's Name: Address: Phone: Current Occupant: Address: Phone: ACCESS Access Report of 19/11/19. It was found suitable/unsuitable. 0400 BARNHURTON Lane OFFICE, LONDON. Some TRENCH TOOKEN AROUND 21.55 TURN LEFT TOWARDS MANORIAL 31.25 TURN LEFT SWAY "K. ROAD" (GRD) 31.70 TURN LEFT SWAY DEPOT BRD AND TURNED UP TO SMALL POWER LINE TRENCH THERE SEEN AND FOUND THE TRENCH LINE DOWN AND TURNED UP THE TO POWER POLE. TRENCH WAS LOST AT ROAD AS STUCK 32.50 LEAVE HIGHWAY. I WENT AROUND TO LONDON. TRENCH NOT FOUND. SEE "K. ROAD" BY TURNING ON WHEELS AT 32.10 AM	Owner's Name: Address: Phone: Current Occupant: Address: Phone:

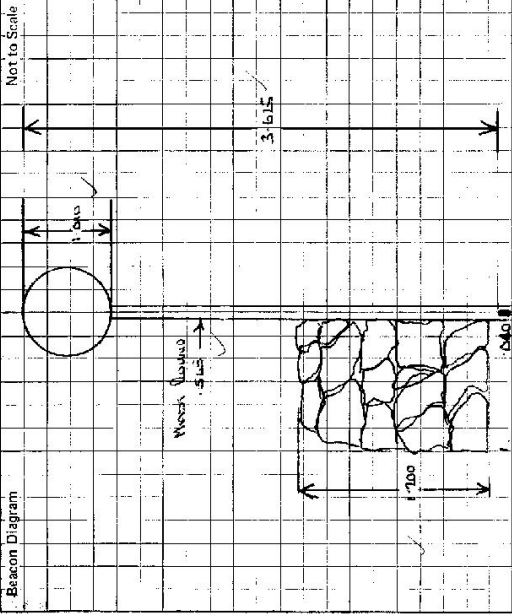

This section to be completed by officer constructing pillar.

Original station mark found/.....

Description of mark:

Original beacon found/not found.

Description of beacon:

Height Top of Vanes to Top Mark.....m.

Height of mark.....m. above G.L. below

Diameter of Vanes.....m. Height of Cairn.....m.

Original Beacon has/not been destroyed by me.

Date	Record of Station