

2004 2 0420 5

GEODETTIC SURVEY OF NSM

CENTRAL MAPPING AUTHORITY

GEODETTIC STATION RECONNAISSANCE and MAINTENANCE REPORT

STATION: UMBERUMBERKA GS. No: 4510

MAP SHEETS SCALE 1:100 000  
SCALE 1:250 000

INSPECTED BY: P. Potts

DATE:

AUTHORITY: Land Information Centre

FIELD BOOK:

- Description: 360 2 4
- Note: Cross out word or words which do not apply
- Cleared by lanes bearing..... from Trig. Mast
  - Mast & Vanes have been painted white & black respectively.
  - The station/pillar was unpiled/not unpiled/constructed on..... 19....., dimensions now being: Description of mark..... should be explicit, e.g., S/Steel Pillar Plate, Steel plug, Brass plug, Bolt, G.I. Pipe
- Description of mark..... should be explicit, e.g., S/Steel Pillar Plate, Steel plug, Brass plug, Bolt, G.I. Pipe
- Height of mark..... m. <sup>above</sup> <sub>below</sub> rock/concrete; Mark is..... m. <sup>above</sup> <sub>below</sub> G.L.
- Height of Top Vanes to Top Mark/Pillar plate..... m. Diameter of Vanes (vertical)..... m.
- Height of Cairn..... m. Diameter of Cairn..... m. Name Plate found/not found/placed.
- Length of Mast..... m. (approximate if not unpiled)
- A..... set in conc/rock has been placed/found, bearing.....°M from Mast/Plug/Pillar
  - A..... set in conc/rock has been placed/found, bearing.....°M from Mast/Plug/Pillar
  - A..... set in conc/rock has been placed/found, bearing.....°M from Mast/Plug/Pillar
  - A..... set in conc/rock has been placed/found, bearing.....°M from Mast/Plug/Pillar
- Action required:.....

STANDPOINT: STAR PICKET (3)

Mark	Direction	Horiz. Distance	Height Difference	Mark	Direction	Horiz. Distance	Height Difference
R.O G.I. Nail	0 00 00		above standpt.				above standpt.
STAR PICKET (2)	11 27 50	6.012	0.096 below standpt.				below standpt.
1/2 COPPER TAG TO R.O	305 07 30	19.470	0.681 above standpt.				above standpt.
G.I. NAIL	305 07 35	4.509	0.055 below standpt.				below standpt.
COPPER NAIL	339 17 50	10.662	0.296 below standpt.				below standpt.
			above standpt.				above standpt.
			below				below

Prepared by: P. Potts

Checked by: [Signature]

Named on U.T.M. Cont

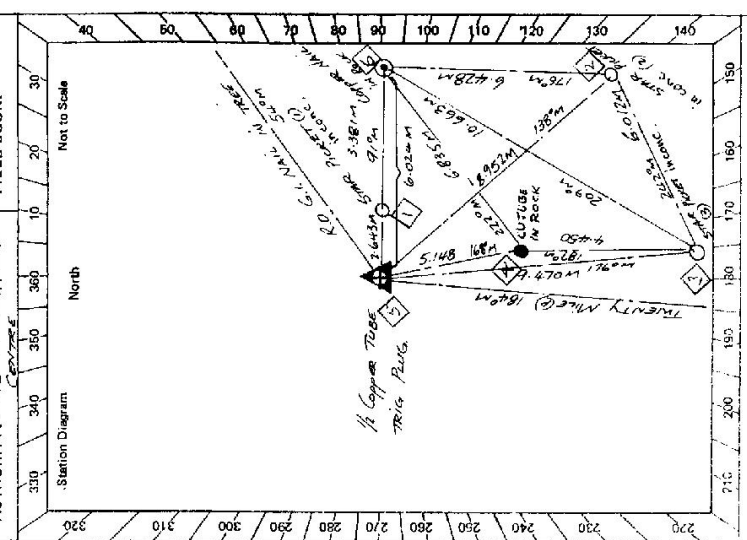

Checked





As of 2 cards

GEODETTIC SURVEY OF NSW

CENTRAL MAPPING AUTHORITY

GEODETTIC STATION RECONNAISSANCE and MAINTENANCE REPORT

STATION: *KAERWANTBERKA G.S. (P)* No.: *4510*  
 MAP SHEETS SCALE 1:100 000  
 SCALE 1:250 000  
 INSPECTED BY: *P. Bors* DATE: *21/3/20*  
 AUTHORITY: *LANDS INFORMATION* FIELD BOOK: *CS19*

- Description: *360*  
 Note: *Cross out word or words which do not apply*  
 1. Cleared by lanes bearing..... from Trig. Mast  
 2. Mast & Vanes have been painted white & black respectively.  
 3. The station/pillar was ~~constructed on~~ *constructed on* ~~base~~ *base* *19.92* m, dimensions now being:  
 Description of mark: *1/2" Brass Plate, Steel plug, Brass plug, Bolt, G.I. Pipe*  
 Height of mark: *1.375* m, <sup>above</sup> ~~below~~ *rock/concrete*, Mark is *1.525* m, <sup>above</sup> ~~below~~ *G.L.*  
 Height of Top Vanes to Top Mark/Pillar plate *1.445* m. Diameter of Vanes (vertical) *2.750* m.  
 Height of Cairn.....m. Diameter of Cairn.....m. Name Plate found/not found/placed.  
 Length of Mast.....m. (approximate if not unpled)  
 4. A *Stone* ~~Picket (1)~~ *set in conc/rock* has been ~~placed~~ *found*, bearing..... *91* °M from ~~Mast/Flag/Pillar~~ *816.1*  
 5. A *Stone* ~~Picket (2)~~ *set in conc/rock* has been ~~placed~~ *found*, bearing..... *138* °M from ~~Mast/Flag/Pillar~~ *816.1*  
 6. A *1/2" Copper Tube* ~~set in conc/rock~~ has been ~~placed~~ *found*, bearing..... *168* °M from ~~Mast/Flag/Pillar~~ *816.1*  
 7. A *Stone* ~~Picket~~ *set in conc/rock* has been ~~placed~~ *found*, bearing..... *176* °M from ~~Mast/Flag/Pillar~~ *816.1*  
 8. A *Copper Nail* ~~set in conc/rock~~ has been ~~placed~~ *found*, bearing..... *91.9* from ~~Pillar~~ *816.1*  
 Action required: *REPLACEMENT*

STANDPOINT: CONCRETE OBSERVING PILE				STANDPOINT: COPPER NAIL			
Mark	Direction	Horiz. Distance	Height Difference	Mark	Direction	Horiz. Distance	Height Difference
<i>R.O. Cairn</i>	<i>0 00 00</i>		<i>above</i> <del>below</del> <i>standpt.</i>	<i>R.O. Cairn</i>	<i>0 00 00</i>		<i>above</i> <del>below</del> <i>standpt.</i>
<i>Copper Nail</i>	<i>34 58 25</i>	<i>6.024</i>	<i>below</i> <del>above</del> <i>standpt.</i>	<i>Stone Picket (2)</i>	<i>126 07 10</i>	<i>6.427</i>	<i>below</i> <del>above</del> <i>standpt.</i>
<i>Stone Picket (1)</i>	<i>34 58 45</i>	<i>2.644</i>	<i>below</i> <del>above</del> <i>standpt.</i>	<i>TRINITY MILE (P)</i>	<i>132 20 50</i>		<i>below</i> <del>above</del> <i>standpt.</i>
<i>Stone Picket (2)</i>	<i>09 49 15</i>	<i>1.953</i>	<i>below</i> <del>above</del> <i>standpt.</i>	<i>Stone Picket (3)</i>	<i>155 59 30</i>	<i>10.648</i>	<i>below</i> <del>above</del> <i>standpt.</i>
<i>1/2" Copper Tube</i>	<i>09 58 15</i>	<i>5.148</i>	<i>below</i> <del>above</del> <i>standpt.</i>	<i>1/2" Copper Tube</i>	<i>171 19 30</i>	<i>6.835</i>	<i>below</i> <del>above</del> <i>standpt.</i>
<i>Stone Picket (3)</i>	<i>18 47 15</i>	<i>9.470</i>	<i>below</i> <del>above</del> <i>standpt.</i>	<i>Concrete Pile</i>	<i>218 00 30</i>	<i>6.026</i>	<i>below</i> <del>above</del> <i>standpt.</i>
<i>TRINITY MILE (P)</i>	<i>129 18 15</i>		<i>above</i> <del>below</del> <i>standpt.</i>	<i>Stone Picket (1)</i>	<i>218 00 20</i>	<i>3.379</i>	<i>above</i> <del>below</del> <i>standpt.</i>

Prepared by: *P. Bors* Checked: *21/3/20* Named on U.T.M. Grid

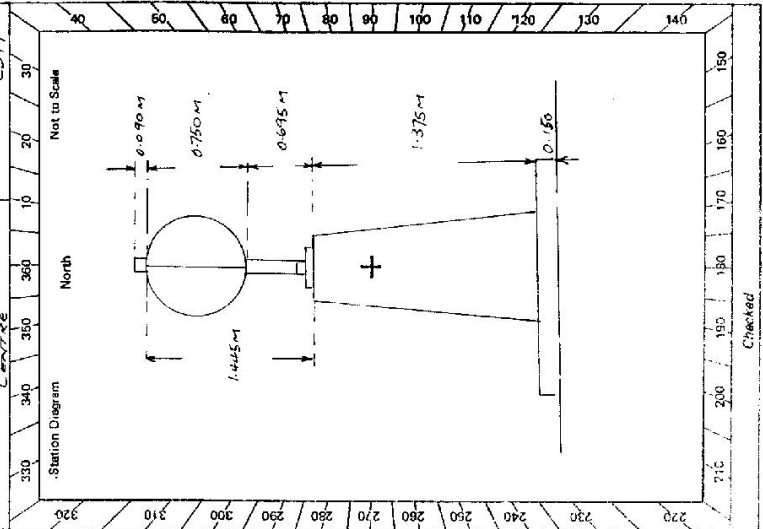

246 of 2 sheets.

GEODETTIC SURVEY OF NSM.

CENTRAL MAPPING AUTHORITY

GEODETTIC STATION RECONNAISSANCE and MAINTENANCE REPORT

STATION: *UMBERUMBERKA G.S.P* No.: *4510*

MAP SHEETS SCALE 1:100 000  
SCALE 1:250 000

INSPECTED BY: *P.P. LOTTS* DATE: *27/4/20*

AUTHORITY: *LAND INFORMATION CENTRE* FIELD BOOK: *C 599*

- Description: *Note: Cross out word or words which do not apply*
- Cleared by lanes bearing..... from Trig. Mast
  - Mast & Vanes have been painted white & black respectively.
  - The station/pillar was unpiled/not unpiled/constructed on..... 19....., dimensions now being: Description of mark..... should be explicit, e.g., S/Steel Pillar Plate, Steel plug, Brass plug, Bolt, G.I. Pipe
  - Description of mark..... should be explicit, e.g., S/Steel Pillar Plate, Steel plug, Brass plug, Bolt, G.I. Pipe
  - Height of mark..... m. <sup>above</sup> rock/concrete; Mark is..... m. <sup>above</sup> G.L.
  - Height of Top Vanes to Top Mark/Pillar plate..... m. Diameter of Vanes (vertical)..... m.
  - Height of Cairn..... m. Diameter of Cairn..... m. Name Plate found/not found/placed.
  - Length of Mast..... m. (approximate if not unpiled)
  - A..... set in conc/rock has been placed/found, bearing..... °M from Mast/Plug/Pillar
  - A..... set in conc/rock has been placed/found, bearing..... °M from Mast/Plug/Pillar
  - A..... set in conc/rock has been placed/found, bearing..... °M from Mast/Plug/Pillar
  - A..... set in conc/rock has been placed/found, bearing..... °M from Mast/Plug/Pillar

Action required:.....

STANDPOINT: *STAR PEGGET (3)*

Mark	Direction	Horiz. Distance	Height Difference	Mark	Direction	Horiz. Distance	Height Difference
<i>RD G.I. Nail</i>	<i>0 00 00</i>		<i>above</i> standpt.				<i>above</i> standpt.
<i>STAR PEGGET (2)</i>	<i>11 28 05</i>	<i>6.012</i>	<i>0.098</i> below standpt.				<i>below</i> standpt.
<i>TWENTY NAIL (P) 135 38 35</i>			<i>above</i> standpt.				<i>above</i> standpt.
<i>CONCRETE PILLAR</i>	<i>305 07 05</i>	<i>9.470</i>	<i>2.164</i> below standpt.				<i>below</i> standpt.
<i>G.I. NAIL</i>	<i>305 07 05</i>	<i>4.509</i>	<i>0.05</i> below standpt.				<i>below</i> standpt.
<i>1/2" COPPER TIE</i>	<i>305 20 15</i>	<i>4.450</i>	<i>0.046</i> below standpt.				<i>below</i> standpt.
<i>COPPER NAIL</i>	<i>339 17 45</i>	<i>0.662</i>	<i>0.294</i> above standpt.				<i>above</i> standpt.

Prepared by: *P.P. LOTTS*

Checked by: *P.P. LOTTS*

Named on U.T.M. Grid

Checked

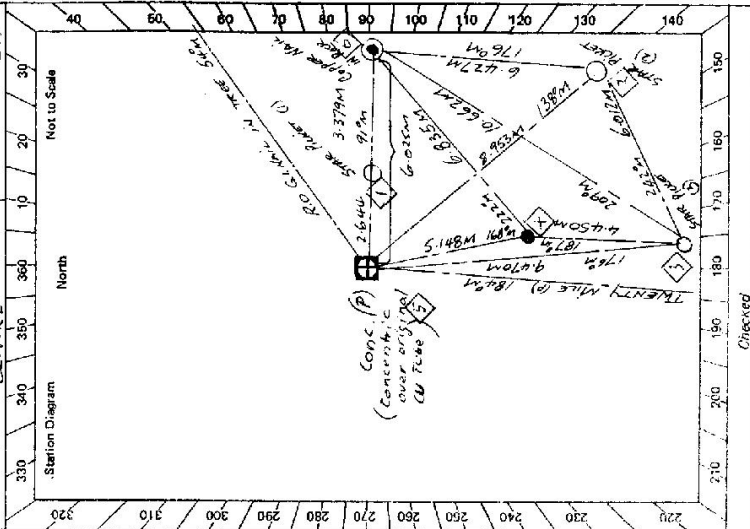

**LAND INFORMATION CENTRE**

GEODETTIC SURVEY OF N.S.W.

**GEODETTIC STATION RECONNAISSANCE and MAINTENANCE REPORT**

STATION: **UMBERUMBERKA** No.: **4510**

Description: **360°**  
 Cleared by Janes bearing.....  
 Note: *Cross out word or words which do not apply*

MAP SHEET  
 SCALE 1:250 000  
**BROKEN HILL**

INSPECTED BY: **A. Sivertsen** DATE: **1 AUG 1914**

AUTHORITY: **LIC** FIELD BOOK: **---**

The station/pillar was unplied/~~not unplied~~ constructed on..... **1 AUG 1914**....., dimensions now being:  
 Description of mark..... should be explicit, e.g., S/Steel Pillar Plate, Steel plug, Brass plug, Bolt, G.I. Pipe  
 Height of mark.....m. <sup>above</sup> rock/concrete; Mark is.....m. <sup>above</sup> G.L. <sub>below</sub>  
 Height of Top Vanes to Top Mark/Pillar plate .....m. Diameter of Vanes (vertical).....m.  
 Height of Cairn.....m. Diameter of Cairn.....m. Name Plate found/not found/placed.  
 Length of Mast .....m. (approximate if not unplied)  
 A.....set in conc/rock has been placed/found, bearing.....°M from Mast/Plug/Pillar  
 A.....set in conc/rock has been placed/found, bearing.....°M from Mast/Plug/Pillar  
 A.....set in conc/rock has been placed/found, bearing.....°M from Mast/Plug/Pillar  
 A.....set in conc/rock has been placed/found, bearing.....°M from Mast/Plug/Pillar

Action required.....

STANDPOINT: .....

Mark	Direction	Horiz. Distance	Height Difference	Mark	Direction	Horiz. Distance	Height Difference
			above standpt. below				above standpt. below
			above standpt. below				above standpt. below
			above standpt. below				above standpt. below
			above standpt. below				above standpt. below
			above standpt. below				above standpt. below
			above standpt. below				above standpt. below
			above standpt. below				above standpt. below

Prepared by: .....

Checked: .....

Noted on U.T.M. Card

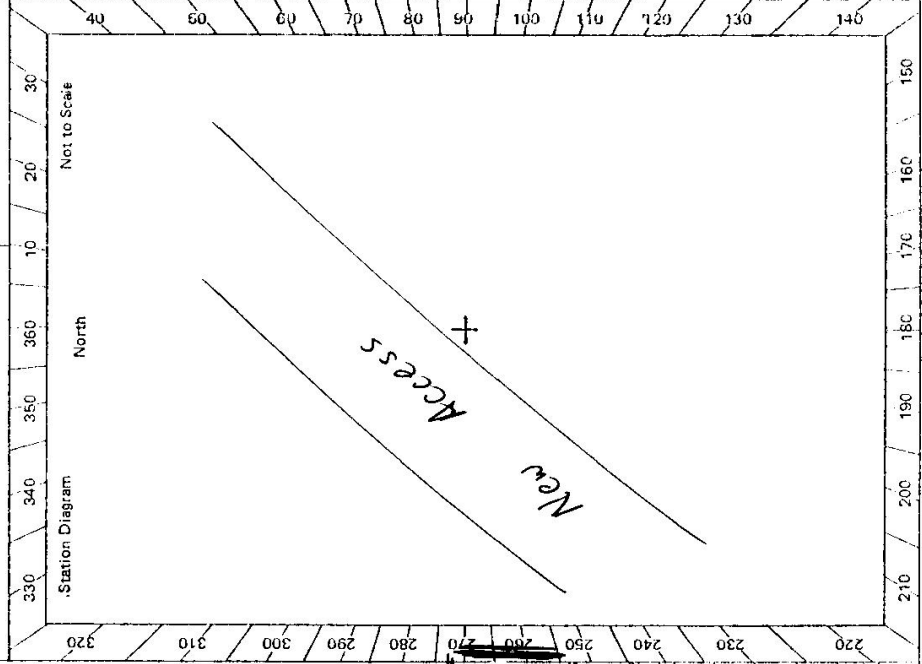

2733-2 D. West. Government Printer

Beacon Diagram	Not to Scale	
<p style="margin: 0;">STATION <b>UMBERUMBERKA (P) TS 4510</b></p>		
<p>Owner's Name: <b>Western Lands Comm.</b>                  Address: <b>MR EEC McORMICK</b>                  Phone: .....</p>		
<p>Current Occupant: <b>MR. P. BLORE</b>                  Address: <b>Belmont Station</b>                  Phone: <b>885310</b></p>		
<p>TRAVEL: <b>1 1/2 HRS from B. HILL</b>      <b>AWD</b>      <b>AUG 1994</b>                  Access Report of <b>18/10/94</b> was found suitable/unsuitable.      <b>ACCESS</b></p>		
<p><b>0.0 SILVERTON GAOL head toward Broken Hill</b>  <b>0.7 Turn L sign "Penrose Park"</b>  <b>1.0 Straight ahead on to dirt road</b>  <b>1.5 Turn L sign "Belmont"</b>  <b>1.7 Turn R sign "Belmont"</b>  <b>2.0 Pass cemetery on R</b>  <b>2.93 Grid. Sign "Belmont Stn" = old mud house on R</b>  <b>3.84 Turn R sign "wet weather rd" (straight ahead to owners house)</b>  <b>4.26 Take L fork</b>  <b>4.66 Dry creek crossing</b>  <b>4.79 Take L fork</b>  <b>5.5 Iron gate</b>  <b>5.93 Take L fork along creek</b>  <b>6.5 Take L fork</b>  <b>7.15 Cross pipe</b>  <b>7.95 Take L fork</b>  <b>8.45 Cross sandy creek to far side</b>  <b>8.5 Track turns R &amp; follows creek</b>  <b>8.6 Track leaves creek on L bank</b>  <b>9.45 Iron gate (creek on R)</b>  <b>9.55 Track enters creek &amp; crosses it several times</b></p>		
<p>Date .....</p>		
<p>Record of Station</p>		
Date		<p><b>10.5 At fence enr. Track follows fence to gate</b>  <b>10.65 Iron gate in corner</b>  <b>10.75 Take L fork just after gully</b>  <b>12.05 Abt 30 m after crest turn L and follow ridge into saddle (small cairns either side of track)</b>  <b>12.75 Wire yards on R</b>  <b>12.9 At fence enr follow track along fence to L. (A visible)</b>  <b>13.3 Turning area. 10 mins easy walk over fence to UMBERUMBERKA (A)</b></p>
<p>This section to be completed by officer constructing pillar.</p>		
<p>Original station mark found/not found. ....</p>		
<p>Description of mark: .....</p>		
<p>Original beacon found/not found. ....</p>		
<p>Description of beacon: .....</p>		
<p>Height Top of Vanes to Top Mark ..... m.</p>		
<p>Height of mark ..... m.      above G.L.                  below .....</p>		
<p>Diameter of Vanes ..... m.      Height of Cairn ..... m.</p>		
<p>Original Beacon has/has not been destroyed by me. ....</p>		