

GEODETIC SURVEY OF M.S.W.

CENTRAL MAPPING AUTHORITY

GEODETIC STATION RECONNAISSANCE and MAINTENANCE REPORT

Description: 360°
 Note: Cross out word or words which do not apply
 1. Cleared by lanes bearing 360° from Trig. Mast

2. Mast & Vanes have been painted white & black respectively.
 3. The STATION was unplaced/~~not placed~~/~~constructed~~ on 19.17.19.00, dimensions now being:

Description of mark: BRASS BOLT should be explicit, e.g. S/Steel Pillar Plate, Steel plug, Brass plug, Bolt, G.I. Pipe
 Height of mark: 0.075 m. ^{above} rock/concrete; Mark is AT ^{above} ~~below~~ G.L.

Height of Top Vanes to Top Mark/~~Pillar/Plate~~: 3.936 m. Diameter of Vanes (vertical): 0.750 m.
 Height of Cairn: 1.000 m. Diameter of Cairn: 2.000 m. Name Plate found/~~not found~~/ PLACED

Length of Mast: 3.956 m. (approximate if not unplaced)
 4. A. S.S.M. No. 128 set in conc/rock has been ~~placed~~/found, bearing 135° M from Mast/Plug/Pillar

5. A. COPPER NAIL set in conc/rock has been placed/~~found~~, bearing 169° M from Mast/Plug/Pillar
 6. A. BRASS BOLT IN CONC (P) set in conc/rock has been placed/~~found~~, bearing 135° M from Mast/Plug/Pillar

7. A. BRASS BOLT IN CONC (P) set in conc/rock has been placed/~~found~~, bearing 169° M from Mast/Plug/Pillar
 8. Action required: POSSIBLE TO REEQUIP PILLAR?

Mark	Direction	Horiz. Distance	Height Difference	STANDPOINT: BRASS BOLT		STANDPOINT: COPPER NAIL	
				Mark	Direction	Horiz. Distance	Height Difference
WILLURI G.S	0 00 00		above standpt.	WILLURI G.S	0 00 00		above standpt.
S.S.M No 128	19 14 05	6 065	above standpt.	S.S.M No 128	9 34 05	9 944	above standpt.
YARRARI G.S	19 15 35		above standpt.	YARRARI G.S	19 15 10		above standpt.
COPPER NAIL	175 09 15	4 096	above standpt.	BRASS BOLT	355 08 15	4 095	above standpt.
			below standpt.				below standpt.
			below standpt.				below standpt.
			below standpt.				below standpt.
			below standpt.				below standpt.
			below standpt.				below standpt.

Prepared by: J.C. [Signature] Checked: [Signature]
 Noted on U.T.M. Card 9/3/81

S: 2733-1

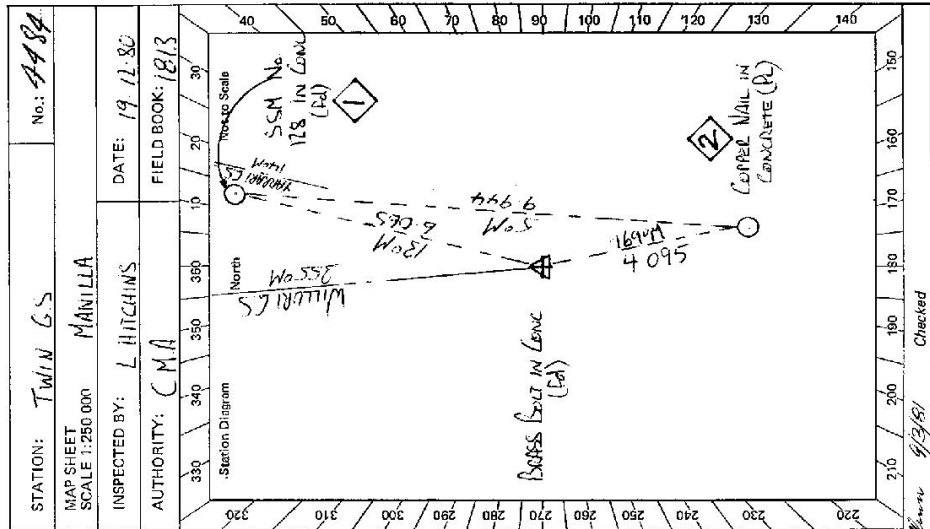

STATION: TWIN G.S No.: 4484
 MAP SHEET SCALE 1:250 000 MANILLA
 INSPECTED BY: L. HITCHINS DATE: 19 12 80
 AUTHORITY: CMA FIELD BOOK: 1813

ST-2733-2 D. West. Government Printer Beacon Diagram Not to Scale		STATION TWIN G.S. IS 4484 Owner's Name: MR. ELIAS ROBERTS Address: KEVIN MA Phone: GUNNADAN Current Occupant: UNGGKAP.PED Address: Phone: ACCESS 19-12-1980
This section to be completed by officer constructing pillar. Original station mark found/ not found . BRASS Bolt in Cone Description of mark: Original beacon found/ not found . CAIRN POLE & DSS Description of beacon: Height Top of Vanes to Top Mark. 2.455 m. Height of mark 0.02 m. above below G.L. Diameter of Vanes 1.010 m. Height of Cairn 1.000 m. Original Beacon has not been destroyed by me.		Access Report of 11/19/85 was found suitable/unsuitable. 0 0 GO GUNNADAN HEAD WEST ALONG CONADILLY ST. 0 45 TURN RIGHT ALONG CHANDOS ST. 1 1 CROSS BRIDGE 4 55 PASS RD TO KEEP IT DAM ON RIGHT. 16 2 TURN RIGHT OFF BITUMEN OPPOSITE LEVY BANK AND HOUSE 16 25 DOUBLE IRON GATES. FOLLOW TRACK STRAIGHT AHEAD 16 35 CROSS GULLY + TURN LEFT. 16 4 TURN RIGHT UP FENCE LINE 16 5 THROUGH DOUBLE IRON GATES THEN VEER RIGHT. STAY BETWEEN SMALL GULLY AND FENCE. NO TRACK TURN LEFT. LEAVE FENCE. CROSS SMALL GULLY + HEAD TOWARDS BURZED TREE BLAZED TREE VEER RIGHT + HEAD TOWARDS GULLY BETWEEN 2 ROCK SPURS + MAKE OWN WAY UP GULLY LEAVE VEHICLE MAKE OWN WAY UP RIGHT HAND SIDE OF HILL TO TWIN G.S. OWNERS HOUSE IS APPROX 7 KM FURTHER ALONG BITUMEN FROM * 16 2 ON R.H.S.
		Date Record of Station